

JOINT PUBLIC NOTICE
April 22, 2005



United States Army
Corps of Engineers
New Orleans District
Regulatory Branch
Post Office Box 60267
New Orleans, Louisiana 70160-0267

State of Louisiana
Department of Environmental Quality
Office of Environmental Services
Post Office Box 4313
Baton Rouge, Louisiana 70821-4313

(504) 862-2595 FAX (504) 862-2117
Project Manager
Jacqueline Farabee
Permit Application Number
MVN-2005-719-EGG

(225) 219-3466 FAX (225) 219-1039
Project Manager
Brian Baker
WQC Application Number
WQC BB 050309-12

Interested parties are hereby notified that a permit application has been received by the New Orleans District of the U.S. Army Corps of Engineers pursuant to:
[] Section 10 of the Rivers and Harbors Act of March 3, 1899 (30 Stat. 1151; 33 USC 403);
and/or [X] Section 404 of the Clean Water Act (86 Stat. 816; 33 USC 1344).

Application has also been made to the Louisiana Department of Environmental Quality, Office of Environmental Services, for a Water Quality Certification (WQC) in accordance with statutory authority contained in LRS 30:2074 A(3) and provisions of Section 401 of the Clean Water Act (P.L.95-217).

RESIDENTIAL SUBDIVISION IN ST. CHARLES PARISH

NAME OF APPLICANT: Nehemiah Development, c/o Civil and Environmental Consulting Engineers
ATTENTION: Danny Hebert, P.E., P.O. Box 1528, Luling, Louisiana 70070.

LOCATION OF WORK: Approximately 42 acres on River Road .5 mile past River Park Drive in Hahnville, Louisiana, in St. Charles Parish, as shown on the attached drawings.

CHARACTER OF WORK: Clear, grade, excavate and deposit fill for the construction of house pads, roadway, driveways, and parking. Approximately 4000 cubic yards of material excavated on-site, 2100 cubic yards of concrete and 4000 cubic yards of hauled-in sand will be deposited on-site. Approximately 4.8 acres of jurisdictional wetlands would be directly impacted as a result of the proposed project.

The comment period for the Department of the Army Permit and the Louisiana Department of Environmental Quality WQC will close **30 days** from the date of this joint public notice. Written comments, including suggestions for modifications or objections to the proposed work, stating reasons thereof, are being solicited from anyone having interest in this permit and/or this WQC request and must be mailed so as to be received before or by the last day of the comment period. Letters concerning the Corps of Engineers permit application must reference the applicant's name and the Permit Application Number, and be mailed to the Corps of Engineers at the address above, **ATTENTION: REGULATORY BRANCH**. Similar letters concerning the Water Quality Certification must reference the applicant's name and the WQC Application number and be mailed to the Louisiana Department of Environmental Quality at the address above.

The application for this proposed project is on file with the Louisiana Department of Environmental Quality and may be examined during weekdays between 8:00 a.m. and 4:30 p.m. Copies may be obtained upon payment of costs of reproduction.

Corps of Engineers Permit Criteria

The decision whether to issue a permit will be based on an evaluation of the probable impacts, including cumulative impacts of the proposed activity on the public interest. That decision will reflect the national concern for both protection and utilization of important resources. The benefit which reasonably may be expected to accrue from the proposal must be balanced against its reasonably foreseeable detriments. All factors which may be relevant to the proposal will be considered including the cumulative effects thereof; among those are conservation, economics, aesthetics, general environmental concerns, wetlands, historic properties, fish and wildlife values, flood hazards, floodplain values, land use, navigation, shoreline erosion and accretion, recreation, water supply and conservation, water quality, energy needs, safety, food and fiber production, mineral needs, considerations of property ownership and, in general, the needs and welfare of the people.

The U.S. Army Corps of Engineers is soliciting comments from the public, federal, state, and local agencies and officials, Indian Tribes, and other interested parties in order to consider and evaluate the impacts of this proposed activity. Any comments received will be considered by the U.S. Army Corps of Engineers to determine whether to make, modify, condition, or deny a permit for this proposal. To make this decision, comments are used to assess impacts on endangered species, historic properties, water quality, general environmental effects, and other public interest factors listed above. Comments are used in the preparation of an Environmental Assessment and/or an Environmental Impact Statement pursuant to the National Environmental Policy Act. Comments are also used to determine the need for a public hearing and to determine the overall public interest of the proposed activity.

No properties listed on the National Register of Historic Places are near the proposed work. The possibility exists that the proposed work may damage or destroy presently unknown archeological, scientific, prehistorical, historical sites, or data. Copies of this notice are being sent to the State Archeologist and the State Historic Preservation Officer.

Our initial finding is that the proposed work would neither affect any species listed as endangered by the U.S. Departments of Interior or Commerce, nor affect any habitat designated as critical to the survival and recovery of any endangered species.

This notice initiates the Essential Fish Habitat (EFH) consultation requirements of the Magnuson-Stevens Fishery Conservation and Management Act. The applicant's proposal would result in the destruction or alteration of n/a acres of EFH utilized by various life stages of red drum and penaeid shrimp. Our initial determination is that the proposed action would not have a substantial adverse impact on EFH or federally managed fisheries in the Gulf of Mexico. Our final determination relative to project impacts and the need for mitigation measures is subject to review by and coordination with the National Marine Fisheries Service.

If the proposed work involves deposits of dredged or fill material into navigable waters, the evaluation of the probable impacts will include the application of guidelines established by the Administrator of the Environmental Protection Agency. Also, a

certification that the proposed activity will not violate water quality standards will be required from the Department of Environmental Quality, Office of Environmental Services before a permit is issued.

Any person may request, in writing, within the comment period specified in this notice, that a public hearing be held to consider this application. Requests for public hearings shall state, with particularity, the reasons for holding a public hearing. You are requested to communicate the information contained in this notice to any other parties whom you deem likely to have interest in the matter.

The applicant has certified that the proposed activity described in the application complies with and will be conducted in a manner that is consistent with the Louisiana Coastal Resources Program. The Department of the Army permit will not be issued unless the applicant received approval or a waiver of the Coastal Use Permit by the Department of Natural Resources.

You are requested to communicate the information contained in this notice to any other parties whom you deem likely to have interest in the matter.

P.J. Serio
Chief, Eastern Evaluation Section
Regulatory Branch

Enclosures

MVN-2005-719

REVISED: 2/22/05

P#2005-0072

ATTACHMENT - A

FINAL CORRECTION FOR LONGITUDE/LATITUDE

Date: 1/28/05

**Nehemiah Developments
Brookshire Estates Subdivision**

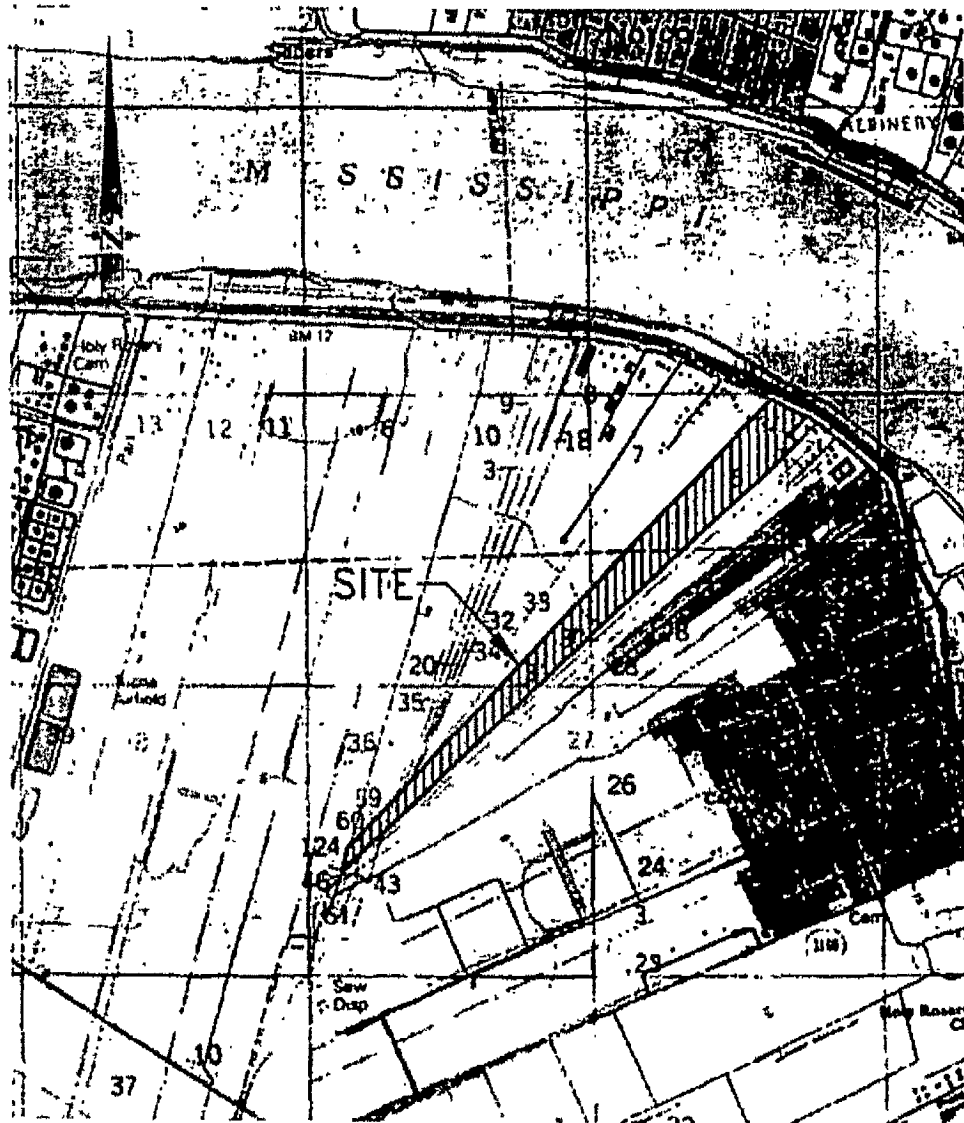

VICINITY MAP

SCALE: 1" = 2000'

FRONT GATE:

Lat: 29 degrees 59' 10"

Lon: 90 degrees 24' 40"

BACK OF PROPERTY:

Lat: 29 degrees 58' 28"

Lon: 90 degrees 25' 36"

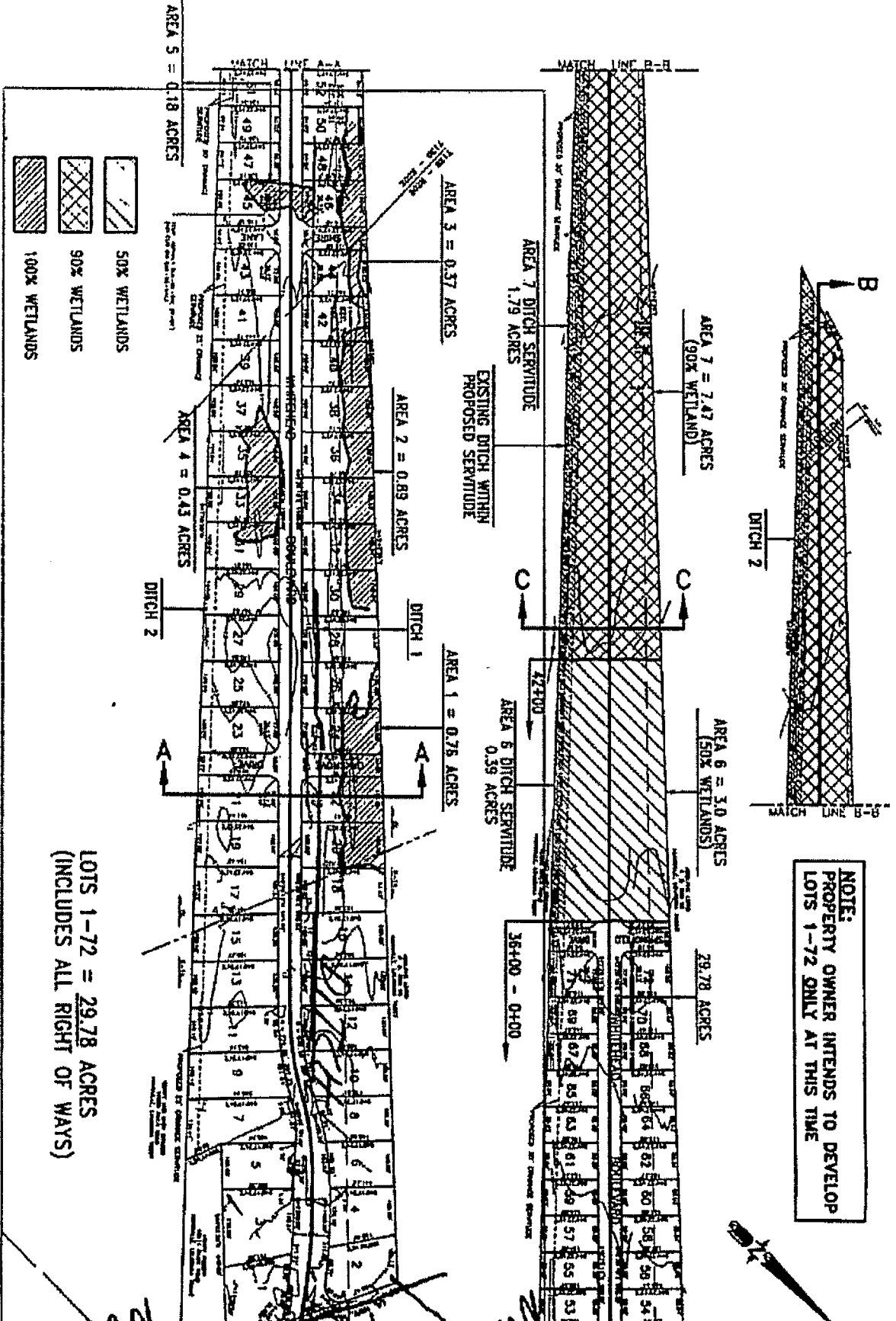

BROOKSHIRE ESTATES WETLANDS AREA

IN SECTIONS 5 & 7, T12S - R20E
 & SECTIONS 31 & 33, T13S - R20E
 ST. CHARLES PARISH, LOUISIANA
 SCALE 1" = 300'
 MARCH 8, 2005

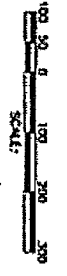

4/18/05 REVISED SECTION B-B
 ADDED SECTION C-C
 SHEET 1

NOTE:
 PROPERTY OWNER INTENDS TO DEVELOP
 LOTS 1-72 ONLY AT THIS TIME

ATTACHMENT D-REVISED 4/19/05

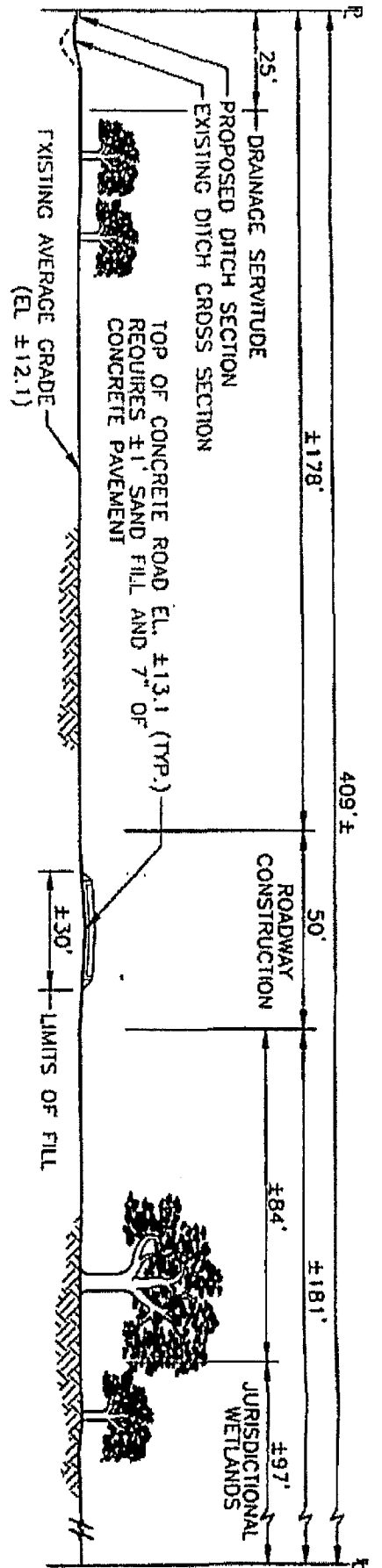

SECTION A
SCALE: 1"=40' H
1"=20' V

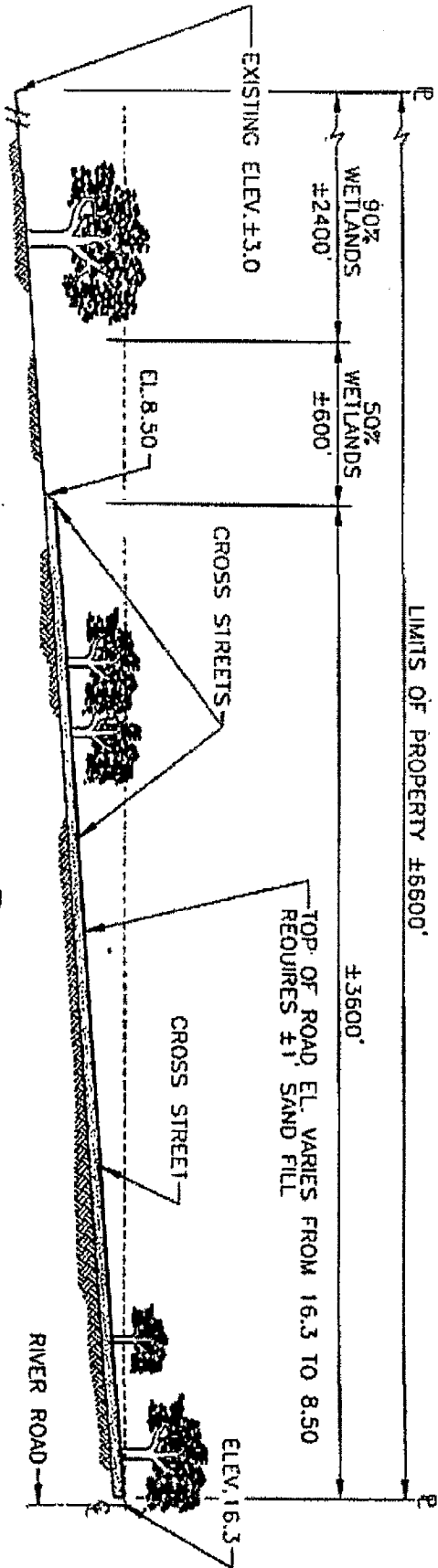

SECTION B
SCALE: 1"=600' H
1"=20' V

AREA OF WETLANDS FILLED= 0.79 ACRES

- NOTES:
1. ALL ELEVATIONS ARE SHOWN IN MEAN SEA LEVEL (MSL).
 2. ALL MATERIAL TO BE RIVER SAND OR SIMILAR.
 3. EXISTING PUMP-OUTS TO BE MAINTAINED.

BROOKSHIRE ESTATES WETLANDS
404 PERMIT APPLICATION
SECTIONS A & B
ST. CHARLES PARISH, LOUISIANA

NO.	REVISION	DATE
1	ISSUED FOR PERMIT	04/19/05
2	REVISED WETLANDS	04/19/05
3	REVISED	04/19/05

BROOKSHIRE ESTATES SECTIONS
ST. CHARLES PARISH, LOUISIANA

SECTIONS THROUGH SITE

DANNY J. BEBERT, P.E.
REGISTERED CIVIL AND ENVIRONMENTAL ENGINEER
P.O. BOX 1328 LAFAYETTE, LOUISIANA 70501
PHONE: (225) 781-1328 FAX: (225) 781-1328
CELL: (225) 781-1328

DATE	SCALE	PROJECT NO.	DATE
04/19/05	AS SHOWN	404	04/19/05
ISSUED FOR PERMIT	ISSUED FOR PERMIT	ISSUED FOR PERMIT	ISSUED FOR PERMIT

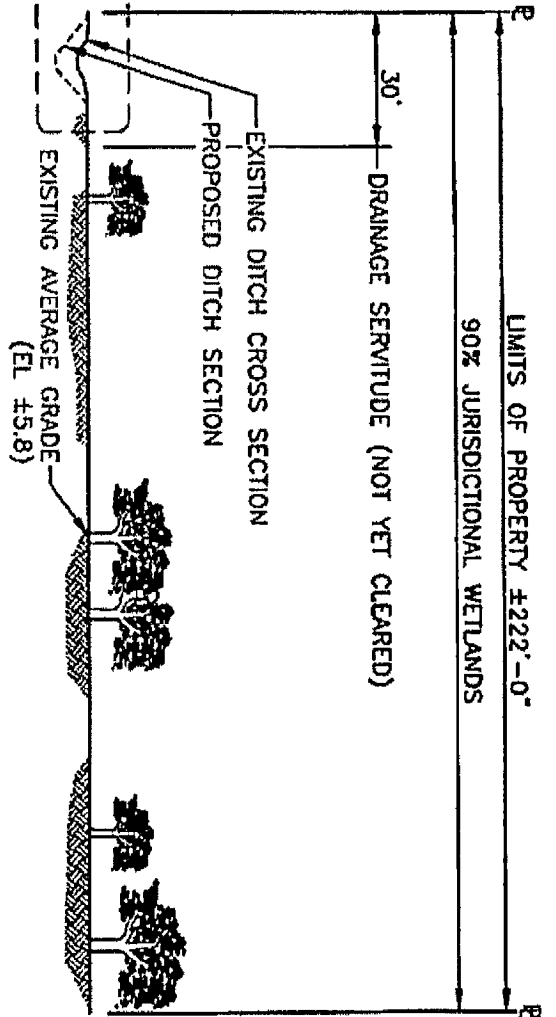

SECTION C
SCALE: 1"=40' H
1"=20' V

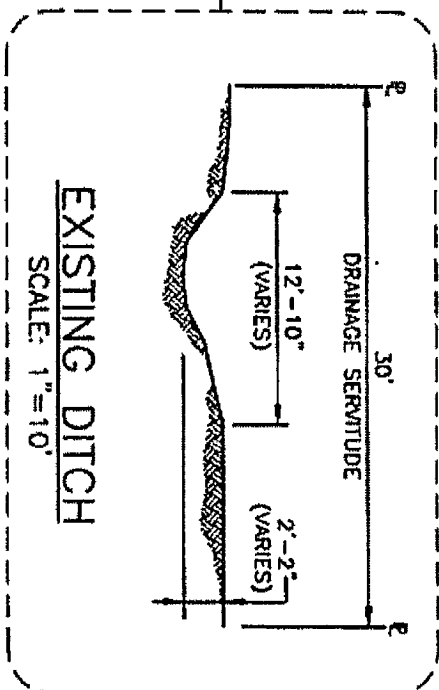
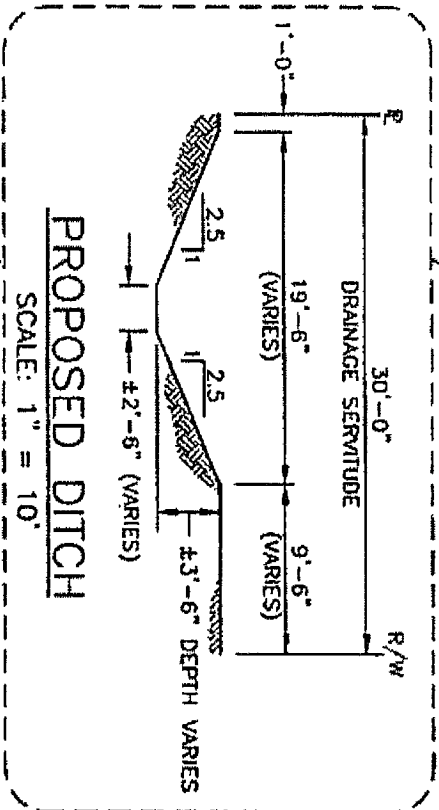

- NOTES:
1. ALL ELEVATIONS ARE SHOWN IN MEAN SEA LEVEL (MSL).
 2. FILL MATERIAL TO BE RIVER SAND OR SIMILAR.
 3. EXISTING DRAINAGE OUTLETS TO BE MAINTAINED.

BROOKSHIRE ESTATES WETLANDS
404 PERMIT APPLICATION
SECTIONS C
ST. CHARLES PARISH, LOUISIANA

NO.	DATE	REVISIONS	BY	CHKD.

BROOKSHIRE ESTATES SECTIONS
ST. CHARLES PARISH, LOUISIANA

SECTIONS THROUGH SITE

DANNY J. HERBERT, P.E.
LICENSURE CIVIL AND ENVIRONMENTAL ENGINEER
P.O. BOX 1528, LAFAYETTE, LOUISIANA 70504
PHONE: (504) 782-3280 FAX: (504) 782-3286
CELL: (504) 782-3286
E-MAIL: dherbert@dhherbert.com
CREATED BY: D.J.H. DATE: 04/19/05
CHECKED BY: D.J.H. DATE: 04/19/05
DESIGNED BY: D.J.H.

ATTACHMENT E2

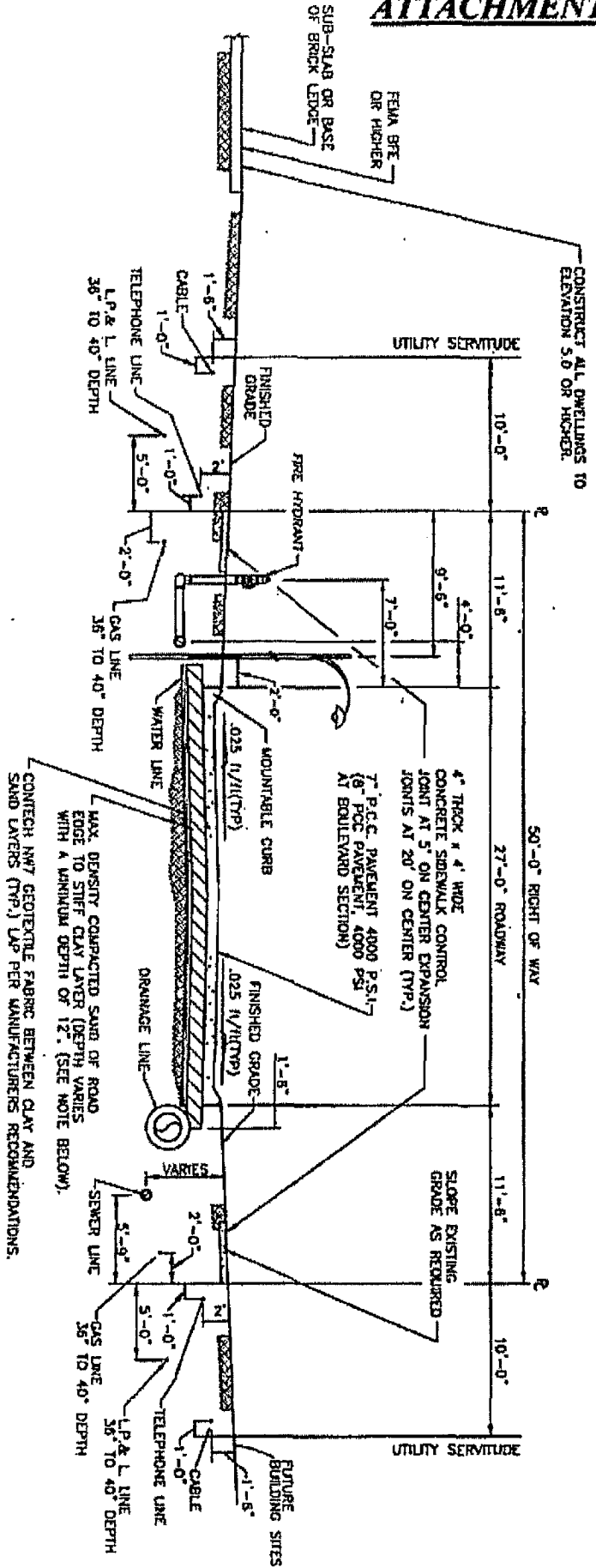

TYPICAL 50' R.O.W.
SCALE: 1" = 10'

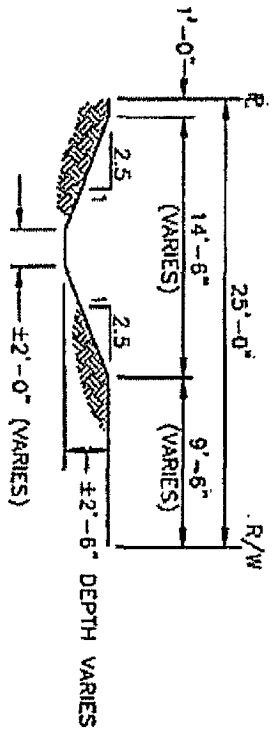

TYPICAL DITCH CROSS SECTION
SCALE: 1" = 10'

Site
Call before
you dig
1-800-378-5853
Note: An excavation for a utility or other purpose shall be made in accordance with the provisions of the Louisiana Department of Transportation and Development.

DATE	DESCRIPTION	NO.

BROOKSHIRE ESTATES
ST. CHARLES PARISH, LOUISIANA

TYPICAL STREET SECTION

DANNY J. HERBERT, P.E.
LICENSED CIVIL AND ENVIRONMENTAL ENGINEER
P.O. BOX 1528 LEBLANC, LOUISIANA 70079
PHONE(504) 783-2385 FAX(504) 783-2386

DATE: 1/24/03
DRAWN BY: [Signature] CHECKED BY: [Signature]
SCALE: 1" = 10'
SHEET NO. 1 OF 1

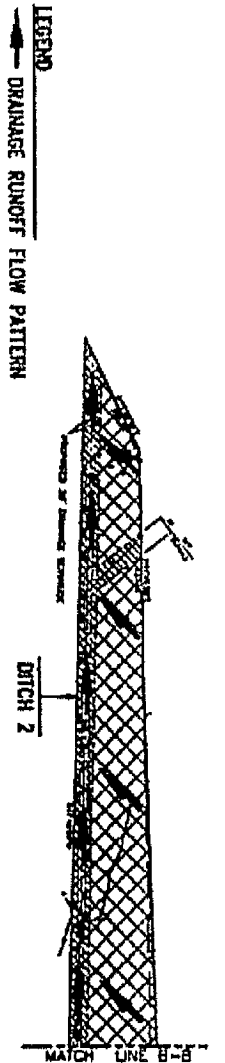

NOTE:
PROPERTY OWNER INTENDS TO DEVELOP
LOTS 1-72 ONLY AT THIS TIME

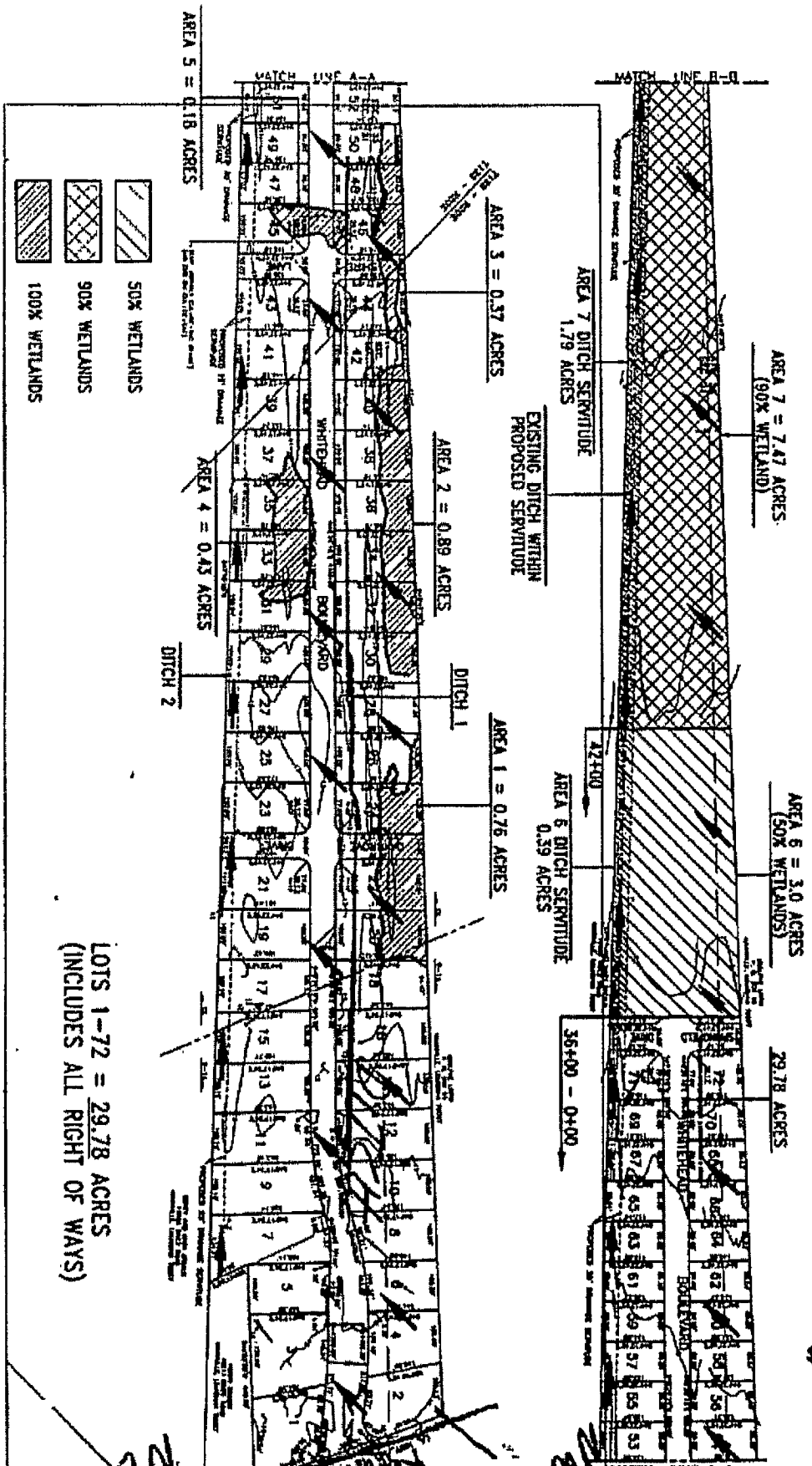

- 50X WETLANDS
- 90X WETLANDS
- 100X WETLANDS

**BROOKSHIRE ESTATES EXISTING & PROPOSED
DRAINAGE FLOW PATTERN**

LOTS 1-72 = 29.78 ACRES
(INCLUDES ALL RIGHT OF WAYS)

IN SECTIONS 5 & 7, T12S - R20E
& SECTIONS 31 & 33, T13S - R20E
ST. CHARLES PARISH, LOUISIANA
SCALE: 1" = 200'

