

JOINT PUBLIC NOTICE

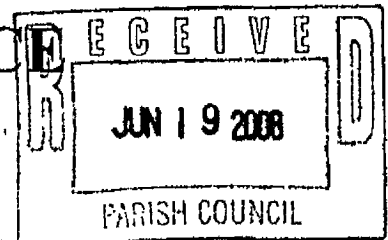

June 9, 2008

United States Army
Corps of Engineers
New Orleans District
Regulatory Branch
Post Office Box 60267
New Orleans, Louisiana 70160-0267

State of Louisiana
Department of Environmental Quality
Office of Environmental Services
Post Office Box 4313
Baton Rouge, Louisiana 70821-4313

(504) 862-2225
Project Manager
Brad LaBorde
Permit Application Number
MVN 2008-0436 EOO

(225) 219-3469
Project Manager
Jamie Phillippe
WQC Application Number
WQC JP 080220-02

Interested parties are hereby notified that a permit application has been received by the New Orleans District of the U.S. Army Corps of Engineers pursuant to: [X] Section 10 of the Rivers and Harbors Act of March 3, 1899 (30 Stat. 1151; 33 USC 403); and/or [X] Section 404 of the Clean Water Act (86 Stat. 816; 33 USC 1344).

Application has also been made to the Louisiana Department of Environmental Quality, Office of Environmental Services, for a Water Quality Certification (WQC) in accordance with statutory authority contained in LRS30:2047 A(3), and provisions of Section 401 of the Clean Water Act (P.L.95-17).

NATURAL GAS PIPELINE IN ST. CHARLES PARISH, LOUISIANA

NAME OF APPLICANT: Sorrento Pipeline Company, LLC., c/o Morris P. Hebert, Inc., 10343 Siegen Ln, building 4-B, Baton Rouge, Louisiana 70810.

LOCATION OF WORK: Proposal will impact approximately 29 acres along an existing pipeline corridor from the Motiva Refinery in Norco, LA to the Marathon Facility in Garyville, LA in St. Charles Parish, Louisiana, as shown on the enclosed drawings.

CHARACTER OF WORK: Install and maintain two 8-inch gas pipelines extending 101,702.25-feet to improve refining capability. 24.09 acres of jurisdictional wetlands will be impacted as approximately 134,955 cubic yards of material will be excavated, stockpiled, and later backfilled upon the completion of the project. Thirty-four temporary work stations will be required adjacent to the existing pipeline corridor and accessed using board mats and nearby access roads. Approximately 949 cubic yards of limestone material will be hauled in for bank stabilization at canal crossings with an additional 35 cubic yards placed at the two proposed 30-foot by 30-foot valve sites.

The comment period for the Department of the Army Permit and the Louisiana Department of Environmental Quality WQC will close **20 days** from the date of this joint public notice. Written comments, including suggestions for modifications or objections to the proposed work, stating reasons thereof, are being solicited from anyone having interest in this permit and/or this WQC request and must be mailed so as to be received before or by the last day of the comment period. Letters concerning the Corps of Engineers permit application must reference the applicant's name and the Permit Application Number, and be mailed to the Corps of Engineers at the address above, **ATTENTION: REGULATORY BRANCH**. Individuals or parties may request an extension of time in which to comment on the proposed work by writing to the project manager or clicking on the project manager's name on the public notice grid on the web page. Any request must be specific and substantively supportive of the requested extension, and received by this office prior to the end of the initial comment period. The Section Chief will review the request and the

requestor will be promptly notified of the decision to grant or deny the request. If granted, the time extension will be continuous to the initial comment period and, inclusive of the initial comment period, will not exceed a total of 30 calendar days. Similar letters concerning the Water Quality Certification must reference the applicant's name and the WQC Application number and be mailed to the Louisiana Department of Environmental Quality at the address above.

The application for this proposed project is on file with the Louisiana Department of Environmental Quality and may be examined during weekdays between 8:00 a.m. and 4:30 p.m. Copies may be obtained upon payment of costs of reproduction.

Corps of Engineers Permit Criteria

The decision whether to issue a permit will be based on an evaluation of the probable impacts, including cumulative impacts of the proposed activity on the public interest. That decision will reflect the national concern for both protection and utilization of important resources. The benefit which reasonably may be expected to accrue from the proposal must be balanced against its reasonably foreseeable detriments. All factors which may be relevant to the proposal will be considered including the cumulative effects thereof; among those are conservation, economics, aesthetics, general environmental concerns, wetlands, historic properties, fish and wildlife values, flood hazards, floodplain values, land use, navigation, shoreline erosion and accretion, recreation, water supply and conservation, water quality, energy needs, safety, food and fiber production, mineral needs, considerations of property ownership and, in general, the needs and welfare of the people.

The U.S. Army Corps of Engineers is soliciting comments from the public, federal, state, and local agencies and officials, Indian Tribes, and other interested parties in order to consider and evaluate the impacts of this proposed activity. Any comments received will be considered by the U.S. Army Corps of Engineers to determine whether to make, modify, condition, or deny a permit for this proposal. To make this decision, comments are used to assess impacts on endangered species, historic properties, water quality, general environmental effects, and other public interest factors listed above. Comments are used in the preparation of an Environmental Assessment and/or an Environmental Impact Statement pursuant to the National Environmental Policy Act. Comments are also used to determine the need for a public hearing and to determine the overall public interest of the proposed activity.

No properties listed on the National Register of Historic Places are near the proposed work. The possibility exists that the proposed work may damage or destroy presently unknown archeological, scientific, prehistorical, historical sites, or data. Copies of this notice are being sent to the State Archeologist and the State Historic Preservation Officer.

Our initial finding is that the proposed work would neither affect any species listed as endangered by the U.S. Departments of Interior or Commerce, nor affect any habitat designated as critical to the survival and recovery of any endangered species.

This notice initiates the Essential Fish Habitat (EFH) consultation requirements of the Magnuson-Stevens Fishery Conservation and Management Act. The applicant's proposal would result in the destruction or alteration of n/a acres of EFH utilized by various life stages of red drum and penaeid shrimp. Our initial determination is that the proposed action would not have a substantial adverse impact on EFH or federally managed fisheries in the Gulf of Mexico. Our final determination relative to project impacts and the need for mitigation measures is subject to review by and coordination with the National Marine Fisheries Service.

If the proposed work involves deposits of dredged or fill material into navigable waters, the evaluation of the probable impacts will include the application of guidelines established by the Administrator of the Environmental Protection Agency. Also, a certification that the proposed activity will not violate applicable water quality standards will be required from the Department of Environmental Quality, Office of Environmental Services, before a permit is issued.

Any person may request, in writing, within the comment period specified in this notice, that a public hearing be held to consider this application. Requests for public hearings shall state, with particularity, the reasons for holding a public hearing.

The applicant has certified that the proposed activity described in the application complies with and will be conducted in a manner that is consistent with the Louisiana Coastal Resources Program. The Department of the Army permit will not be issued unless the applicant received approval or a waiver of the Coastal Use Permit by the Department of Natural Resources.

You are requested to communicate the information contained in this notice to any other parties whom you deem likely to have interest in the matter.

Michael V. Farabee
Chief, Eastern Evaluation Section

Enclosure

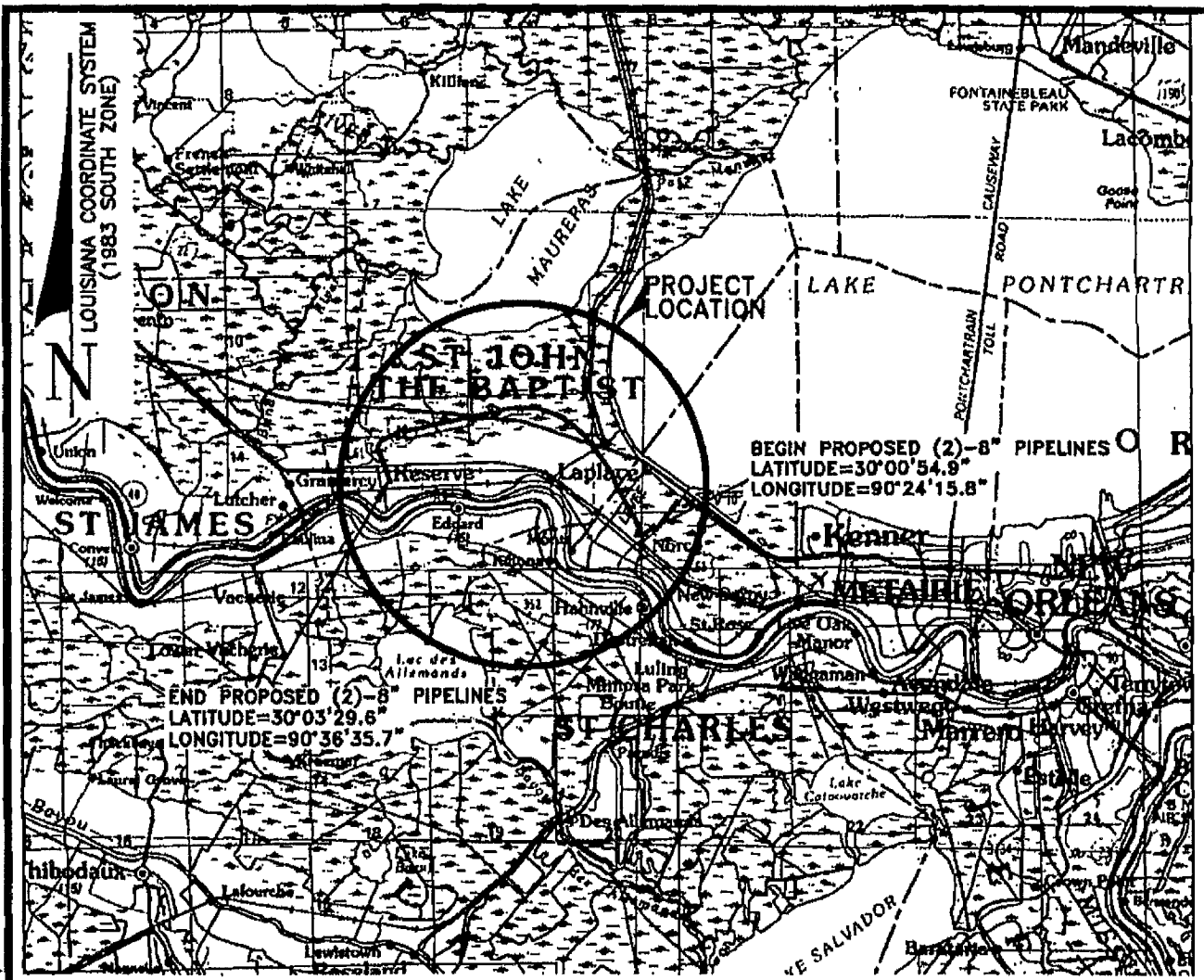

LOUISIANA COORDINATE SYSTEM
(1983 SOUTH ZONE)

BEGIN PROPOSED (2)-8" PIPELINES
LATITUDE=30°00'54.9"
LONGITUDE=90°24'15.8"

END PROPOSED (2)-8" PIPELINES
LATITUDE=30°03'29.6"
LONGITUDE=90°36'35.7"

GRAPHIC SCALE



NO.	DATE	REV. BY:	REVISION
-----	------	----------	----------

SORRENTO PIPELINE COMPANY, LLC

PROPOSED (2)-8" PIPELINES FROM ENTERPRISE NORCO REFRACTIONATOR TO GARYVILLE
LOCATED IN SECTIONS 6, 21, 22, 25, 26, T12S-R8E & SECTIONS 32, 42-44,
T11S-R8E, ST. CHARLES PARISH & SECTIONS 18-20, 29, T11S-R8E & SECTIONS
7-9, 14, 16, 66, 69-71, 96-98, T11S-R7E & SECTIONS 23, 26-28, 30, 32, 60,
62, 66, 91-93, 95, T11S-R6E, ST. JOHN THE BAPTIST PARISH, LOUISIANA



Morris P. Hebert, Inc.

QUALITY • ENGINEERING • ENVIRONMENTAL SERVICES • FIELD SERVICES • GIS
P.O. BOX 3106 • 283 CORPORATE DRIVE • HOUMA, LOUISIANA 70361 • (905) 879-2731
10101 SOUTHWEST FREEWAY • SUITE 400 • HOUSTON, TEXAS 77074 • (713) 219-1470

DRAWN BY: JDW	SHEET: 1
CHKD./APPD. BY: JMH	SCALE: SHOWN
UPDATED BY: DPM	DATE: 11/01/07
DATA BASE: 9580	JOB NO. 9580

MPH CAD FILE: 13604-PD-001.DWG

W:\dwg\9580\COE\13604-PD-001.dwg PLOT DATE: 1/11/08 2:08:11PM

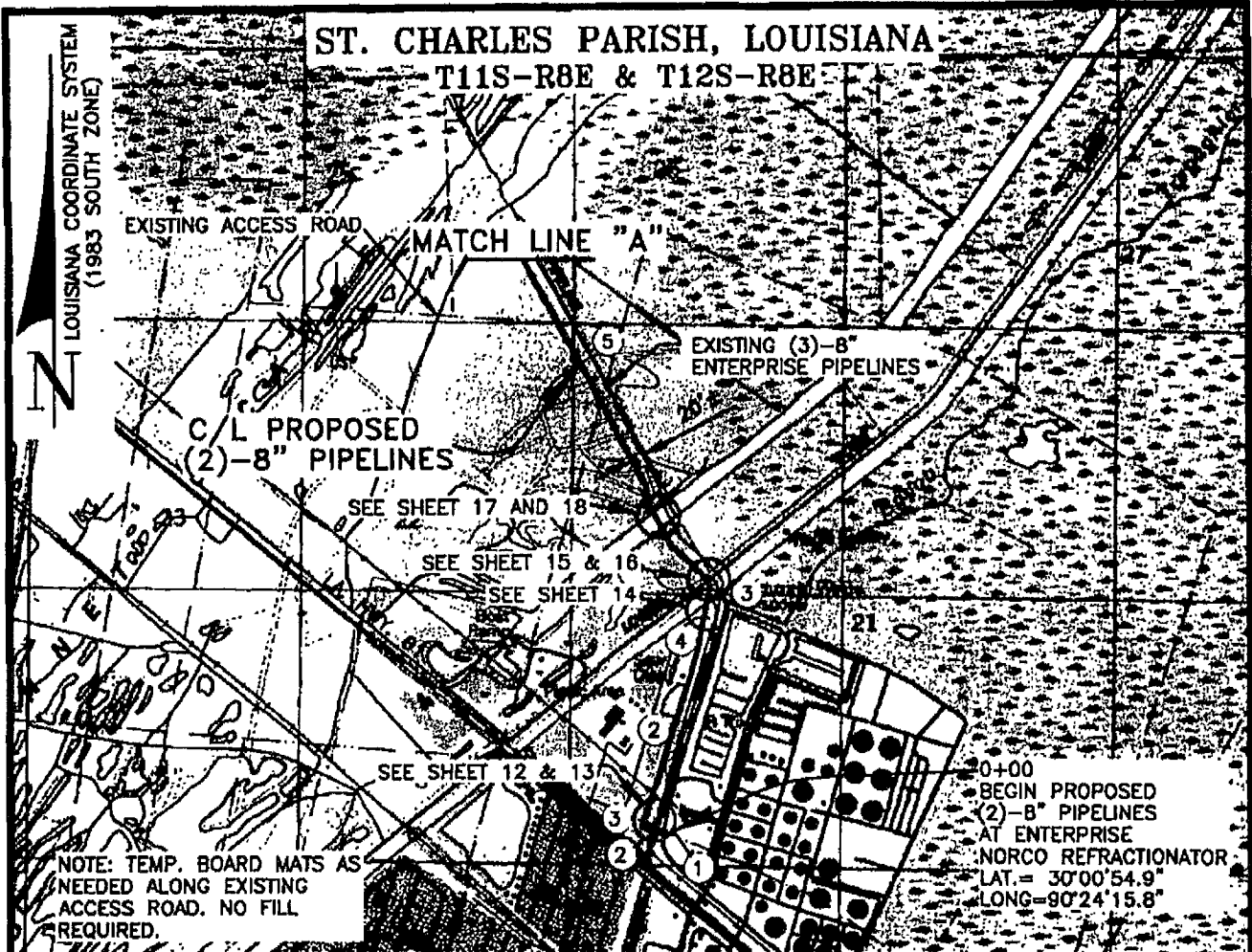

PLAN

AFFECTED LAND OWNERS:

- ① EPCO NORCO FRACTIONATION PLANT, LLC
- ② SHELL OIL COMPANY
- ③ GRAVITY DRAINAGE DISTRICT No.2
- ④ ST. CHARLES PARISH SEWERAGE DISTRICT #1
- ⑤ UNITED STATES OF AMERICA

GRAPHIC SCALE



NO.	DATE	REV. BY:	REVISION

SORRENTO PIPELINE COMPANY, LLC

PLAN



QUANTITY • ENGINEERING • ENVIRONMENTAL SERVICES • FIELD SERVICES • GIS
P.O. BOX 3108 • 283 CORPORATE DRIVE • HOUMA, LOUISIANA 70361 • (905) 879-2731
10101 SOUTHWEST FREEWAY • SUITE 400 • HOUSTON, TEXAS 77074 • (713) 218-1470

DRAWN BY: JDW	SHEET: 2
CHKD./APPD. BY: JMH	SCALE: SHOWN
UPDATED BY: CJG	DATE: 11/01/07
DATA BASE: 9580	JOB NO. 9580
MPH CAD FILE: 13604-PD-002.DWG	

W:\eng\9580\002\13604-PD-002.dwg PLOT DATE: 1/11/08 2:12:53pm

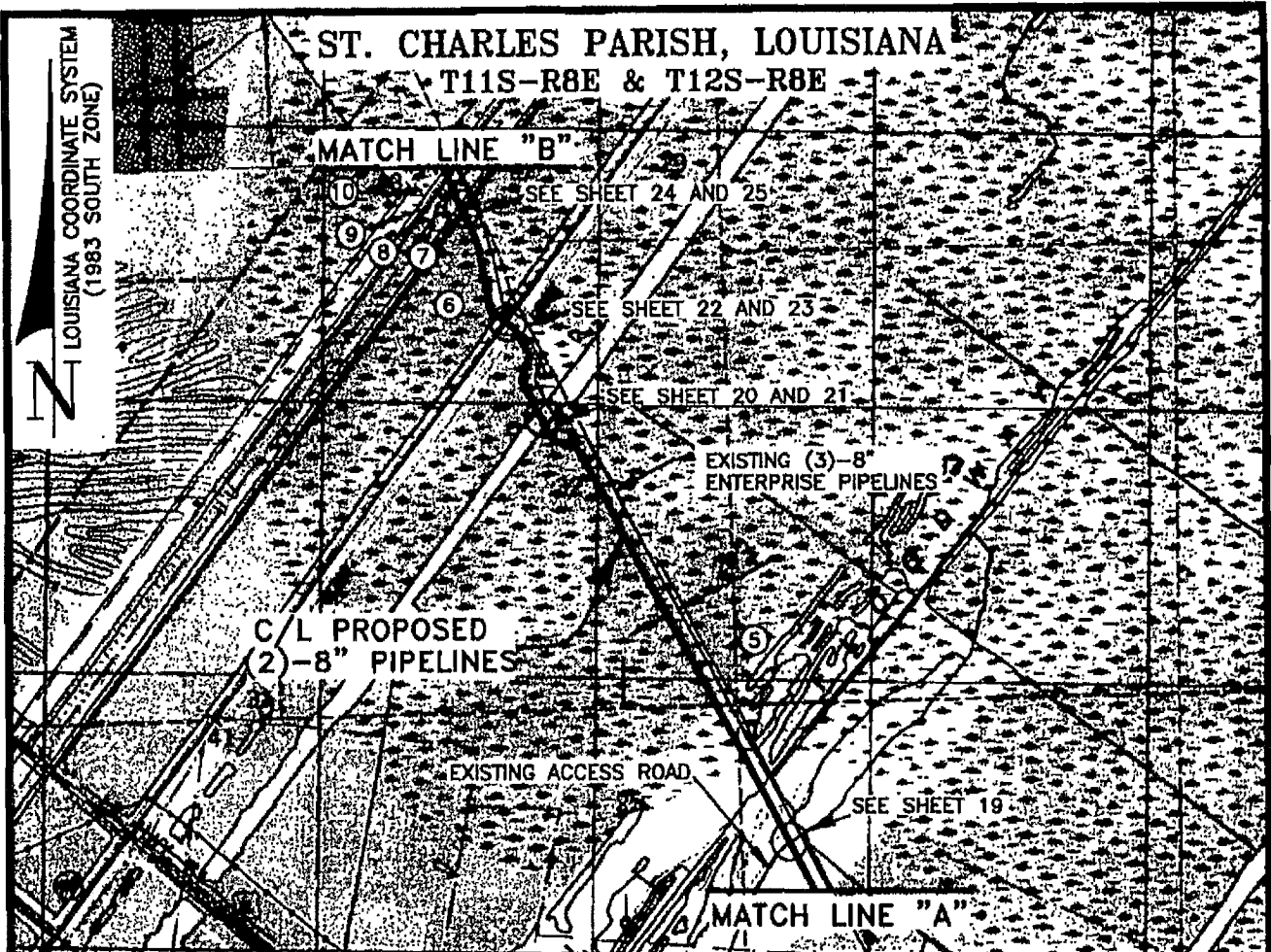

PLAN

AFFECTED LAND OWNERS:

- ⑤ UNITED STATES OF AMERICA
- ⑥ KRISTI GERSTNER SMITH
- ⑦ WAYNE BRODGEN
- ⑧ HARRY L. SHOEMAKER III, ET AL
- ⑨ LOUISE OFFUTT PRESCOTT TREADWAY
- ⑩ ENERGY LOUISIANA INC.

GRAPHIC SCALE



NO.	DATE	REV. BY:	REVISION

SORRENTO PIPELINE COMPANY, LLC

PLAN



Morris P. Hebert, Inc.

SURVEYING • ENGINEERING • ENVIRONMENTAL SERVICES • FIELD SERVICES • GIS
 P.O. BOX 3106 • 283 CORPORATE DRIVE • HOUMA, LOUISIANA 70361 • (985) 879-2731
 10101 SOUTHWEST FREEWAY • SUITE 400 • HOUSTON, TEXAS 77074 • (713) 218-1470

DRAWN BY: JDW	SHEET: 3
CHKD./APPD. BY: JMH	SCALE: SHOWN
UPDATED BY: CJG	DATE: 11/01/07
DATA BASE: 9580	JOB NO. 9580

MPH CAD FILE: 13604-PD-003.DWG

W:\cmap\9580\COE\13604-PD-003.dwg PLOT DATE: 1/17/08 2:16:50pm

ST. CHARLES & ST. JOHN THE BAPTIST PARISH, LOUISIANA

T11S-R8E

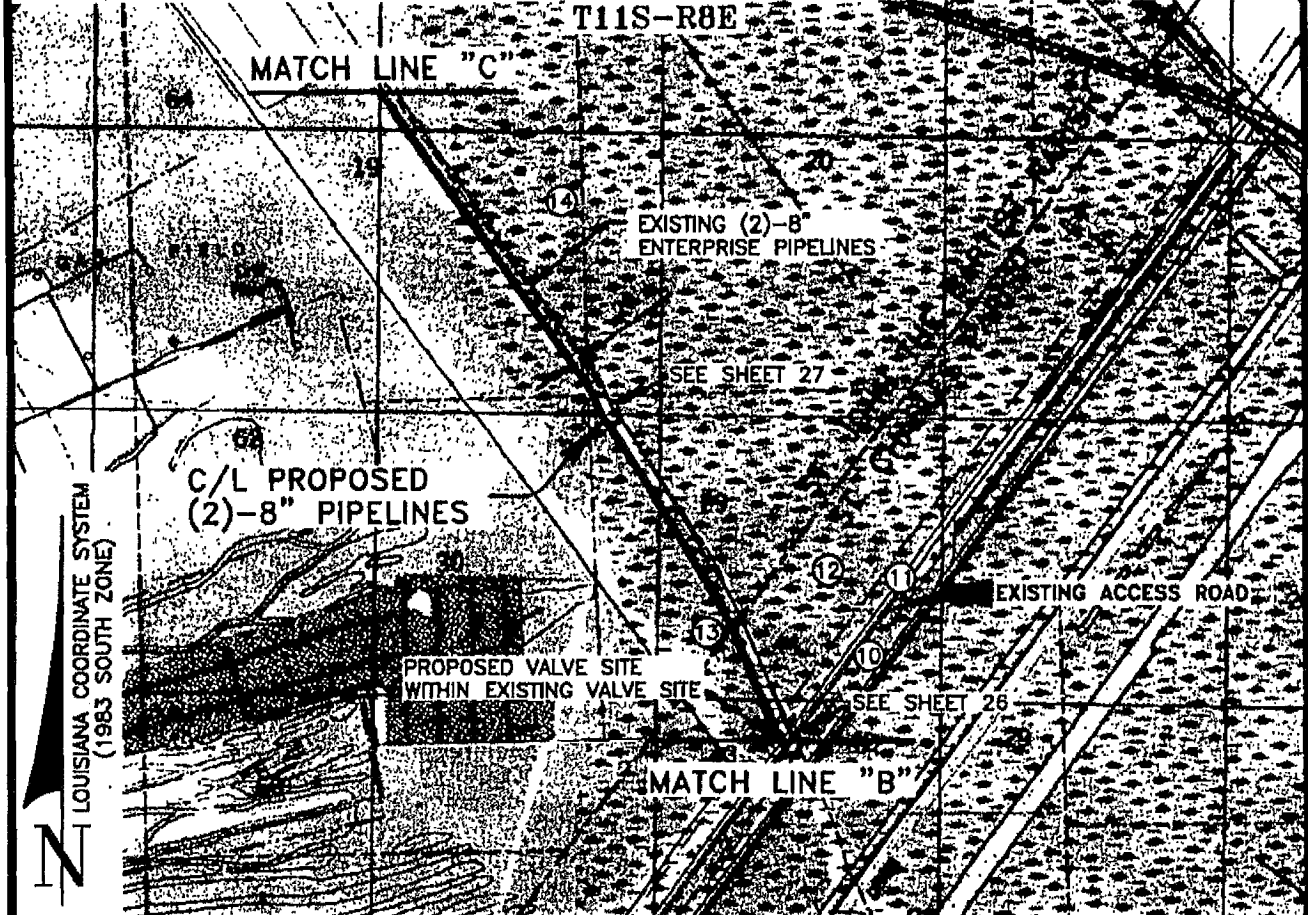

LOUISIANA COORDINATE SYSTEM
(1983 SOUTH ZONE)



PLAN

AFFECTED LAND OWNERS:

- ⑩ ENTERGY LOUISIANA, INC.
- ⑪ CRISTINA & LAURICALLA, INC.
- ⑫ CYPRESS VENTURES LLC & DUHE BROTHERS, LLC.
- ⑬ LA DEPT. OF WILDLIFE & FISHERIES
- ⑭ ROGERS LAND CO, INC.

GRAPHIC SCALE



NO.	DATE	REV. BY:	REVISION

SORRENTO PIPELINE COMPANY, LLC

PLAN



Morris P. Hebert, Inc.

SURVEYING • ENGINEERING • ENVIRONMENTAL SERVICES • FIELD SERVICES • GIS
P.O. BOX 3106 • 283 CORPORATE DRIVE • HOUMA, LOUISIANA 70361 • (985) 879-2751
10101 SOUTHWEST FREEWAY • SUITE 400 • HOUSTON, TEXAS 77074 • (713) 219-1470

DRAWN BY: JDW	SHEET: 4
CHKD./APPD. BY: JMH	SCALE: SHOWN
UPDATED BY: CJG	DATE: 11/01/07
DATA BASE: 9580	JOB NO. 9580

MPH CAD FILE: 13604-PD-004.DWG

W:\dwg\9580\COE\13604-PD-004.dwg PLOT DATE: 1/11/08 2:17:40pm

ST. JOHN THE BAPTIST PARISH, LOUISIANA

T11S-R7E & T11S-R8E

MATCH LINE "D"

EXISTING ACCESS ROAD

SEE SHEET 30

EXISTING ACCESS ROAD

C/L PROPOSED
(2)-8" PIPELINES

EXISTING ACCESS ROAD

SEE SHEET 29

EXISTING ACCESS ROAD

SEE SHEET 28

EXISTING (2)-8"
ENTERPRISE
PIPELINES

NOTE: TEMP. BOARD MATS AS NEEDED ALONG
EXISTING ACCESS ROADS, NO FILL REQUIRED.

MATCH LINE "C"

LOUISIANA COORDINATE SYSTEM
(1983 SOUTH ZONE)

PLAN

AFFECTED LAND OWNERS:

- 15 H.H. WHITE LP., et al
- 16 STATE OF LOUISIANA
- 17 GORDEN GUIDRY, et ux

GRAPHIC SCALE

0 1000' 2000' 4000' 6000'

NO.	DATE	REV. BY:	REVISION
SORRENTO PIPELINE COMPANY, LLC			
PLAN			

SORRENTO PIPELINE COMPANY, LLC

PLAN



Morris P. Hebert, Inc.

SURVEYING • ENGINEERING • ENVIRONMENTAL SERVICES • FIELD SERVICES • GIS
P.O. BOX 3106 • 253 CORPORATE DRIVE • HOUMA, LOUISIANA 70361 • (985) 879-2731
10101 SOUTHWEST FREEWAY • SUITE 400 • HOUSTON, TEXAS 77074 • (713) 218-1470

DRAWN BY: JDW	SHEET: 5
CHKD./APPD. BY: JMH	SCALE: SHOWN
UPDATED BY: CJG	DATE: 11/01/07
DATA BASE: 9580	JOB NO. 9580

MPH CAD FILE: 13604-PD-005.DWG

W:\dwg\9580\COE\13604-PD-005.dwg PLOT DATE: 1/11/08 2:19:22pm

ST. JOHN THE BAPTIST PARISH, LOUISIANA
T11S-R7E

LOUISIANA COORDINATE SYSTEM
(1983 SOUTH ZONE)

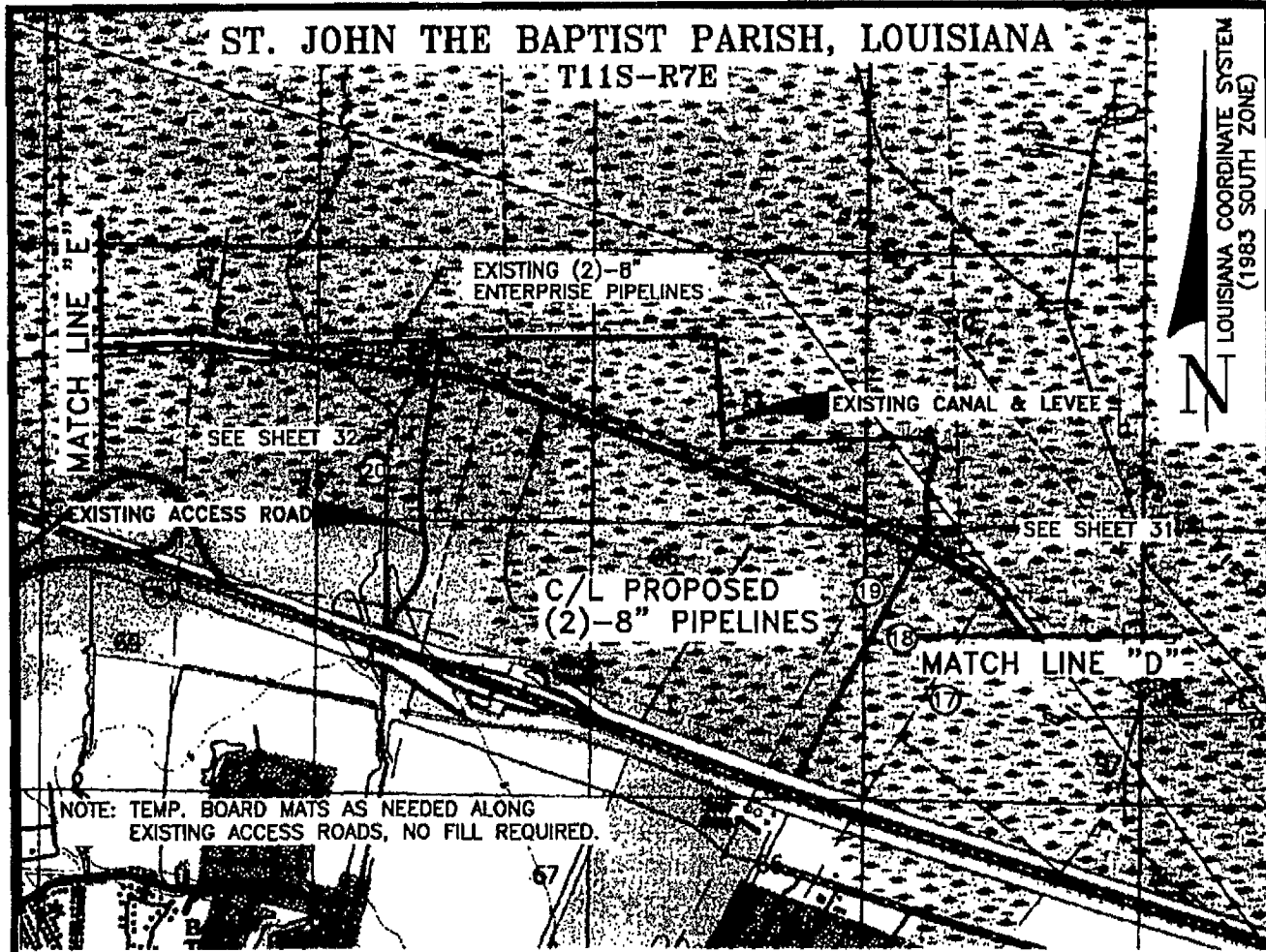

PLAN

AFFECTED LAND OWNERS:

- (17) GORDON L. GUIDRY, et ux
- (18) DOWIE GENDRON, et al
- (19) CLARA VICKNAIR ANCALE, et al
- (20) BELLE TERRE HOLDINGS, L.L.C.

GRAPHIC SCALE



NO.	DATE	REV. BY:	REVISION

SORRENTO PIPELINE COMPANY, LLC

PLAN



Morris P. Hebert, Inc.

SURVEYING • ENGINEERING • ENVIRONMENTAL SERVICES • FIELD SERVICES • GIS
P.O. BOX 3108 • 283 CORPORATE DRIVE • HOUMA, LOUISIANA 70381 • (985) 879-2731
10101 SOUTHWEST FREEWAY • SUITE 400 • HOUSTON, TEXAS 77074 • (713) 219-1470

DRAWN BY: JDW	SHEET: 6
CHKD./APPD. BY: JMH	SCALE: SHOWN
UPDATED BY: CJG	DATE: 11/01/07
DATA BASE: 9580	JOB NO. 9580

MPH CAD FILE: 13604-PD-006.DWG

W:\eng\9580\COE\13604-PD-006.dwg PLOT DATE: 1/11/08 2:20:05pm

LOUISIANA COORDINATE SYSTEM
(1983 SOUTH ZONE)

ST. JOHN THE BAPTIST PARISH, LOUISIANA
T11S-R7E

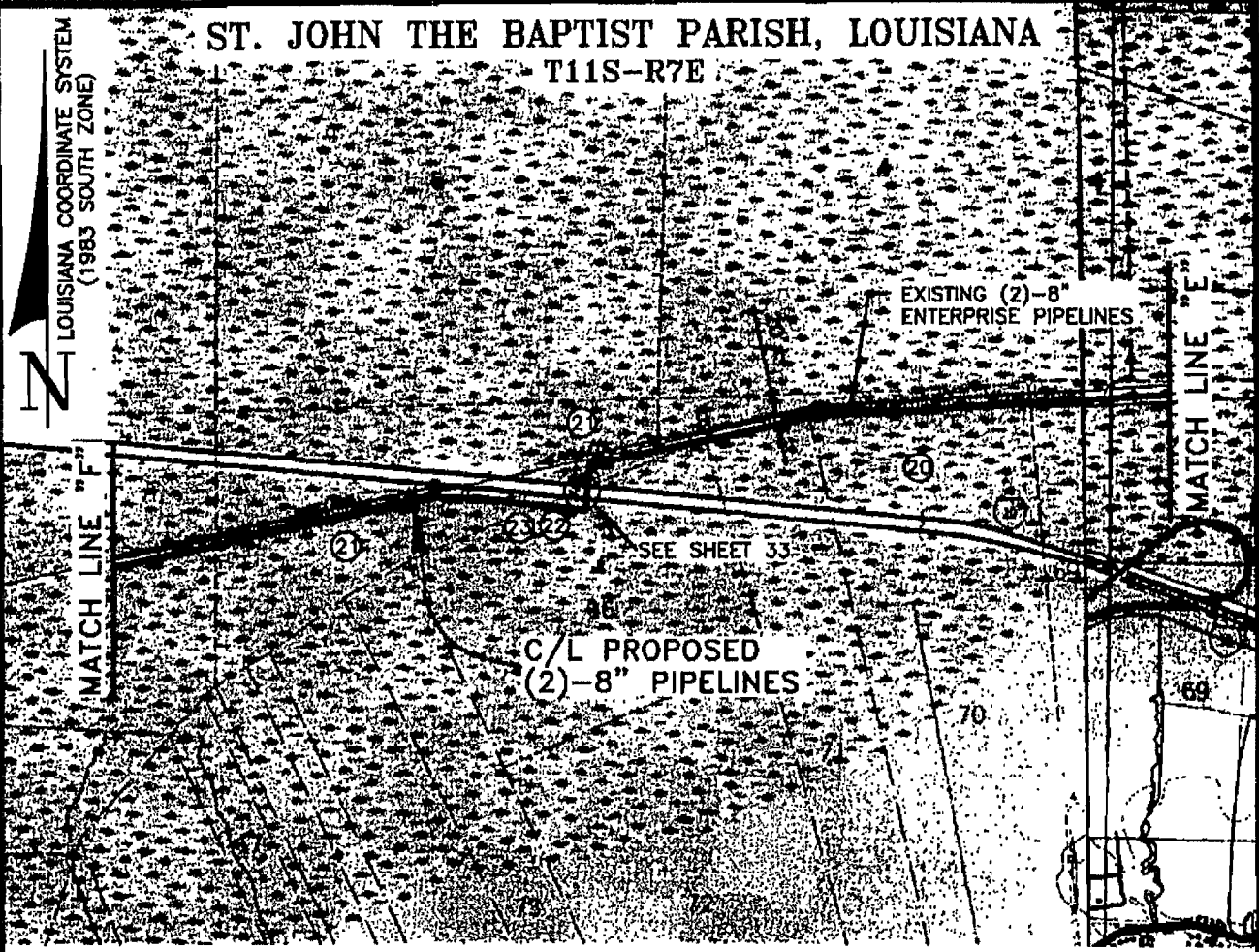

PLAN

AFFECTED LAND OWNERS:

- 20 BELLE TERRE HOLDING, L.L.C.
- 21 NATURE LAND COMPANY, L.L.C.
- 22 STATE OF LOUISIANA DOTD (I-10)
- 23 FRANK MANUEL CHALAIRE, M.D., et ux



NO.	DATE	REV. BY:	REVISION

SORRENTO PIPELINE COMPANY, LLC

PLAN

Morris P. Hebert, Inc.
SURVEYING • ENGINEERING • ENVIRONMENTAL SERVICES • FIELD SERVICES • GIS
P.O. BOX 3108 • 283 CORPORATE DRIVE • HOUMA, LOUISIANA 70361 • (985) 879-2731
10101 SOUTHWEST FREEWAY • SUITE 400 • HOUSTON, TEXAS 77074 • (713) 219-1470

DRAWN BY: JDW	SHEET: 7
CHKD./APPD. BY: JMH	SCALE: SHOWN
UPDATED BY: CJG	DATE: 11/01/07
DATA BASE: 9580	JOB NO. 9580
MPH CAD FILE: 13604-PD-007.DWG	

W:\dwg\9580\COE\13604-PD-007.dwg PLOT DATE: 1/11/08 2:20:47pm

ST. JOHN THE BAPTIST PARISH, LOUISIANA
T11S-R7E & T11S-R6E

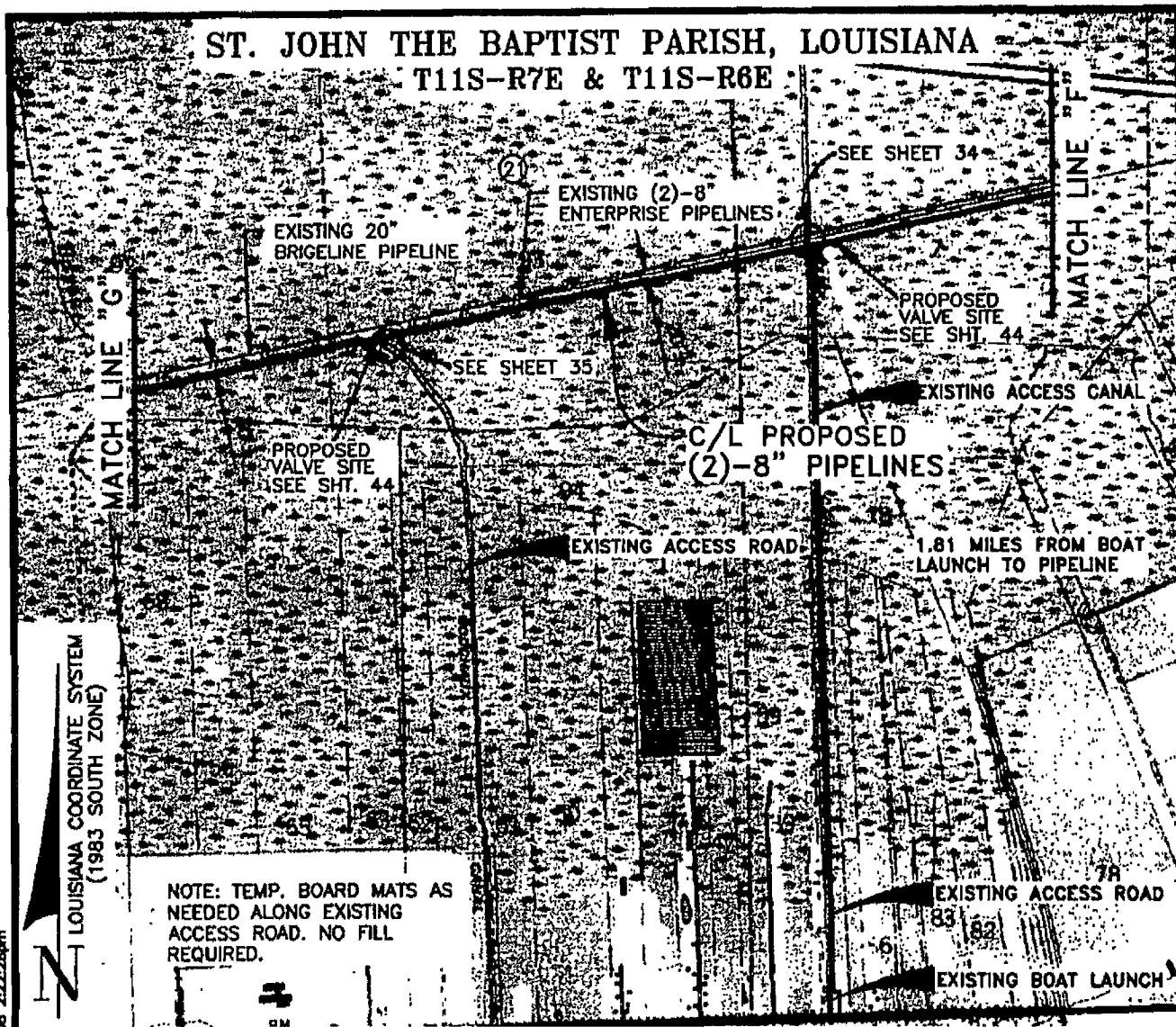

AFFECTED LAND OWNERS:

① NATURE LAND COMPANY, L.L.C.

PLAN

GRAPHIC SCALE



NO.	DATE	REV. BY:	REVISION

SORRENTO PIPELINE COMPANY, LLC

PLAN



Morris P. Hebert, Inc.

SURVEYING • ENGINEERING • ENVIRONMENTAL SERVICES • FIELD SERVICES • GIS
P.O. BOX 3106 • 283 CORPORATE DRIVE • HOUMA, LOUISIANA 70361 • (985) 879-2731
10101 SOUTHWEST FREEWAY • SUITE 400 • HOUSTON, TEXAS 77074 • (713) 210-1470

DRAWN BY: CJG	SHEET: 8
CHKD./APPD. BY: JMH	SCALE: SHOWN
UPDATED BY: CJG	DATE: 11/02/07
DATA BASE: 9580	JOB NO. 9580

MPH CAD FILE: 13604-PD-008.DWG

W:\eng\9580\008\13604-PD-008.dwg PLOT DATE: 1/11/08 2:22:22pm

ST. JOHN THE BAPTIST PARISH, LOUISIANA

T11S-R6E

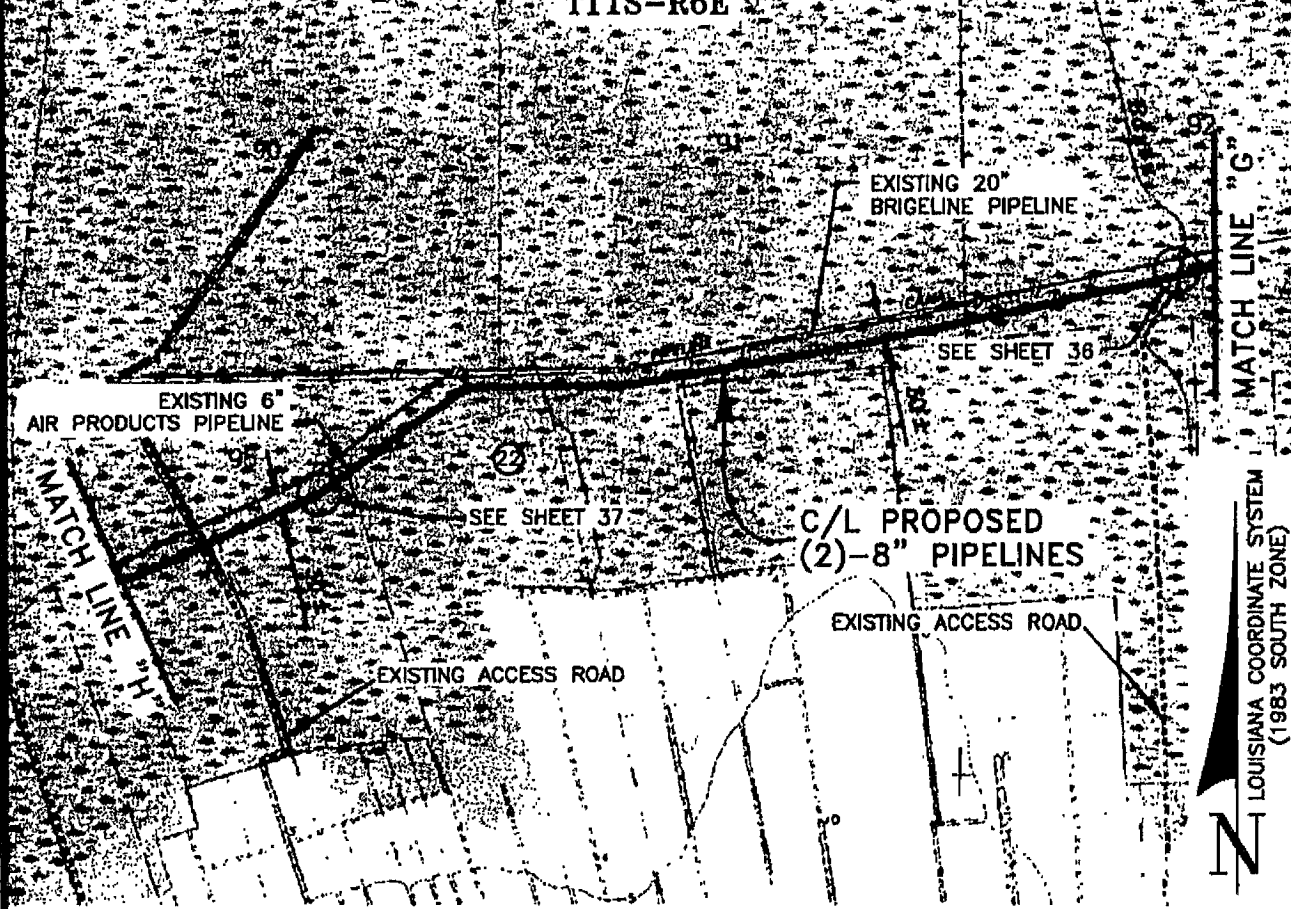

AFFECTED LAND OWNERS:

- ② MARATHON ASHLAND PETROLEUM, L.L.C.

PLAN

GRAPHIC SCALE



NO.	DATE	REV. BY:	REVISION

SORRENTO PIPELINE COMPANY, LLC

PLAN



Morris P. Hebert, Inc.

SURVEYING • ENGINEERING • ENVIRONMENTAL SERVICES • FIELD SERVICES • GIS
 P.O. BOX 3106 • 283 CORPORATE DRIVE • HOUMA, LOUISIANA 70361 • (855) 879-2731
 10101 SOUTHWEST FREEWAY • SUITE 400 • HOUSTON, TEXAS 77074 • (713) 219-1470

DRAWN BY: JDW	SHEET: 9
CHKD./APPD. BY: JMH	SCALE: SHOWN
UPDATED BY: CJG	DATE: 11/01/07
DATA BASE: 9580	JOB NO. 9580

MPH CAD FILE: 13604-PD-009.DWG

W:\mg\9580\COE\13604-PD-009.dwg PLOT DATE: 1/11/08 2:23:27pm

ST. JOHN THE BAPTIST PARISH, LOUISIANA

T11S-R6E

LOUISIANA COORDINATE SYSTEM
(1983 SOUTH ZONE)

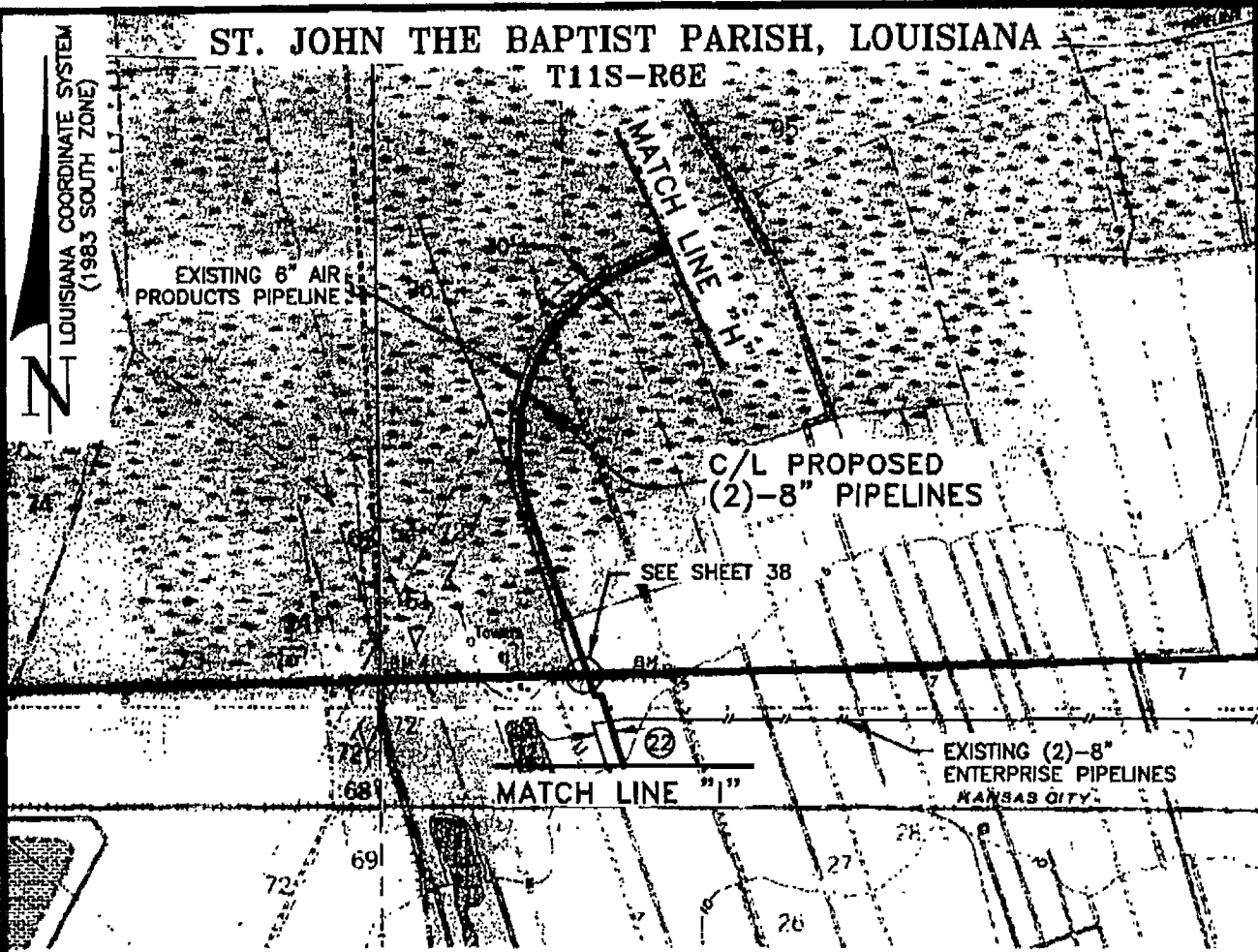

PLAN

AFFECTED LAND OWNERS:

- ② MARATHON-ASHLAND PETROLEUM, L.L.C.

GRAPHIC SCALE



NO.	DATE	REV. BY:	REVISION

SORRENTO PIPELINE COMPANY, LLC

PLAN



Morris P. Hebert, Inc.

SURVEYING • ENGINEERING • ENVIRONMENTAL SERVICES • FIELD SERVICES • GIS
P.O. BOX 3108 • 283 CORPORATE DRIVE • HOUMA, LOUISIANA 70361 • (888) 879-2731
10101 SOUTHWEST FREEWAY • SUITE 400 • HOUSTON, TEXAS 77074 • (713) 219-1470

DRAWN BY: JDW	SHEET: 10
CHKD./APPD. BY: JMH	SCALE: SHOWN
UPDATED BY: CJG	DATE: 11/01/07
DATA BASE: 9580	JOB NO. 9580

MPH CAD FILE: 13804-PD-010.DWG

W:\cwg\9580\COE\13804-PD-010.dwg PLOT DATE: 1/11/08 2:24:00pm

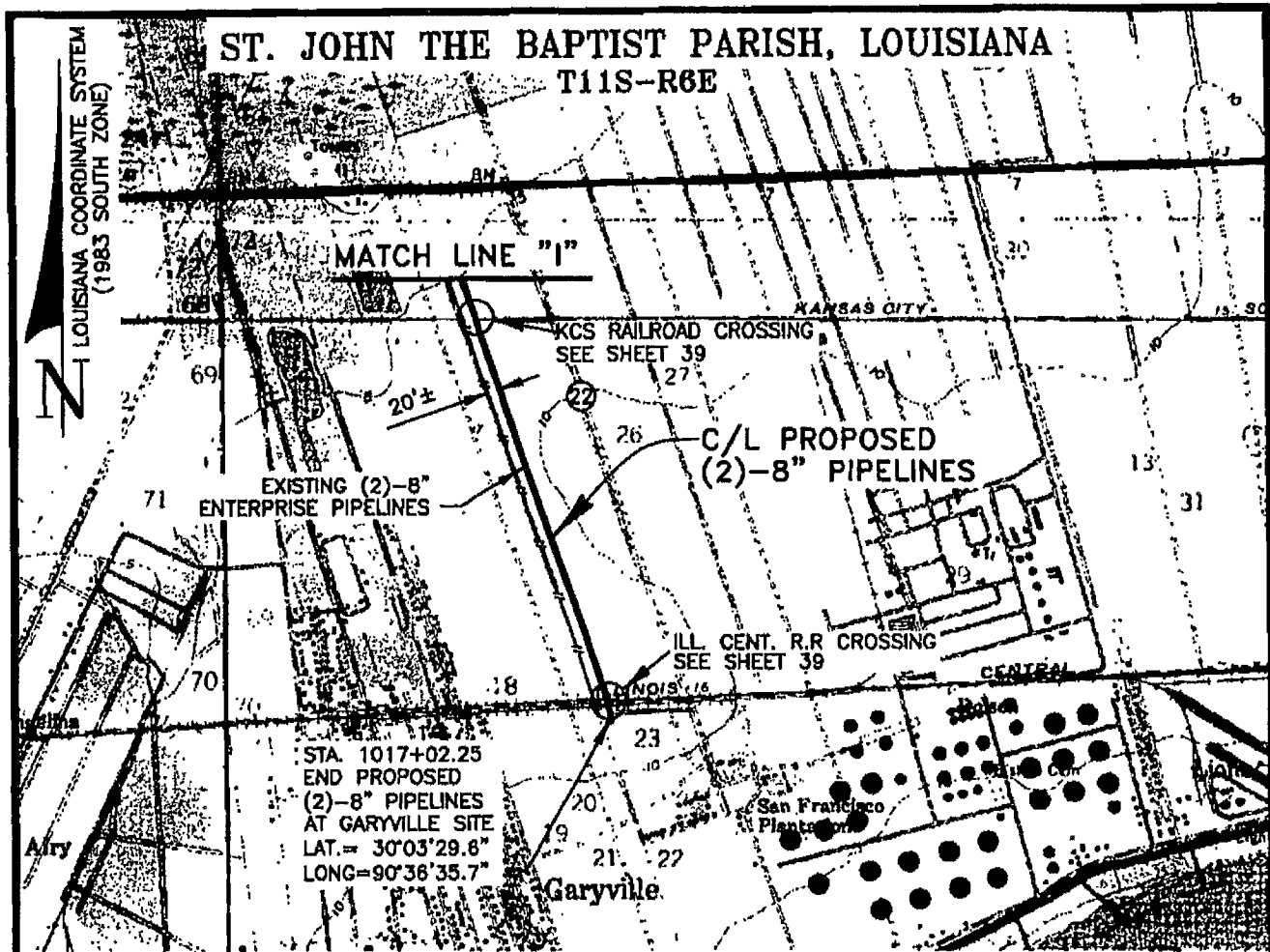

STA. 1017+02.25
 END PROPOSED
 (2)-8" PIPELINES
 AT GARYVILLE SITE
 LAT. = 30°03'29.8"
 LONG = 90°36'35.7"

PLAN

AFFECTED LAND OWNERS:

- ② MARATHON-ASHLAND PETROLEUM, L.L.C.



NO.	DATE	REV. BY	REVISION

SORRENTO PIPELINE COMPANY, LLC

PLAN

Morris P. Hebert, Inc.
 SURVEYING • ENGINEERING • ENVIRONMENTAL SERVICES • FIELD SERVICES • GIS
 P.O. BOX 3106 • 283 CORPORATE DRIVE • HOUMA, LOUISIANA 70361 • (985) 879-2731
 10101 SOUTHWEST FREEWAY • SUITE 400 • HOUSTON, TEXAS 77074 • (713) 219-1470

DRAWN BY: JDW	SHEET: 11
CHKD./APPD. BY: JMH	SCALE: SHOWN
UPDATED BY: CJG	DATE: 11/01/07
DATA BASE: 9580	JOB NO. 9580
MPH CAD FILE: 13604-PD-011.DWG	

W:\dwg\9580\COE\13604-PD-011.dwg PLOT DATE: 1/11/08 2:24:35pm

ST. CHARLES PARISH, LOUISIANA
SECTION 21, T12S-R8E

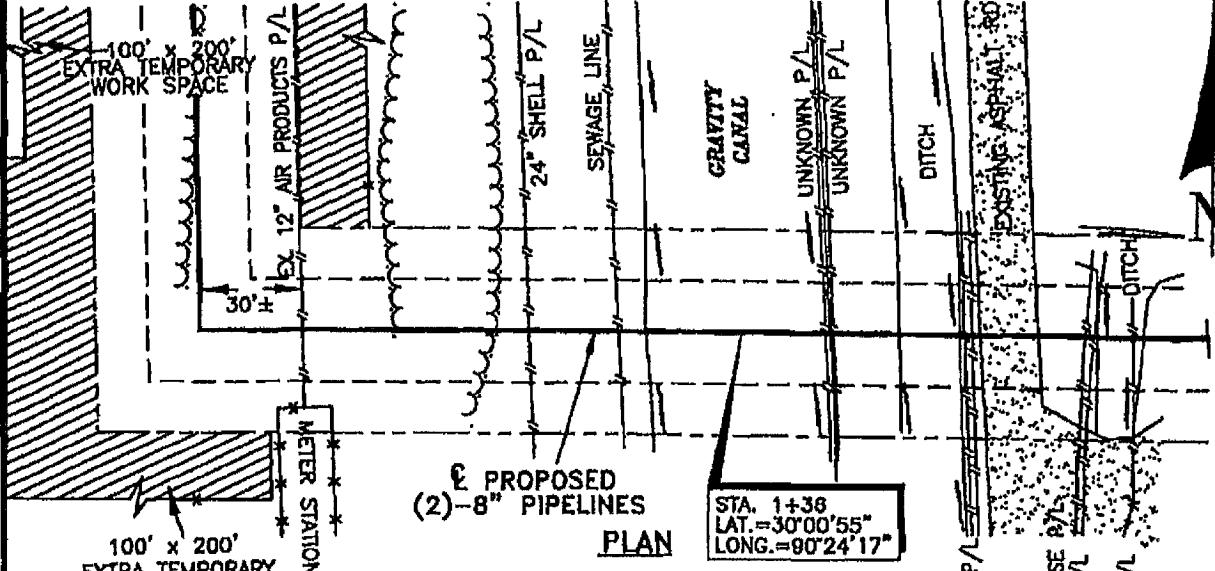

LOUISIANA COORDINATE SYSTEM
(1983 SOUTH ZONE)



SEE SHEET 13 FOR
EXTRA WORKSPACE
AND RIGHT-OF-WAY
INFORMATION

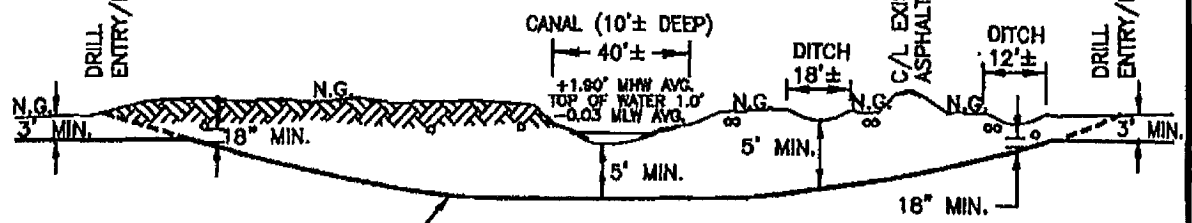

W:\dwg\9580\COE\13604-PD-012.dwg PLOT DATE: 1/24/08 2:42:58pm

NO.	DATE	REV. BY	REVISION
-----	------	---------	----------

SORRENTO PIPELINE COMPANY, LLC

DETAIL PLAN & PROFILE

MPH
Morris P. Hebert, Inc.

SURVEYING • ENGINEERING • ENVIRONMENTAL SERVICES • FIELD SERVICES • GIS
P.O. BOX 3108 • 283 CORPORATE DRIVE • HOLMA, LOUISIANA 70341 • (866) 679-2731
10101 SOUTHWEST FREEDWAY • SUITE 400 • HOUSTON, TEXAS 77074 • (713) 218-1470

DRAWN BY: JDW	SHEET: 12
CHKD./APPD. BY: JMH	SCALE: SHOWN
UPDATED BY: MAS	DATE: 11/01/07
DATA BASE: 9580	JOB NO. 9580
MPH CAD FILE: 13604-PD-012.DWG	

ST. CHARLES PARISH, LOUISIANA
SECTION 21, T12S-R8E

LOUISIANA COORDINATE SYSTEM
(1983 SOUTH ZONE)

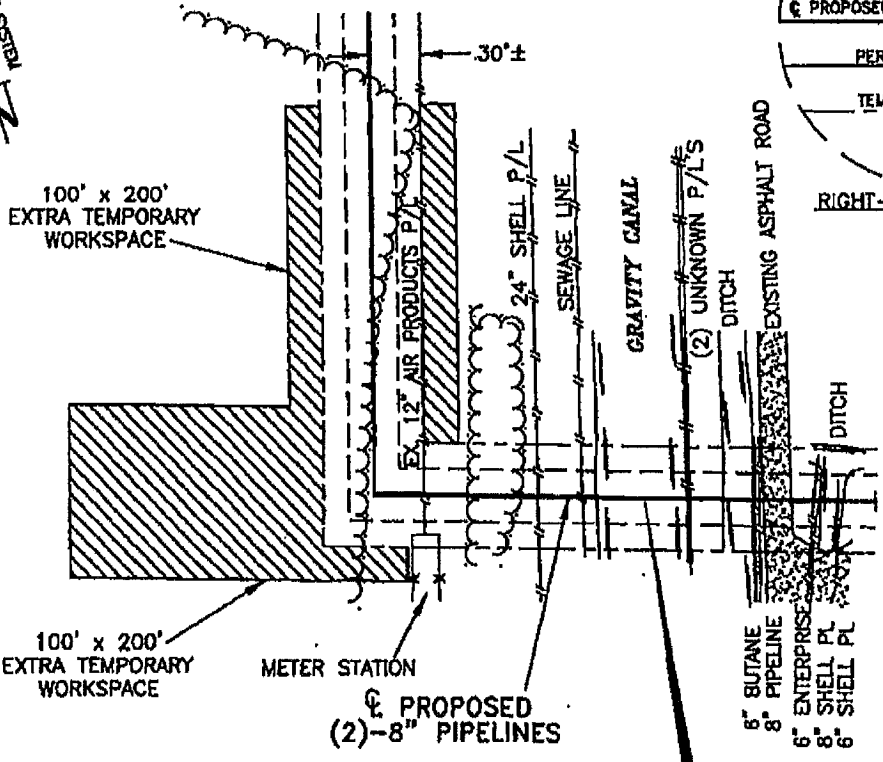
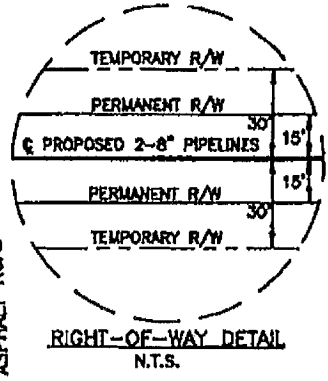

100' x 200'
EXTRA TEMPORARY
WORKSPACE

100' x 200'
EXTRA TEMPORARY
WORKSPACE

EXTRA TEMPORARY WORKSPACES IMPACTED
FORESTED UPLAND = 0.45 ACRES

STA. 1+36
LAT. = 30°00'55"
LONG. = 90°24'17"

PLAN

GRAPHIC SCALE



W:\dwg\9580\COE\13604-PD-013.dwg PLOT DATE: 12/21/07 4:49:00am

NO.	DATE	REV. BY:	REVISION

SORRENTO PIPELINE COMPANY, LLC

DETAIL PLAN



Morris P. Hebert, Inc.
SURVEYING • ENGINEERING • ENVIRONMENTAL SERVICES • FIELD SERVICES • GIS
P.O. BOX 3106 • 283 CORPORATE DRIVE • HOUMA, LOUISIANA 70361 • (845) 879-2751
10101 SOUTHWEST FREEWAY • SUITE 400 • HOUSTON, TEXAS 77074 • (713) 219-1470

DRAWN BY: JDW	SHEET: 13
CHKD./APPD. BY: JMH	SCALE: SHOWN
UPDATED BY: KOT	DATE: 11/01/07
DATA BASE: 9580	JOB NO. 9580
MPH CAD FILE: 13604-PD-013.DWG	

**ST. CHARLES PARISH, LOUISIANA
SECTION 21, T12S-R8E**

LOUISIANA COORDINATE SYSTEM
(1983 SOUTH ZONE)

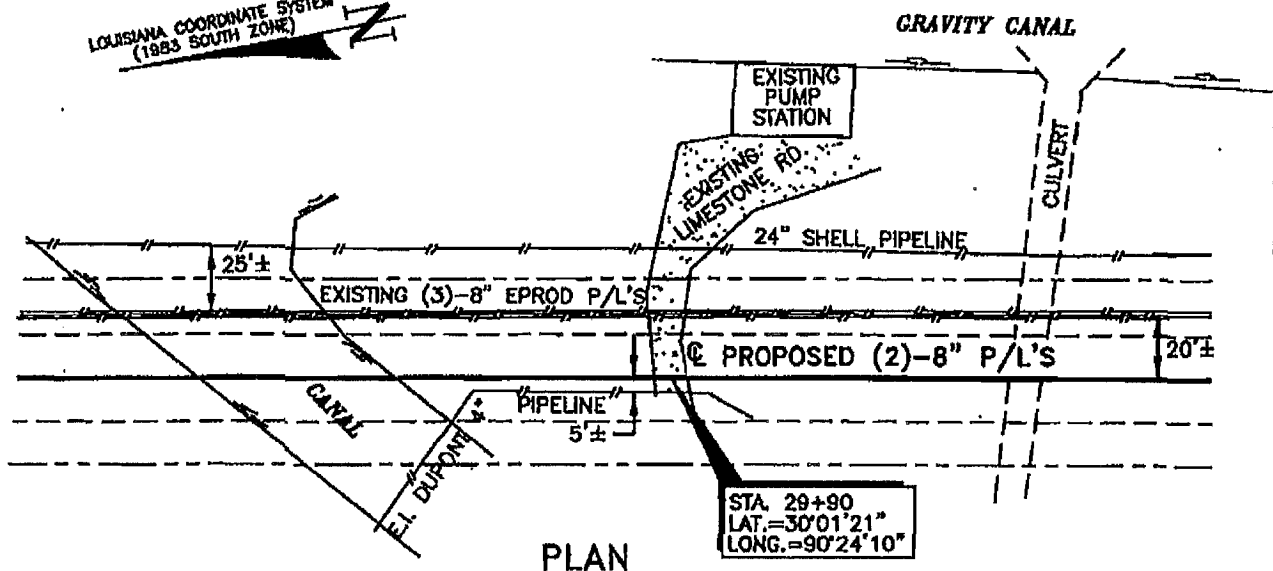

PLAN
GRAPHIC SCALE

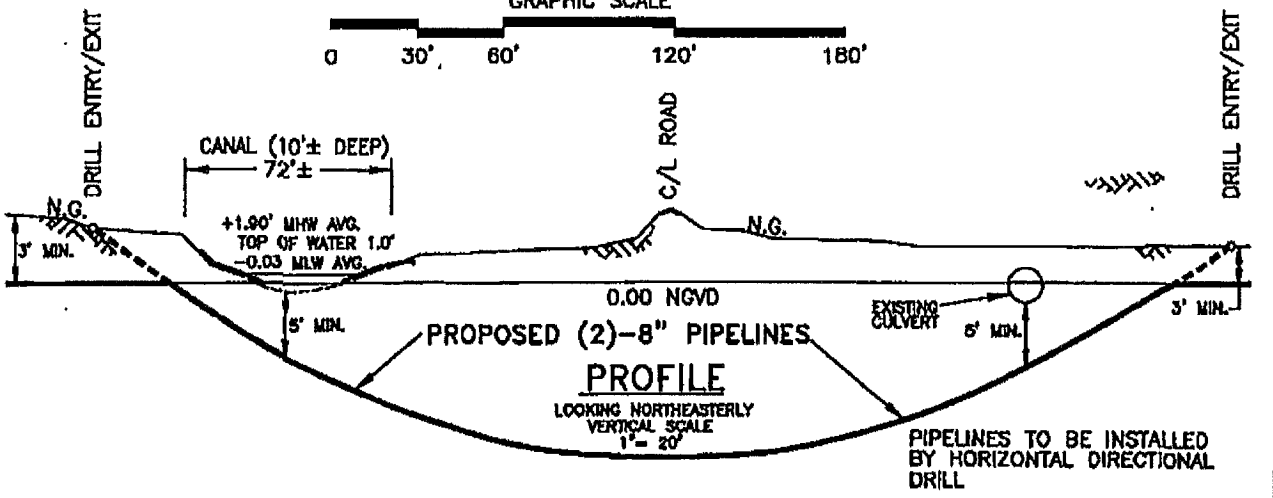

PROFILE
LOOKING NORTHEASTERLY
VERTICAL SCALE
1" = 20'

PIPELINES TO BE INSTALLED
BY HORIZONTAL DIRECTIONAL
DRILL

W:\dwg\9580\COE\13604-PD-014.dwg PLOT DATE: 1/24/08 3:17:17pm

NO.	DATE	REV. BY:	REVISION

SORRENTO PIPELINE COMPANY, LLC

DETAIL PLAN & PROFILE

Morris P. Hebert, Inc.
SURVEYING • ENGINEERING • ENVIRONMENTAL SERVICES • FIELD SERVICES • GIS
P.O. BOX 3106 • 283 CORPORATE DRIVE • HOLMA, LOUISIANA 70361 • (504) 879-2731
19101 SOUTHWEST FREEWAY • SUITE 400 • HOUSTON, TEXAS 77074 • (713) 219-1470

DRAWN BY: JOW	SHEET: 14
CHKD./APPD. BY: JMH	SCALE: SHOWN
UPDATED BY: DPM	DATE: 11/01/07
DATA BASE: 9580	JOB NO. 9580
MPH CAD FILE: 13604-PD-014.DWG	

ST. CHARLES PARISH, LOUISIANA
SECTION 21, T12S-R8E

LOUISIANA COORDINATE SYSTEM
(1983 SOUTH ZONE)

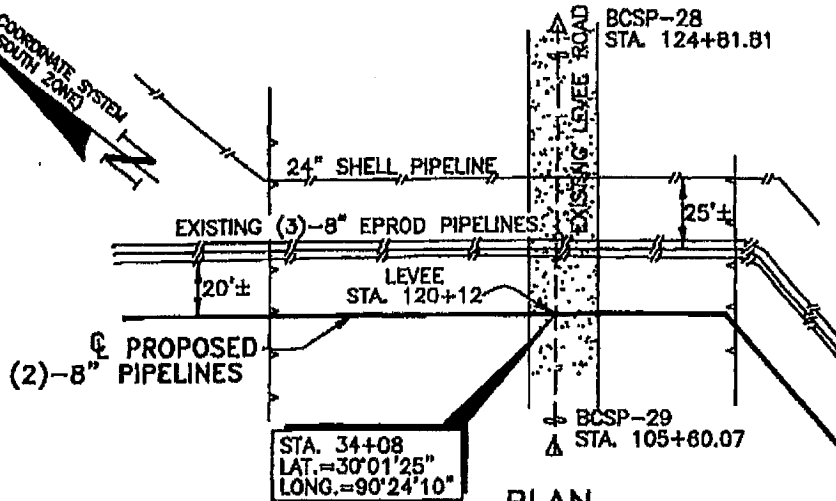

PLAN

GRAPHIC SCALE



SEE SHEET 16 FOR
EXTRA WORKSPACE
AND RIGHT-OF-WAY
INFORMATION

LOWER GUIDE LEVEE

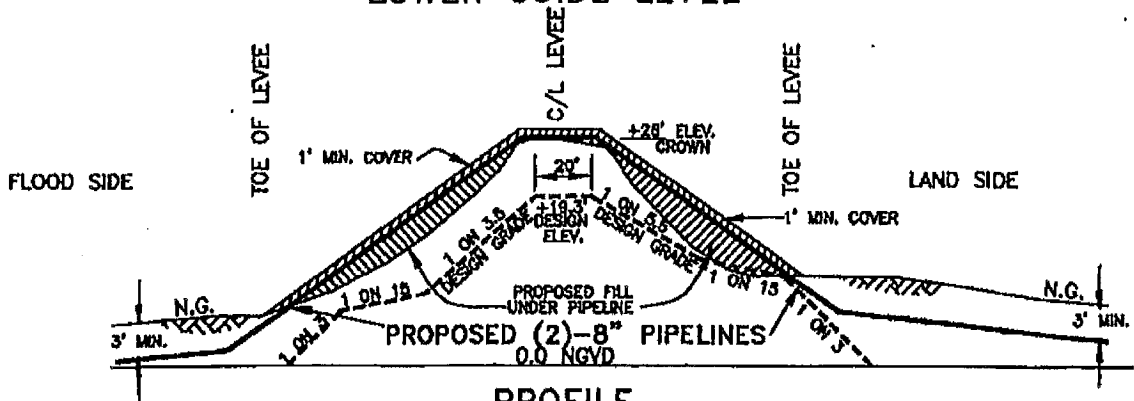

PROFILE

LOOKING NORTHEASTERLY
VERTICAL SCALE
1" = 20'

I:\eng\9580\COE\13804-PD-015.dwg PLOT DATE: 12/20/07 5:59:22pm

NO.	DATE	REV. BY:	REVISION

SORRENTO PIPELINE COMPANY, LLC

DETAIL PLAN & PROFILE



Morris P. Hebert, Inc.

SURVEYING • ENGINEERING • ENVIRONMENTAL SERVICES • FIELD SERVICES • GIS
P.O. BOX 3104 • 283 CORPORATE DRIVE • HOUMA, LOUISIANA 70361 • (905) 879-2731
10101 SOUTHWEST FREEWAY • SUITE 400 • HOUSTON, TEXAS 77074 • (713) 219-1470

DRAWN BY: JDW	SHEET: 15
CHKD./APPD. BY: JMH	SCALE: SHOWN
UPDATED BY: KDT	DATE: 11/01/07
DATA BASE: 9580	JOB NO. 9580
MPH CAD FILE: 13804-PD-015.DWG	

ST. CHARLES PARISH, LOUISIANA
SECTION 21, T12S-R8E

LOUISIANA COORDINATE SYSTEM
(2011 SOUTH ZONE)

APPROX. LOCATION (NOT FOUND)
4" BUCKET PIPELINE

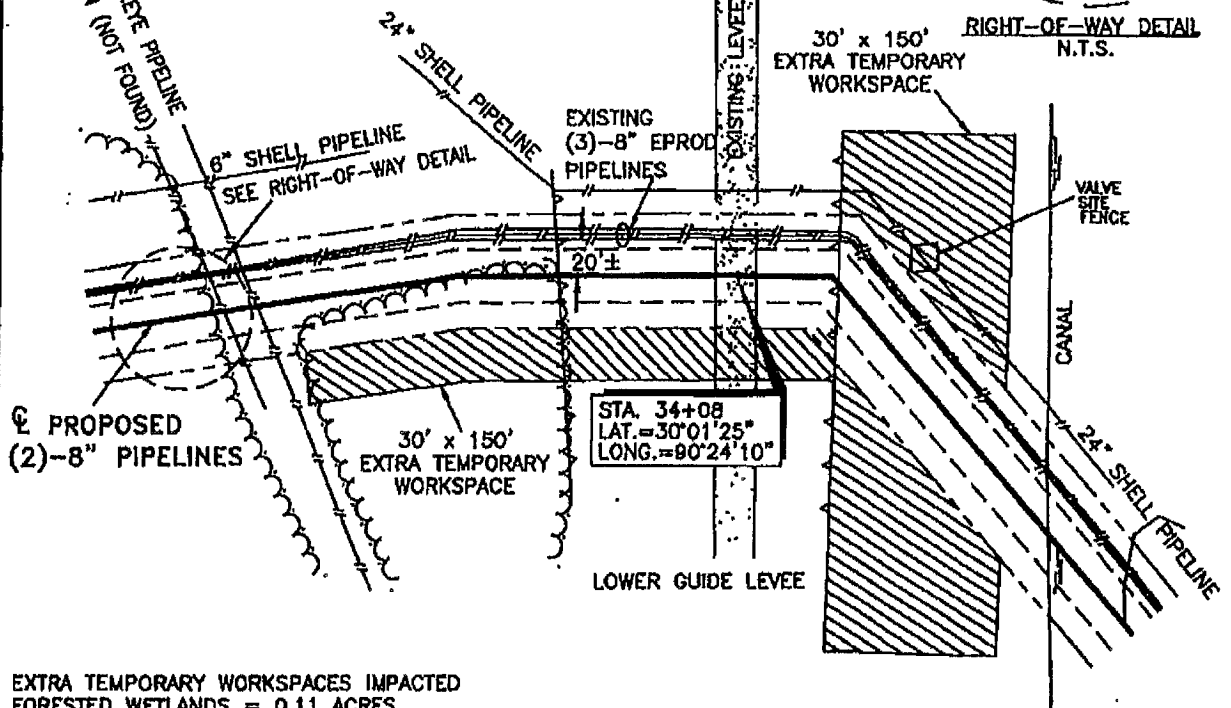
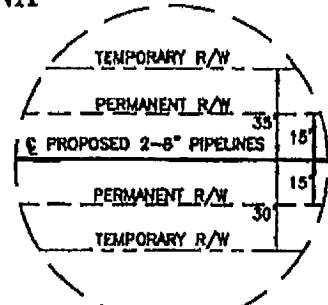

EXTRA TEMPORARY WORKSPACES IMPACTED
FORESTED WETLANDS = 0.11 ACRES

EXTRA TEMPORARY WORKSPACES IMPACTED
HERBACEOUS UPLANDS = 0.26 ACRES

PLAN

GRAPHIC SCALE



NO.	DATE	REV. BY:	REVISION

SORRENTO PIPELINE COMPANY, LLC

DETAIL PLAN

Morris P. Hebert, Inc.
SURVEYING • ENGINEERING • ENVIRONMENTAL SERVICES • FIELD SERVICES • GIS
P.O. BOX 3106 • 283 CORPORATE DRIVE • HOUMA, LOUISIANA 70361 • (888) 679-2731
10101 SOUTHWEST FREEWAY • SUITE 400 • HOUSTON, TEXAS 77074 • (713) 219-1470

DRAWN BY: JDW	SHEET: 16
CHKD./APPD. BY: JMH	SCALE: SHOWN
UPDATED BY: KDT	DATE: 11/01/07
DATA BASE: 9580	JOB NO. 9580
MPH CAD FILE: 13804-PD-016.DWG	

W:\dwp\9580\COE\13804-PD-016.dwg PLOT DATE: 12/21/07 4:47:52am

ST. CHARLES PARISH, LOUISIANA
SECTION 21, T12S-R8E

LOUISIANA COORDINATE SYSTEM
(1883 SOUTH ZONE)

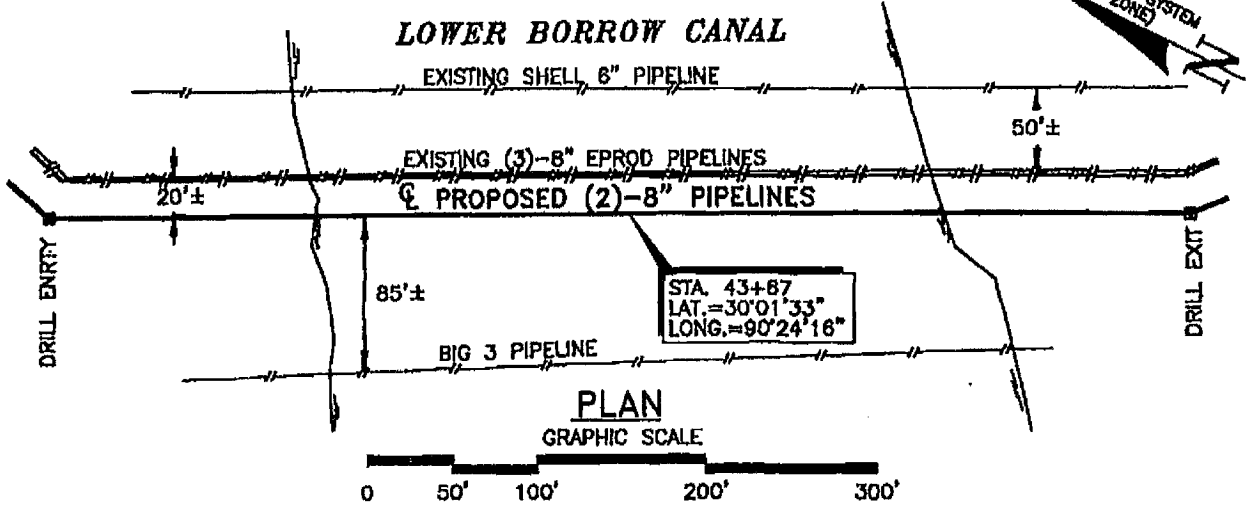

SEE SHEET 18 FOR EXTRA WORKSPACE
AND RIGHT-OF-WAY INFORMATION

LOWER BORROW CANAL

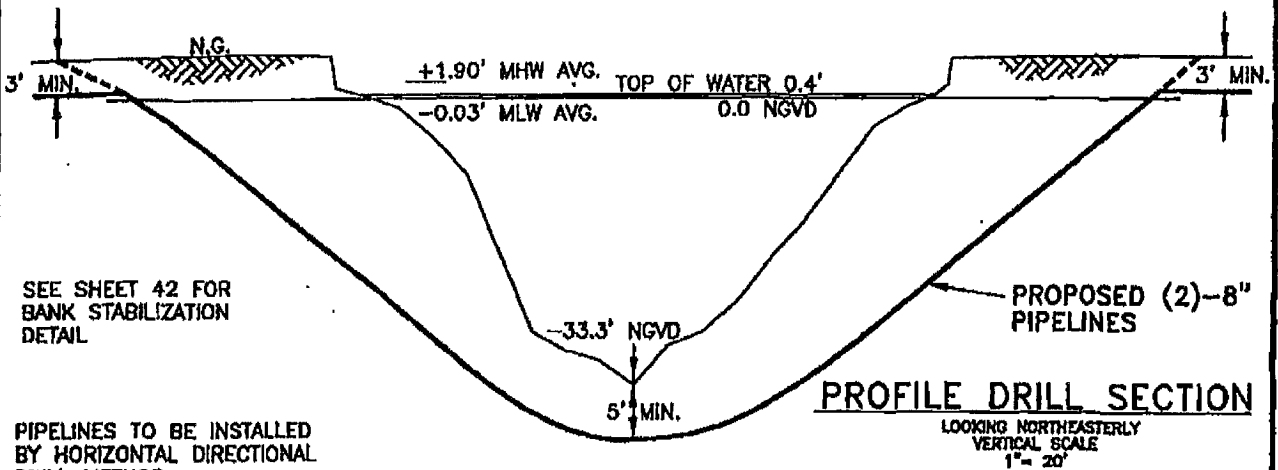

SEE SHEET 42 FOR
BANK STABILIZATION
DETAIL

PIPELINES TO BE INSTALLED
BY HORIZONTAL DIRECTIONAL
DRILL METHOD.

W:\eng\9580\COE\13804-PD-017.dwg PLOT DATE 1/8/08 9:39:52am

NO.	DATE	REV. BY	REVISION

SORRENTO PIPELINE COMPANY, LLC

DETAIL PLAN & PROFILE

Morris P. Hebert, Inc.
 SURVEYING • ENGINEERING • ENVIRONMENTAL SERVICES • FIELD SERVICES • GIS
 P.O. BOX 3168 • 283 CORPORATE DRIVE • HOLMA, LOUISIANA 70361 • (866) 879-2731
 10101 SOUTHWEST FREeway • SUITE 400 • HOUSTON, TEXAS 77074 • (713) 219-1470

DRAWN BY: JDW	SHEET: 17
CHKD./APPD. BY: JMH	SCALE: SHOWN
UPDATED BY: KOT	DATE: 11/01/07
DATA BASE: 9580	JOB NO. 9580
MPH CAD FILE: 13804-PD-017.DWG	

ST. CHARLES PARISH, LOUISIANA
SECTION 21, T12S-R8E

LOUISIANA COORDINATE SYSTEM
(1983 SOUTH ZONE)

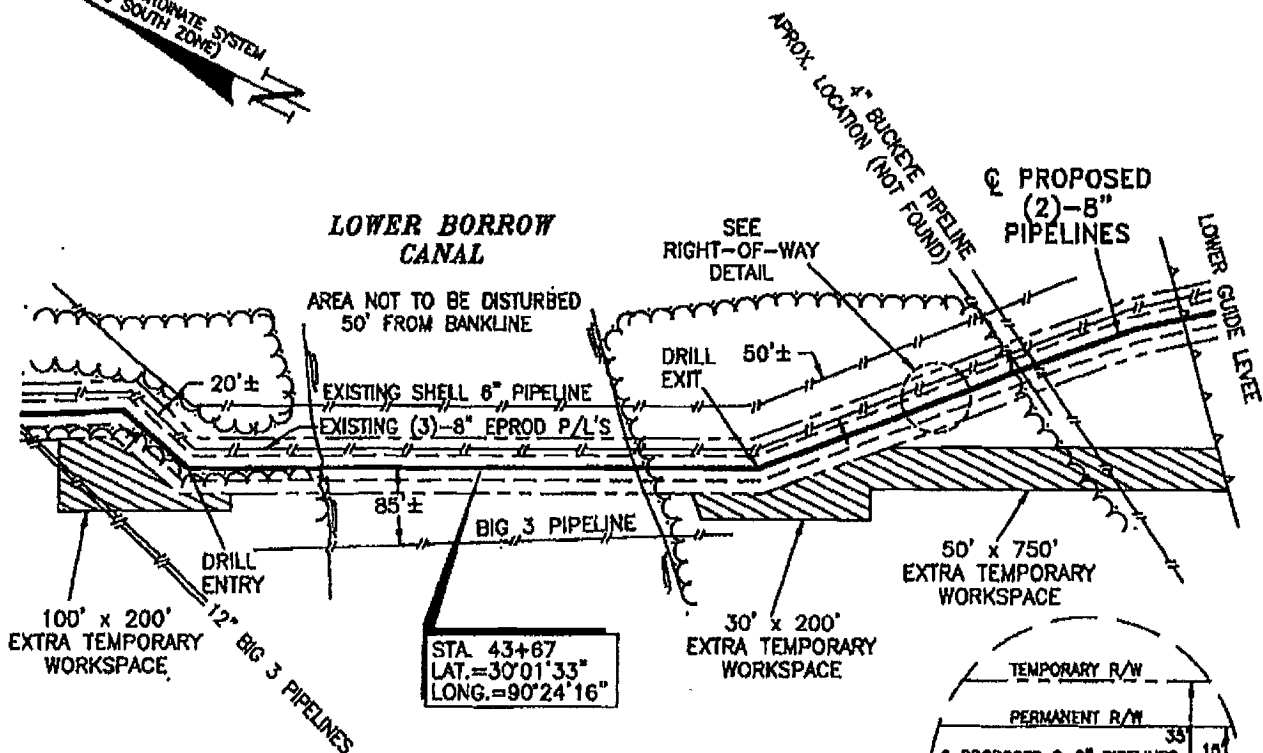

PLAN

EXTRA TEMPORARY WORKSPACES IMPACTED FORESTED WETLANDS = 0.74 ACRES

EXTRA TEMPORARY WORKSPACES IMPACTED HERBACEOUS UPLANDS = 0.19 ACRES



W:\dwg\9580\COE\13604-PD-018.dwg PLOT DATE: 12/21/07 4:46:04pm

NO.	DATE	REV. BY:	REVISION

SORRENTO PIPELINE COMPANY, LLC

DETAIL PLAN

Morris P. Hebert, Inc.
SURVEYING • ENGINEERING • ENVIRONMENTAL SERVICES • FIELD SERVICES • GIS
P.O. BOX 3108 • 283 CORPORATE DRIVE • HOUMA, LOUISIANA 70361 • (985) 878-2731
10101 SOUTHWEST FREEWAY • SUITE 400 • HOUSTON, TEXAS 77074 • (713) 219-1470

DRAWN BY: JDW	SHEET: 18
CHKD./APPD. BY: JMH	SCALE: SHOWN
UPDATED BY: KDT	DATE: 11/01/07
DATA BASE: 9580	JOB NO. 9580
MPH CAD FILE: 13604-PD-018.DWG	

ST. CHARLES PARISH, LOUISIANA
SECTION 26, T12S-R8E

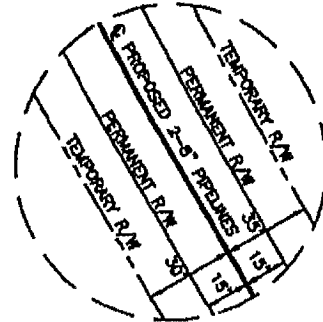

RIGHT-OF-WAY DETAIL
N.T.S.

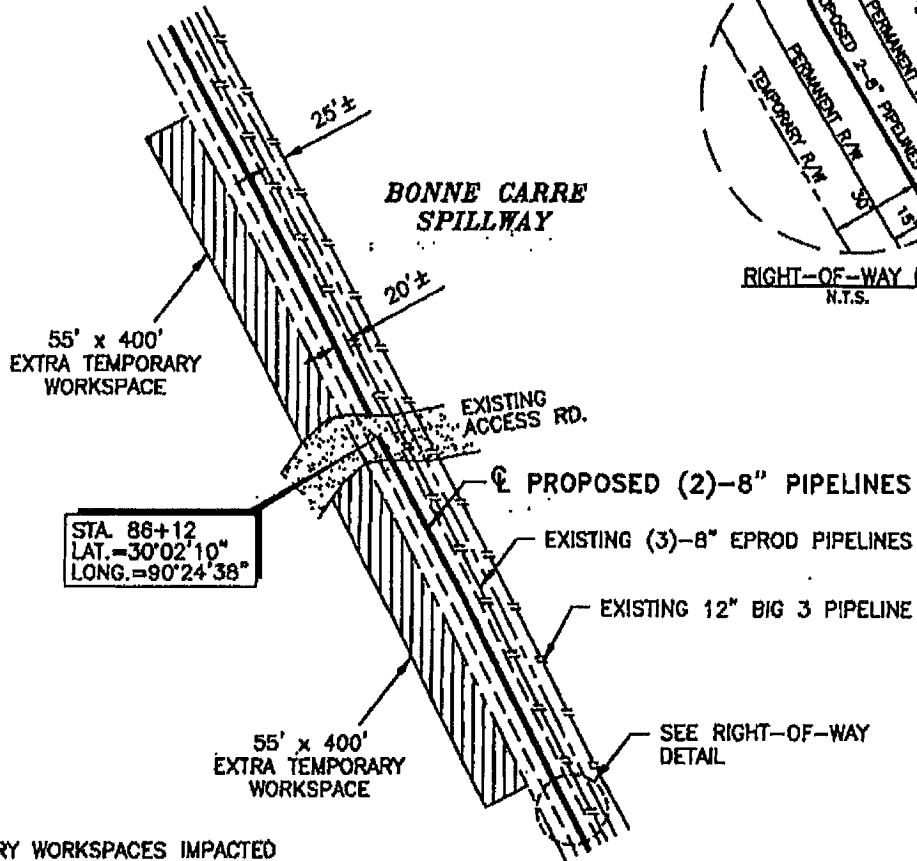

EXTRA TEMPORARY WORKSPACES IMPACTED
HERBACEOUS WETLANDS = 1.02 ACRES

PLAN

GRAPHIC SCALE

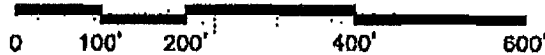

NO.	DATE	REV. BY:	REVISION

SORRENTO PIPELINE COMPANY, LLC

DETAIL PLAN

MPH
Morris P. Hebert, Inc.

SURVEYING • ENGINEERING • ENVIRONMENTAL SERVICES • FIELD SERVICES • GIS
P.O. BOX 3108 • 283 CORPORATE DRIVE • HOUMA, LOUISIANA 70361 • (985) 879-2731
10101 SOUTHWEST FREEMAY • SUITE 400 • HOUSTON, TEXAS 77074 • (713) 218-1470

DRAWN BY: JDW	SHEET: 19
CHKD./APPD. BY: JMH	SCALE: SHOWN
UPDATED BY: KDT	DATE: 12/07/07
DATA BASE: 9580	JOB NO. 9580
MPH CAD FILE: 13604-PD-019.DWG	

W:\eng\9580\COE\13604-PD-019.dwg PLOT DATE: 12/21/07 1:41:36pm

ST. CHARLES PARISH, LOUISIANA
SECTION 32, T11S-R8E

LOUISIANA COORDINATE SYSTEM
(1983 SOUTH ZONE)

UPPER BORROW CANAL

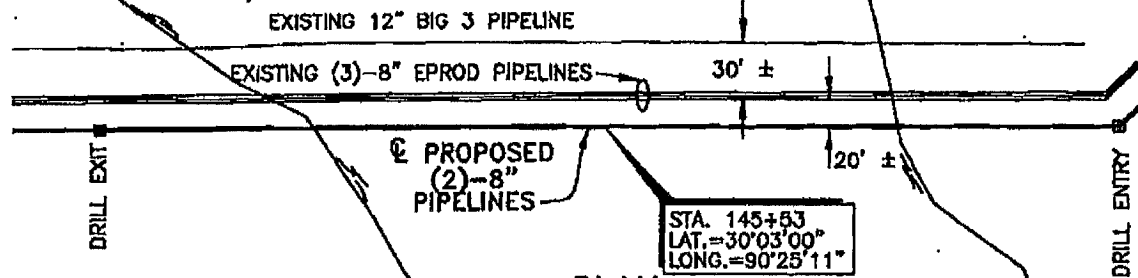

STA. 145+83
LAT.=30°03'00"
LONG.=90°25'11"

PLAN

GRAPHIC SCALE



SEE SHEET 21 FOR
EXTRA WORKSPACE
AND RIGHT-OF-WAY
INFORMATION

DRILL EXIT

DRILL ENTRY

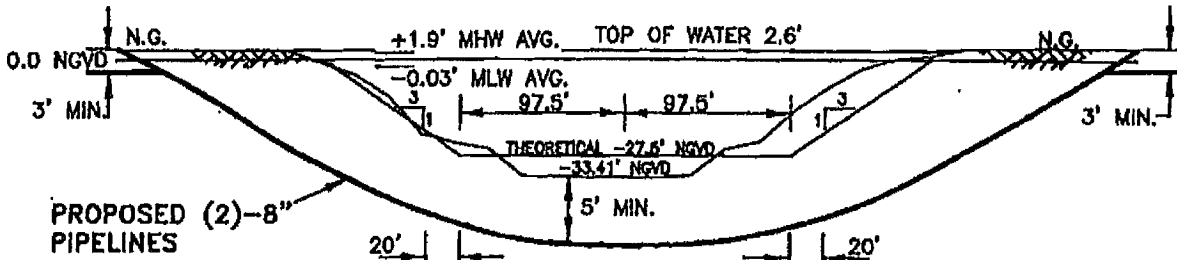
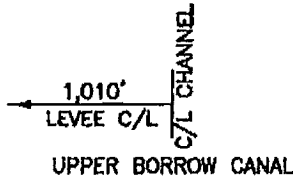

PROPOSED (2)-8"
PIPELINES

PROFILE DRILL SECTION

LOOKING NORTHEASTERLY
VERTICAL SCALE
1" = 50'

PIPELINES TO BE
INSTALLED BY HORIZONTAL
DIRECTIONAL DRILL

SEE SHEET 42 FOR
BANK STABILIZATION
DETAIL

NO.	DATE	REV.	BY

REVISION

SORRENTO PIPELINE COMPANY, LLC

DETAIL PLAN & PROFILE



Morris P. Hebert, Inc.

SURVEYING • ENGINEERING • ENVIRONMENTAL SERVICES • FIELD SERVICES • GIS
P.O. BOX 3108 • 283 CORPORATE DRIVE • IRVING, LOUISIANA 70361 • (985) 879-2731
10101 SOUTHWEST FREEMAN • SUITE 400 • HOUSTON, TEXAS 77074 • (713) 210-1470

DRAWN BY: JDW	SHEET: 20
CHKD./APPD. BY: JMH	SCALE: SHOWN
UPDATED BY: KDT	DATE: 11/01/07
DATA BASE: 9580	JOB NO. 9580

MPH CAD FILE: 13804-PD-020.DWG

W:\dwg\9580\COE\13804-PD-020.dwg PLOT DATE: 1/9/08 9:40:51am

ST. CHARLES PARISH, LOUISIANA
SECTION 32, T11S-R8E

LOUISIANA COORDINATE SYSTEM
(1883 SOUTH ZONE)

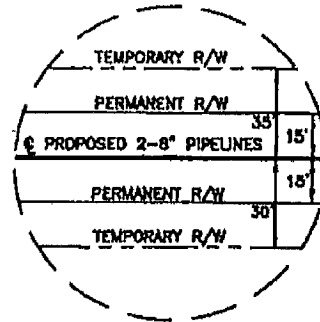
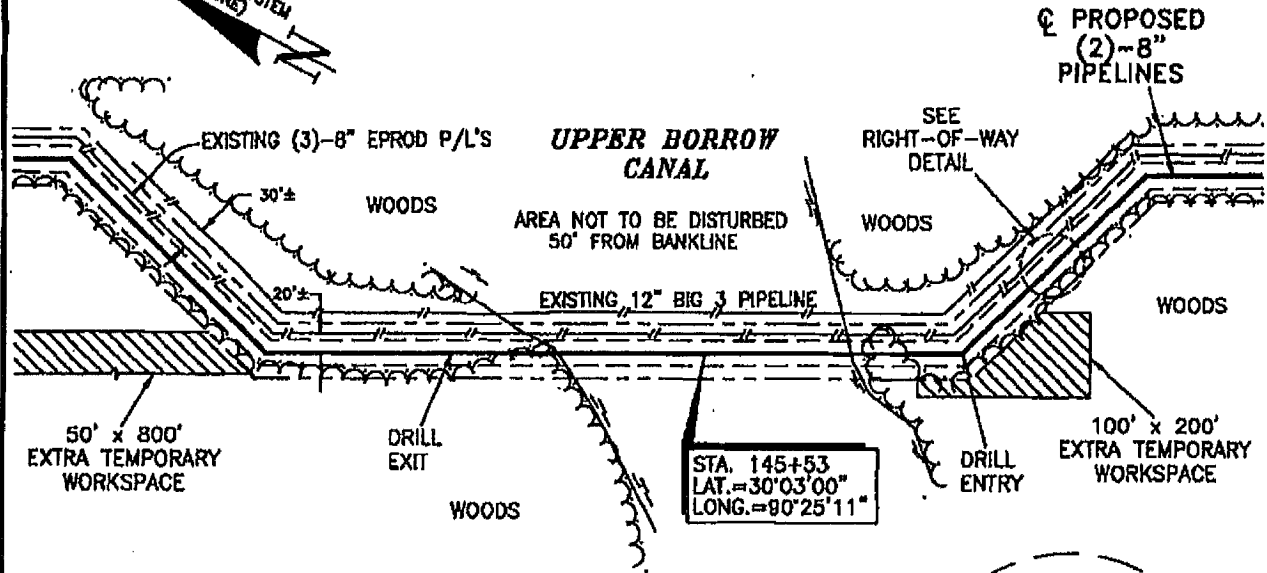

RIGHT-OF-WAY DETAIL
N.T.S.

EXTRA TEMPORARY WORKSPACES IMPACTED
FORESTED WETLANDS = 0.76 ACRES

PLAN

GRAPHIC SCALE

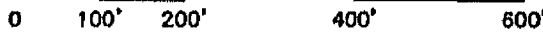

NO.	DATE	REV. BY:	REVISION

SORRENTO PIPELINE COMPANY, LLC

DETAIL PLAN



Morris P. Hebert, Inc.
SURVEYING • ENGINEERING • ENVIRONMENTAL SERVICES • FIELD SERVICES • GIS
P.O. BOX 3106 • 283 CORPORATE DRIVE • HOUMA, LOUISIANA 70341 • (883) 878-2731
10101 SOUTHWEST FREEWAY • SUITE 400 • HOUSTON, TEXAS 77074 • (713) 219-1470

DRAWN BY: JDW	SHEET: 21
CHKD./APPD. BY: JMH	SCALE: SHOWN
UPDATED BY: DPM	DATE: 11/01/07
DATA BASE: 9580	JOB NO. 9580
MPH CAD FILE: 13804--PD--021.DWG	

W:\dwg\9580\COE\13804--PD--021.dwg PLOT DATE: 12/21/07 4:44:28am

ST. CHARLES PARISH, LOUISIANA
SECTION 32 & 42, T11S-R8E

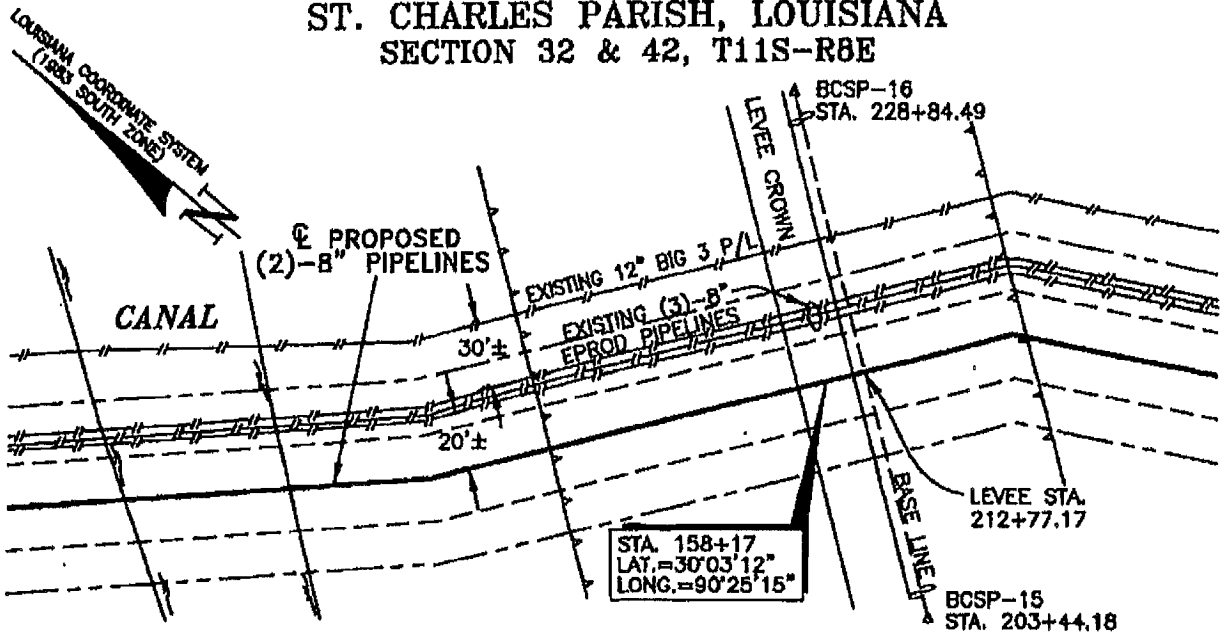

SEE SHEET 23 FOR
EXTRA WORKSPACE
AND RIGHT-OF-WAY
INFORMATION

PLAN
GRAPHIC SCALE



UPPER GUIDE LEVEE

SEE SHEET 42 FOR
BANK STABILIZATION
DETAIL

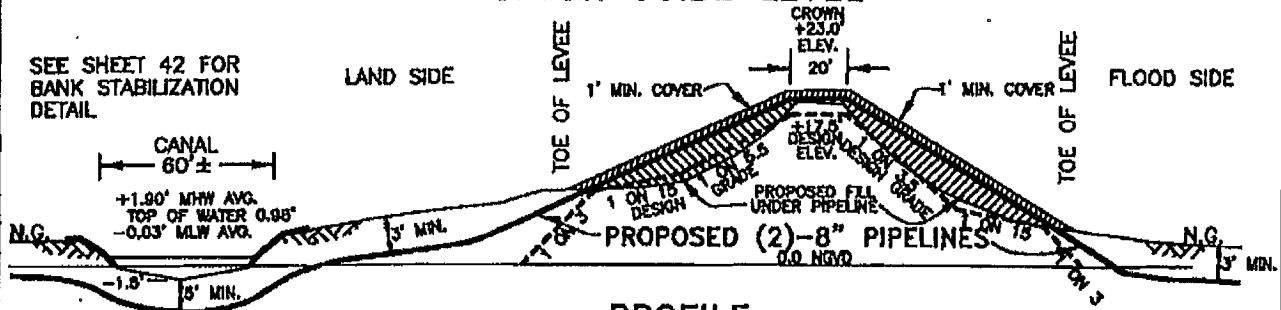

PROFILE

LOOKING NORTHEASTERLY
VERTICAL SCALE
1" = 20'

W:\dwg\9580\COE\13604-PD-022.dwg PLOT DATE: 1/24/08 2:58:10pm

NO.	DATE	REV. BY	REVISION

SORRENTO PIPELINE COMPANY, LLC

DETAIL PLAN & PROFILE



SURVEYING • ENGINEERING • ENVIRONMENTAL SERVICES • FIELD SERVICES • GIS
P.O. BOX 3106 • 283 CORPORATE DRIVE • HOUMA, LOUISIANA 70361 • (985) 879-2731
10101 SOUTHWEST FREDWAY • SUITE 400 • HOUSTON, TEXAS 77074 • (713) 219-1470

DRAWN BY: JDW	SHEET: 22
CHKD./APPD. BY: JMH	SCALE: SHOWN
UPDATED BY: KOT	DATE: 11/01/07
DATA BASE: 9580	JOB NO. 9580
MPH CAD FILE: 13604-PD-022.DWG	

ST. CHARLES PARISH, LOUISIANA
SECTION 32 & 42, T11S-R8E

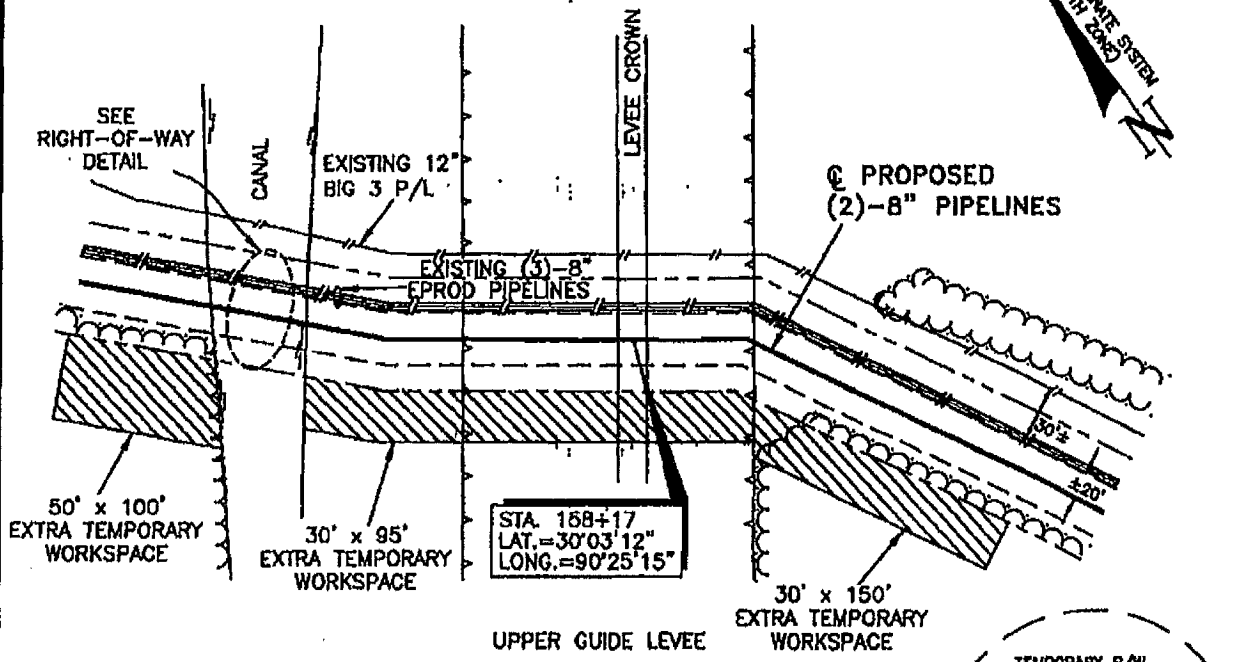
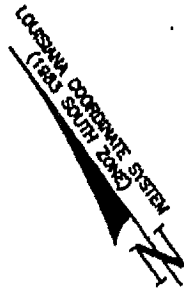

EXTRA TEMPORARY WORKSPACES IMPACTED
FORESTED WETLANDS = 0.21 ACRES
EXTRA TEMPORARY WORKSPACES IMPACTED
HERBACEOUS UPLANDS = 0.20 ACRES

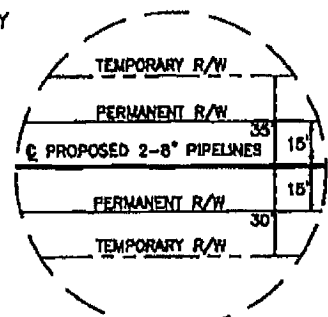

PLAN

GRAPHIC SCALE



RIGHT-OF-WAY DETAIL
N.T.S.

NO.	DATE	REV. BY:	REVISION

SORRENTO PIPELINE COMPANY, LLC

DETAIL PLAN

DRAWN BY: JDW	SHEET: 23
CHKD./APPD. BY: JMH	SCALE: SHOWN
UPDATED BY: KDT	DATE: 11/01/07
DATA BASE: 9580	JOB NO. 9580
MPH CAD FILE: 13604--PD--023.DWG	

W:\dwg\9580\COE\13604-PD-023.dwg PLOT DATE: 12/21/07 1:42:46pm

ST. CHARLES PARISH, LOUISIANA
SECTION 42 & 43, T11S-R8E

LOUISIANA COORDINATE SYSTEM
(1983 SOUTH ZONE)

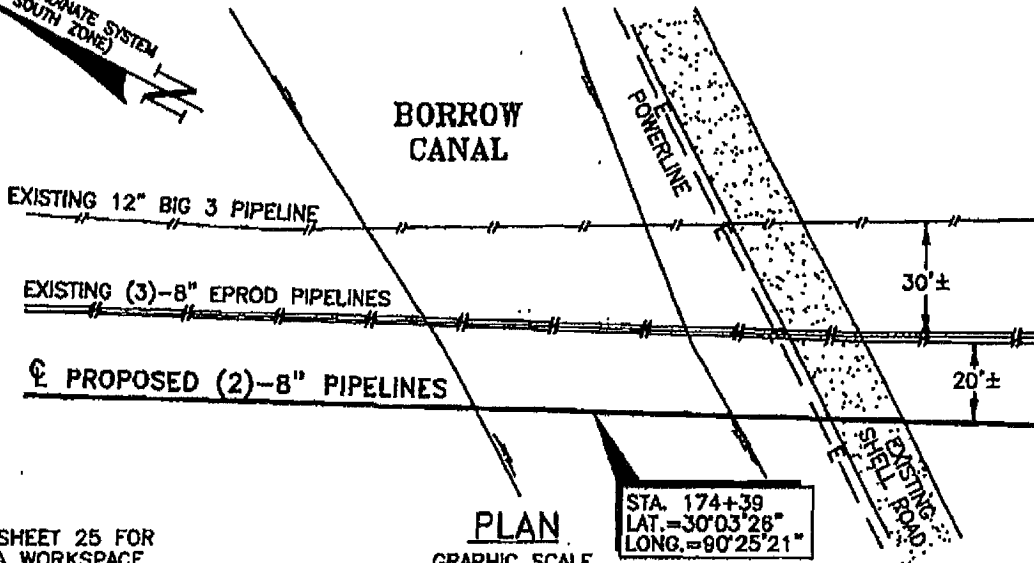

SEE SHEET 25 FOR
EXTRA WORKSPACE
AND RIGHT-OF-WAY
INFORMATION

PLAN

GRAPHIC SCALE

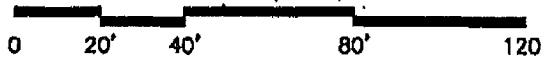

STA. 174+39
LAT. = 30°03'28"
LONG. = 90°25'21"

SEE SHEET 42 FOR
BANK STABILIZATION DETAIL

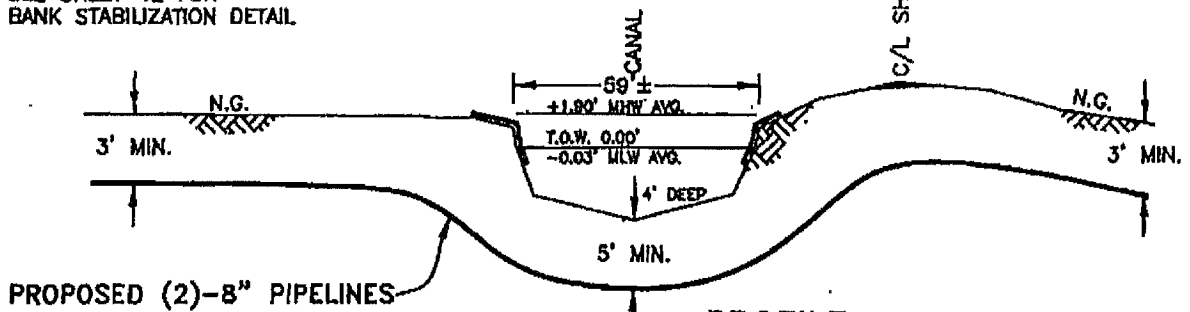

PROFILE

LOOKING NORTHEASTERLY
VERTICAL SCALE
1" = 10'

NO.	DATE	REV. BY	REVISION

SORRENTO PIPELINE COMPANY, LLC

DETAIL PLAN & PROFILE

Morris P. Hebert, Inc.
SURVEYING • ENGINEERING • ENVIRONMENTAL SERVICES • FIELD SERVICES • GIS
P.O. BOX 3108 • 283 CORPORATE DRIVE • HOUMA, LOUISIANA 70361 • (985) 878-2731
10101 SOUTHWEST FREEWAY • SUITE 400 • HOUSTON, TEXAS 77074 • (713) 210-1470

DRAWN BY: JDW	SHEET: 24
CHKD./APPD. BY: JMH	SCALE: SHOWN
UPDATED BY: KDT	DATE: 11/01/07
DATA BASE: 9580	JOB NO. 9580

MPH CAD FILE: 13604-PD-024.DWG

W:\mp\9580\COE\13604-PD-024.dwg PLOT DATE: 12/21/07 4:43:01pm

ST. CHARLES PARISH, LOUISIANA
SECTION 42 & 43, T11S-R8E

LOUISIANA COORDINATE SYSTEM
(1983 SOUTH ZONE)

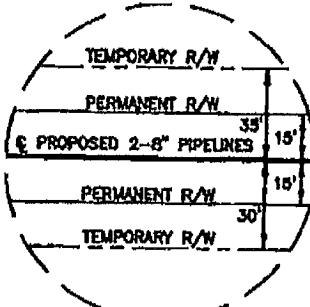

RIGHT-OF-WAY DETAIL
N.T.S.

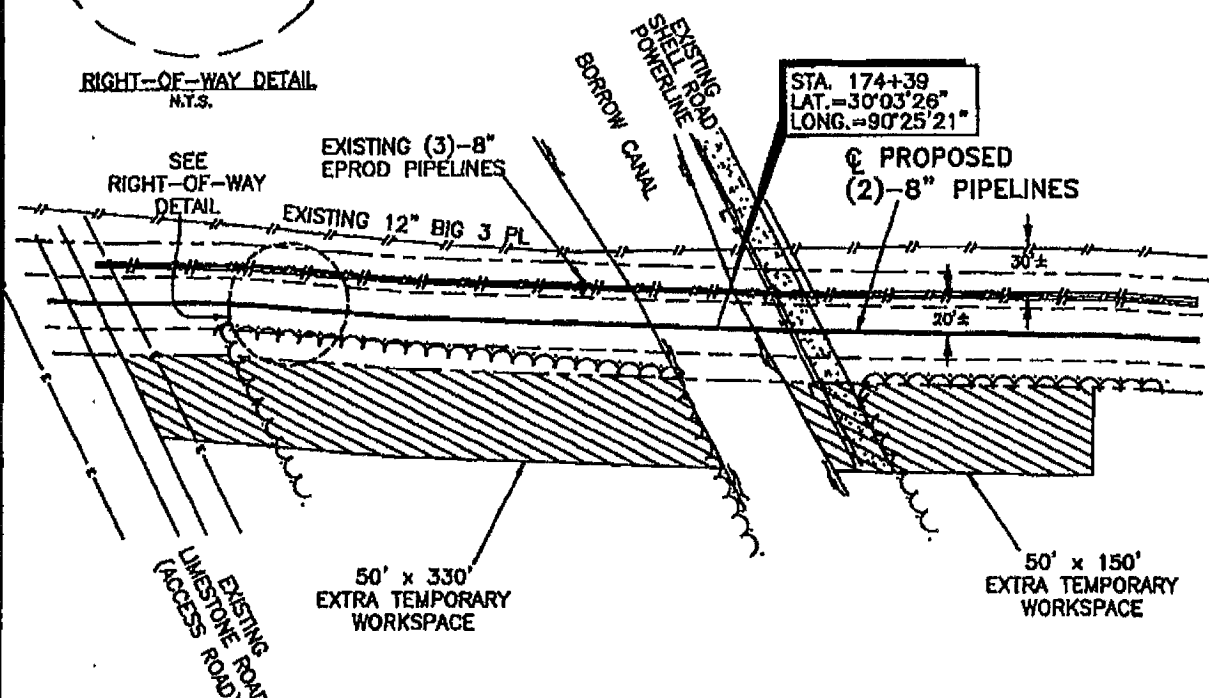

EXTRA TEMPORARY WORKSPACES IMPACTED
FORESTED WETLANDS = 0.45 ACRES
EXTRA TEMPORARY WORKSPACES IMPACTED
HERBACEOUS WETLANDS = 0.12 ACRES

PLAN

GRAPHIC SCALE



NO.	DATE	REV. BY:	REVISION

SORRENTO PIPELINE COMPANY, LLC

DETAIL PLAN



Morris P. Hebert, Inc.
SURVEYING • ENGINEERING • ENVIRONMENTAL SERVICES • ROAD SERVICES • GIS
P.O. BOX 3108 • 263 CORPORATE DRIVE • HOUMA, LOUISIANA 70301 • (850) 879-2731
10101 SOUTHWEST FREEWAY • SUITE 400 • HOUSTON, TEXAS 77074 • (713) 219-1470

DRAWN BY: JDW	SHEET: 25
CHKD./APPD. BY: JMH	SCALE: SHOWN
UPDATED BY: OPM	DATE: 11/01/07
DATA BASE: 9580	JOB NO. 9580
MPH CAD FILE: 13604-PD-025.DWG	

W:\eng\9580\COE\13604-PD-025.dwg PLOT DATE: 12/21/07 8:50:12am

ST. JOHN THE BAPTIST PARISH, LOUISIANA
SECTION 43 & 44, T11S-R8E

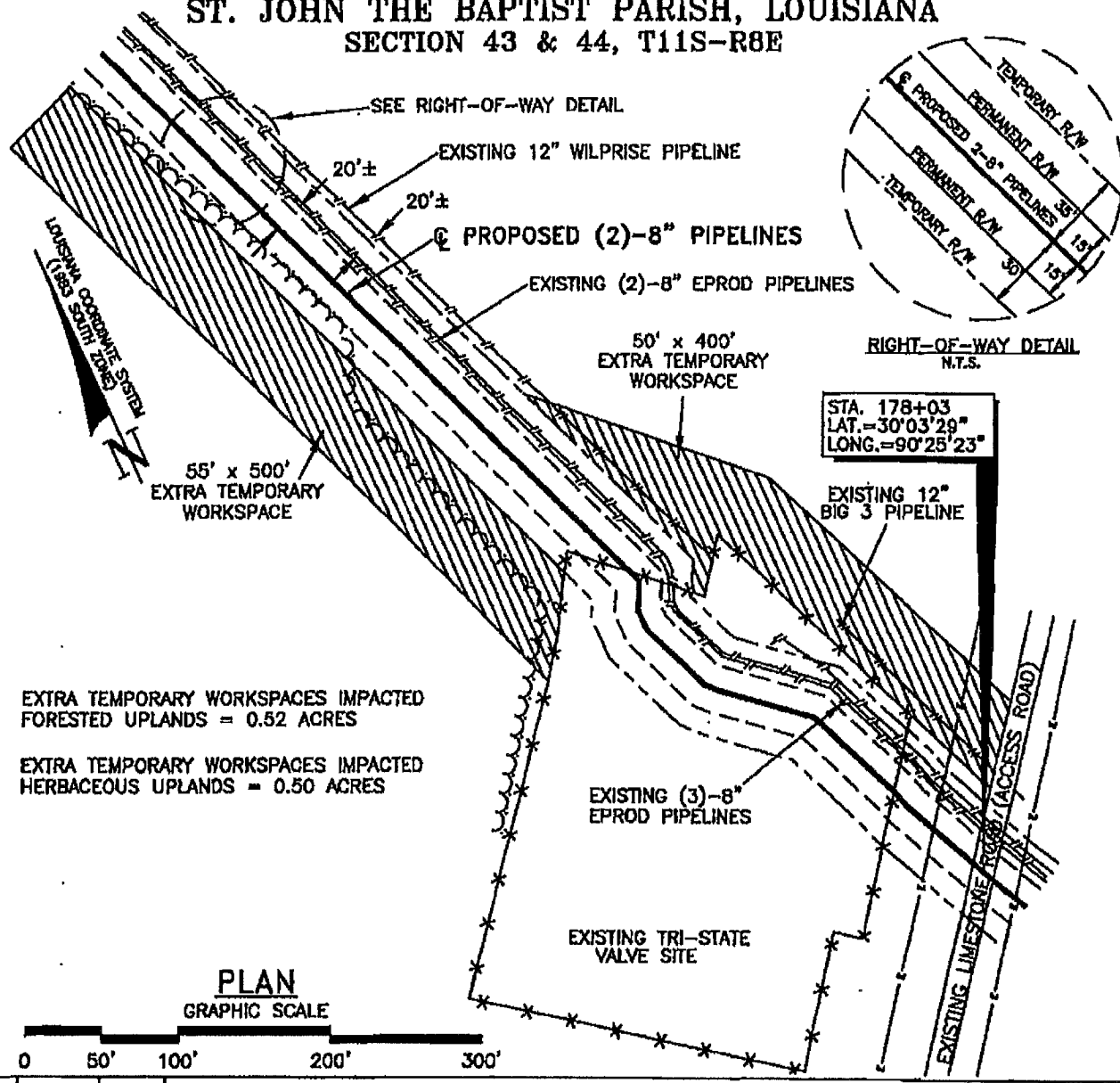

EXTRA TEMPORARY WORKSPACES IMPACTED
FORESTED UPLANDS = 0.52 ACRES

EXTRA TEMPORARY WORKSPACES IMPACTED
HERBACEOUS UPLANDS = 0.50 ACRES



STA. 178+03
LAT.=30°03'29"
LONG.=90°25'23"

RIGHT-OF-WAY DETAIL
N.T.S.

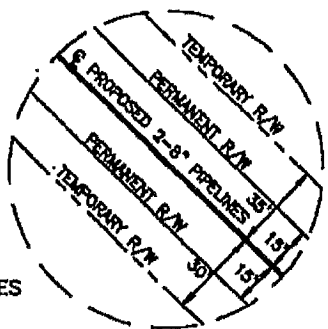

W:\temp\9580\COE\13604-PD-026.dwg PLOT DATE: 12/20/07 6:13:58pm

NO.	DATE	REV. BY:	REVISION

SORRENTO PIPELINE COMPANY, LLC

PLAN

Morris P. Hebert, Inc.
SURVEYING • ENGINEERING • ENVIRONMENTAL SERVICES • FIELD SERVICES • GIS
P.O. BOX 3108 • 283 CORPORATE DRIVE • HOUMA, LOUISIANA 70341 • (865) 879-2731
10101 SOUTHWEST FREEMAN • SUITE 400 • HOUSTON, TEXAS 77074 • (713) 219-1470

DRAWN BY: JDW	SHEET: 28
CHKD./APPD. BY: JMH	SCALE: SHOWN
UPDATED BY: DPM	DATE: 11/01/07
DATA BASE: 9580	JOB NO. 9580
MPH CAD FILE: 13604-PD-026.DWG	

ST. JOHN THE BAPTIST PARISH, LOUISIANA
 SECTIONS 19, 20, 29 & 30, T11S-R8E

LOUISIANA COORDINATE SYSTEM
 (1983 SOUTH ZONE)

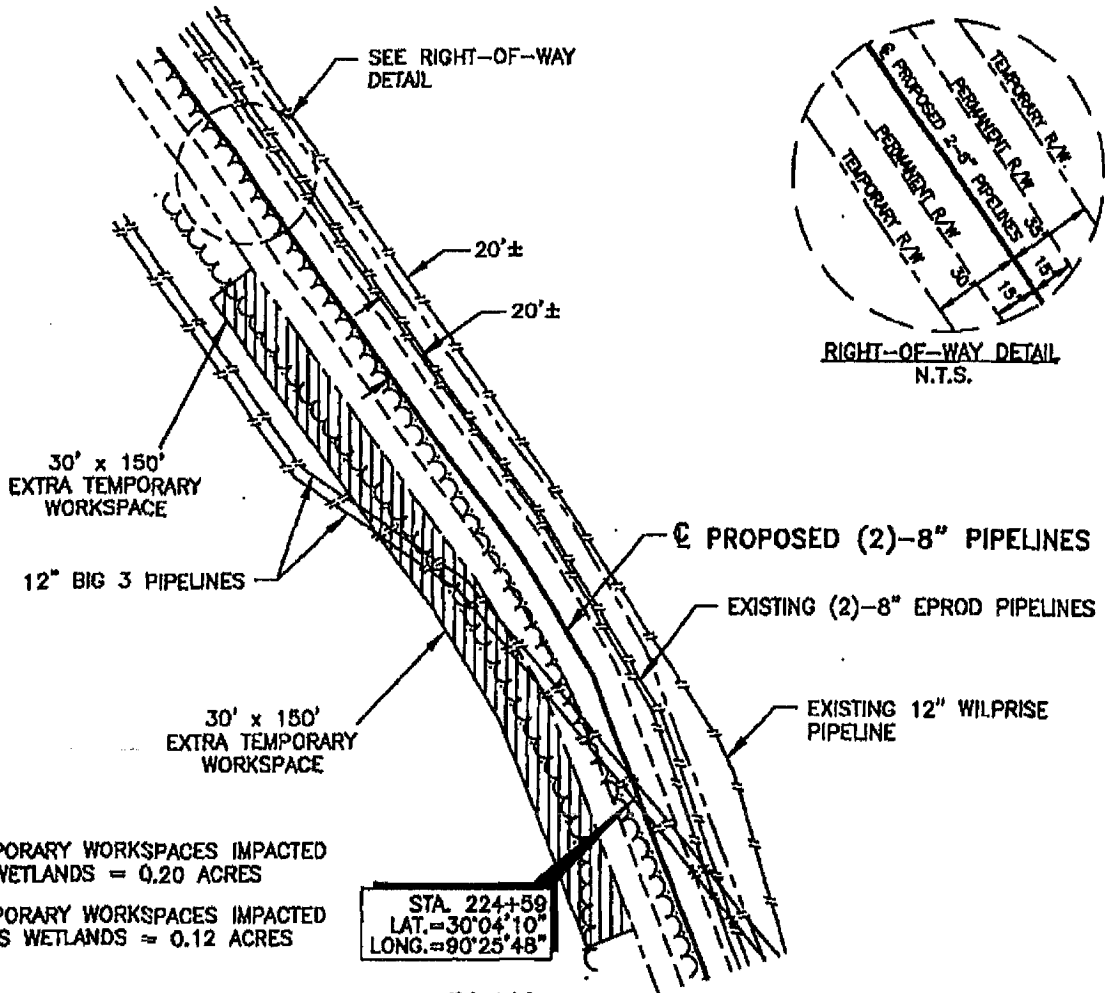

PLAN

GRAPHIC SCALE

0 50' 100' 200' 300'

W:\eng\9580\COE\13604-PD-027.dwg PLOT DATE: 12/20/07 5:58:39pm

NO.	DATE	REV. BY:	REVISION
-----	------	----------	----------

SORRENTO PIPELINE COMPANY, LLC

DETAIL PLAN



Morris P. Hebert, Inc.
 SURVEYING • ENGINEERING • ENVIRONMENTAL SERVICES • FIELD SERVICES • GIS
 P.O. BOX 3106 • 283 CORPORATE DRIVE • HOUMA, LOUISIANA 70381 • (866) 878-2731
 10101 SOUTHWEST FREEWAY • SUITE 400 • HOUSTON, TEXAS 77074 • (713) 218-1470

DRAWN BY: JDW	SHEET: 27
CHKD./APPD. BY: JMH	SCALE: SHOWN
UPDATED BY: DPM	DATE: 12/07/07
DATA BASE: 9580	JOB NO. 9580
MPH CAD FILE: 13604-PD-027.DWG	

ST. JOHN THE BAPTIST PARISH, LOUISIANA
SECTION 18, T11S-R8E

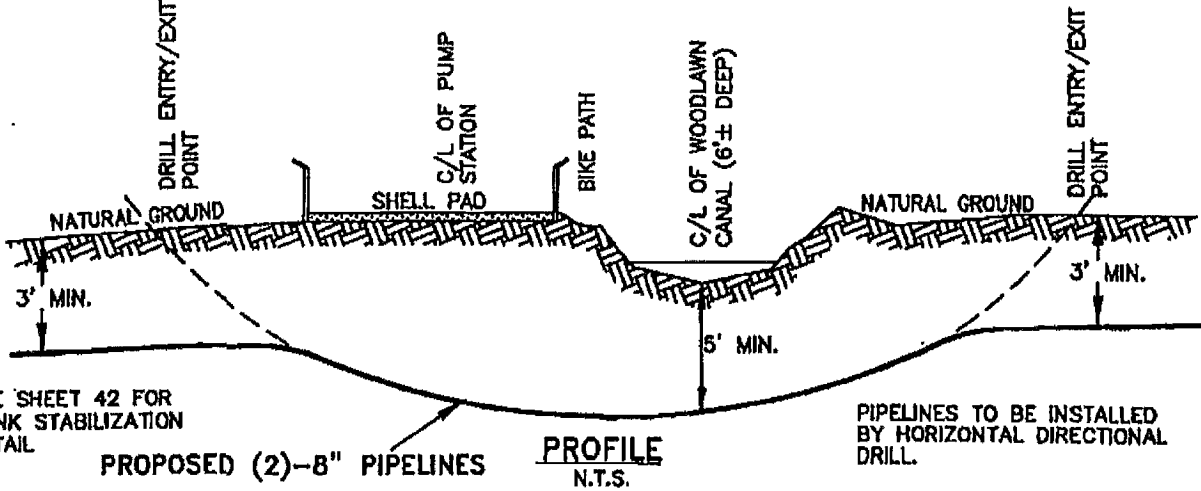
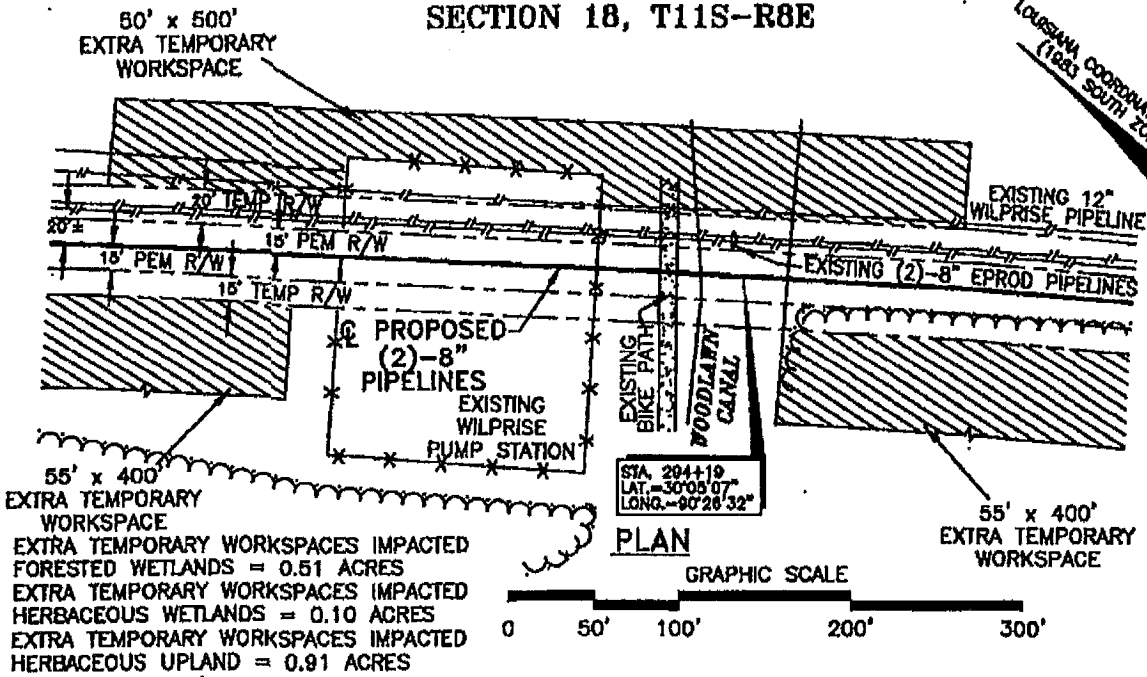

I:\eng\9580\COE\13604-PD-028.dwg PLOT DATE: 1/24/08 3:28:38pm

NO.	DATE	REV. BY:	REVISION

SORRENTO PIPELINE COMPANY, LLC

DETAIL PLAN & PROFILE



SURVEYING • ENGINEERING • ENVIRONMENTAL SERVICES • FIELD SERVICES • GIS
 P.O. BOX 3108 • 283 CORPORATE DRIVE • HOUMA, LOUISIANA 70341 • (825) 879-2731
 10101 SOUTHWEST FREEWAY • SUITE 400 • HOUSTON, TEXAS 77074 • (713) 219-1470

DRAWN BY:	JOW	SHEET:	28
CHKD./APPD. BY:	JMH	SCALE:	SHOWN
UPDATED BY:	DPM	DATE:	11/01/07
DATA BASE:	9580	JOB NO.	9580
MPH CAD FILE: 13604-PD-028.DWG			

ST. JOHN THE BAPTIST PARISH, LOUISIANA
SECTION 18, T11S-R8E & SECTION 98, T11-R7E

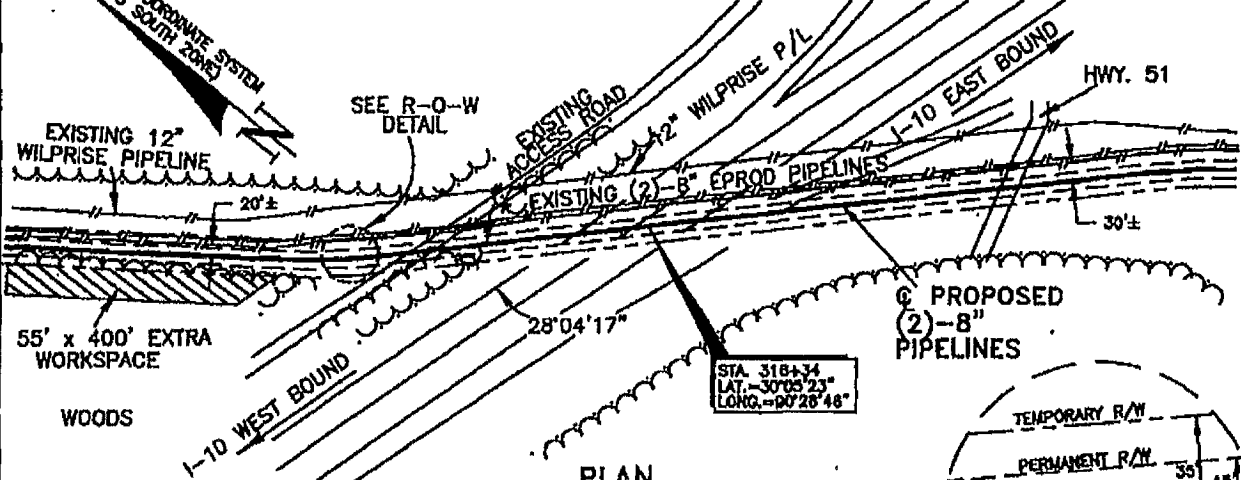

PLAN

GRAPHIC SCALE



EXTRA TEMPORARY WORKSPACES IMPACTED
FORESTED WETLANDS = 0.55 ACRES

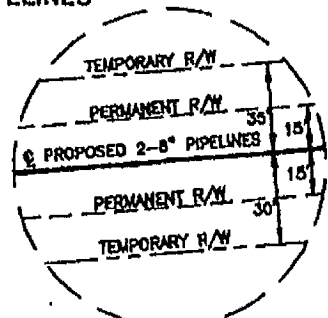

RIGHT-OF-WAY DETAIL
N.T.S.

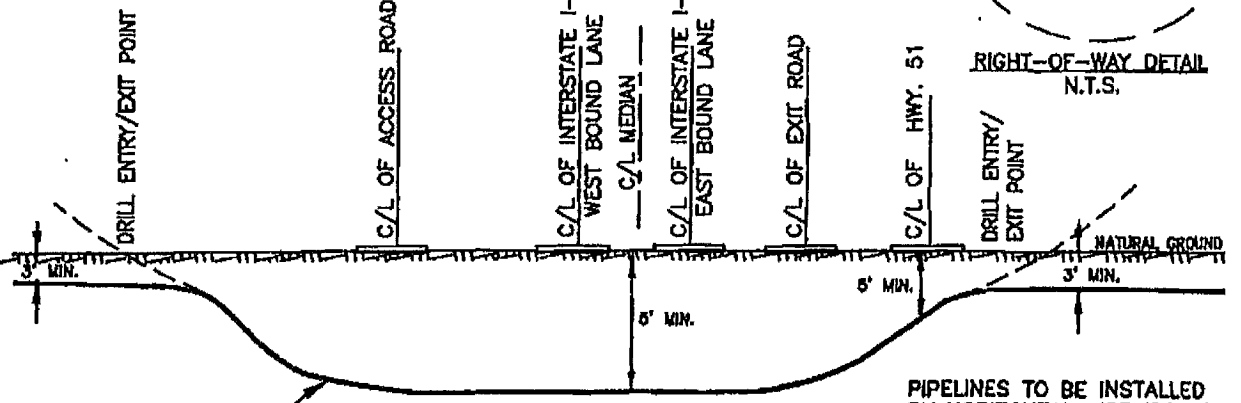

PROFILE
N.T.S.

PIPELINES TO BE INSTALLED
BY HORIZONTAL DIRECTIONAL
DRILL.

MPH.dwg (9580) (05/01/07) 13604-PD-029.dwg PLOT DATE: 1/31/08 8:44:17am

NO.	DATE	REV. BY:	REVISION

SORRENTO PIPELINE COMPANY, LLC

DETAIL PLAN & PROFILE



Morris P. Hebert, Inc.
SURVEYING • ENGINEERING • ENVIRONMENTAL SERVICES • FIELD SERVICES • GIS
P.O. BOX 3108 • 283 CORPORATE DRIVE • HOUMA, LOUISIANA 70361 • (863) 878-2731
10101 SOUTHWEST FREEWAY • SUITE 400 • HOUSTON, TEXAS 77074 • (713) 219-1470

DRAWN BY: JDW	SHEET: 29
CHKD./APPD. BY: JMH	SCALE: SHOWN
UPDATED BY: KDT	DATE: 11/01/07
DATA BASE: 9580	JOB NO. 9580
MPH CAD FILE: 13604-PD-029.DWG	

ST. JOHN THE BAPTIST PARISH, LOUISIANA
SECTION 97, T11S-R7E

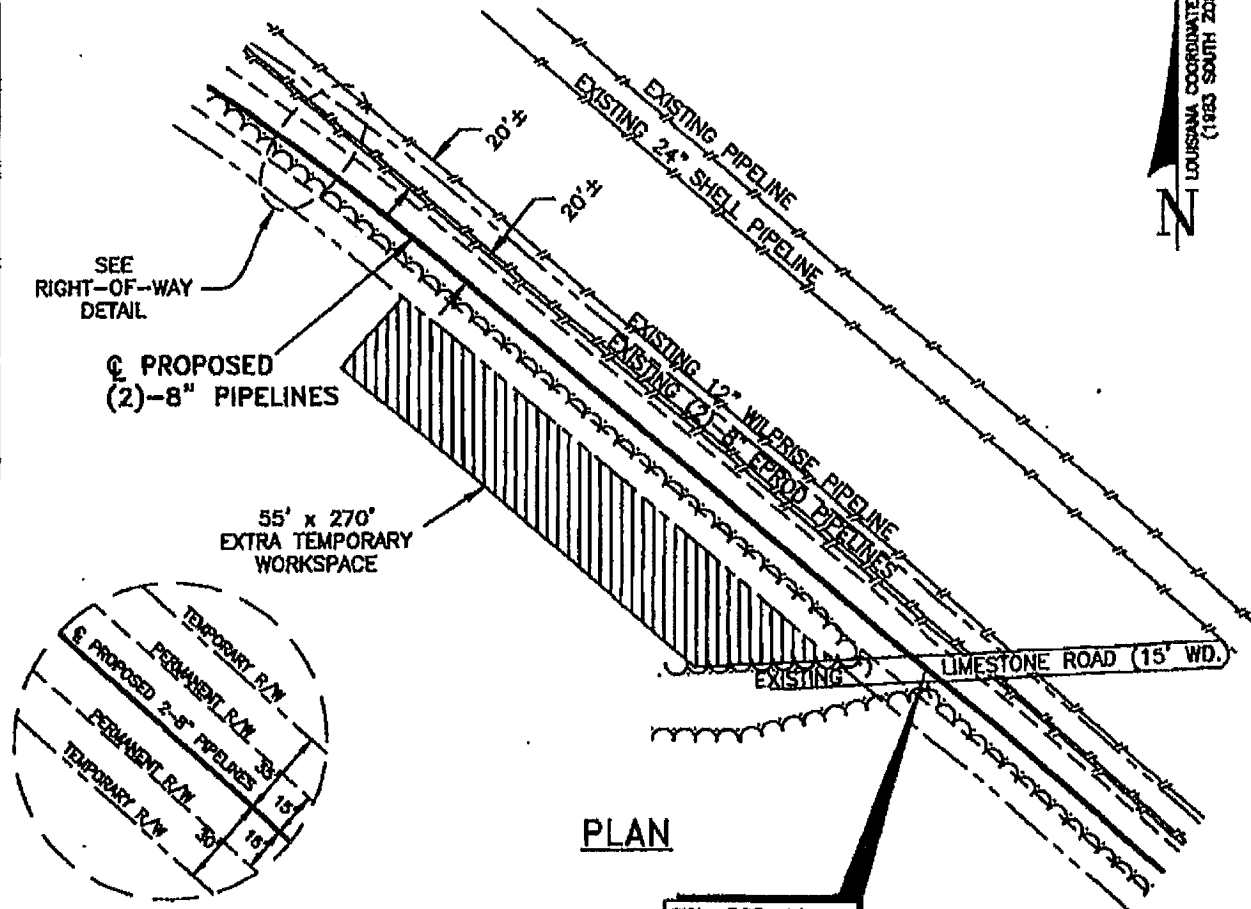

SEE
RIGHT-OF-WAY
DETAIL

☉ PROPOSED
(2)-8" PIPELINES

55' x 270'
EXTRA TEMPORARY
WORKSPACE

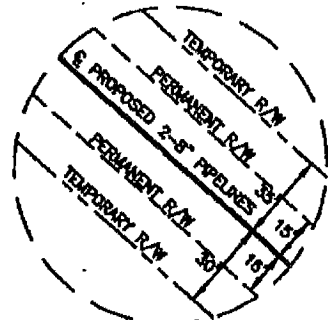

RIGHT-OF-WAY DETAIL
N.T.S.

EXTRA TEMPORARY WORKSPACES IMPACTED
FORESTED WETLANDS = 0.38 ACRES

PLAN

STA. 365+10
LAT.=30°05'57"
LONG.=90°27'27"

GRAPHIC SCALE



W:\dms\9580\COE\13604-PD-030.dwg PLOT DATE: 12/21/07 5:17:58pm

NO.	DATE	REV. BY:	REVISION

SORRENTO PIPELINE COMPANY, LLC

DETAIL PLAN



Morris P. Hebert, Inc.

SURVEYING • ENGINEERING • ENVIRONMENTAL SERVICES • FIELD SERVICES • GIS
P.O. BOX 3108 • 283 CORPORATE DRIVE • HOUMA, LOUISIANA 70381 • (850) 879-2731
10101 SOUTHWEST FREEWAY • SUITE 400 • HOUSTON, TEXAS 77074 • (713) 219-1479

DRAWN BY: JOW	SHEET: 30
CHKD./APPD. BY: JMH	SCALE: SHOWN
UPDATED BY: KOT	DATE: 11/01/07
DATA BASE: 9580	JOB NO. 9580
MPH CAD FILE: 13604-PD-030.DWG	

ST. JOHN THE BAPTIST PARISH, LOUISIANA
SECTIONS 66, T11S-R7E

LOUISIANA COORDINATE SYSTEM
(1983 SOUTH ZONE)

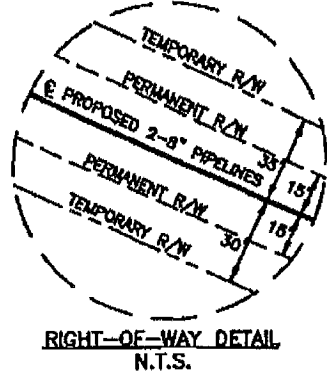
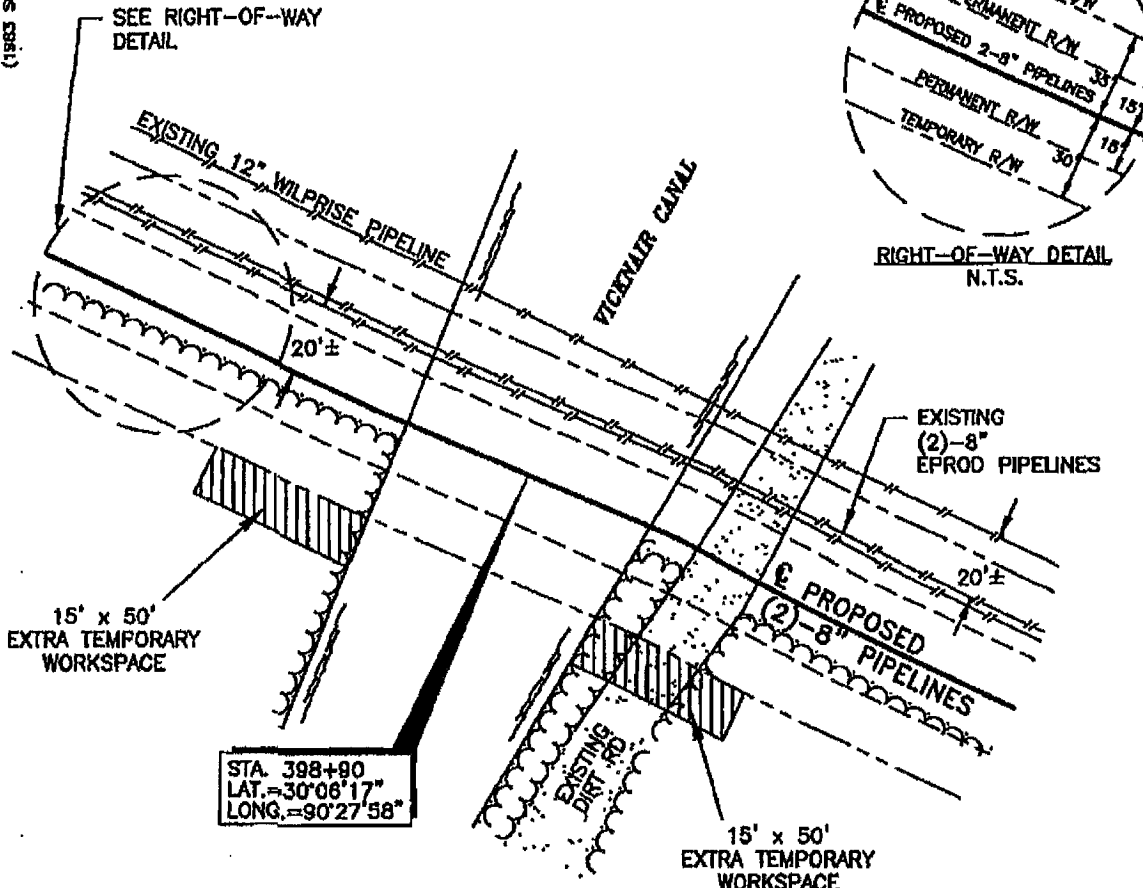

STA. 398+90
LAT. = 30°06'17"
LONG. = 90°27'58"

EXTRA TEMPORARY WORKSPACES IMPACTED
FORESTED WETLANDS = 0.03 ACRES

PLAN

SEE SHEET 40 FOR TYPICAL
WATERWAY CROSSING.



SEE SHEET 42 FOR BANK
STABILIZATION DETAIL.

W:\dms\9580\COE\13604-PD-031.dwg PLOT DATE: 12/21/07 8:30:47am

NO.	DATE	REV. BY:	REVISION

SORRENTO PIPELINE COMPANY, LLC

DETAIL PLAN

DRAWN BY: JDW	SHEET: 31
CHKD./APPD. BY: JMH	SCALE: SHOWN
UPDATED BY: DPM	DATE: 12/10/07
DATA BASE: 9580	JOB NO. 9580
MPH CAD FILE: 13604-PD-031.DWG	

ST. JOHN THE BAPTIST PARISH, LOUISIANA
SECTIONS 14, T11S-R7E

N
LOUISIANA COORDINATE SYSTEM
(1983 SOUTH ZONE)

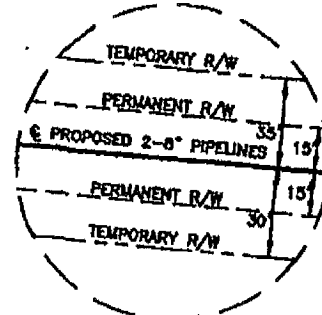

RIGHT-OF-WAY DETAIL
N.T.S.

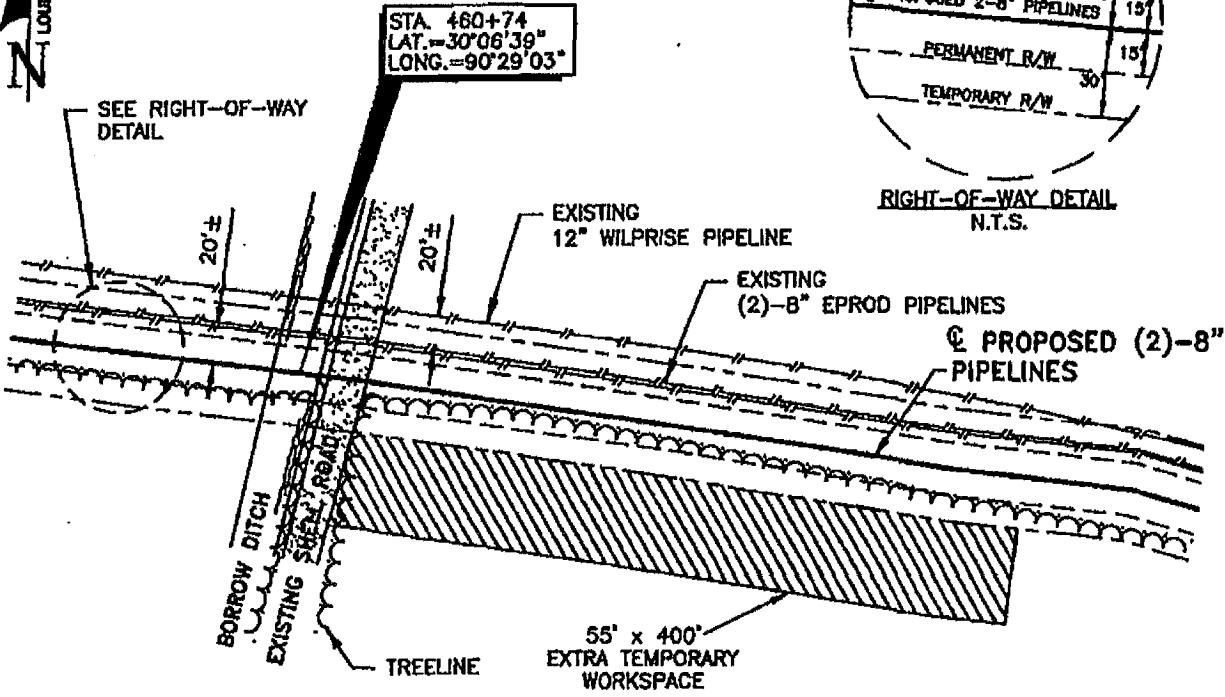

EXTRA TEMPORARY WORKSPACES IMPACTED
FORESTED WETLANDS = 0.51 ACRES

PLAN

GRAPHIC SCALE



NO.	DATE	REV. BY:	REVISION

SORRENTO PIPELINE COMPANY, LLC

DETAIL PLAN



Morris P. Hebert, Inc.

SURVEYING • ENGINEERING • ENVIRONMENTAL SERVICES • FIELD SERVICES • GIS
P.O. BOX 3108 • 283 CORPORATE DRIVE • HOKIA, LOUISIANA 70361 • (885) 879-2731
10101 SOUTHWEST FREWAY • SUITE 400 • HOUSTON, TEXAS 77074 • (713) 219-1470

DRAWN BY: JDW	SHEET: 32
CHKD./APPD. BY: JMH	SCALE: SHOWN
UPDATED BY: KOT	DATE: 12/10/07
DATA BASE: 9580	JOB NO. 9580

MPH CAD FILE: 13604-PD-032.DWG

N:\dwg\13604\13604-PD-032.dwg PLOT DATE: 12/21/07 8:35:40am

ST. JOHN THE BAPTIST PARISH, LOUISIANA
SECTION 8 & 16, T11S-R7E

LOUISIANA COORDINATE SYSTEM
(1983 SOUTH ZONE)

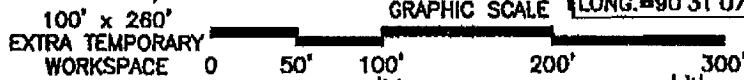
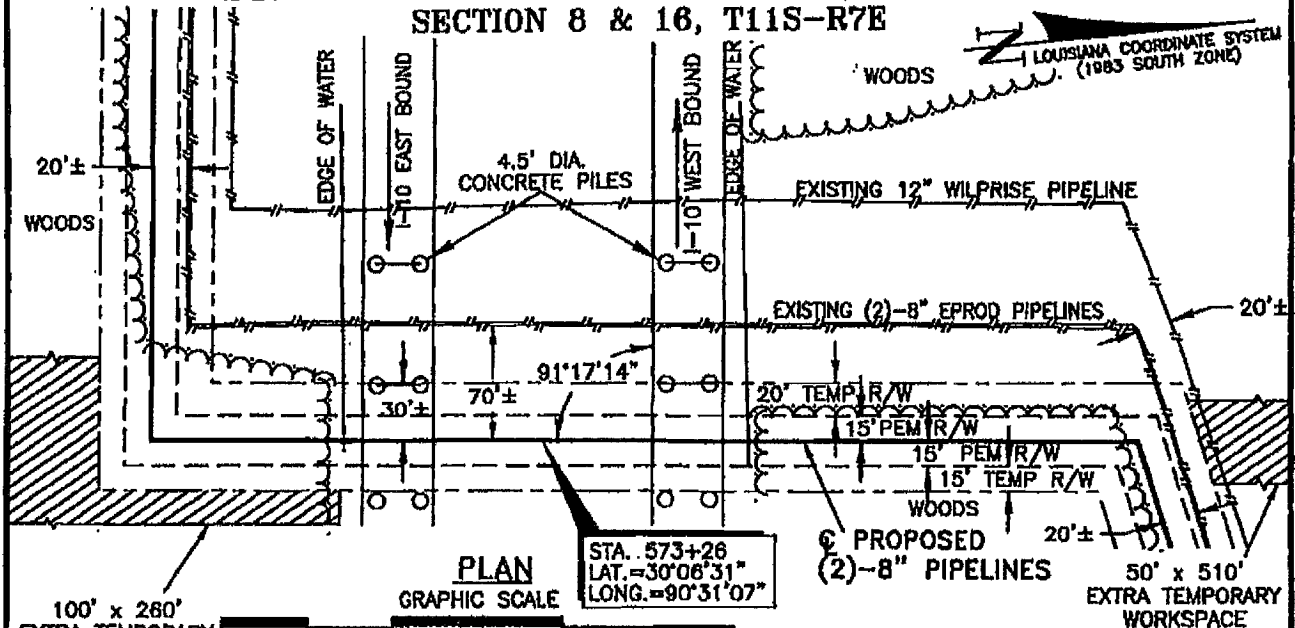

STA. 573+26
LAT. = 30°08'31"
LONG. = 90°31'07"

EXTRA TEMPORARY WORKSPACES IMPACTED
FORESTED WETLANDS = 0.34 ACRES
EXTRA TEMPORARY WORKSPACES IMPACTED
HERBACEOUS WETLANDS = 0.41 ACRES

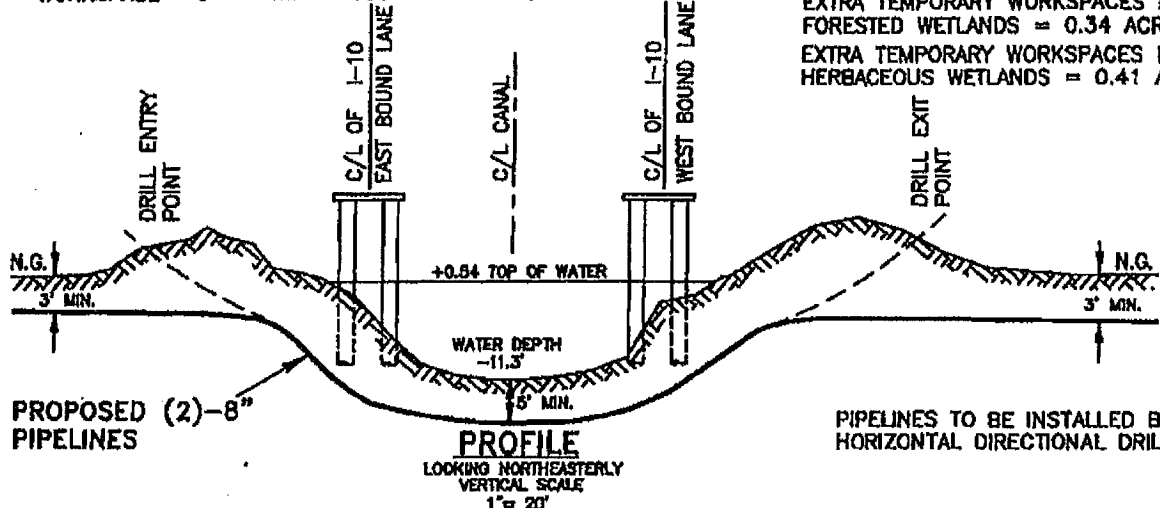

PROFILE
LOOKING NORTHEASTERLY
VERTICAL SCALE
1" = 20'

W:\proj\9580\COE\13604-PD-033.dwg PLOT DATE: 12/21/07 8:55:02am

NO.	DATE	REV. BY:	REVISION

SORRENTO PIPELINE COMPANY, LLC

DETAIL PLAN & PROFILE

Morris P. Hebert, Inc.
SURVEYING • ENGINEERING • ENVIRONMENTAL SERVICES • FIELD SERVICES • GIS
P.O. BOX 3108 • 283 CORPORATE DRIVE • HOUMA, LOUISIANA 70361 • (855) 879-2731
10101 SOUTHWEST FREEWAY • SUITE 400 • HOUSTON, TEXAS 77074 • (713) 218-1470

DRAWN BY: JDW	SHEET: 33
CHKD./APPD. BY: JMH	SCALE: SHOWN
UPDATED BY: OPM	DATE: 11/01/07
DATA BASE: 9580	JOB NO. 9580
MPH CAD FILE: 13604-PD-033.DWG	

ST. JOHN THE BAPTIST PARISH, LOUISIANA
SECTION 7, T11S-R7E

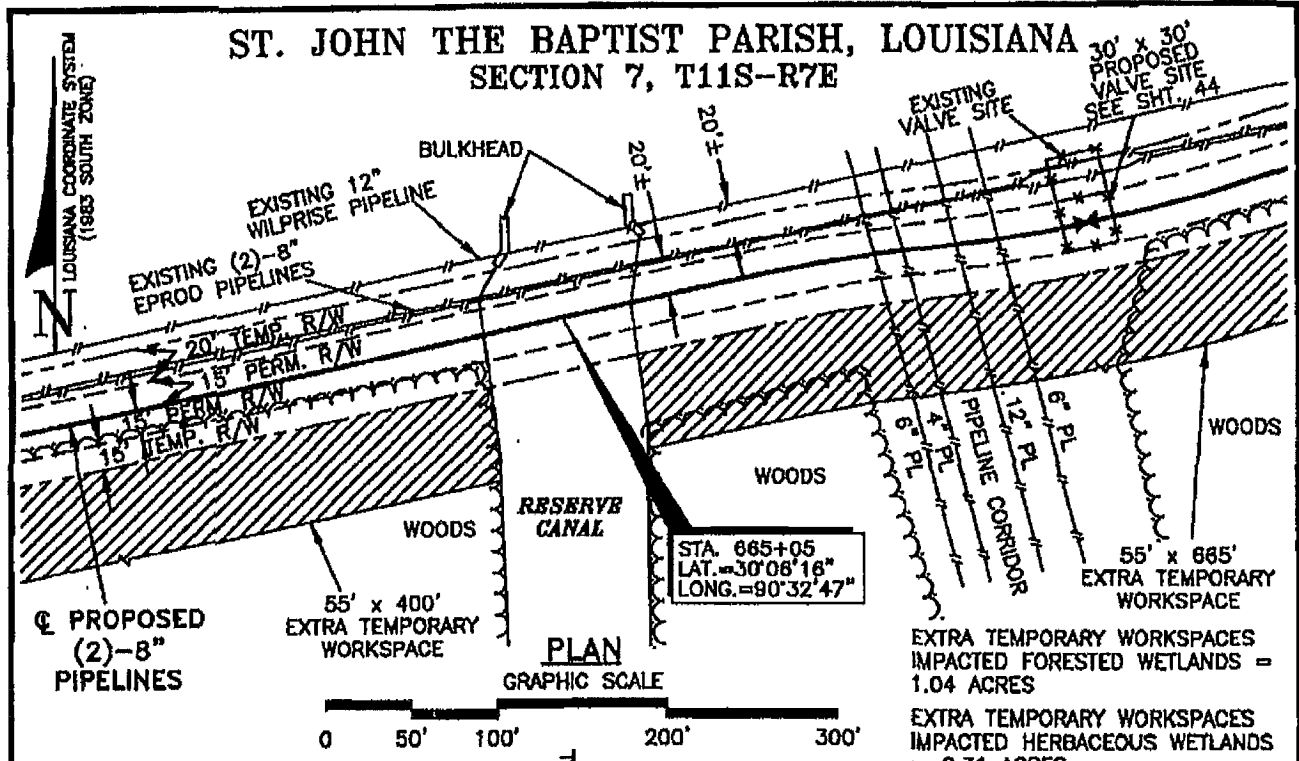

EXTRA TEMPORARY WORKSPACES
IMPACTED FORESTED WETLANDS =
1.04 ACRES
EXTRA TEMPORARY WORKSPACES
IMPACTED HERBACEOUS WETLANDS
= 0.31 ACRES

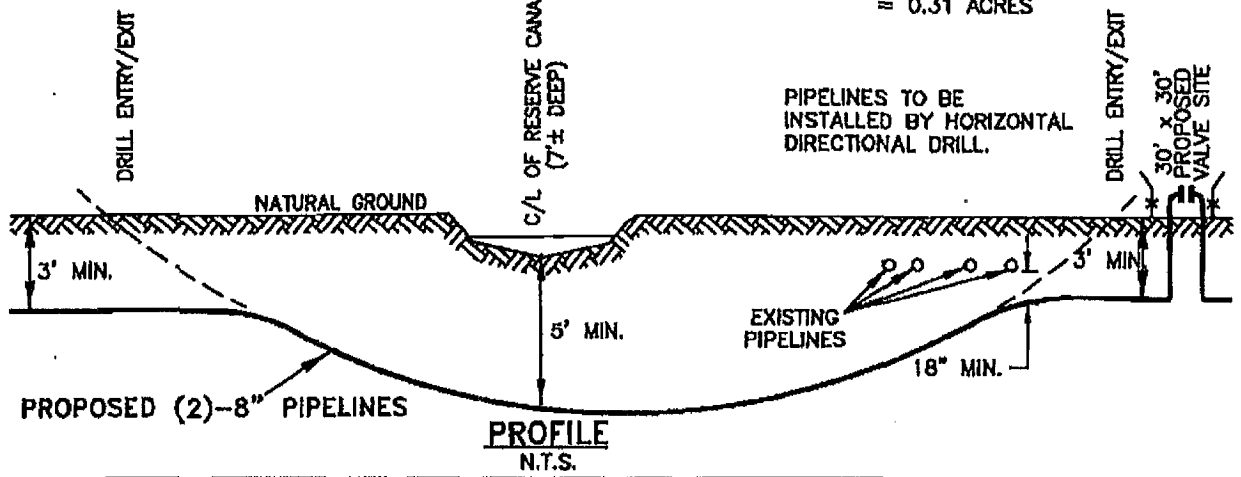

I:\eng\9580\COE\13604-PD-034.dwg PLOT DATE: 1/24/08 1:27:24pm

NO.	DATE	REV. BY:	REVISION

SORRENTO PIPELINE COMPANY, LLC

DETAIL PLAN & PROFILE

Morris P. Hebert, Inc.
SURVEYING • ENGINEERING • ENVIRONMENTAL SERVICES • FIELD SERVICES • GIS
P.O. BOX 3108 • 283 CORPORATE DRIVE • HOUMA, LOUISIANA 70361 • (865) 870-2731
10101 SOUTHWEST FREEWAY • SUITE 400 • HOUSTON, TEXAS 77074 • (713) 218-1470

DRAWN BY: JDW	SHEET: 34
CHKD./APPD. BY: JMH	SCALE: SHOWN
UPDATED BY: MAS	DATE: 11/01/07
DATA BASE: 9580	JOB NO. 9580
MPH CAD FILE: 13604-PD-034.DWG	

ST. JOHN THE BAPTIST PARISH, LOUISIANA

SECTION 93, T11S-R6E

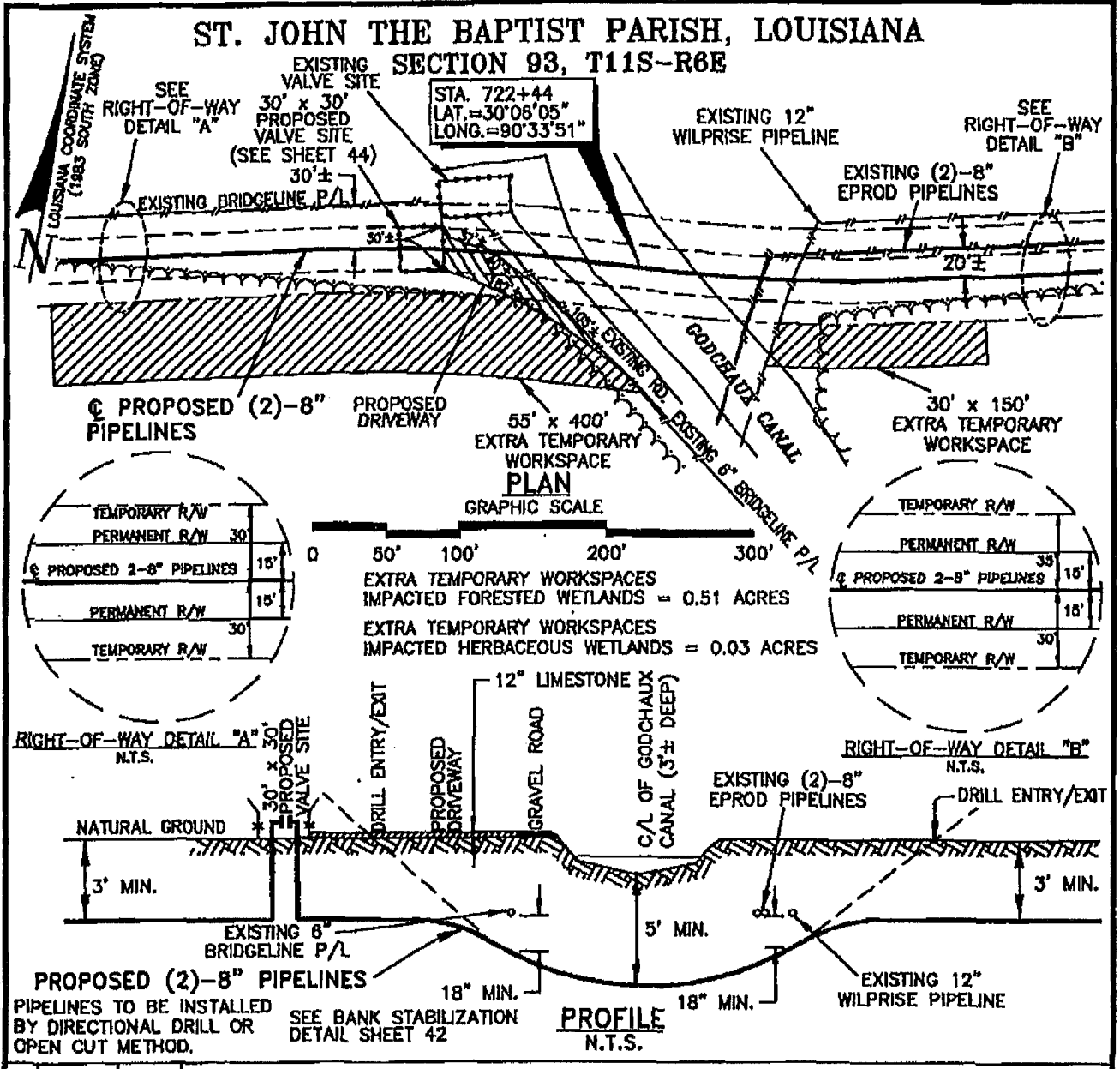

W:\dmg\9580\COE\13604-PD-035.dwg PLOT DATE: 1/24/08 3:26:48pm

NO.	DATE	REV. BY:	REVISION

SORRENTO PIPELINE COMPANY, LLC

DETAIL PLAN & PROFILE

mph
Morris P. Hebert, Inc.

SURVEYING • ENGINEERING • ENVIRONMENTAL SERVICES • FIELD SERVICES • GIS
P.O. BOX 3108 • 283 CORPORATE DRIVE • HOUMA, LOUISIANA 70381 • (985) 879-2731
10101 SOUTHWEST FREEWAY • SUITE 400 • HOUSTON, TEXAS 77074 • (713) 219-1470

DRAWN BY: JDW	SHEET: 35
CHKD./APPD. BY: JMH	SCALE: SHOWN
UPDATED BY: MAS	DATE: 11/01/07
DATA BASE: 9580	JOB NO. 9580
MPH CAD FILE: 13604-PD-035.DWG	

ST. JOHN THE BAPTIST PARISH, LOUISIANA
SECTION 92, T11S-R6E

LOUISIANA COORDINATE SYSTEM
(1983 SOUTH ZONE)

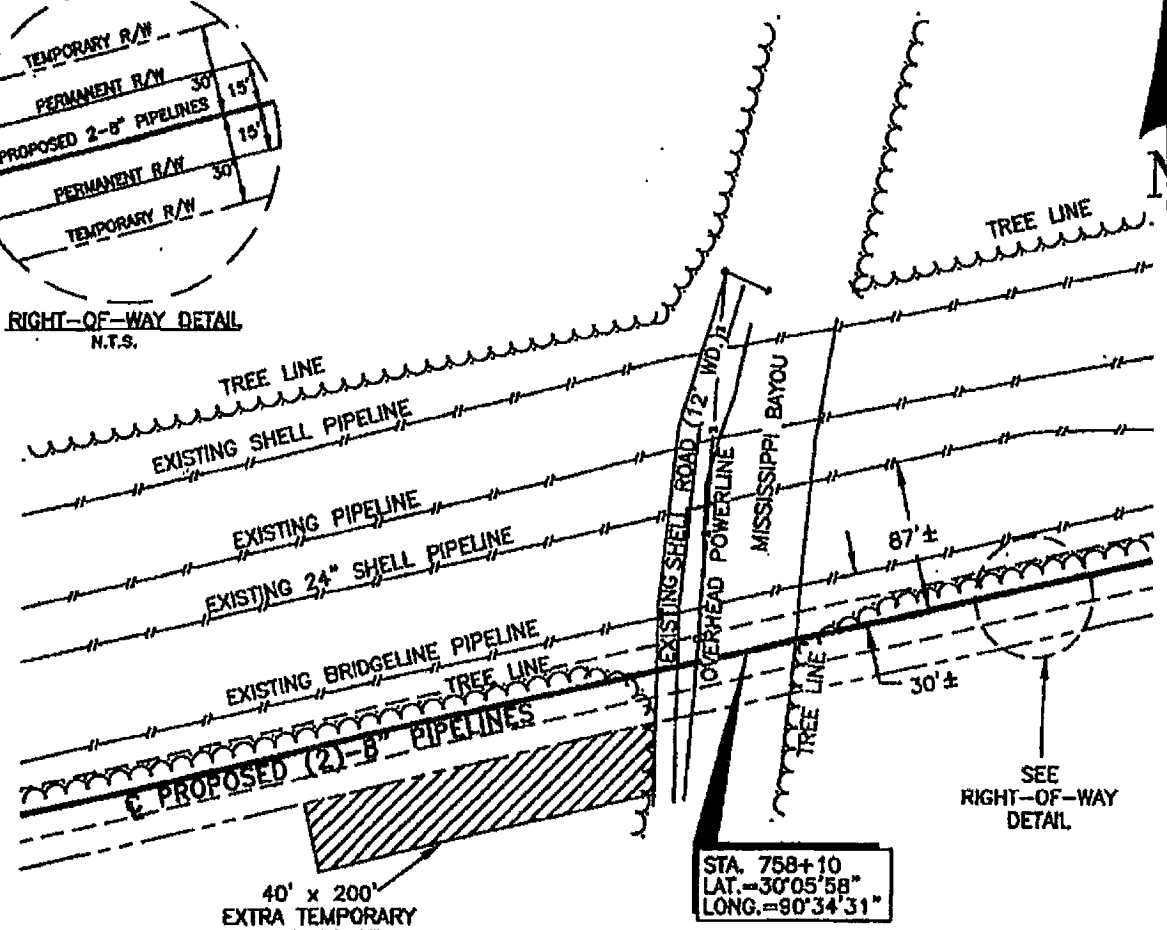
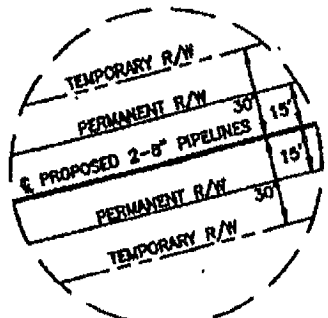

EXTRA TEMPORARY WORKSPACES IMPACTED
FORESTED WETLAND = 0.19 ACRES
PIPELINES WILL BE INSTALLED BY HORIZONTAL
DIRECTIONAL DRILL OR OPEN CUT METHOD.

PLAN

SEE SHEET 42 FOR BANK
STABILIZATION DETAIL.
SEE SHEET 40 FOR TYPICAL
WATERWAY CROSSING DETAIL.



NO.	DATE	REV. BY:	REVISION

SORRENTO PIPELINE COMPANY, LLC

DETAIL PLAN



Morris P. Hebert, Inc.
SURVEYING • ENGINEERING • ENVIRONMENTAL SERVICES • FIELD SERVICES • GIS
P.O. BOX 3108 • 283 CORPORATE DRIVE • HOUMA, LOUISIANA 70381 • (985) 878-2731
10101 SOUTHWEST FREEWAY • SUITE 400 • HOUSTON, TEXAS 77074 • (713) 218-1470

DRAWN BY: C J G	SHEET: 38
CHKD./APPD. BY: J M H	SCALE: SHOWN
UPDATED BY: D P M	DATE: 12/12/07
DATA BASE: 9580	JOB NO. 9580
MPH CAD FILE: 13604-PD-038.DWG	

W:\chng\9580\COE\13604-PD-038.dwg PLOT DATE: 12/21/07 8:39:01am

ST. JOHN THE BAPTIST PARISH, LOUISIANA
SECTIONS 82 & 95, T11S-R6E



STA. 861+80
LAT. = 30°05'34"
LONG = 90°36'23"

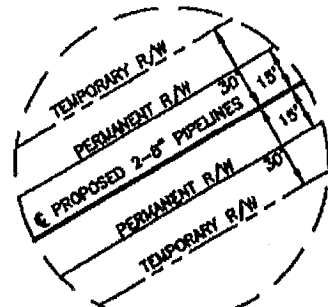
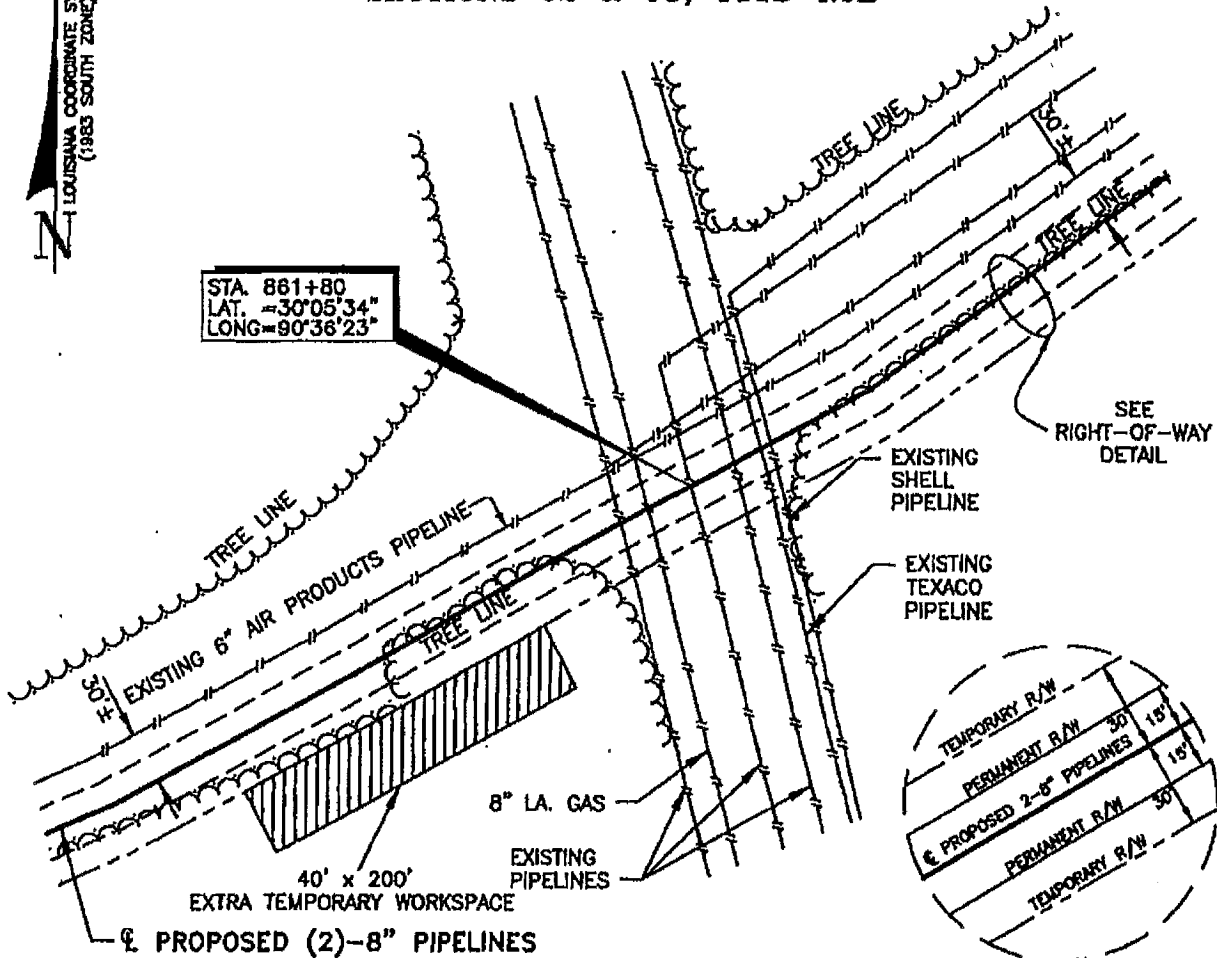

EXTRA TEMPORARY WORKSPACES IMPACTED
FORESTED WETLANDS = 0.19 ACRES

PLAN

GRAPHIC SCALE



NO.	DATE	REV. BY:	REVISION

SORRENTO PIPELINE COMPANY, LLC

DETAIL PLAN



Morris P. Hebert, Inc.
SURVEYING • ENGINEERING • ENVIRONMENTAL SERVICES • FIELD SERVICES • GIS
P.O. BOX 3108 • 283 CORPORATE DRIVE • HOUMA, LOUISIANA 70341 • (855) 879-2731
10101 SOUTHWEST FREEWAY • SUITE 400 • HOUSTON, TEXAS 77074 • (713) 219-1470

DRAWN BY: JDW	SHEET: 37
CHKD./APPD. BY: JMH	SCALE: SHOWN
UPDATED BY: DPM	DATE: 12/07/07
DATA BASE: 9580	JOB NO. 9580

MPH CAD FILE: 13604-PD-037.DWG

W:\eng\9580\COE\13604-PD-037.dwg PLOT DATE: 12/21/07 4:58:01am

TYPICAL ROAD CROSSING DETAIL

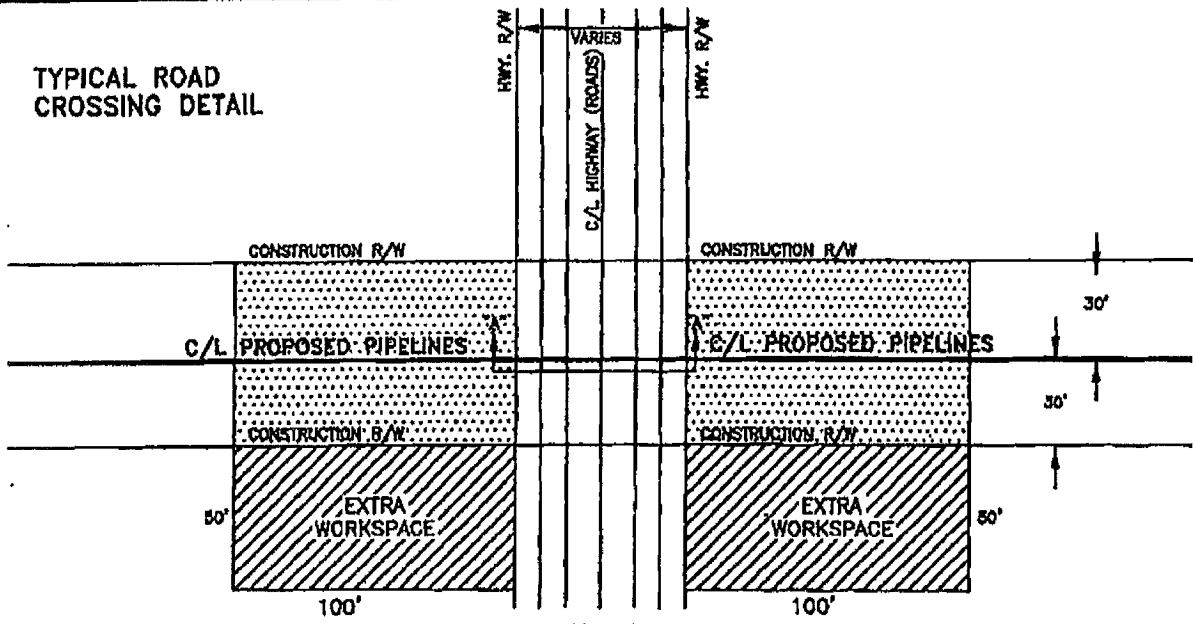

PLAN
N.T.S.

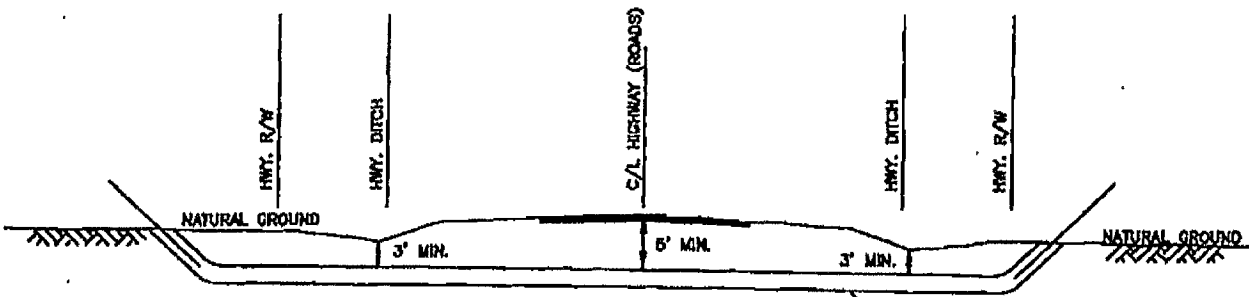

CROSS-SECTION "A" - "A"
N.T.S.

NOTE: PIPELINES WILL BE INSTALLED BY DIRECTIONAL DRILL OR BORE METHOD.

W:\dwg\9580\08E\13604-PD-038.dwg PLOT DATE: 1/8/08 8:41:52am

NO.	DATE	REV. BY	REVISION

SORRENTO PIPELINE COMPANY, LLC

TYPICAL ROAD CROSSING DETAIL

Morris P. Hebert, Inc.
 SURVEYING • ENGINEERING • ENVIRONMENTAL SERVICES • FIELD SERVICES • GIS
 P.O. BOX 3106 • 283 CORPORATE DRIVE • HOUMA, LOUISIANA 70341 • (985) 879-4731
 10101 SOUTHWEST FREEWAY • SUITE 400 • HOUSTON, TEXAS 77074 • (713) 219-1470

DRAWN BY: JDW	SHEET: 3B
CHKD./APPD. BY: JMH	SCALE: N.T.S.
UPDATED BY: DPM	DATE: 11/01/07
DATA BASE: 9580	JOB NO. 9580
MPH CAD FILE: 13604-PD-038.DWG	

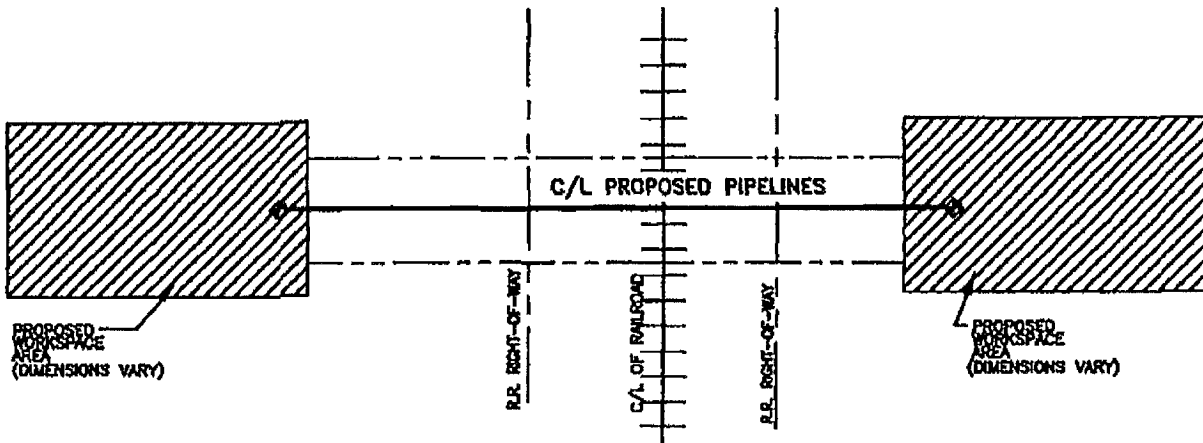

PLAN
N.T.S

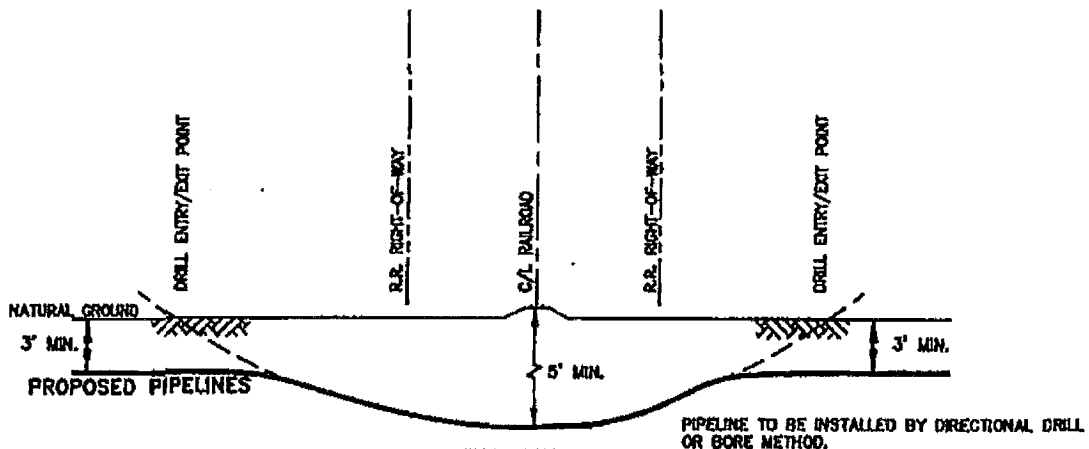

PROFILE
N.T.S

W:\dwg\9580\COE\13604-PD-039.dwg PLOT DATE: 12/21/07 9:06:19am

NO.	DATE	REV. BY:	REVISION

SORRENTO PIPELINE COMPANY, LLC

TYPICAL RAILROAD CROSSING DETAIL



Morris P. Hebert, Inc.

SURVEYING • ENGINEERING • ENVIRONMENTAL SERVICES • FIELD SERVICES • GIS
 P.O. BOX 3106 • 283 CORPORATE DRIVE • HOUMA, LOUISIANA 70361 • (985) 878-2751
 10101 SOUTHWEST FREEWAY • SUITE 400 • HOUSTON, TEXAS 77074 • (713) 219-1470

DRAWN BY: JDW	SHEET: 39
CHKD./APPD. BY: JMH	SCALE: SHOWN
UPDATED BY: DPM	DATE: 11/01/07
DATA BASE: 9580	JOB NO. 9580
MPH CAD FILE: 13604-PD-039.DWG	

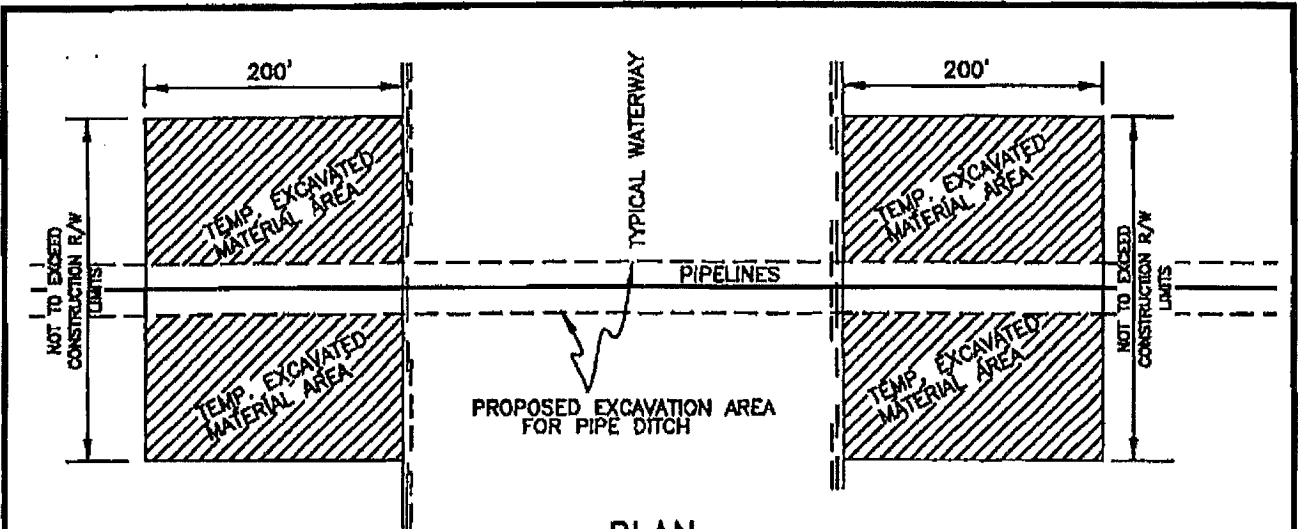

PLAN

N.T.S.

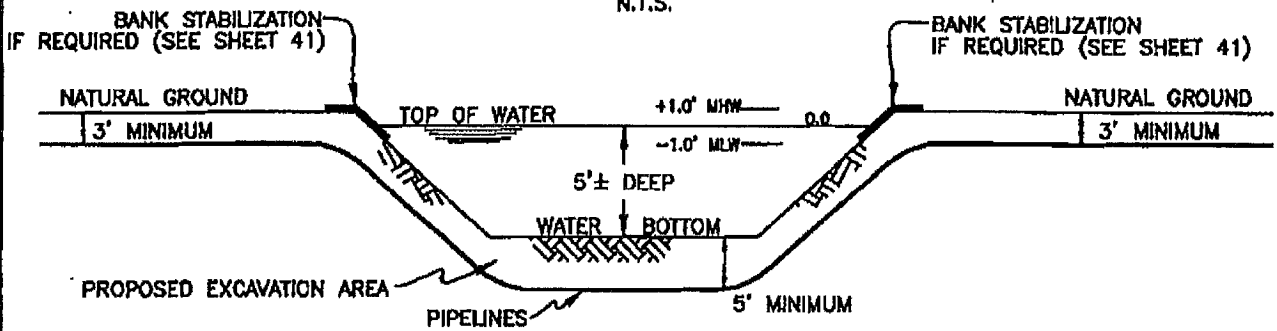

PROFILE

N.T.S.

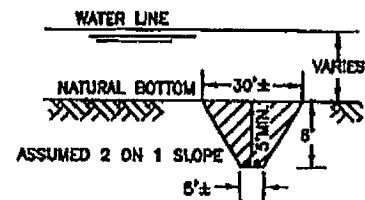

DITCH CROSS-SECTION

N.T.S.

EXCESS DREDGED OR EXCAVATED MATERIAL WILL BE TEMPORARILY PLACED ON THE BANK.

TYPICAL OPEN CUT WATERWAY CROSSING

NO.	DATE	REV. BY:	REVISION

SORRENTO PIPELINE COMPANY, LLC

TYPICAL WATERWAY PLAN & PROFILE AND TYPICAL DITCH CROSS-SECTION



Morris P. Hebert, Inc.

SURVEYING • ENGINEERING • ENVIRONMENTAL SERVICES • FIELD SERVICES • GIS
 P.O. BOX 3108 • 283 CORPORATE DRIVE • HOUMA, LOUISIANA 70361 • (985) 879-2731
 10101 SOUTHWEST FREEWAY • SUITE 400 • HOUSTON, TEXAS 77074 • (713) 219-1470

DRAWN BY: JOW	SHEET: 40
CHKD./APPD. BY: JMH	SCALE: N.T.S.
UPDATED BY: DPM	DATE: 11/01/07
DATA BASE: 9580	JOB NO. 9580
MPH CAD FILE: 13604-PD-040.DWG	

W:\dmg\0580\COE\13604-PD-040.dwg PLOT DATE: 1/24/08 3:11:04pm

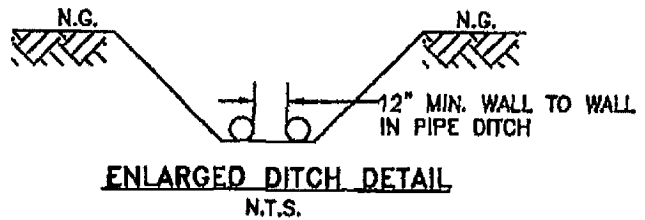
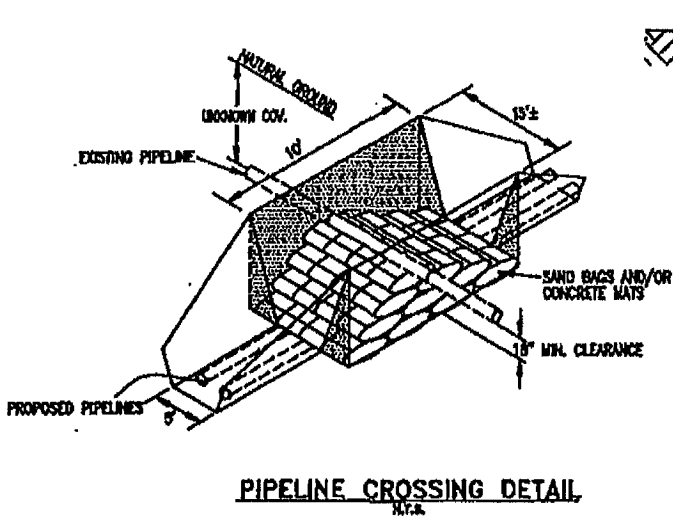
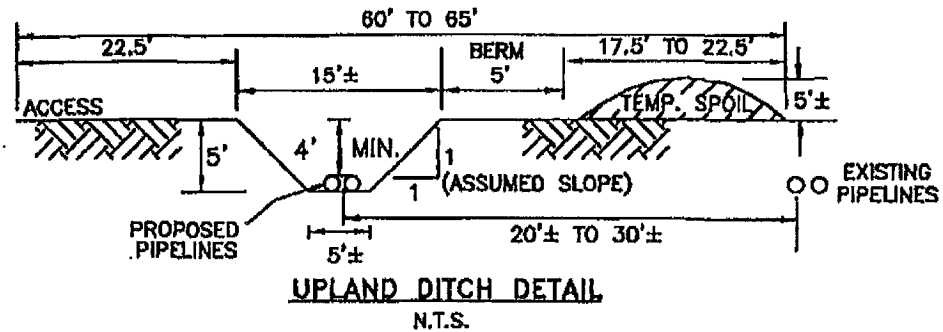
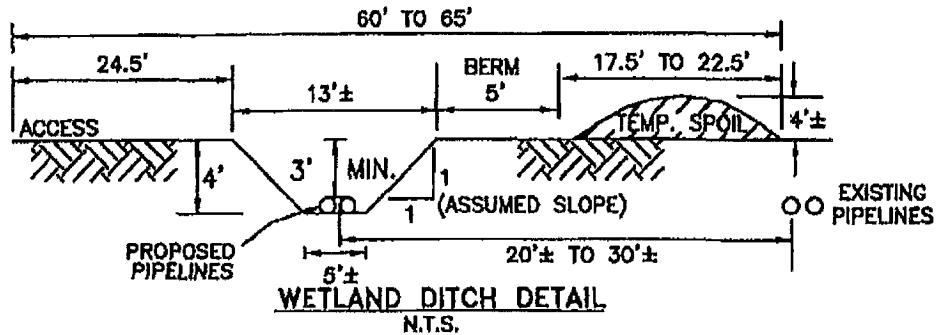

FILL
APPROX. 2 CU. YDS. OF SANDBAG/CONCRETE MAT MATERIAL REQUIRED FOR EACH OF THE ±10 SANDBAG BRACE INSTALLATIONS. TOTAL SANDBAG/CONCRETE MAT MATERIAL NEEDED IS APPROX. 20 CU. YDS.

W:\dmg\9580\COE\13604-PD-041.dwg PLOT DATE: 1/22/08 4:17:35pm

NO.	DATE	REV. BY:	REVISION

SORRENTO PIPELINE COMPANY, LLC

TYPICAL CROSS SECTIONS



SURVEYING • ENGINEERING • ENVIRONMENTAL SERVICES • FIELD SERVICES • GIS
P.O. BOX 3108 • 283 CORPORATE DRIVE • HOLMA, LOUISIANA 70381 • (845) 879-2731
10101 SOUTHWEST FREeway • SUITE 400 • HOUSTON, TEXAS 77074 • (713) 218-1470

DRAWN BY: JDW	SHEET: 41
CHKD./APPD. BY: JMH	SCALE: N.T.S.
UPDATED BY: WAS	DATE: 11/01/07
DATA BASE: 9580	JOB NO. 9580
MPH CAD FILE: 13604-PD-041.DWG	

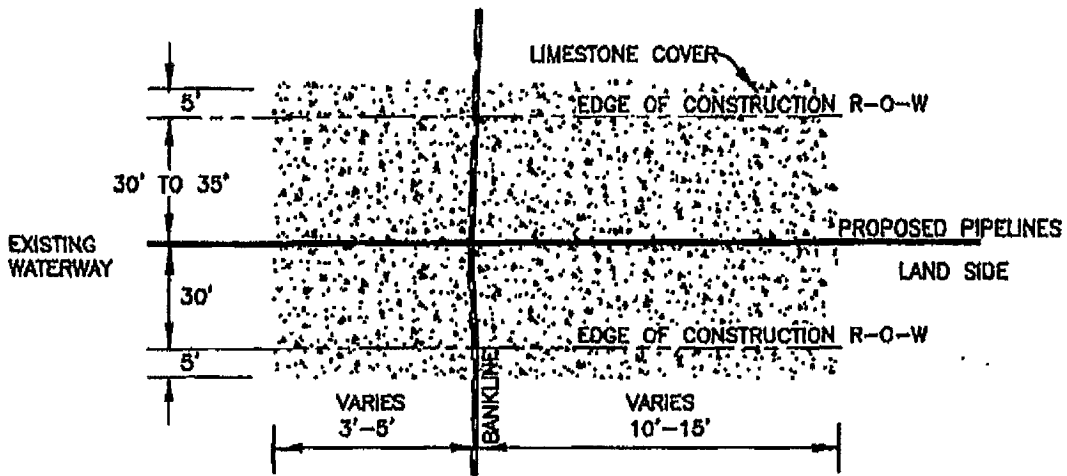

TYPICAL PLAN
N.T.S.

APPROXIMATELY 45 CUBIC YARDS (MAX.) OF LIMESTONE OR INTERLOCKING MATS TO BE PLACED OVER IMPACTED AREA PLUS AN ADDITIONAL 5 FEET BEYOND THE WIDTH OF THE IMPACTED AREA TO PROVIDE STABILIZATION ALONG DISTURBED BANKLINE.

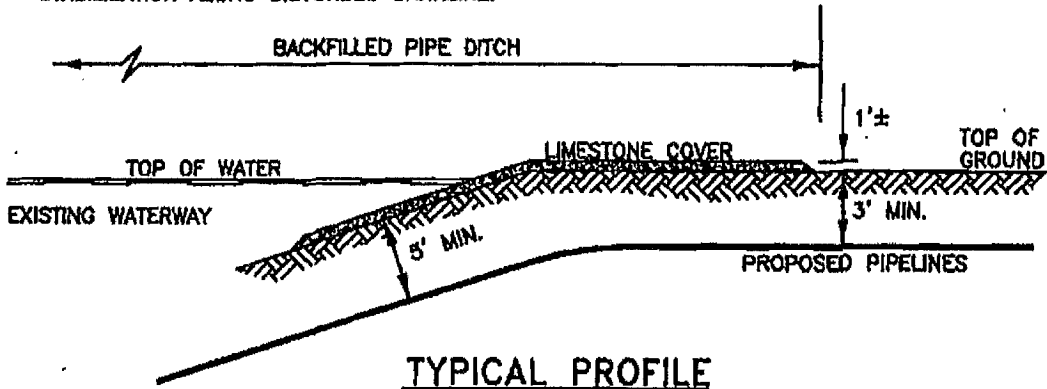

TYPICAL PROFILE
N.T.S.

W:\eng\95857\00E\13604-PD-042.dwg PLOT DATE: 12/21/07 6:20:18am

NO.	DATE	REV. BY:	REVISION
-----	------	----------	----------

SORRENTO PIPELINE COMPANY, LLC

TYPICAL PLAN & PROFILE

Morris P. Hebert, Inc.
 SURVEYING • ENGINEERING • ENVIRONMENTAL SERVICES • PILING SERVICES • GIS
 P.O. BOX 3108 • 283 CORPORATE DRIVE • MONROE, LOUISIANA 70381 • (504) 879-2731
 10101 SOUTHWEST FREEWAY • SUITE 400 • HOUSTON, TEXAS 77074 • (713) 218-1470

DRAWN BY: JDW	SHEET: 42
CHKD./APPD. BY: JMH	SCALE: N.T.S.
UPDATED BY: DPM	DATE: 11/01/07
DATA BASE: 9580	JOB NO. 9580
MPH CAD FILE: 13604-PD-042.DWG	

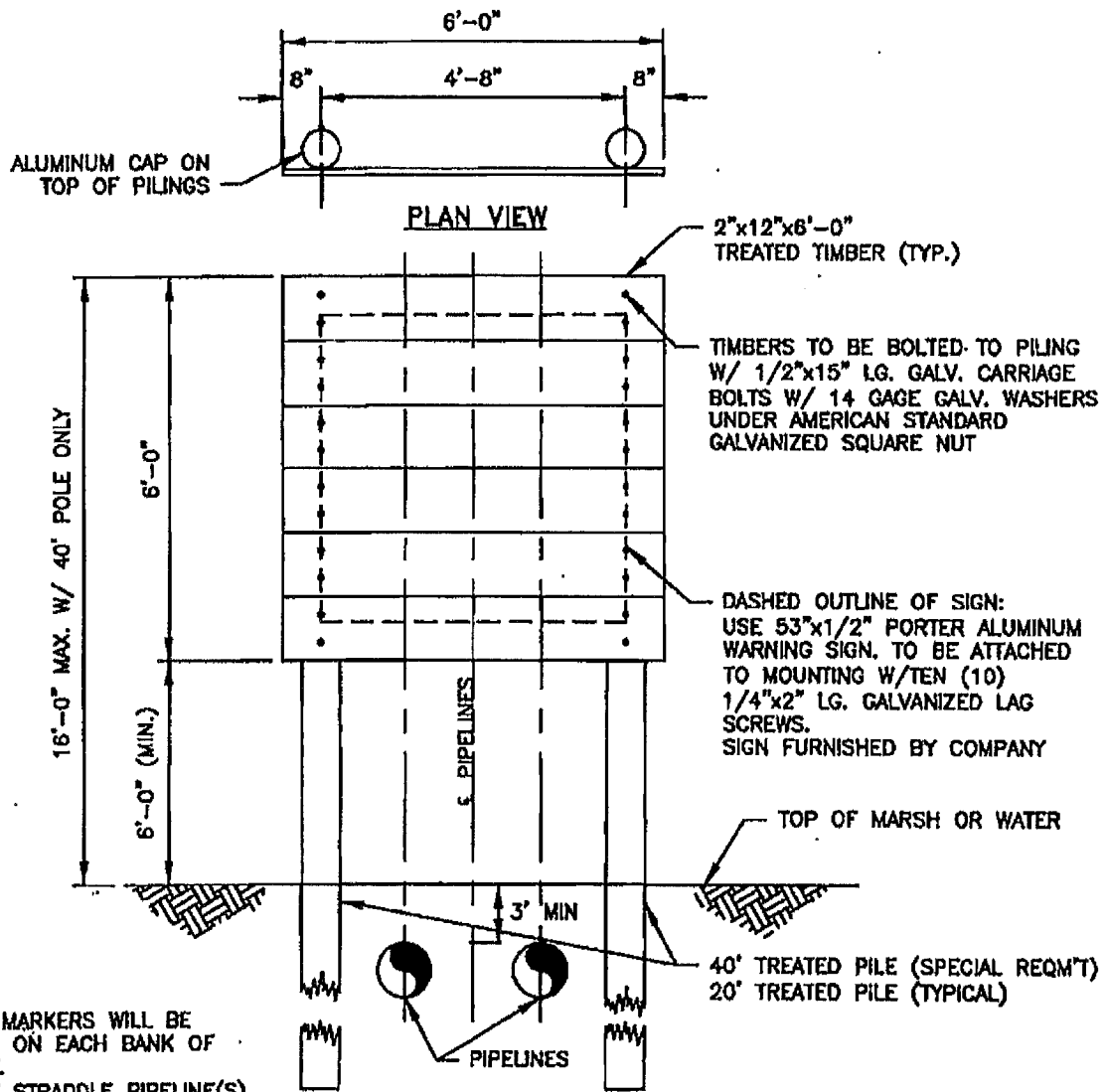

- NOTE:
1. WATERWAY MARKERS WILL BE INSTALLED ON EACH BANK OF WATERWAY.
 2. SIGN MUST STRADDLE PIPELINE(S).

TYPICAL WATERWAY MARKER
N.T.S.

W:\dwg\9580\COE\13804-PD-043.dwg PLOT DATE: 1/22/08 5:56:18am

NO.	DATE	REV. BY:	REVISION
-----	------	----------	----------

SORRENTO PIPELINE COMPANY, LLC

TYPICAL WATERWAY MARKER



Morris P. Hebert, Inc.
 SURVEYING • ENGINEERING • ENVIRONMENTAL SERVICES • FIELD SERVICES • GIS
 P.O. BOX 3108 • 283 CORPORATE DRIVE • HOUMA, LOUISIANA 70381 • (886) 879-2731
 10101 SOUTHWEST FREEWAY • SUITE 400 • HOUSTON, TEXAS 77074 • (713) 219-1470

DRAWN BY: JDW	SHEET: 43
CHKD./APPD. BY: JMH	SCALE: N.T.S.
UPDATED BY: MAS	DATE: 11/01/07
DATA BASE: 9580	JOB NO. 9580
MPH CAD FILE: 13804-PD-043.DWG	

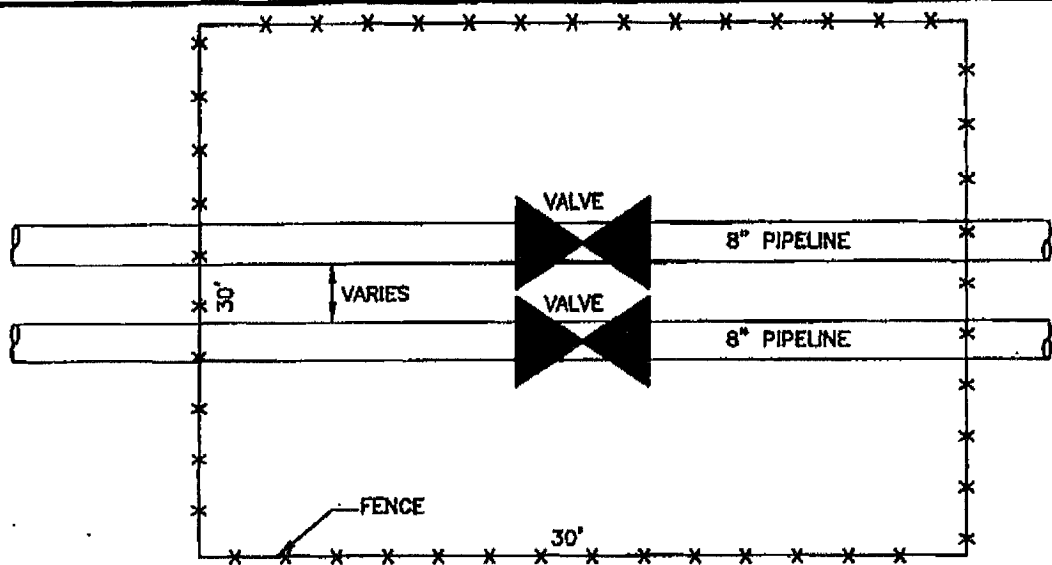

TYPICAL VALVE SITE
PLAN
N.T.S.

APPROX. ±35 CU. YDS. OF LIMESTONE
FILL REQUIRED.

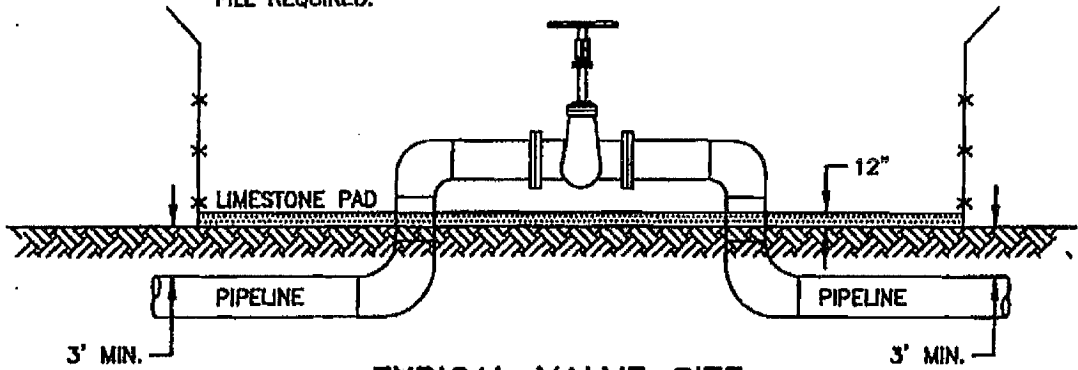

TYPICAL VALVE SITE
PROFILE
N.T.S.

W:\dwy\9580\COE\13604-PD-044.dwg PLOT DATE: 12/21/07 8:47:55am

NO.	DATE	REV. BY:	REVISION
-----	------	----------	----------

SORRENTO PIPELINE COMPANY, LLC

TYPICAL VALVE SITE PLAN & PROFILE

MPH
Morris P. Hebert, Inc.
SURVEYING • ENGINEERING • ENVIRONMENTAL SERVICES • FIELD SERVICES • CIV
P.O. BOX 3108 • 283 CORPORATE CIRCLE • HOUMA, LOUISIANA 70361 • (863) 878-2731
10101 SOUTHWEST FREEWAY • SUITE 400 • HOUSTON, TEXAS 77074 • (713) 219-1470

DRAWN BY: JDW	SHEET: 44
CHKD./APPO. BY: JMH	SCALE: N.T.S.
UPDATED BY: DPM	DATE: 11/01/07
DATA BASE: 9580	JOB NO. 9580
MPH CAD FILE: 13604-PD-044.DWG	

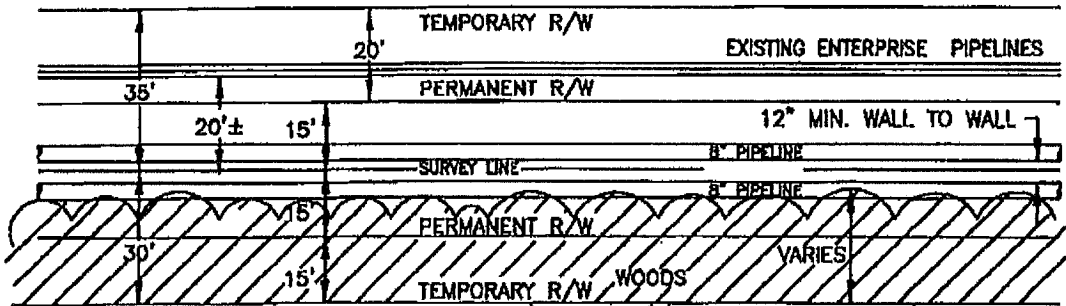

WETLAND R/W DETAIL (1)

N.T.S.

STATIONS	IMPACTED FORESTED WETLANDS		IMPACTED HERBACEOUS WETLANDS	
	PERMANENT	TEMPORARY	PERMANENT	TEMPORARY
51+44 TO 143+80	0.53	2.16	5.83	5.26
147+26 TO 157+44	0.05	0.24	0.65	0.57
159+17 TO 177+95	0.01	0.23	1.29	1.28
188+12 TO 293+83	1.64	3.59	5.64	4.88
322+06 TO 398+51	1.71	4.68	3.56	3.63
399+29 TO 572+02	6.34	4.25	8.09	7.93
577+13 TO 664+64	1.15	2.79	3.05	1.91
665+52 TO 722+07	1.29	1.91	2.61	2.64
TOTAL ACRES =	12.70 ±	19.85 ±	30.71 ±	28.09 ±

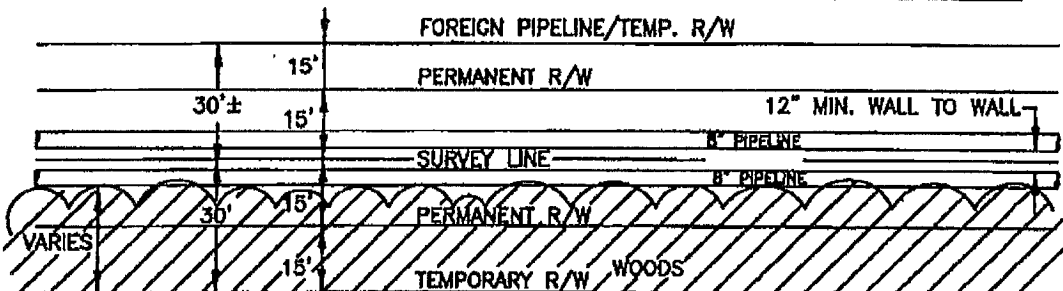

WETLAND R/W DETAIL (2)

N.T.S.

STATIONS	IMPACTED FORESTED WETLANDS		IMPACTED HERBACEOUS WETLANDS	
	PERMANENT	TEMPORARY	PERMANENT	TEMPORARY
722+82 TO 757+80	1.94	1.15	0.47	1.27
758+39 TO 940+08	9.09	6.29	3.43	6.22
TOTAL ACRES =	11.02 ±	7.44 ±	3.90 ±	7.48 ±

W:\dwg\13604\13604-PD-045.dwg PLOT DATE: 1/5/08 7:22:21 am

NO.	DATE	REV. BY	REVISION

SORRENTO PIPELINE COMPANY, LLC

WETLAND R/W DETAILS



Morris P. Hebert, Inc.
 SURVEYING • ENGINEERING • ENVIRONMENTAL SERVICES • FIELD SERVICES • GIS
 P.O. BOX 3106 • 283 CORPORATE DRIVE • HOUMA, LOUISIANA 70361 • (865) 879-2731
 10101 SOUTHWEST FREWAY • SUITE 400 • HOUSTON, TEXAS 77074 • (713) 219-1470

DRAWN BY: JDW	SHEET: 45
CHKD./APPD. BY: JMH	SCALE: N.T.S.
UPDATED BY: DPM	DATE: 11/01/07
DATA BASE: 9580	JOB NO. 9580
MPH CAD FILE: 13604-PD-045.DWG	

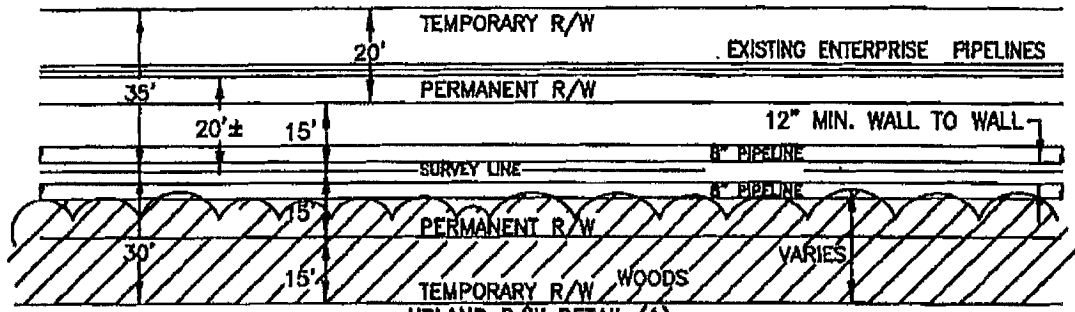

UPLAND R/W DETAIL (1)
N.T.S.

STATIONS	IMPACTED FORESTED UPLANDS		IMPACTED HERBACEOUS UPLANDS	
	PERMANENT	TEMPORARY	PERMANENT	TEMPORARY
0+00 TO 33+45.68	0.18	0.19	2.12	2.48
177+94.59 TO 188+11.83	0.01	0.12	0.69	0.69
287+02.31 TO 300+82.57	0.00	0.00	0.28	0.31
575+54.87 TO 591+86.55	0.37	0.24	0.83	0.73
TOTAL ACRES =	0.56 ±	0.55 ±	3.91 ±	4.21 ±

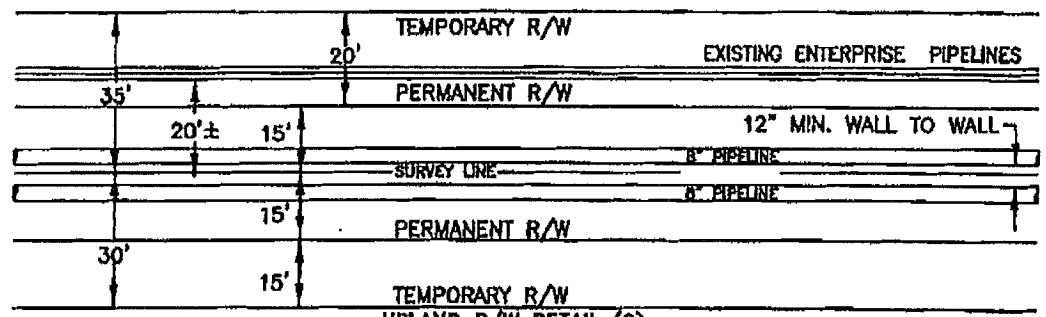

UPLAND R/W DETAIL (2)
N.T.S.

STATIONS	IMPACTED UPLANDS (CANE FIELD)	
	PERMANENT	TEMPORARY
940+08.12 TO 1017+01.25	5.30	6.18
TOTAL ACRES =	5.30 ±	6.18 ±

EXTRA TEMPORARY WORKSPACE IMPACTS:

1. IMPACTED FORESTED UPLAND - 0.97± ACRES
2. IMPACTED FORESTED WETLAND - 6.72± ACRES
3. IMPACTED HERBACEOUS UPLAND - 2.08± ACRES
4. IMPACTED HERBACEOUS WETLAND - 2.11± ACRES

W:\proj\9580\COE\13604-PD-046.dwg PLOT DATE: 1/5/08 7:25:38am

NO.	DATE	REV. BY	REVISION

SORRENTO PIPELINE COMPANY, LLC

WETLAND R/W DETAILS



Morris P. Hebert, Inc.
 SURVEYING • ENGINEERING • ENVIRONMENTAL SERVICES • FIELD SERVICES • GIS
 P.O. BOX 3106 • 283 CORPORATE DRIVE • HOUMA, LOUISIANA 70361 • (828) 876-2731
 10101 SOUTHWEST FREEWAY • SUITE 400 • HOUSTON, TEXAS 77074 • (713) 219-1470

DRAWN BY: JDW	SHEET: 48
CHKD./APPD. BY: JMH	SCALE: N.T.S.
UPDATED BY: DPM	DATE: 11/01/07
DATA BASE: 9580	JOB NO. 9580
MPH CAD FILE: 13604-PD-046.DWG	

NOTES:

1. AS-BUILT DRAWINGS SHALL BE SUBMITTED WITHIN 90 DAYS OF COMPLETION OF THIS PROJECT TO THE LOUISIANA DEPARTMENT OF NATURAL RESOURCES, OFFICE OF CONSERVATION, PIPELINE DIVISION, P.O. BOX 44487, BATON ROUGE, LA. 70804-4487 AND TO THE LOUISIANA DEPARTMENT DIVISION, P.O. BOX 44487, BATON ROUGE, LA. 70804-4487.
2. IN ORDER TO ENSURE THE SAFETY OF ALL PARTIES, THE PERMITTEE SHALL CONTACT THE LOUISIANA ONE CALL SYSTEM (1-800-272-3020) A MINIMUM OF 48 HOURS PRIOR TO THE COMMENCEMENT OF ANY EXCAVATION (DIGGING, DREDGING, JETTING, ETC.) OR DEMOLITION ACTIVITY.
3. MATERIAL WHICH WILL HAVE BEEN EXCAVATED BY BACK HOE WILL BE PLACED ADJACENT TO PIPE DITCH DURING CONSTRUCTION. FOLLOWING CONSTRUCTION, SPOIL WILL BE RETURNED TO DITCH.
4. IMPACTED TREES TO BE CHIPPED AND/OR REMOVED FROM PROJECT SITE.
5. 24.09 ACRES OF EXCAVATION IN WETLANDS. (FORESTED & HERBACEOUS)
6. 4.84 ACRES OF EXCAVATION IN UPLANDS. (FORESTED & HERBACEOUS)
7. 0.22 ACRES OF EXCAVATION IN WATER CROSSINGS.
8. 107,649 CUBIC YARDS OF EXCAVATION IN WETLANDS.
9. 26,052 CUBIC YARDS OF EXCAVATION IN UPLANDS.
10. 1,254 CUBIC YARDS OF EXCAVATION IN WATERWAYS.
11. 107,649 CUBIC YARDS OF SPOIL IN WETLANDS.
12. 26,052 CUBIC YARDS OF SPOIL IN UPLANDS.
13. 1,254 CUBIC YARDS OF SPOIL IN WATERWAYS.
14. 949 CUBIC YARDS OF FILL (LIMESTONE) FOR BANK STABILIZATION & VALVE SITES.
15. 0.54 ACRES OF FILL (LIMESTONE) FOR BANK STABILIZATION & VALVE SITES.
16. 0.08 ACRES OF FILL (DIRT) FOR LEVEE CROSSINGS.
17. 3,974 CUBIC YARDS OF FILL (DIRT) FOR LEVEE CROSSINGS.

W:\DWG\9580\COE\13604-PD-047.dwg PLOT DATE: 1/22/08 4:14:54pm

NO.	DATE	REV. BY:	REVISION
-----	------	----------	----------

SORRENTO PIPELINE COMPANY, LLC

NOTES



Morris P. Hebert, Inc.

SURVEYING • ENGINEERING • ENVIRONMENTAL SERVICES • FIELD SERVICES • GIS
 P.O. BOX 3154 • 283 CORPORATE DRIVE • HOUMA, LOUISIANA 70361 • (848) 878-2731
 10101 SOUTHWEST FREWAY • SUITE 400 • HOUSTON, TEXAS 77074 • (713) 219-1470

DRAWN BY: JDW	SHEET: 47
CHKD./APPD. BY: JMH	SCALE: NONE
UPDATED BY: DPM	DATE: 11/01/07
DATA BASE: 9580	JOB NO. 9580
MPH CAD FILE: 13604-PD-047.DWG	