

*Ord.*  
**2011-0130**

**INTRODUCED BY: V.J. ST. PIERRE, JR., PARISH PRESIDENT**

**ORDINANCE NO. 11-4-29**

An ordinance to amend Ordinance No. 10-1-4, Department of the Army License No. DACW29-2-07-01, Easement for Boat Ramp, Access Road and Parking Lot in the Bonnet Carre' Spillway at Interstate 10 in Norco to approve Amendment No. 2 as requested by the Dept. of Army.

**WHEREAS,** St. Charles Parish currently has a Department of the Army License for use of the property at Interstate 10 in the Bonnet Carre' Spillway for a Boat Ramp, Access Road and Parking Lot ( DACW29-2-07-01); and,

**WHEREAS,** the Department of the Army has proposed to amend said Easement to show the proposed repairs to the Bonnet Carre' Spillway boat launch, identified as Exhibit B, Pages 1 - 3; and,

**WHEREAS,** it is the desire of the Parish Council to approve said Amendment No. 2.

**THE ST. CHARLES PARISH COUNCIL HEREBY ORDAINS:**

**SECTION I.** That Amendment No. 2 to Easement No. DACW29-2-07-01 for the proposed repairs to the Bonnet Carre' Spillway boat launch at Interstate 10 in Norco is hereby approved.

**SECTION II.** That the Parish President is hereby authorized to execute said Amendment No. 2 on behalf of the St. Charles Parish Council.

The foregoing ordinance having been submitted to a vote, the vote thereon was as follows:

YEAS: SCHEXNAYDRE, AUTHEMENT, RAYMOND, TASTET, BENEDETTO, HOGAN, COCHRAN, LAMBERT, NUSS

NAYS: NONE

ABSENT: NONE

And the ordinance was declared adopted this 18th day of April, 2011, to become effective five (5) days after publication in the Official Journal.

CHAIRMAN: *[Signature]*

SECRETARY: *[Signature]*

DLVD/PARISH PRESIDENT: April 19, 2011

APPROVED: \_\_\_\_\_ DISAPPROVED: \_\_\_\_\_

PARISH PRESIDENT: *[Signature]*

RETD/SECRETARY: April 20, 2011

AT: 12:50 p.m. RECD BY: *[Signature]*

RECORDED IN THE ST. CHARLES PARISH  
CLERK OF COURT OFFICE

ON June 3, 2016

AS ENTRY NO. 415347

IN MORTGAGE/CONVEYANCE BOOK

NO. 833 FOLIO 222

AMENDED

ORD. 07-1-11

ORD. 10-1-4

\_\_\_\_\_

\_\_\_\_\_

\_\_\_\_\_

\_\_\_\_\_

\_\_\_\_\_

AMENDMENT NO. 2  
TO EASEMENT NO. DACW29-2-07-01

WHEREAS, on 1 February 2007, Easement No. DACW29-2-07-01 was entered into between the Government, as Grantor, and St. Charles Parish Council, as Grantee, to construct, use, maintain, control, operate and repair a boat launching ramp, an access road to the ramp, and a parking area, in our Bonnet Carre Spillway Project, Sections 39 & 40, Township 11 South, Range 8 East, St. Charles Parish, Louisiana.

WHEREAS, it is acceptable to the Secretary of the Army to continue the easement until 1 October 2031.

WHEREAS, on 26 January 2010, Amendment No. 1 was issued, Page 6 was amended to include Conditions 25 and 26 which states:

25. The grantee is required to maintain and refurbish the existing access road along the top of the Bonnet Carre Spillway east guide levee, during construction activities.

26. This permit does not authorize interference with an existing or proposed federal project, therefore the grantee shall uphold coordination and conformity with the USACE, Bonnet Carre Spillway Manager, in order to maintain integrity of existing public access along the eastern guide levee and/or incorporate necessary improvements for public access to the recreational park.

NOW THEREFORE, Exhibit B, Pages 1- 3 are amended to show the proposed repairs to the Bonnet Carre Spillway boat launch. Attached is Exhibit B, Pages 1-3 and made part of this instrument.

IN WITNESS WHEREOF, I have hereunto set my hand by authority of the Secretary of the Army this 9<sup>th</sup> day of May 2011.

WITNESSES:

Signed: Sheila B. Mills

Printed Name: Sheila B. Mills

Signed: Keokak Jones

Printed Name: Keokak Jones

Janet R. Crisp  
LINDA C. LABURE  
Chief, Real Estate Division  
U.S. Army Corps of Engineers  
New Orleans District

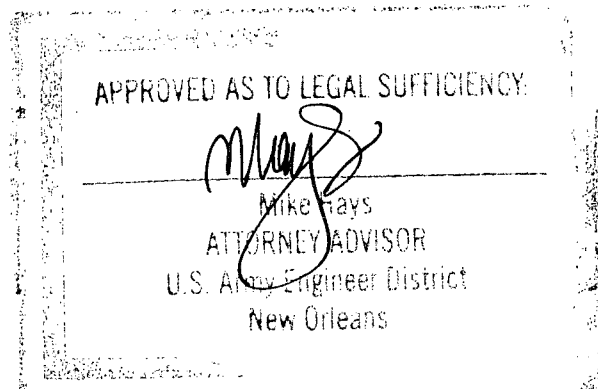

The above Amendment is hereby accepted this 20<sup>th</sup> of April, 2011.

ST. CHARLES PARISH COUNCIL

Signed: VJ St Pierre

Typed Name: V.J. St. Pierre, Jr.

Title: Parish President

WITNESSES:

Signed: Valarie Berthelot

Printed Name: Valarie Berthelot

Signed: Nicole Breaux

Printed Name: Nicole Breaux

**CERTIFICATE OF AUTHORITY**

I, Leon E. Via, do hereby certify that I am the principle legal officer of the St. Charles Parish Council (SCPC), that the SCPC is a legally constituted public body with full authority and legal capability to adhere and comply with the terms and conditions for Easement No. DACW29-2-07-01, and subsequent amendments thereto, for a boat launching ramp, access road and parking area, in connection with the Bonnet Carre Spillway Project, and that the persons who executed Easement No. DACW29-2-07-01 on behalf of the SCPC has acted within their statutory authority.

IN WITNESS WHEREOF, I have made and executed this certification on this 21 day of May, 2011.

Signed: Leon E. Via

Printed name: Leon E. Via

Title: Director of Legal Services

**ACKNOWLEDGMENT**

STATE OF Louisiana

COUNTY/PARISH OF St. Charles

On this 2<sup>nd</sup> day of May, 2011, before me appeared V. J. St. Pierre, Jr.,  
to me personally known, who, being by me duly sworn, did say that he is the Parish President  
of St. Charles Parish Council (SCPC), and that the easement was signed in behalf of SCPC, by  
authority duly and legally granted and bestowed upon him, and that SCPC acknowledged the  
easement to be the free act and deed of SCPC and the SCPC has no seal.

**IN WITNESS WHEREOF**, I have hereunto set my hand and official seal.

Signed: 

Printed Name: Leon E. Van 1st

Notary Public  
State of Louisiana

Parish of \_\_\_\_\_

My Commission Expires: at death

Bar Association Number: 59825

**ACKNOWLEDGEMENT OF WITNESS FOR AMENDMENT NO. 2 TO  
EASEMENT NO. DACW29-2-07-01**

BEFORE ME, the undersigned authority, this day personally came and appeared the undersigned person, duly sworn, who did depose and state that she executed the foregoing amendment agreement as subscribing witness thereto, and that the amendment agreement was signed and executed by JANET R. CRUPPI, and that she knows JANET R. CRUPPI to be the identical person who executed the same and saw JANET R. CRUPPI sign her name in her capacity as Deputy Chief, Real Estate Division, CEMVN, on behalf of the United States, as the voluntary act and deed of the United States, and for the purposes and considerations therein expressed, in her presence and in the presence of the other subscribing witness.

Signed: Sheila B. Mills (Appearer)  
Printed Name: Sheila B. Mills

SWORN TO AND SUBSCRIBED BEFORE ME this 18<sup>th</sup> day of May 2011.

Signed: Mike Hays (Notary)  
Printed name: \_\_\_\_\_

Louisiana Bar Association Number: 06700

My Commission expires \_\_\_\_\_  
**MIKE HAYS**  
**Attorney - Notary Public**  
**My Commission Is For Life**



**PRINCIPAL**  
 Engineering, Inc.  
 10118 C. Maudrye Blvd., Suite 10  
 Metairie, LA 70001  
 Phone (504) 885-2200 Fax (504) 885-2300

SCALE  
 1/4" = 40 FEET  
 DATE  
 OCTOBER 2010

**BONNET CARRE SPILLWAY**  
**BOAT LAUNCH**  
**ST. CHARLES PARISH**  
**LOUISIANA**  
 SITE LAYOUT

SHEET NO  
**1 OF 2**

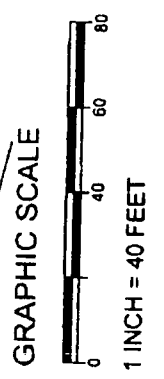
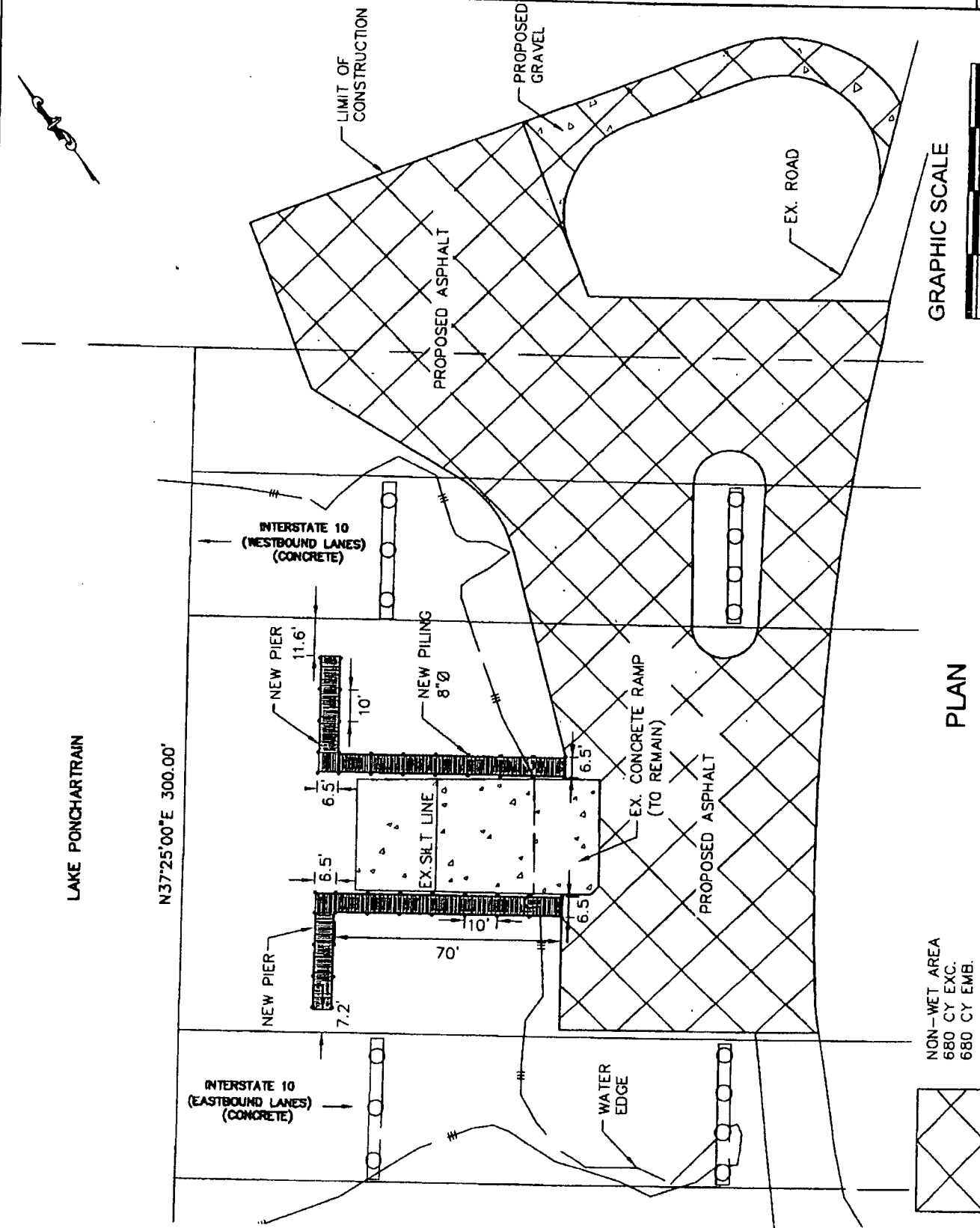

**PLAN**

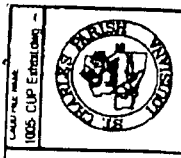

**PRINCIPAL**  
*Engineering, Inc.*  
 1011 N. Calumet Blvd., Suite 10  
 Metairie, LA 70001  
 Phone: (504) 885-2001 Fax: (504) 885-2003

SCALE: 1 INCH = 3 FEET  
 DATE: OCTOBER 2010

**BONNET CARRE SPILLWAY**  
 BOAT LAUNCH  
 ST. CHARLES PARISH  
 LOUISIANA  
 TYPICAL SECTION

SHEET NO. 2 OF 2

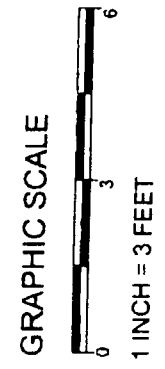
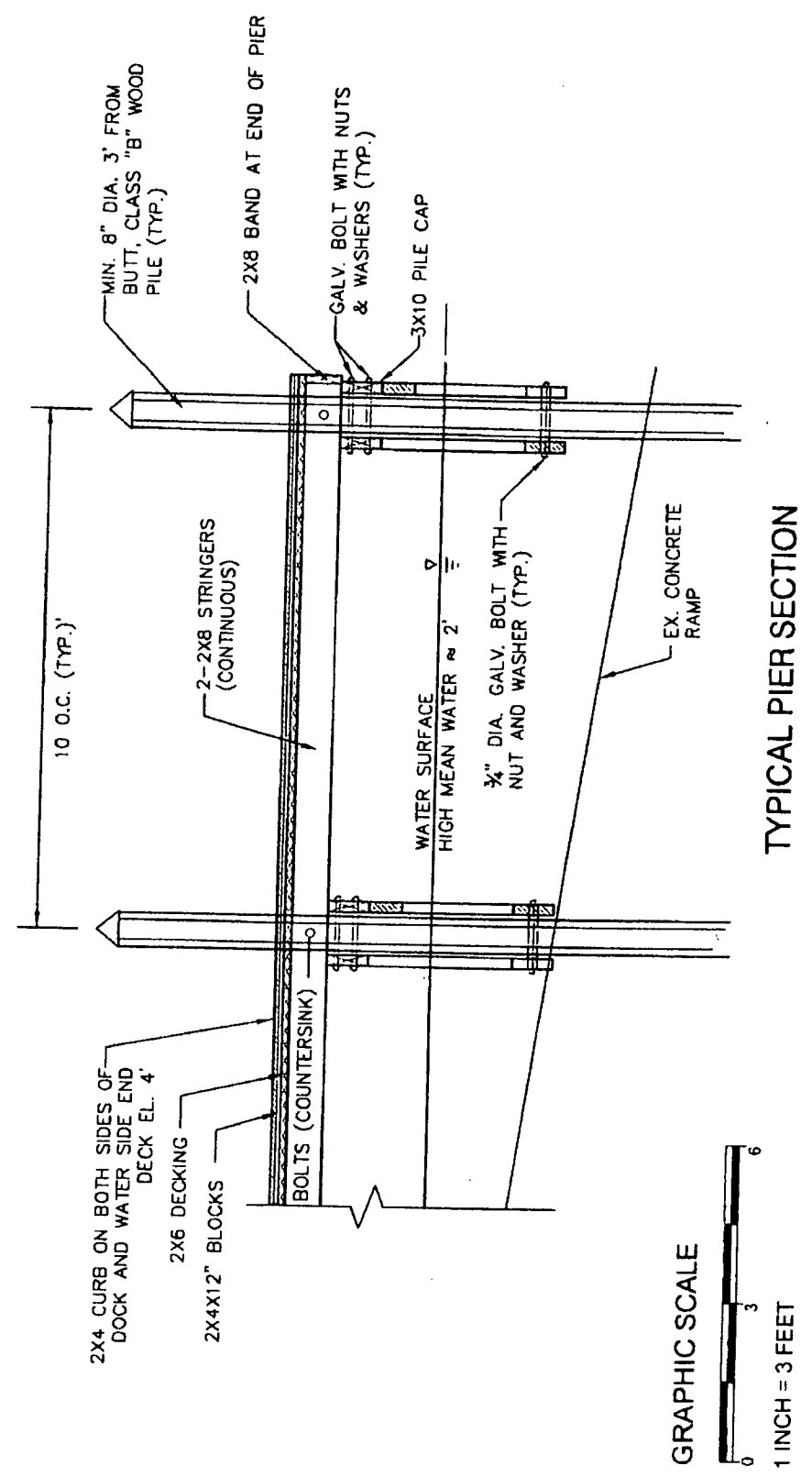
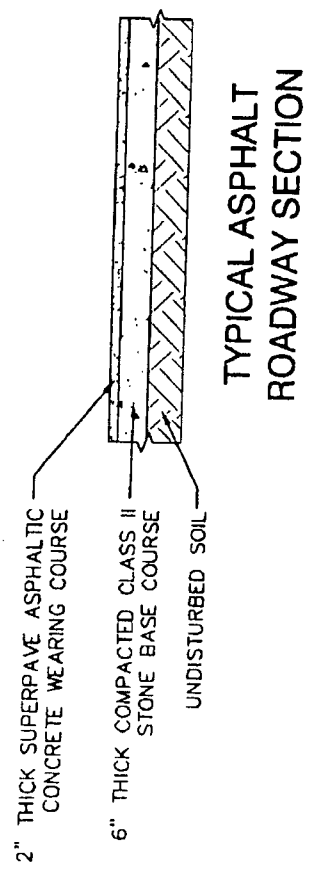
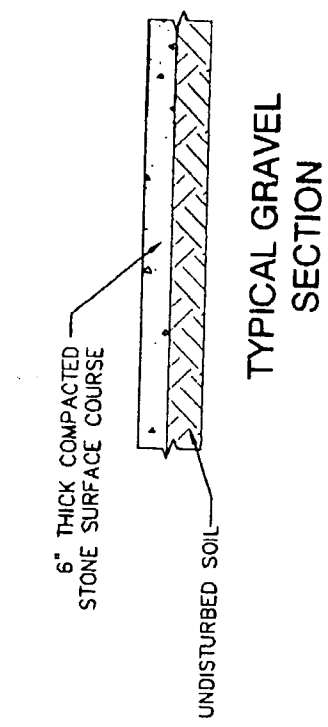



DESCRIPTION OF A PARCEL OF LAND FOR  
THE BONNET CARRE SPILLWAY BOAT LAUNCHING RAMP

Commence at a point, which said point is known as the U.S. Army Corps of Engineers centerline levee monument LMS-22 located at levee station 276 + 92.48, Bonnet Carre Spillway Lower Guide Levee and having Louisiana coordinates X = 2304472.9175 and Y = 506619.4820, in T11S, R8E, Section 39, St. Charles Parish east of the Mississippi River. Thence South  $36^{\circ}33'21''$  West along the centerline of said levee as defined between centerline of levee monuments LMS-21 and LMS-22 a distance of 428.69 feet to a point, which said point is also on the surveyed centerline of Interstate Highway 10 at highway survey station 305 + 12, thence North  $36^{\circ}55'00''$  East a distance of 150.01 feet to a point on the northern right of way line of Interstate Highway 10 said point being the Point of Beginning, thence South  $52^{\circ}35'$  East along the northern right of way line a distance of 210 feet to a point, thence South  $37^{\circ}25'$  West a distance of 300 feet to a point located on the southern right of way line of Interstate Highway 10, thence North  $52^{\circ}35'$  West along the southern right of way line a distance of 450 feet to a point, thence North  $37^{\circ}25'$  East a distance of 300 feet to a point located on the northern right of way line of Interstate Highway 10, thence South  $52^{\circ}35'$  East along the northern right of way line a distance of 240 feet to the Point of Beginning and containing 3.099 acres.

