

matmore, Inc.
 101 Mulberry Dr
 Metairie, La. 70005

matmore, Inc.
 101 Mulberry Dr.
 Metairie, La. 70005

Benny Pughie
 Lot 1, Blk. 14
 4-001-014-0001
 213 Short St.
 Boutte, La
 70039

Benny Pughie
 Lots 1, 2, 3
 Blk 12
 4-001-012-0001
 4-001-012-0005
 213 Short St.
 Boutte, La
 70039

Zoning District R1A
 Zoning District C2

Zoning District R1A
 Zoning District C2

Sidney Stable

4-15-6-17A

SAM ST
Perch St

Oliver Burre
 Lots 1 & 2 Blk 10
 4-001-010-0002
 207 Sam St.
 Boutte, La.

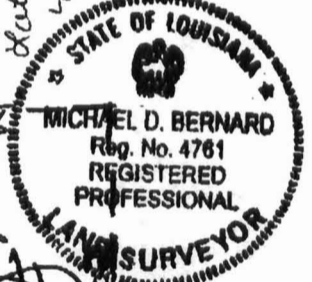

4-015-007-00004
Charles
Ragande
 P.O. Box 726
 Luling, La
 70070

Burger King
 #12830
 4-015-007-009-A
 Land & Building
 Sydney Sw. II L.P.
 3000 Executive Pkwy
 Suite 515
 San Ramon, CA. 94583

Third Street

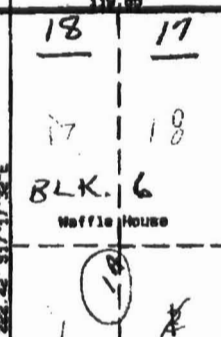

W.H. Capital
 Lot 1A

Jinny, Inc.
 4-015-006-00001
 5-5-2003
 Lot 2A

4-515-006-001-A US 90 Eastbound

5986 Commercial Dr
 Metairie, La. 30071

US 90 Westbound

SCALE 1"=100'

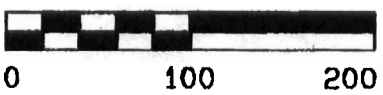

This SKETCH does not represent an actual ground survey, and should not be interpreted as such. This is only a representation of portions of planned uses on the property.

Rezoning of Approx. 5 Acres From R1-A and C2 To R3, on Lands of Sidney Stable, which are Undivided & Unnamed parcels in Mosella Townsite Section 2, T14S R20E St. Charles Parish La.

MICHAEL D. BERNARD, P.L.S.
 LICENSED LAND SURVEYOR
 29 E. LEVY LULING, LOUISIANA 70079
 PHONE (504) 381-8031 FAX (504) 788-8214

DATE: 6/20/03	PLOT SCALE: 1" = 100'	DRAWING NO. OF 1
DRAWN BY: MEB	CHECKED BY: GGD	
CHECKED BY:	CHECKED BY: MEB	APPROVED BY: