

GNOL Landfill
St Charles Area

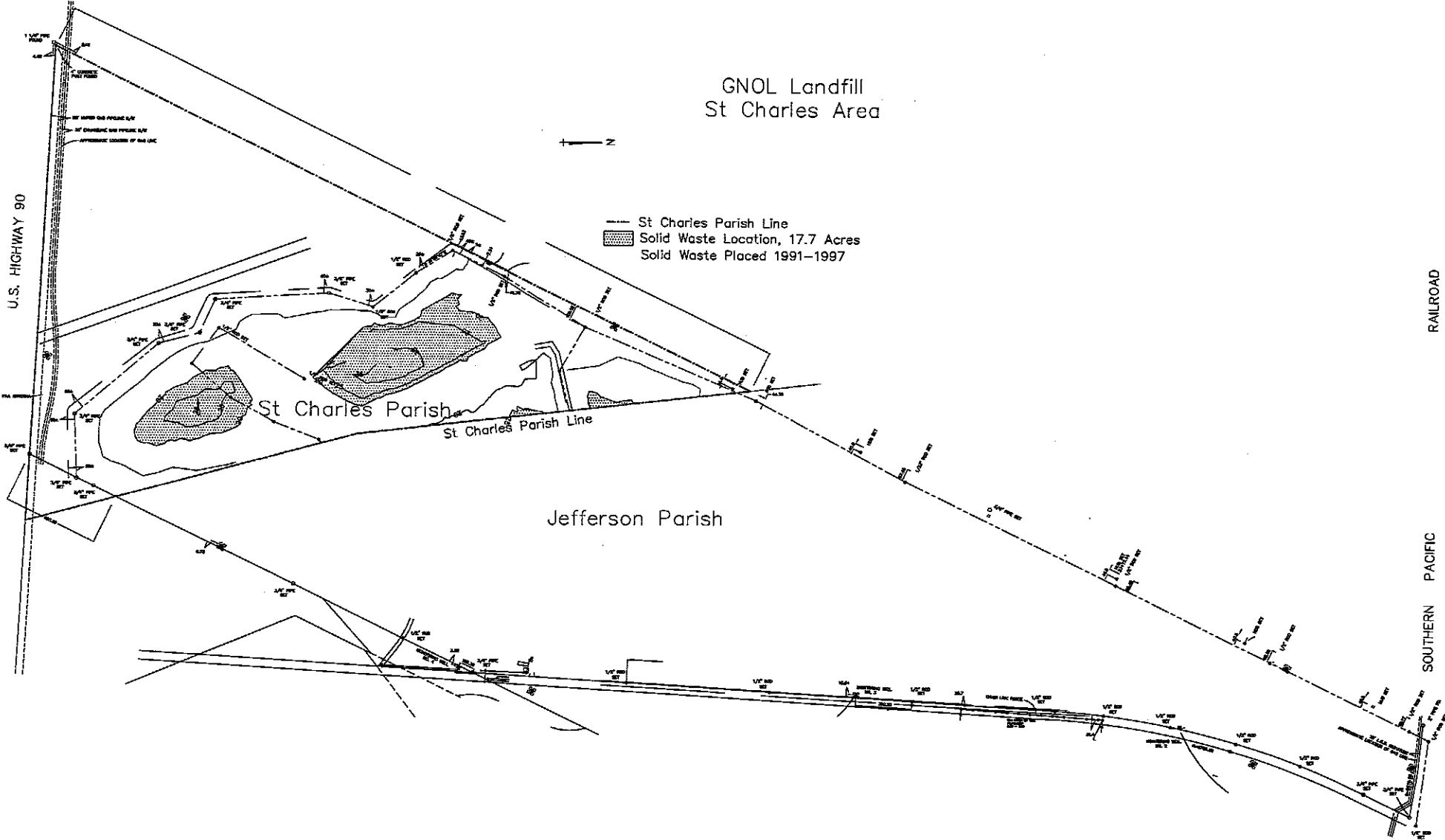

- St Charles Parish Line
- ▨ Solid Waste Location, 17.7 Acres
- ▨ Solid Waste Placed 1991-1997

U.S. HIGHWAY 90

RAILROAD

SOUTHERN PACIFIC

St Charles Parish

Jefferson Parish

St Charles Parish Line