

Attention Glenn Niccard

MR. Richard,

I would like to use driveway 1 and 2 coming off of Hwy 431 for my personal vehicles. Driveway 3 coming off of Levee Rd. will be used for parking for a small snowball stand.

Frank LNU

Aluthimo Jim Villaseñor
17913 Old Spanish Tr
Des Allmonds, LA 70030
OR5- 758-5571

Levee Rd.

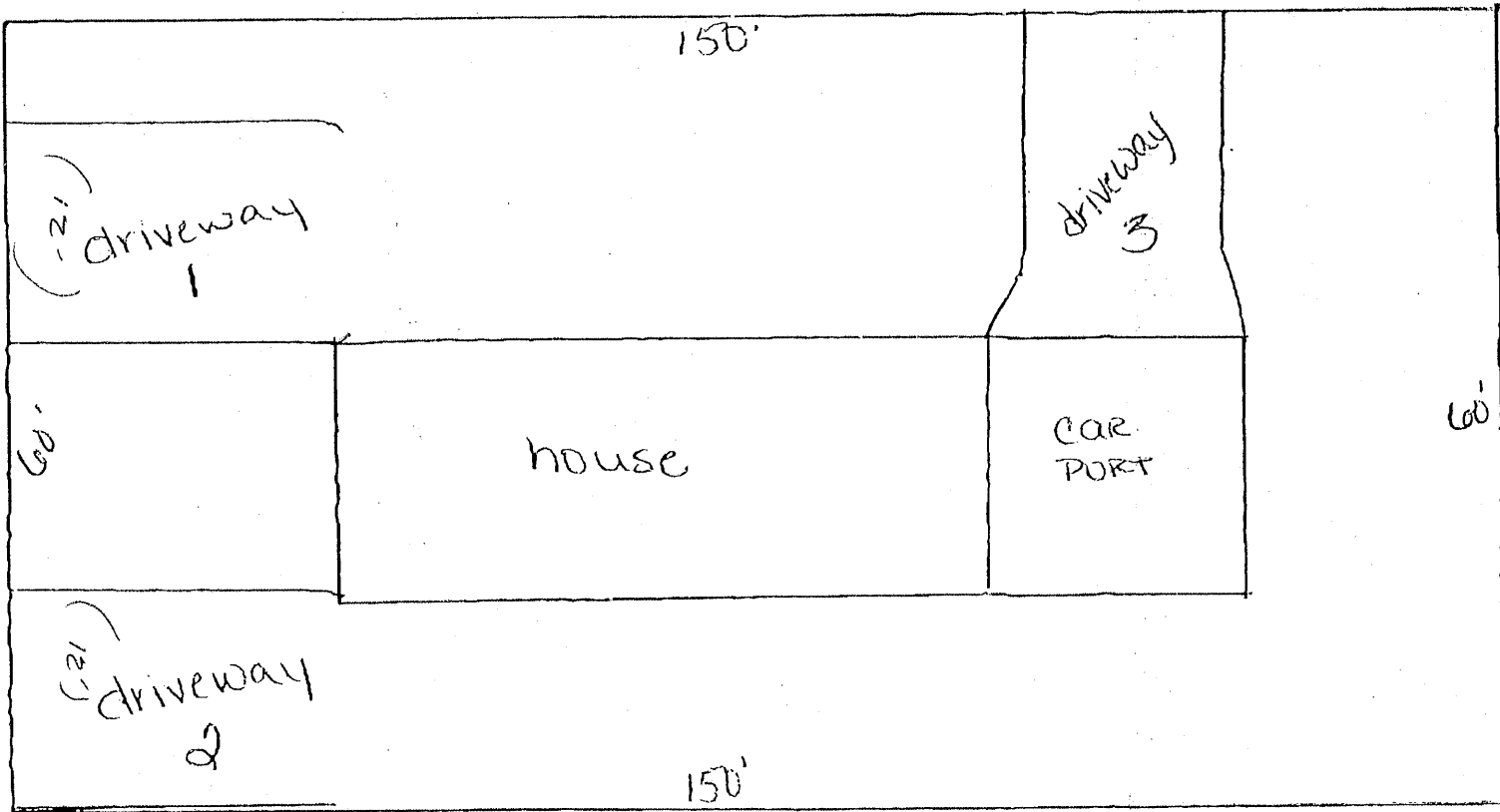

Don Williams
" Hwy 631 "

Alutimo Villasenor

Attention Glenn Richard