

SECTION 00806

CHANGE ORDER

No. One (1) - FINAL

DATE OF ISSUANCE July 15, 2021 EFFECTIVE DATE July 15, 2021

OWNER St. Charles Parish Department of Public Works
CONTRACTOR Fleming Construction Company, L.L.C.
Contract: P190502 Schexnaydre Pump Station Improvements
Project: Schexnaydre Pump Station Improvements
OWNER's Contract No. P190502 ENGINEER's Contract No. 2019-21-740
ENGINEER Evans-Graves Engineers, Inc.

You are directed to make the following changes in the Contract Documents:

Description: *See attached example on how to fill in this information*

1. Delete the Following Work Items: (none)

- a. Contract Item #: *10 - Relocation of Infrastructure*
Delete item in its entirety. (-\$ 30,000.00)

Total of Deducted Items = (-\$30,000.00)

2. Add the Following Work Items:

- a. New Contract Item #: *XI-01 - Custom-length drive shaft with torsional coupling*
Addition of \$3,070.00 (L.S.). See attached executed WCD-01 for details.
- b. New Contract Item #: *XI-02 - Discharge Bell*
Addition of \$ 16,325.88 (L.S.). See attached executed WCD-02 for details.
- c. New Contract Item #: *XI-03 - PTO and drive shaft modifications*
Addition of \$ 8,654.00 (L.S.). See attached executed WCD-04 for details.
- d. New Contract Item #: *XI-04 - Extended Bypass Pumping*
Addition of \$45,479.85 (L.S.). See attached FCP-05 for details.

Total of Added Work Items = (+\$73,529.73)

3. Revise the Following Work Item Quantities: (none)

Total of Change in Work Items Quantity = (+/- \$0.00)

Reason for Change Order: List a reason for each Line Item listed above. *See attached example on how to fill in this information*

1. Deleted Work Items

- a. No hidden infrastructure was found during the work which required relocation.

2. Add Work Items

- a. Fabricate and install custom length drive shaft with torsional coupling to keep larger motor out of usable walkway space on pump deck.
- b. Fabricate and install discharge bell for end of new discharge pipe to calm flow velocities and minimize erosive forces from the new pump into the Canal.
- c. Furnish and install new Power Take-off (PTO) as required by St. Charles Parish for operation, and associated modifications to driveshaft; all as coordinated with and discussed in correspondence with St. Charles Parish and at the Bi-Weekly Construction Progress Meeting of 3-16-2021.
- d. Maintain and operate the existing (2) rented bypass pumps onsite beyond the contract end time in order for the Parish to perform replacement of a deteriorated beam in the discharge basin.

3. Revise Work Item Quantities (N/A)

Attachments: executed WCD-01, executed WCD-02, executed WCD-04, Fleming proposal FCP-05

CHANGE IN CONTRACT PRICE:	
Original Contract Price	
\$	<u>654,016.00</u>
Net Increase (Decrease) from previous Change Orders No. <u>N/A</u> to <u>N/A</u> :	
\$	<u>0.00</u>
Contract Price prior to this Change Order:	
\$	<u>654,016.00</u>
Net <u>increase</u> (decrease) of this Change Order:	
\$	<u>43,529.73</u>
Contract Price with all approved Change Orders:	
\$	<u>697,545.73</u>

CHANGE IN CONTRACT TIMES:	
Original Contract Times:	
Substantial Completion:	<u>180</u>
Ready for final payment:	<u>210</u>
(days or dates)	
Net change from previous Change Orders No. <u>N/A</u> to No. <u>N/A</u> :	
Substantial Completion:	<u>0</u>
Ready for final payment:	<u>0</u>
(days)	
Contract Times prior to this Change Order:	
Substantial Completion:	<u>180</u>
Ready for final payment:	<u>210</u>
(days or dates)	
Net <u>increase</u> (decrease) this Change Order:	
Substantial Completion:	<u>88</u>
Ready for final payment:	<u>88</u>
(days)	
Contract Times with all approved Change Orders:	
Substantial Completion:	<u>268</u>
Ready for final payment:	<u>298</u>
(days or dates)	

RECOMMENDED:

By: [Signature]
ENGINEER (Authorized Signature)

Date: 7/21/2021

APPROVED:

By: _____
OWNER (Authorized Signature)

Date: _____

ACCEPTED:

By: [Signature]
CONTRACTOR (Authorized Signature)

Date: 7/26/2021

SECTION 00805

WORK CHANGE DIRECTIVE

No. One (1)

DATE OF ISSUANCE 1/26/2021 EFFECTIVE DATE _____
 Owner: St. Charles Parish Department of Public Works
 Contractor: Fleming Construction Company, L.L.C.
 Contract: P190502 Schexnaydre Pump Station Improvements
 Project: Schexnaydre Pump Station Improvements
 Owner's Contract No.: P190502 Engineer's Contract No.: 2019-21-740
 ENGINEER: Evans-Graves Engineers, Inc.

Contractor is directed to proceed promptly with the following change(s):
 Description: Fabricate and install custom length drive shaft with torsional coupling to keep larger motor out of usable walkway space on pump deck.

Attachments: (List documents supporting change) Fleming Construction Co., L.L.C. Change Proposal FCP #02.

Purpose for Work Change Directive:

Directive to proceed promptly with the Work described herein, prior to agreeing to changes on Contract Price and Contract Time, is issued due to: *(check one)*

- Non-agreement on pricing of proposed change.
- Necessity to proceed for schedule or other project reasons.

Estimated Change in Contract Price and Contract Times (non-binding, preliminary):

Contract Price: \$ 3,070.00 [increase] [decrease]
 Contract Time 28 days [increase] [decrease]

Basis of estimated change in Contract Price:

- Lump Sum
- Cost of the Work
- Unit Price
- Other

<p><i>(Recommended)</i></p> <p>By: <u>[Signature]</u> <small>Engineer (Authorized Signature)</small></p>	<p>Limited Authorization By*:</p> <p>By: <u>[Signature]</u> <small>Owner's Representative</small></p>	<p>Received:</p> <p>By: <u>[Signature]</u> <small>Contractor (Authorized Signature)</small></p>
Title: <u>DEPUTY CHIEF ENGINEER</u>	Title: <u>Public Works Director</u>	Title: <u>V.P.</u>
Date: <u>1/29/2021</u>	Date: <u>01/27/2021</u>	Date: <u>02/01/2021</u>

*Owner's Representative is not authorized to finalize a Change Order nor does the Work Change Directive substitute the Change Order process as more fully set out in the General Conditions of the Construction Contract.

Approved by Funding Agency (if applicable)

By: _____ Date: _____
 Title: _____



8074 Park Avenue Houma, LA 70363
P 985-851-7077
F 985-878-9854
office@associatedpump.com

January 14, 2021

Fleming Construction Co., LLC
23 E. Airline Drive
Kenner, LA 70062

Attention: Steve Freeman

RE: Schexnaydre Pump Station Drive Shaft Length Changes

We are pleased to offer the following quote for changes made to Drive Shaft at above captioned:

Charges to change the length of the drive shaft from a 48" long Vibra Damp drive shaft to a 2'-5 ⁷/₁₆ drive shaft with a M22A Torsional Coupling.

Total: \$2,403.00

Please respond with a purchase order number.

Terms: 30-day account.

Only items listed above are included in this quotation.

Sincerely,
Paul Klingman
Associated Pump & Supply Co., LLC
985-851-7077

SECTION 00805

WORK CHANGE DIRECTIVE

No. Two (2)

DATE OF ISSUANCE 3/1/2021 EFFECTIVE DATE _____
 Owner: St. Charles Parish Department of Public Works
 Contractor: Fleming Construction Company, L.L.C.
 Contract: P190502 Schexnavdre Pump Station Improvements
 Project: Schexnavdre Pump Station Improvements
 Owner's Contract No.: P190502 Engineer's Contract No.: 2019-21-740
 ENGINEER: Evans-Graves Engineers, Inc.

Contractor is directed to proceed promptly with the following change(s):
 Description: Fabricate and install discharge bell for end of new discharge pipe to calm flow velocities and minimize erosive forces from the new pump into the Canal.

Attachments: (List documents supporting change) Fleming Construction Co., L.L.C. Change Proposal FCP #01 (REV 2-9-2021), marked up with E-G corrections, 3-1-2021.

Purpose for Work Change Directive:

Directive to proceed promptly with the Work described herein, prior to agreeing to changes on Contract Price and Contract Time, is issued due to: *(check one)*

- Non-agreement on pricing of proposed change.
- Necessity to proceed for schedule or other project reasons.

Estimated Change in Contract Price and Contract Times (non-binding, preliminary):

Contract Price: \$ 16,325.88 [increase] [decrease]
 Contract Time 1 days [increase] [decrease]

Basis of estimated change in Contract Price:

- Lump Sum
- Cost of the Work
- Unit Price
- Other

By: [Signature] Recommended: _____ Limited Authorization By: [Signature] Received: [Signature]
 (Engineer Authorized Signature) By: [Signature] Owner's Representative* By: [Signature] Contractor (Authorized Signature)
 Title: DEPUTY CHIEF ENGINEER Title: Director of Public Works Title: PM
 Date: 3/1/2021 Date: 3/1/2021 Date: 3/1/21

*Owner's Representative is not authorized to finalize a Change Order nor does the Work Change Directive substitute the Change Order process as more fully set out in the General Conditions of the Construction Contract.

Approved by Funding Agency (if applicable)
 By: _____ Date: _____
 Title: _____



FLEMING CONSTRUCTION CO., L.L.C.

PAVING & PIPE CONTRACTORS SINCE 1953 LOUISIANA LICENSE NO. 935

March 1, 2021

Stephen Lundgren
Evans-Greyes Engineers
909 Poydras St., Suite 3050
New Orleans, La. 70112

FCP # 01

Field Change Proposal no. 1: Engineer added bell to end of 48" Discharge. Fabricator had to add.
By adding bell, an additional 48" Bolt up is required due to limited space at Pipe Band No. 4
It was estimated a full day to bolt up 3 sections. Now there is a fourth causing extra day.

Re: Schexnaydra Canal Drainage Pump Station Improvements

Subject: Fabricate bell for new 48" discharge and install one extra bolt up.

Dear Mr. Lundgren,

Below is our cost breakdown for the referenced scope of work:

Labor:	Rate					Tax & Ins.	Rate W/ T & I Per Hour	Total Labor Per Hour
1 -Foreman	40.00		+			20.00	=	60.00
3 -Laborers	18.00		+			9.00	=	27.00
1 -Operator	25.00		+			12.50	=	37.50
								<u>178.50</u>
	178.50	x		10 Hrs	Per Day	1 Days	=	1,785.00
								<u>Subtotal Labor</u>
								1,785.00
Equipment:								
1 Hyundai 210 LC 9	108.00	x		10 Hrs.		=		1,080.00
1 Cat 910 Loader	36.38	x		10 Hrs.		=		363.80
1 Foreman Truck	19.13	x		10 Hrs.		=		191.30
1 Service Truck	21.88	x		10 Hrs.		=		218.80
1 Crane	3,565.00	x		1 dy		=		3,565.00
								<u>Subtotal Equipment</u>
								5,418.90
								<u>Total Labor & Equipment:</u>
								7,203.90
Material:								
1 Fabricated bell (coastal metal)	10160.00	x		1 ea		=		10,160.00
								<u>Subtotal Materials</u>
								10,160.00
								<u>Tax 9.20%</u>
								934.72
								<u>Total Materials</u>
								11,094.72
Credit (4'-0" of 48" pipe)		unit x 4						
4 LF	\$1,078	\$4,312.00						
		<u>\$4,312.00</u>						

**** 1 day for install

Total Labor & Equipment	7,203.90
Total Materials	11,094.72
<u>Subtotal</u>	<u>\$18,298.62</u>
Credit	4,312.00
<u>Subtotal</u>	<u>\$13,986.62</u>
15% OHP of 14,700.10	\$2,097.99
2.5% Bond of 16,084.61	\$241.27
<u>Total for Construction</u>	<u>\$16,325.88</u>
Total days extension	1 day

SECTION 00805

WORK CHANGE DIRECTIVE

No. Four (4)

DATE OF ISSUANCE 4/1/2021 EFFECTIVE DATE _____
 Owner: St. Charles Parish Department of Public Works
 Contractor: Fleming Construction Company, L.L.C.
 Contract: P190502 Schexnaydre Pump Station Improvements
 Project: Schexnaydre Pump Station Improvements
 Owner's Contract No.: P190502 Engineer's Contract No.: 2019-21-740
 ENGINEER: Evans-Graves Engineers, Inc.

Contractor is directed to proceed promptly with the following change(s):
 Description: Furnish and install new Power Take-off (PTO) as required by St. Charles Parish for operation, and associated modifications to driveshaft; all as coordinated with and discussed in correspondence with St. Charles Parish and at the Bi-Weekly Construction Progress Meeting of 3-16-2021.

Attachments: (List documents supporting change) Fleming Construction Co., L.L.C. Change Proposal FCP #03 (4-1-2021), and supporting documentation from Associated Pumps dated 3-30-2021.

Purpose for Work Change Directive:

Directive to proceed promptly with the Work described herein, prior to agreeing to changes on Contract Price and Contract Time, is issued due to: (check one)

- Non-agreement on pricing of proposed change.
- Necessity to proceed for schedule or other project reasons.

Estimated Change in Contract Price and Contract Times (non-binding, preliminary):

Contract Price: \$ 8,654.00 [increase] [decrease]
 Contract Time 8 days [increase] [decrease]

Basis of estimated change in Contract Price:

- Lump Sum
- Cost of the Work
- Unit Price
- Other

Recommended: _____ Limited Authorization By*: _____ Received: _____
 By: [Signature] By: [Signature] By: [Signature]
 (Inspector/Authorized Signature) Owner's Representative Contractor (Authorized Signature)
 Title: DEPUTY CHIEF ENGINEER Title: Public Works Director Title: P/M
 Date: 4/1/2021 Date: 4/5/2021 Date: 4/5/2021

*Owner's Representative is not authorized to finalize a Change Order nor does the Work Change Directive substitute the Change Order process as more fully set out in the General Conditions of the Construction Contract.

Approved by Funding Agency (if applicable)
 By: _____ Date: _____
 Title: _____

April 1, 2021

Stephen Lundgren
Evans-Graves Engineers
Metairie Centre, 3424 Edenborn Ave., Suite 450
Metairie, LA 70001

FCP #03

Field Change Proposal no. #1 F & I PTO, Modify driveshaft & machine shop costs along with install

Re: Schoupsydra Canal Drafosga Pump Station Improvements

Subject: Furnish, modify driveshaft, PTO and install

Dear Mr. Lundgren,

Below is our cost breakdown for the referenced scope of work:

Labour:	Rate						Rate W/ T & I Per Hour	Total Labor Per Hour
1 Foreman	40.00		+				20.00	60.00
1 Operator	25.00		+				12.50	37.50
							<u>Total Labor Per Hour</u>	<u>97.50</u>
	97.50	x	7	Hrs	Per Day	1	Days	682.50
							<u>Subtotal Labor</u>	<u>682.50</u>
Equipment:								
1 Foreman Truck		18.13	x	7	Hrs.			126.91
							<u>Subtotal Equipment</u>	<u>126.91</u>
							<u>Total Labor & Equipment</u>	<u>809.41</u>

Suppliers

1. drive shaft for new PTO	"	1 ea	"	\$2,403.00
2. PTO	"	1 ea	"	\$2,398.00
3. Machine shop charges	"	1 ea	"	\$850.00
4. Installation of PTO on tractor	"	1 ea	"	\$895.00

Total Rentals **\$8,598.00**

Total Labor & Equipment	\$816.41
Total Supplier	8,598.00
Subtotal	9,414.41
15% OHP of 9,414.41	\$8,112.88
1.5% of \$826.87	\$127.90
Total for Dept support	\$8,656.00
Total days construction	8 days

Sincerely,

 Steve Freeman
 Fleming Construction Co., LLC



ASSOCIATED
PUMP & SUPPLY LLC
SALES RENTAL 24 HOUR SERVICE

9074 Park Avenue - Houma, LA 70363
P: 985-881-7077
P: 985-879-8864
office@associatedpump.com

March 30, 2021

Fleming Construction
Attn: Mr. Steve Freeman
PH: 1-226-270-7667
E-Mail: sfreeman@flemco.net

RE: Schexnaydre Pump Station

We are pleased to offer for your consideration the following equipment:

Qty: (1) Drive Shaft - 2' 5 7/16" **Cost: \$2,403.00/Each**
Qty: (1) PTO **Cost: \$2,350.00/Each**
Machine Shop Charges to Shorten, Align, and Weld Drive Shaft... **Cost: \$850.00**
Installation of Torsional Coupler, PTO, and Drive Shaft..... **Cost: \$995.00**

Total Cost: \$6,598.00 (Plus Applicable Taxes)

Terms are Net 30 Days. Only items listed above are included in this quotation.

Once again, we appreciate the opportunity to quote you on the above equipment and we look forward to your favorable consideration. Please feel free to call, should you have any questions.

Thanks,

Oscar Perez

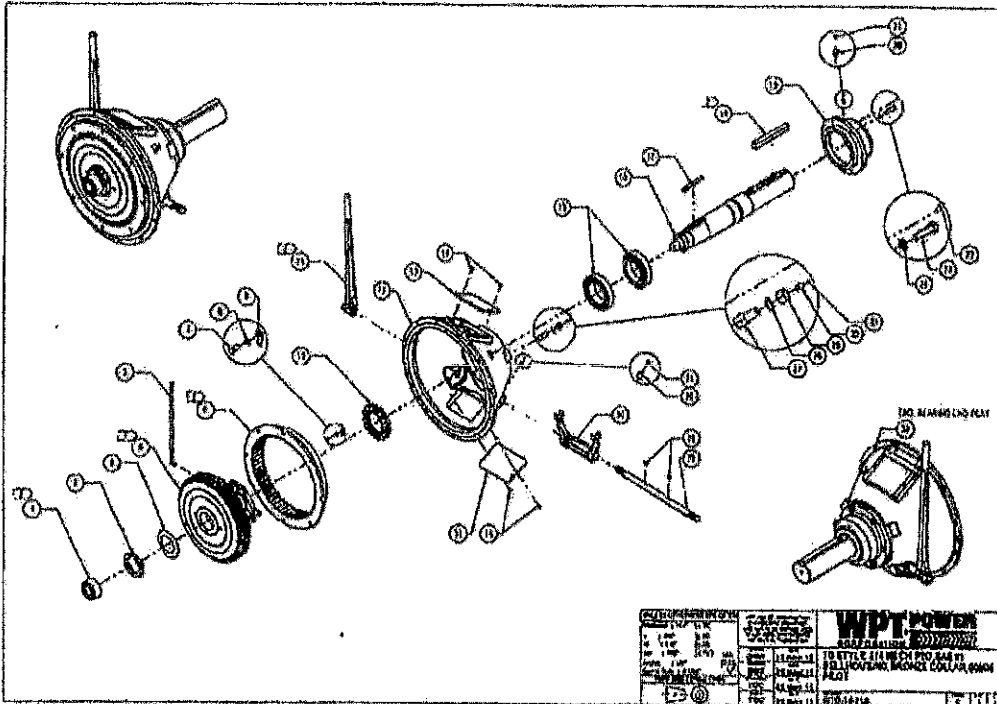

(SL) STANDARD LENGTH DRIVESHAFTS

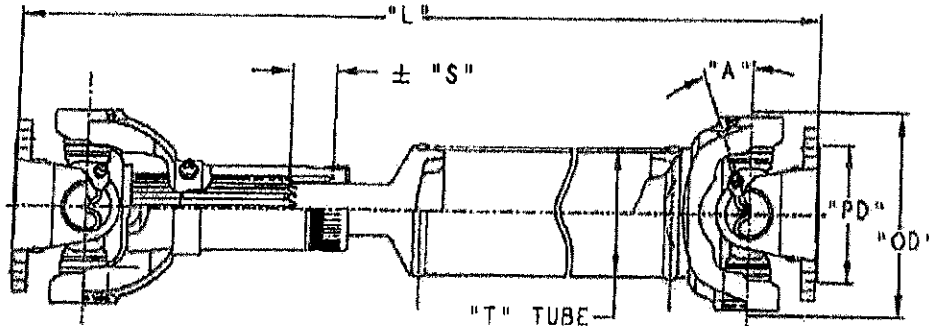

SERIES	PART #	"L" LENGTH	"T" TUBE	"S" SLIP ±A	"A" MAX ANGLE	"A" WORKING ANGLE	"PD" PILOT DIA.	"OD" MAX. DIA.	SHAFT WEIGHT @ 36 inches
31/1310	SL31 x	24,36,48	3.00 x .083	1.06	20°	1° to 8°	2.38	3.88	18 lbs.
37/1350	SL37 x	24,36,48	3.00 x .083	1.81	20°	1° to 8°	2.75	4.56	30
41/1410	SL41 x	24,36,48	3.50 x .083	1.44	20°	1° to 8°	2.75	4.88	31
48/1480	SL48 x	24,36,48	3.50 x .083	1.25	22°	1° to 8°	3.75	5.88	33
55/1550	SL55 x	24,36,48	3.50 x .095	1.13	22°	1° to 8°	3.75	5.88	43
61/1610	SL61 x	24,36,48	3.50 x .134	1.44	26°	1° to 8°	6.63	7.00	52
71/1710	SL71 x	24,36,48	4.00 x .134	2.63	22°	1° to 8°	7.75	8.00	73
81/1810	SL81 x	36,48	4.50 x .134	2.50	30°	1° to 8°	7.75	9.13	77
88/1880	SL88 x	36,48	4.50 x .250	2.56	22°	1° to 8°	7.00	9.88	163
91/1910	SL91 x	36,48	4.75 x .250	2.75	24°	1° to 8°	7.00	9.63	170

- All dimensions in inches (unless noted).
- Standard length shafts are dynamically balanced.
- Non-standard lengths available, please call APT.
- Refer to guard information for proper safety shielding.

Warning: Rotating driveshafts can be dangerous. Use shaft guards to help prevent serious injury to personnel

All Power-Transmission Inc. • 3146 Market Street, Green Bay, WI 54304 • Phone (920) 336-6111 • FAX (920) 336-2690
 Visit our web site at www.allpowertrans.com E-mail apt@allpowertrans.com

(SC) SHORT COUPLED SHAFTS

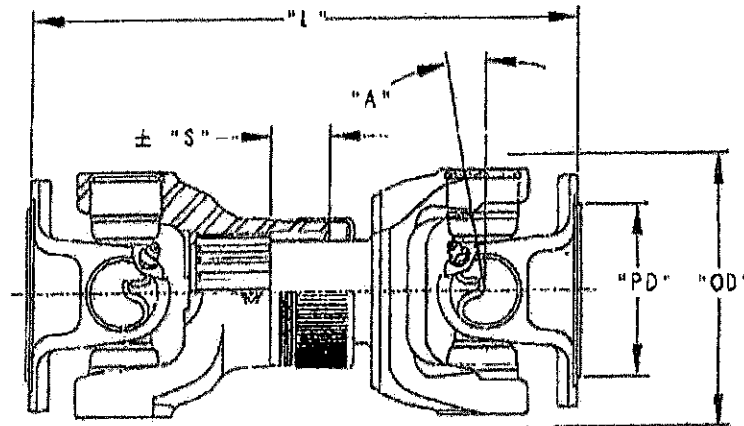

SERIES	PART #	"L" LENGTH	"S" SLIP +/-	"A" MAX. ANGLE	"A1" WORKING ANGLE	"PD" PILOT DIA.	"OD" MAX. DIA.	SHAFT WEIGHT
31	SC31-1	9.50	.63	15°	1° to 8°	2.38	3.88	8 lbs.
37	SC37-1	9.88	.38	8°	1° to 8°	2.75	4.58	11
41	SC41-1	9.88	.38	8°	1° to 8°	2.75	4.69	14
48	SC48-1	9.00	.50	8°	1° to 8°	3.75	5.88	20
55	SC55-1	10.25	.50	5°	1° to 5°	3.75	5.88	30
61	SC61-1	9.50	.38	8°	1° to 8°	6.63	7.00	45
71	SC71-1	11.00	.38	8°	1° to 8°	7.75	8.00	54
81	SC81-1	13.86	.56	12°	1° to 8°	7.75	9.13	78
88	SC88-1	14.13	.50	8°	1° to 8°	7.00	9.88	142
91	SC91-1	22.25	.79	24°	1° to 8°	7.00	9.63	129

- All dimensions in inches unless noted.
- Standard length shafts are dynamically balanced.
- Non-standard SC lengths available, please call APT.
- Refer to guard information for proper safety shielding.

SL & SC DRIVESHAFT BOLT KITS

SHAFT SERIES	31	37 - 41	48 - 55	61	71	81	88-91
Hardware Kit	300-1001	300-1003	300-1006	300-1007	300-1007	300-1009	300-1011

Warning: Rotating driveshafts can be dangerous. Use shaft guards to help prevent serious injury to personnel.

All Power-Transmission Inc. • 3145 Market Street, Green Bay, WI 54304 • Phone (920) 336-6111 • FAX (920) 336-2690
 Visit our web site at www.allpowertrans.com E-mail apt@allpowertrans.com

COMPANION FLANGE SPECIFICATIONS

MODEL SF

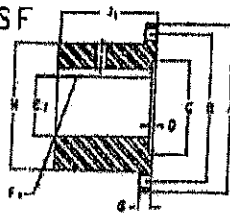

MODEL SLF

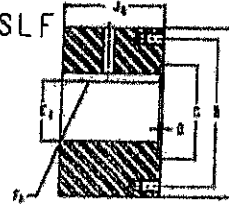

STYLE #1

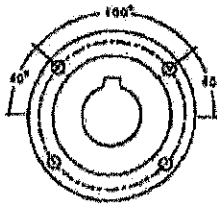

STYLE #2

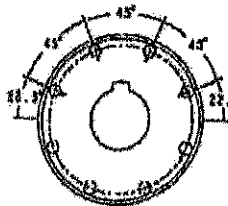

STYLE #3

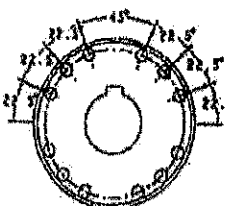

STYLE #4

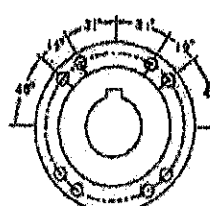

SERIES	31	37 - 41	48 - 55	61	71	81	88 - 91
A-OUTSIDE DIAMETER	3.88	4.56	5.88	6.88	8.00	8.00	8.83
B-BOLT CIRCLE	3.125	3.750	4.750	6.125	7.250	7.250	8.250
C-PILOT DIA.(FEMALE)	2.375	2.750	3.750	6.625	7.750	7.750	7.000
D-PILOT DEPTH	.078	.078	.088	.056	.055	.055	.135
MODEL SF (STANDARD FLANGE)							
E ₁ -MAXIMUM BORE	1.69	1.88	2.44	3.12	4.00	4.00	4.83
F ₁ -MAXIMUM KEYWAY	3/8 x 3/16	1/2 x 1/4	5/8 x 5/16	3/4 x 3/8	1 x 1/2	1 x 1/2	1-1/8 x 9/16
G-FLANGE WIDTH	0.38	0.38	0.38	0.38	0.38	0.38	0.83
H-HUB DIAMETER	2.44	2.88	3.75	5.25	6.38	6.38	6.88
J ₁ -LENGTH	2.00	2.00	2.50	3.50	4.00	4.00	5.00
ROUGH BORE DIA.	0.75	1.00	1.25	1.25	1.25	1.25	1.50
APPROXIMATE WEIGHT	3.14 #	4.25 #	8.61 #	21.78 #	36.56 #	36.56 #	58.12 #
MODEL SLF (SPECIAL LARGE FLANGE)							
E ₂ -MAXIMUM BORE	2.37	2.75	3.75	4.50	5.50	5.50	6.38
F ₂ -MAXIMUM KEYWAY	5/8 x 5/16	3/4 x 3/8	1 x 1/2	1-1/8 x 8/16	1-1/4 x 5/8	1-1/4 x 5/8	1-1/4 x 5/8
J ₂ -LENGTH	2.50	3.00	3.50	5.00	6.00	6.00	6.00
ROUGH BORE DIA.	1.38	1.75	2.38	3.12	3.50	3.50	4.25
APPROXIMATE WEIGHT	7.27 #	11.79 #	22.38 #	41.52 #	68.77 #	68.77 #	99.10 #
BOLT HOLE SPACING							
STYLE #	# 1	# 1	# 1	# 2	# 2	# 3	# 4
NUMBER OF BOLTS	4	4	4	8	8	12	8
THREAD SIZE	3/8-24	7/16-20	1/2-20	3/8-24	3/8-24	7/16-20	5/8-18

Warning: Rotating driveshafts can be dangerous. Use shaft guards to help prevent serious injury to personnel.

All Power-Transmission Inc. • 3146 Market Street, Green Bay, WI 54304 • Phone (920) 336-6111 • FAX (920) 336-2690
 Visit our web site at www.allpowertrans.com E-mail apci@allpowertrans.com

STOCK BORE COMPANION FLANGES

Bore	Keyway	31	37-41	48-55	61	71	81
SF. Rough Bore		63-1001	66-1001	103-1001	163-1001	183-1001	203-1001
1	1/4	63-1002	66-1002				
1 1/8	1/4	63-1003	66-1003				
1 1/4	1/4	63-1004	66-1004				
1 1/4	5/16	63-1005	66-1005				
1 3/8	5/16	63-1006	66-1006				
1 3/8	3/8	63-1007	66-1007				
1 7/16	3/8	63-1008	66-1008				
1 1/2	3/8	63-1009	66-1009	103-1009			
1 5/8	3/8	63-1010	66-1010	103-1010			
1 11/16	3/8	63-1035	66-1035	103-1032			
1 3/4	3/8	64-1011	66-1011	103-1011			
1 3/4	1/2	64-1012	66-1012	103-1012			
1 7/8	3/8	64-1013	66-1013	103-1013			
1 7/8	1/2	64-1014	66-1014	103-1014			
2	1/2	64-1015	67-1015	103-1015	163-1015	183-1015	
2 1/8	5/8	64-1016	67-1016	103-1016	163-1016	183-1016	
2 1/4	1/2	64-1017	67-1017	103-1017	163-1017	183-1017	
2 1/4	5/8	64-1018	67-1018	103-1018	163-1018	183-1018	
2 3/8	5/8	64-1019	67-1019	103-1019	163-1019	183-1019	
2 7/16	6/8		67-1020	103-1020	163-1020	183-1020	
2 1/2	5/8		67-1021	104-1021	163-1021	183-1021	203-1021
2 3/4	5/8		67-1022	104-1022	163-1022	183-1022	203-1022
2 15/16	3/4			104-1023	163-1023	183-1023	203-1023
3	3/4			104-1024	163-1024	183-1024	203-1024
3 1/2	7/8			104-1025	164-1025	183-1025	203-1025
3 15/16	1				164-1026	183-1026	203-1026
4	1				164-1027	183-1027	203-1027
SLF. Rough Bore		64-1001	67-1001	104-1001	164-1001	184-1001	204-1001
Hardware Kit		300-1001	300-1003	300-1005	300-1007	300-1007	300-1009

-SLF flanges denoted in blue

Notes:

1. Finished Bore sizes nominal to + 0.002".
2. Keyway per ANSI Class I tolerance.
3. All companion flanges provided with (1) setscrew over the keyway.
4. Popular sizes listed, please call for availability on other sizes.
5. Special bore or spline flanges quoted upon request.

Warning: Rotating driveshafts can be dangerous. Use shaft guards to help prevent serious injury to personnel.

All Power-Transmission Inc. • 3148 Market Street, Green Bay, WI 54304 • Phone (920) 336-9111 • FAX (920) 336-2880
 Visit our web site at www.allpowertrans.com E-mail apt@allpowertrans.com

SHAFT GUARDS

IRRIGATION DRIVELINE SHAFT GUARDS



- Easily installed on new or existing installations. Slips easily over shaft and bolts to drive and driven machines.
- Rigid construction of heavy gauge, continuous milled, non-flaking steel.
- No lost time lubricating shaft, 2" wide opening runs full length of underside of guard.

SHAFT GUARD MODELS	LENGTHS AVAILABLE	DRIVESHAFT SERIES
SG-18	10" to 18"	31 - 55
SG-24	14" to 24"	61 - 81
SG-42	24" to 42"	31 - 55
SG-66	36" to 66"	31 - 55
SG-70	35" to 66"	61 - 81
SG-91	28" to 54"	68 - 285

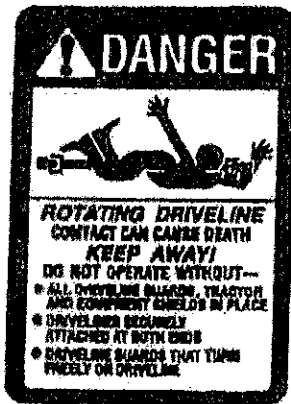

Safety standards require that rotating driveshafts have proper shielding in place. Serious injury or death can result. **DO NOT OPERATE** equipment without safety shields installed on driveshafts. Warning stickers available through APT upon request.

The majority of driveshaft related injuries occur when shielding is missing or has been omitted. It is imperative a guard is properly installed at each shaft location.

Warning: Rotating driveshafts can be dangerous. Use shaft guards to help prevent serious injury to personnel.

All Power-Transmission Inc. • 3146 Market Street, Green Bay, WI 54304 • Phone (820) 336-5111 • FAX (820) 336-2880
 Visit our web site at www.allpowertrans.com E-mail apt@allpowertrans.com

Total Labor & Equipment: 3,700.19

Material:

2 Syphon Assbly	x	\$1,237.00	1 ea	=	\$1,237.00
-----------------	---	------------	------	---	------------

Subtotal Materials	\$1,237.00
Tax 9.20%	\$113.80
Total Materials	\$1,350.80

Rental:

1 24" Bypass pump	x	\$9,644.00	2 mo	=	\$19,288.00
1 12" Bypass pump	x	\$5,466.35	2 mo	=	\$10,932.70

Subtotal rental	\$30,220.70
Tax 9.20%	\$2,780.30
Total Rentals	\$33,001.00

Fuel Consumed

1 24" Bypass pump	Hrs running	12.30	12.39 g/hr	=	\$152.40
1 12" Bypass pump		22.81	11.1 g/hr	=	\$253.19

Total gallons	\$405.59
---------------	----------

Total fuel	405.00	\$2.25 per gallon	\$911.25
------------	--------	-------------------	----------

Total Labor & Equipment	\$3,700.19
Total Materials	1,350.80
Total Rentals	33,001.00
Total Fuel	911.25
Subtotal	\$38,963.24
15% OHP of 38,963.24	\$5,844.49
1.5% Bond of 44,807.73	\$672.12
Total for Bypass pump	\$45,479.85
Total days extension	51 DAYS

Sincerely,

 Steve Freeman
 Fleming Construction Co., LLC

Steve Freeman

From: Donald Edwards <dedwards@stcharlesgov.net>
Sent: Wednesday, April 14, 2021 3:36 PM
To: Steve Freeman; Stephen Lundgren
Cc: Joe Malley; Jason Graves
Subject: RE: Schexnaydre Pump Station

Steve,

We want you to operate and maintain the pumps in accordance with the Contract Documents. We understand that there will be an additional cost for the additional pumping. I understand that it's not convenient for you, but please subcontract the maintenance and operation to someone else, if needed. I understand that Oscar from Associated lives locally, so maybe you can work something out with him.

I hope that you can understand that the Parish doesn't want to assume liability for temporary pumping that has already failed once.

Thanks,

Don Edwards, P.E., Senior Engineer
Public Works Department
100 River Oaks Drive
Destrehan, LA 70047
(985)783-5102



ST. CHARLES PARISH

From: Steve Freeman <sfreeman@flemco.net>
Sent: Wednesday, April 14, 2021 2:41 PM
To: Donald Edwards <dedwards@stcharlesgov.net>; Stephen Lundgren <slundgren@evans-graves.com>
Cc: Joe Malley <jmalley@flemco.net>; Jason Graves <jgraves@flemco.net>
Subject: RE: Schexnaydre Pump Station

Don/Stephen,

Because there is no work being done at site by us for the next several weeks, Fleming does not want to assume liability for the pumps. We will be glad to turn rental of pumps over to the other contractor who will be doing the work or to the parish. All we will have to do is get with Rental companies and let the contractor send whatever paperwork they may need to assume rental. When we had given our rental rates on the bent proposal, that was us being at site but now we are having to send people over to check pumps and it is a lot more costs not to mention our insurance and bonding folks doesn't want to be placed in assumption of liability while other work outside our scope is being performed. Please advise.

Thanks.....

Steve Freeman
Fleming Construction co., LLC

From: Donald Edwards <dedwards@stcharlesgov.net>
Sent: Monday, April 12, 2021 2:26 PM
To: Stephen Lundgren <slundgren@evans-graves.com>
Cc: Miles Bingham <mbingham@stcharlesgov.net>; Joe Malley <jmalley@flemco.net>; Steve Freeman <sfreeman@flemco.net>; Chris Dufour <cdufour@stcharlesgov.net>; Je'Quain Robinson <jrobinson@stcharlesgov.net>
Subject: Schexnaydre Pump Station

Stephen,

We have another contractor that will replace the deteriorated beam. They will be finished in about six to eight weeks.

Thanks,

Don Edwards, P.E., Senior Engineer
Public Works Department
100 River Oaks Drive
Destrehan, LA 70047
(985)783-5102



Wednesday, March 24, 2021

7:00 AM - 10:00 AM (3 HR)

Foreman: Wayne Salathe

Superintendent: Jason Graves

Location: Schexnaydre Pump Station

Status: Transferred

Business Unit: Fleming Construction

Notes: Went pump station and check on bypass pumps. Had to fill 12 in pump with fuel and also found that battery was dead. Hertz was called out and changed out battery. Pump running fine now.

Field Log Totals

Employee

Equipment

W. Salathe
Safe

3.00 HR

0.00 HR

Subcontractors

0.00 EACH

[20-201] St. Charles Parish/Schexnaydre Pump Station

Job Totals

Employee

Equipment

3.00 HR

0.00 HR

Subcontractors

0.00 EACH

Production Accounts

[12008] Relocation of Infrastructure

Estimated Qty.

Reported Qty.

Remaining Qty.

0.00 LS

0.00 LS

17.50 LS

(17.50) LS

Employee Hours

Equipment Hours

3.00 HR

0.00 HR

[20-206] JP /N SIBLEY @ W NAPOLEON DRAINAGE

Job Totals

Employee

Equipment

0.00 HR

0.00 HR

Subcontractors

0.00 EACH

Resources

Employees

Saturday, April 10, 2021

10:30 AM- 12:30 PM (2 HR)

Foreman: Wayne Salathe

Superintendent: Jason Graves

Location: Schexnaydre Pump Station

Status: Transferred

Business Unit: Fleming Construction

Notes: Went and checked on bypass pump after heavy rain Friday night/Saturday morning.

Field Log Totals

Employee	2.00 HR	Subcontractors	0.00 EACH
Equipment	0.00 HR		

[20-201] St. Charles Parish / Schexnaydre Pump Station

Job Totals

Employee	2.00 HR	Subcontractors	0.00 EACH
Equipment	0.00 HR		

Production Accounts

[12008] Relocation of Infrastructure

Estimated Qty. 0.00 LS

Reported Qty. 17.50 LS

Remaining Qty. (17.50) LS

Employee Hours 2.00 HR

Equipment Hours 0.00 HR

Resources

Employees

Eric Teele [TEE01]

Foreman

10:30 AM- 12:30 PM

[12008] Relocation of Infrastructure

Total Hours

2.00 HR
2.00 HR

Subcontractors

Tuesday, April 13, 2021

1:00 PM - 5:30 PM (4.5 HR)

Foreman: Wayne Salathe

Superintendent: Jason Graves

Location: Schexnaydre pump station

Status: Transferred

Business Unit: Fleming Construction

Notes: Went to pump station and test run pumps before rain. And went back during rain and found 24in pump shut down due to code on screen. Trouble shoot and found loose wire connection tighten and pump started up. Ran fine after that

Field Log Totals

Employee	5.50 HR
Equipment	0.00 HR

[20-201] St. Charles Parish/Schexnaydre Pump Station

Job Totals

Employee	5.50 HR
Equipment	0.00 HR

Production Accounts

[12008] Relocation of Infrastructure	0.00 LS
Estimated Qty.	0.00 LS
Reported Qty.	17.50 LS
Remaining Qty.	(17.50) LS
Employee Hours	5.50 HR
Equipment Hours	0.00 HR

Resources

Employees

Wayne Salathe [SAL001]

Foreman

1:00 PM - 5:30 PM

[12008] Relocation of Infrastructure

Total Hours

5.50 HR
5.50 HR

Wednesday, April 14, 2021

Field Log 10244

printed on 5/27/2021, 10:59 AM

10:30 AM- 12:30 PM (2 HR)
Foreman: Wayne Salathe
Superintendent: Jason Graves
Location: Schexnaydre pumping station
Status: Transferred
Business Unit: Fleming Construction

Notes: Wayne checked bypass pumps in morning and evening.

Field Log Totals

Employee	2.00 HR	Subcontractors	0.00 EACH
Equipment	0.00 HR		

[20-201] St. Charles Parish/Schexnaydre Pump Station

Job Totals

Employee	2.00 HR	Subcontractors	0.00 EACH
Equipment	0.00 HR		

Production Accounts

[12008] Relocation of Infrastructure

Estimated Qty.	0.00 LS
Reported Qty.	17.50 LS
Remaining Qty.	(17.50) LS
Employee Hours	2.00 HR
Equipment Hours	0.00 HR

Resources

Employees

Eric Teele [TEE01]	
Foreman	
10:30 AM- 12:30 PM	
Total Hours	0.00 HR

Wayne Salathe [SAL01]

Foreman	
10:30 AM- 12:30 PM	
[12008] Relocation of Infrastructure	2.00 HR
Total Hours	2.00 HR

Subcontractors

Wednesday, April 14, 2021

7:00 PM - 12:00 AM (5 HR)

Foreman: Wayne Salathe

Location: Schexnaydre pump station

Status: Transferred

Business Unit: Fleming Construction

Notes: Had to come back out after heavy rain because 24" pump wasn't running.

Field Log Totals

Employee	5.00 HR
Equipment	0.00 HR

Attachments

File Name: Choice Supply Ticket.jpg

File Name: Truck Ticket.jpg

File Name: Flex Force Timesheet.jpg

[20-201] St. Charles Parish/Schexnaydre Pump Station

Job Totals

Employee	5.00 HR
Equipment	0.00 HR

Production Accounts

[12008] Relocation of Infrastructure	0.00 LS
Estimated Qty.	0.00 LS
Reported Qty.	17.50 LS
Remaining Qty.	(17.50) LS
Employee Hours	5.00 HR
Equipment Hours	0.00 HR

Resources

Employees

Wayne Salathe [SAL01]

Foreman

7:00 PM - 12:00 AM

[12008] Relocation of Infrastructure

Total Hours

5.00 HR
5.00 HR

Thursday, April 15, 2021

Field Log 10240
printed on 5/27/2021 10:38 AM

7:00 AM- 11:00 AM (4 HR)
Foreman: Wayne Salathie
Superintendent: Jason Graves
Location: Schexnaydre pumping station
Status: Transferred
Business Unit: Fleming Construction

Notes: Checked pumps after heavy rain to make sure they were running properly.

Field Log Totals

Employee 7.00 HR
Equipment 0.00 HR

[20-201] St. Charles Parish/Schexnaydre Pump Station

Job Totals

Employee 7.00 HR
Equipment 0.00 HR

Production Accounts

[12008] Relocation of Infrastructure 0.00 LS
Estimated Qty. 0.00 LS
Reported Qty. 17.50 LS
Remaining Qty. (17.50) LS
Employee Hours 7.00 HR
Equipment Hours 0.00 HR

Resources

Employees

Eric Teele [TEE01]
Excavator Operator
7:00 AM- 10:00 AM
[12008] Relocation of Infrastructure
Total Hours 3.00 HR

Wayne Salathie [SALO1]
Foreman
7:00 AM- 11:00 AM
[12008] Relocation of Infrastructure
Total Hours 4.00 HR

Friday, April 16, 2021

7:00 AM- 9:00 AM (2 HR)

Foreman: Wayne Salathe

Superintendent: Jason Graves

Location: Schexnaydre pump station

Status: Transferred

Business Unit: Fleming Construction

Notes: Checked bypass pumps in the morning and the evening.

Field Log Totals

Employee	2.00 HR
Equipment	0.00 HR

[20-201] St. Charles Parish/Schexnaydre Pump Station

Job Totals

Employee	2.00 HR
Equipment	0.00 HR

Production Accounts

[12008] Relocation of Infrastructure	0.00 LS
Estimated Qty.	0.00 LS
Reported Qty.	17.50 LS
Remaining Qty.	(17.50) LS
Employee Hours	2.00 HR
Equipment Hours	0.00 HR

Resources

Employees

Eric Teale [TEE01]	
Foreman	
7:00 AM- 9:00 AM	
[12008] Relocation of Infrastructure	2.00 HR
Total Hours	2.00 HR

Wednesday, May 5, 2021

8:30 AM- 9:30 AM (1 HR)

Foreman: Wayne Salathe

Superintendent: Joseph Bellow

Location: Schexnaydre pump station

Status: Transferred

Business Unit: Fleming Construction

Notes: Checked bypass pumps

Field Log Totals

Employee	1.00 HR
Equipment	0.00 HR

[20-201] St. Charles Parish / Schexnaydre Pump Station

Job Totals

Employee	1.00 HR
Equipment	0.00 HR

Production Accounts

[12008] Relocation of Infrastructure

Estimated Qty.	0.00 LS
Reported Qty.	17.50 LS
Remaining Qty.	(17.50) LS

Employee Hours	1.00 HR
Equipment Hours	0.00 HR

Resources

Employees

Eric Teale [TEEB1]

Foreman

8:30 AM- 9:30 AM

[12008] Relocation of Infrastructure

Total Hours

1.00 HR
1.00 HR

5/27/2021

B2W Field Log 10670- Print Preview

Field Log 10670
printed on 5/27/2021 10:34 AM

Monday, May 10, 2021

6:30 AM- 12:30 PM (6 HR)

Foreman: Wayne Salathe

Superintendent: Jason Graves

Location: Schexnaydre pumping station

Status: Transferred

Business Unit: Fleming Construction

Notes: Checked bypass pump at 6:30 and after the rain stopped. Went and got extended fuel lines, exhaust gasket material and more bolts.

Field Log Totals

Employee	6.00 HR
Equipment	0.00 HR

Attachments

File Name: 5-11-2021 12:07 PM.jpg

File Name: 5-11-2021 12:07 PM.jpg

File Name: 5-11-2021 12:07 PM.jpg

[20-201] St. Charles Parish/Schexnaydre Pump Station

Job Totals

Employee	6.00 HR
Equipment	0.00 HR

Production Accounts

[12008] Relocation of Infrastructure	0.00 LS
Estimated Qty.	0.00 LS
Reported Qty.	17.50 LS
Remaining Qty.	(17.50) LS
Employee Hours	6.00 HR
Equipment Hours	0.00 HR

Resources

Employees

Eric Teale [12008]

Foreman

6:30 AM- 12:30 PM

[12008] Relocation of Infrastructure

Total Hours

6.00 HR
6.00 HR

oe
oe

Date 3-26-21

M Kirby Black

Address Fuel Truck

Reg. No.	Clerk	Account Forward		
1				
2	7:00 a.m.			
3				
4	to			
5				
6	4:30 p.m.			
7				
8				
9	• Checked/Filled			
10	3 Pumps			
11				
12				
13	6593-31			
14				
15				

25
MRS

Al
R

Date 3-27-21

M Kirby Black

Address Fuel Truck

Reg. No.	Clerk	Account Forward		
1	1:00 p.m.			
2				
3	to			
4				
5	3:30 p.m.			
6				
7				
8				
9	Checked on pump			
10	@ pump stations			
11				
12				
13				
14	4235-28			
15				

2.5 HRS

A-1200/3510/3630
T-45202/46202/46203

Your Account Stated to Date - If Error is Found, Return at Once

OK
M

Date 3-28-21

M Kirby Black

Address Fuel Truck

Reg. No.	Clerk	Account Forward		
1	2:00			
2	2:00 p.m.			
3				
4	to			
5				
6	6:00 p.m.			
7				
8	• Checked on pumps			
9	at pump stations			
10	• Washed Fuel Truck			
11				
12				
13				
14	4235-29			
15				

2 HRS

Date 4-03-21

M. Kirby Black

Address Fuel Track

Reg. No.	Clerk	Account Forward
1		
2	7:30 a.m.	[Signature]
3		
4	to	
5		
6	11:00 a.m.	
7		
8		
9		
10		
11		
12		
13	6593-35	
14		
15		

3⁵ HRS

A-1200/35103530
T-45202/16202/16203

Your Account Stated to Date - If Error is Found, Return at Once

Date 4-04-21

Mr Kirby Black

Address Fuel Truck

Reg. No.	Clerk	Account Forward		
1				
2	9:00			
3	am			
4	to			
5				
6	1:00			
7	pm			
8				
9				
10				
11				
12				
13	6593-36			
14				
15				

4 HRS

A-12003610/3500
T-46202/46202/46203

Your Account Stated to Date - If Error Is Found, Return at Once

Date 4-11-21 *okey*
 M. Kirby Black
 Address Fuel Truck

Reg. No.	Clerk	Account Forward
1		
2	7:30 a.m.	
3		
4	to	
5		
6	1:30 p.m.	
7		
8		
9		
10		
11		
12		
13	6593-41	
14		
15		

3 HRS

OK

Date 4-17-21

M Kirby Black

Address Fuel Truck

3 hrs.

Reg. No.	Clerk	Account Forward	Set
1	7:00		
2	7:00 a.m.		
3	↓		
4	to		
5	10:00		
6	10:00 a.m.		
7			
8			
9			
10			
11			
12			
13	6593-47		
14			
15			

3 HRS

om

Date 4-18-21 *pm*

Name Kirby Black

Address Fuel Truck

Reg. No.	Clerk	Account Forward		
1	7:00 a.m.			
2				
3	to			
4				
5	11:00 a.m.			
6				
7				
8				
9				
10				
11				
12				
13	6593-48			
14				
15				

4 HRS

A-1200/25103630
T-45202/16202/46200

Your Account Stated to Date - If Error is Found, Return at Once

A-1200261 07/89
T-45202/40202/40200

Your Account Expires to Date - If Error is Found, Return at Once

Reg. No.	Clerk	Account Forward
1		
2		
3		
4		
5		
6		
7		
8		
9		
10		
11		
12		
13		
14		
15		

4235-36

Checked 2 pumps
Fuel up w/ 20 gallons
Fuel pump - 20.15
Washed floor
Detail of fuel tank

5:00 p.m.

8:00 a.m.

3 hrs

M Kirby, Wash
Address Fuel Truck
4-24-21
OK
per

ok
pm

Date 4-25-21

M Kirby Black

Address Fuel Truck

Reg. No.	Clerk	Account Forward		
1	8:30			
2	8:30 am			
3				
4	10			
5	11:00			
6	11:00 am			
7				
8				
9				
10				
11				
12				
13				
14	4235-38			
15				

2⁵ HRS

A-12003510030
T-45202/4R202A1a203

Your Account Stated to Date - If Error Is Found, Return at Once

Your Account Stated to Date - If Error is Found, Return at Once
 A-1200051 06320
 T-152202/022/06203

15								
14								4235-45
13								
12								
11								
10								
9								
8								
7								
6								
5								
4								
3								
2								
1								
Address		TATE MAN		Account Forward				

TO 10:30 AM
 TO 10:30 AM

4 HCS

Date 5.1.21
 M.H.S.
 [Signature]

OK
PR

M flca Date 5.2.21 jm

Address _____

Reg No	FUEL	Account Forward
1		
2		
3	6.30 AM	
4		
5	TO	
6		
7	10.30 AM	
8		
9		
10		
11		
12		
13		
14	4235-46	
15		

4 HRS

Handwritten initials "OF" and "M" above the date field.
Date: 5.8.21
M: HSC

Address: 75101 WIAN

	Account Forward		
1			
2			
3			
4			
5			
6			
7			
8			
9			
10			
11			
12			
13			
14			
15			

Handwritten notes in the table:
- "0.00 AM" in row 3
- "TO" in row 5
- "10.30 AM" in row 8
- "3309-4" in row 14

4 HAS

OK
Date 5.9.21
M HEC

Address

Reg No	Account Forward
1	
2	
3	
4	
5	
6	
7	
8	
9	
10	
11	
12	
13	
14	
15	

4:30 AM
TO
10:30 AM

3309-5

4 HRS

Ops

Date 5-15-21

IN Kirby Black

Address Fuel Truck

Reg. No.	Clerk	Account Forward		
1				
2	8:30 a.m.			
3				
4	to			
5				
6	12:00 p.m.			
7				
8				
9				
10				
11				
12				
13				
14	3309-11			
15				

3⁵ hrs

ok

Date 5-16-21

NR Kirby Black

Address Fuel Track

Reg. No.	Clark	Account Forward		
1	9:00			
2		<i>am</i>		
3	to			
4				
5	12:30			
6		<i>pm</i>		
7				
8				
9				
10				
11				
12				
13				
14	3309-12			
15				

3⁵ HRS

A-1200/86100300
T-43202/413202/48203

Your Account Stated to Date - If Error is Found, Return at Once

OK
for

Date 5-22-21

M. K. Black

Address Fuel Truck

Reg. No.	Clerk	Account Forward		
1	8:00 a.m.			
2				
3	To			
4	11:30 a.m.			
5				
6				
7				
8	• Failed pumps throughout M.O.			
9				
10				
11				
12				
13				
14				
15				

3⁵ HRS

du
m

Date 5-23-21

M KB

Address Fuel Truck

Reg. No.	Clerk	Account Forward		
1	8:30			
2	to			
3	11:30			
4				
5				
6				
7				
8				
9				
10				
11				
12				
13				
14	3:00			
15				

3 HRS

Associated Pump & Supply, LLC

9074 Park Avenue
 Houma, LA 70363
 Phone: (985) 851-7077
 Fax: (985) 876-9854

RECEIVED
 MAR 31 2021

7
 (copy reference for change order work)
Invoice

Date	Invoice #
3/24/2021	11135-1

Bill To
Fleming Construction Co., LLC 23 E. Airline Drive Kenner, LA 70062

Ship To
St. Charles Parish Schexnaydre Pump Station Improvements Project No. P190502

P.O. Number	Terms	Rep	Ship	Via	F.O.B.	Project
20-201-1	30 Days		2/22/2021	Our Truck		

Quantity	Item Code	Description	Price Each	Amount
		Rental from 02/22/21 thru 03/22/21 = 1 Month		
1	Rental	24" Submersible hydraulic pump (sn:26176) w/ APS276 Diesel drive unit (2-75 HP)	8,250.00	8,250.00T
1	Rental	50' Set of hydraulic hoses w/ fittings	0.00	0.00T
4	Rental	24" x 20' Steel pipe	130.00	520.00T
1	Rental	24" x 10' Steel pipe	65.00	65.00T
1	Rental	24" x 5' Steel pipe	0.00	0.00T
2	Rental	24" x 3' Steel pipe	19.50	39.00T
2	Rental	24" x 90° Elbow	0.00	0.00T
1	Rental	24" x 45° Elbow	385.00	385.00T
1	Rental	24" x 22° Elbow	385.00	385.00T
1	Rental	Set of floats	0.00	0.00T
1	Sales	Rental of Reach Forklift	1,266.88	1,266.88T
	Delivery	Delivery of Equipment	500.00	500.00
	Set-Up Charge	Set-Up Charge PLUS Lumber	1,540.00	1,540.00
		LA/St Charles Parish Sales Tax	9.45%	1,031.07

*8250
 520
 65
 39
 385
 385*

Purchaser agrees to pay interest in the amount of one and one-half percent (1 1/2%) per month on all invoices over thirty days old. Purchaser further agrees to pay thirty three and one third percent (33 1/3%) attorney's fees plus legal interest if account is placed in the hands of an attorney for collection.

9,644.07/110

Thank You For Your Business! Have A Great Day!	Total	\$13,981.95
--	--------------	--------------------



DISTRIBUTORS OF
PETROLEUM PRODUCTS



Wes-Pet, Inc

2320 N. Causeway Blvd.
Metairie, LA 70001
Phone: (504)-833-6385 Fax: (504)-833-6386
Email: denise@wes-pet.com
Website: http://www.wes-pet.com

PLEASE REMIT TO:
PO Box 24122
New Orleans, LA 70184

INVOICE

INVOICE NO. 202102820

Batch Number: AAACLZ

Transaction Number: 28

ACCT. NO.: FLEM00010

SOLD TO: FLEMING CONSTRUCTION
23 EAST AIRLINE DRIVE
KENNER LA 70062
UNITED STATES

SHIP TO: LOUIS 296-1183 PAUL 376-5286
OFF. 464-4000 EXT. #242
COMBO 0033#
UNITED STATES

Phone: (504) 464-4000 Fax: (504) 464-4036

Phone: (504) 464-4000 Fax: (504) 464-4036

Sales No.	Purchase Order No.	Ship Via	Sales-Person	Date Shipped	Terms	Invoice Date
28	1941	OUR TRUCK	MG1	05/25/2021		05/25/2021
Quantity Ordered	Quantity Shipped	Back Ordered	ITEM NO.	DESCRIPTION	UNIT PRICE	EXTENDED PRICE
319.0000 ✓	319.0000	0.0000	DIE00020	ULS DYED DIESEL FUEL NA 1993 3 PG III <i>COST PER GALLON</i>	\$2.2600	\$717.76
HAZARDOUS MATERIALS EMERGENCY CONTACT: PERS 1-800-833-8253				SALES AMOUNT		\$717.75
Signature: <i>[Handwritten Signature]</i>				TAXABLE TOTAL		\$717.75
				SALES TAX		\$31.94
				FREIGHT		\$0.00
				TOTAL		\$749.69



CUSTOMER COPY
PROGRESS BILLING

3/22/21

Res/Quote Number: 53332153

PAYMENT TERMS ARE DUE UPON RECEIPT
LATE CHARGES MAY APPLY
Customer is responsible for FUEL, FLATS,
DAMAGE and CLEANUP FEES.

FLEMING CONSTRUCTION COMPANY I
23 EAST AIRLINE DRIVE
KENNER, LA 70062-6801



Invoice Number: 31955390-001

AMOUNT DUE: \$ 5466.55

AMOUNT ENCLOSED: \$

CUSTOMER NUMBER: 0021641

MAIL PAYMENT TO:
HERC RENTALS INC.
PO BOX 986257
ATLANTA, GA 31183

To insure accuracy and timely posting, detach and send top portion with your payment

RENTED FROM: FLEMING CONSTRUCTION CO.
143 WILLIAMS DR
MESTREHAN, LA 70067
Tel: 504-371-6631
Fax: 504-660-0900

RENTAL DATES: 2/22/21 - 3/22/21
INVOICE FROM DATE: 2/22/21
INVOICE TERM DATE: 3/22/21

PO# : 1111
JOB NUMBER : 37- FLEMING CONSTRVC
RENTAL START DATE: 2/22/21 9:00
DELIVERED BY: LOUTE
ORDERED BY: GRAVES, JASON
SIGNED BY: WET SIGNATURE
SALES REP: CHRISTOPHER CURSTID
CLOSED BY:

DESCRIPTION	AMOUNT	TOTAL
RENTAL CHARGES	4500.00	4500.00
OTHER CHARGES	329.10	329.10
DELIVERY/PICK UP	290.00	290.00
TAXABLE CHARGES	4629.10	4629.10
TRX	437.45	437.45
TOTAL CHARGES	5466.55	5466.55

NET DUE 5466.55

QTY	EQUIPMENT #	HRS	MIN	HOOR	DAY	WEEK	4 WEEK	MONTH
1	PUMP VAC ASSIST SMD ATT 12IN DSI SKID 800246893	5/	500.00	53.33	500.00	1500.00	4500.00	4500.00

8021171
HR OUT: 369.20 HR IN: LR CHG:
Subbed for open unit
EMISSIONS & ENV SURCHARGE

2 WATER PUMP FLOAT SWITCH SINGLE 5/
9203640
EMISSIONS & ENV SURCHARGE

SALES ITEMS	UNIT	PRICE	AMOUNT
1 CORSIDE FREIGHT DELIVERY	EA	200.000	200.00
1 TRANS SRVC SURCHARGE	EA	20.000	20.00
1 TRANS SRVC SURCHARGE	EA	20.000	20.00

371000001 - TRANS SERVICE SURCHARGE

Customer Number: 0021641 Res/Quote Number: 53332153 Invoice Number: 31955390-001 Invoice Date: 3/22/21

For GREAT DEALS on USED EQUIPMENT - Visit us at HercRentals.com

Mater ready AT START

FROM: OSCAR PEREZ (TEXT)

24" Pump
Flow Meter

4,088.1 HRS (START)
Current HRS 4,100.39

24" Fuel used 12.30 HRS @ 12.39/Hr = 152.40 gallons
152.40 gallons x

12" Fuel used 22.80 HRS @ 11.1/Hr = 253.08 gallons

405
405 gallons
Fuel
Used

405 gallons x 2.25/gal = \$ 911.25



1 Photo Selected

Options >

3:44 PM

50%



Oscar >

Read 5/3/21

check with my tech

Mon, May 3, 3:03 PM

here tomorrow
ing to pick up

Tue, May 4, 8:36 AM

n in the parking lot
up the box to take
exnaydre pump

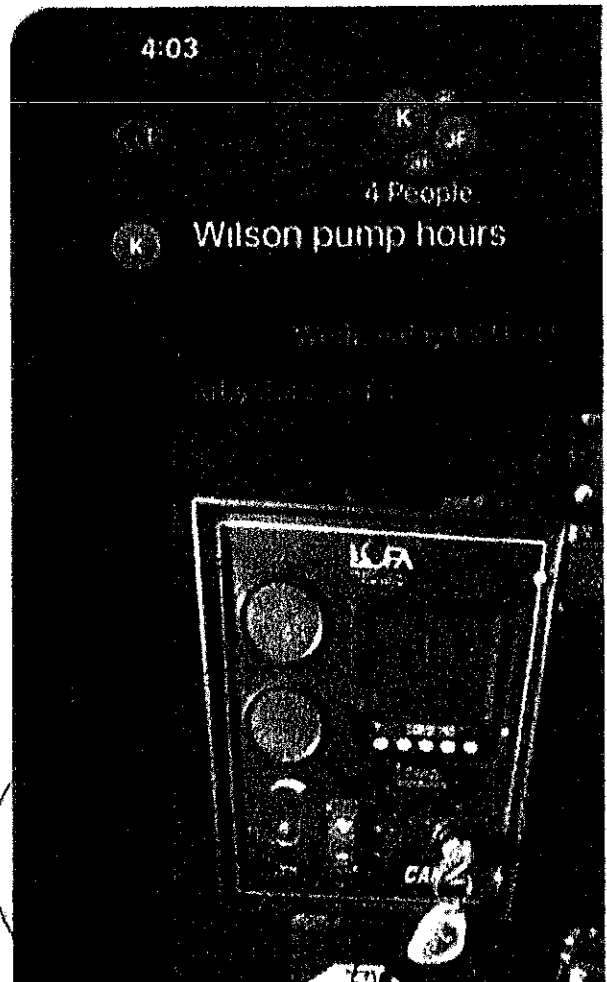

2

392.2



PREMIER PUMP & POWER
THE WAVE OF THE FUTURE

PREMIER PUMP & POWER

SPECIFICATION SHEET FOR MODEL 12NNT Trailer Mounted Trash Pump

VACUUM ASSISTED, HEAVY DUTY SOLIDS
HANDLING PUMP

PUMP SPECIFICATIONS

Size	12" X 12" AISI 150# flanges
Wear Ring	ASTM A48 class 30 cast iron
Volute Casing	ASTM A536 Grade 65-45-12 ductile iron
Backplate	ASTM A48 class 30 cast iron
Mechanical Seal	Tungsten vs. Silicon Carbide seal faces, Viton elastomers, 300 series stainless steel hardware & spring, seal system designed for dry indefinite running
Impeller	Enclosed type, two port, non clog, w/4 inch spherical solids handling capability. ASTM A48 class 30 cast iron
Bearing Housing	ASTM A48 class 30 cast iron
Pump-end Bearing	Single row ball – 6316-C3
Drive-end Bearing	Duplex angular contact ball – 7316-C3
Shaft	17-4PH corrosion resistant
Lip Seals	CR type, single lip
Discharge check valve	Swing type, ductile iron w/Buna-N disc

PRIMING

Priming System	Haldex 1300 Series compressor. Lubricated by engine oil and cooled by engine water
Separator Spool	Standard steel
Air/Water Chamber	Chamber designed to separate air and water before entering the pump case
Venturi	Constructed of non-corrosive bronze
Optional Priming	50 CFM diaphragm vacuum pump

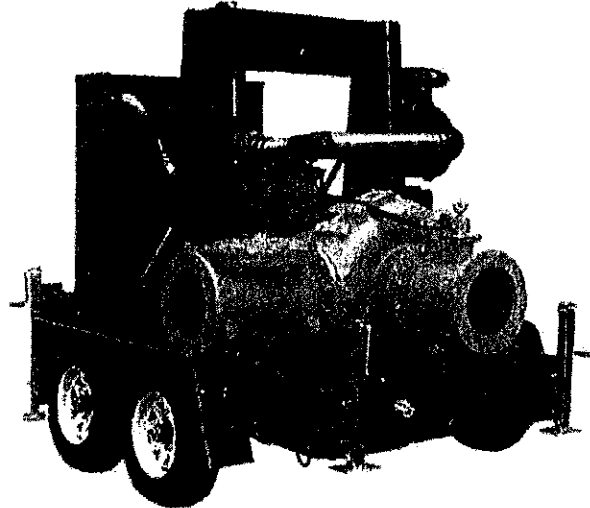

ENGINE SPECIFICATIONS

Model	Cummins Model QSF6.7 Final Tier 4
Horsepower	225 intermittent horsepower @ 2200 RPM six cylinder, four cycle, water cooled diesel engine
Governor	Electronic
Fuel Consumption	11.1 Gallons Per Hour @ Max RPM
Safety Shut Down	Low Oil Pressure, High Temperature and V-Belt Failure
Instrument Panel	Lofa CP750 auto start panel

STANDARD TRAILER

Frame	Heavy duty, powder coated fabricated steel frame with lifting bale
Fuel Tank	180 gallon HDPE fuel cell
Axle	Dual 7000# Torsion Flex
Brakes	Electric with DOT lighting package

BDC

Diesel engine power to Fuel Consumption table - Naturally aspirated Engines

Table based on fuel consumed at 240 g/kW hour

Power Unit			Fuel Consumption per hour			
hp	kW	kVA	lb	kg	liter	US gal
1	0.75	0.93	0.40	0.18	0.21	0.06
1.07	0.8	1	0.43	0.19	0.23	0.06
1.34	1	1.25	0.54	0.24	0.29	0.08
5	3.73	4.66	2.00	0.90	1.07	0.28
7	6.22	6.52	2.80	1.30	1.49	0.39
hp	kW	kVA	lb	kg	liter	US gal
10	7.46	9.32	4.00	1.80	2.13	0.56
12	9	11	4.80	2.20	2.56	0.68
15	11	14	6.00	2.70	3.20	0.85
18	13	17	7.20	3.25	3.84	1.01
20	15	19	8.00	3.50	4.26	1.13
22	16	21	8.80	4.00	4.69	1.24
25	19	23	10	4.5	5.33	1.41
35	26	33	14	6.4	7.46	1.97
50	37	47	20	9.1	10.66	2.82
hp	kW	kVA	lb	kg	liter	US gal
55	41	51	22	10	11.7	3.09
60	45	56	24	10.9	12.8	3.38
65	48	61	26	11.8	13.9	3.67
75	56	70	30	13.6	16	4.23
80	60	75	32	14.5	17.1	4.52
100	75	93	40	18	21.3	5.63
hp	kW	kVA	lb	kg	liter	US gal
120	89	112	48	22	25.6	6.76
150	112	140	60	27	32	8.45
200	149	186	80	36	42.6	11.25
240	164	205	88	40	46.9	12.39
300	224	280	120	54	63.9	16.88
310	231	289	124	56	66.1	17.46
350	261	326	140	80	64	19.71
hp	kW	kVA	lb	kg	liter	US gal
400	298	373	160	73	85.3	22.53
450	336	419	180	82	95.9	25.33
500	373	466	200	91	106.6	28.16
600	447	559	240	109	128	33.8
750	559	699	300	136	160	42.3
1000	746	932	400	181	213	56.3
hp	kW	kVA	lb	kg	liter	US gal

Approximate guide only, subject to change without notice
BDC for engine manuals and specs
<https://barringtondieselclub.co.za/>