

# JOINT PUBLIC NOTICE

July 5, 2000

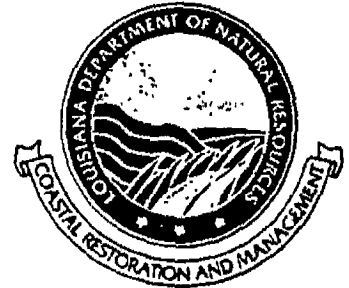

STATE OF LOUISIANA  
DEPARTMENT OF ENVIRONMENTAL QUALITY  
OFFICE OF ENVIRONMENTAL SERVICES  
P.O. BOX 82135  
BATON ROUGE, LA 70884-2135  
(225) 765-0664

DEQ REVIEWER:  
James Little

WATER QUALITY CERTIFICATION NUMBER:  
000518-02

STATE OF LOUISIANA  
DEPARTMENT OF NATURAL RESOURCES  
COASTAL MANAGEMENT DIVISION  
P.O. BOX 44487  
BATON ROUGE, LA 70804-4487  
(225) 219-4969

CMD REVIEWER:  
C. S. Melton

COASTAL USE PERMIT NUMBER:  
P000686

Interested parties are hereby notified that the Coastal Management Division of the Department of Natural Resources has received the following application for a Coastal Use Permit (CUP) in accordance with the State and Local Resources Management Act of 1978, as amended, (Louisiana R.S.49, Sections 214.21-214.41), and the rules and regulation of the Coastal Resources Program.

Application has also been made to the Louisiana Department of Environmental Quality, Office of Environmental Services for a Water Quality Certification in accordance with statutory authority contained in the Louisiana Revised Statutes of 1950, Title 30, Chapter 11, Part IV, Section 2074 A(3) and provisions of Section 401 of the Clean Water Act (P.L. 95-217).

**NAME:** Sorrento Pipeline Company, L.L.C., c/o Morris P. Hebert, Inc., P.O. Box 3106, Houma, LA 70361, Attn: Michael Capello.

**LOCATION:** St. Charles Parish, LA; POB - Lat. 29° 59' 40" N, Long. 90° 23' 12" W; POE - Lat. 30° 00' 56" N, Long. 90° 24' 15" W; Sections 6 and 7, T12S-R8E.

**DESCRIPTION:** Installation of two 8" pipelines (±10,476' in length) with a 30' permanent right-of-way and 20' temporary right-of-way to transport P/P mix and butanes from the Orion Refinery to the Enterprise Norco Refractionator. The pipelines will be buried a minimum of 3' below the surface. Directional drill sites with temporary workspaces will be used to cross the Kansas City Southern Railroad, an old pit, US Hwy. 61 and Airline Canal, a congested pipeline corridor, and the canal in front of the Shell/Motiva Plant. Approx. 7,240 cu. yds. of native soils will be excavated with a backhoe, placed in a ±10' wide area adjacent to the pipe ditch, and as backfill when the pipeline installation is complete. Approx. 14.5 acres of developed uplands and approx. 3.26 acres of forested wetlands will be impacted as a result of this activity.\*

The official date of the beginning of the public comment period for Coastal Use Permits and Water Quality Certification applications begins on the date of publication of the notice in the official state journal (The Advocate), in accordance with the Rules and Procedures for Coastal Use Permits, §723.C.5.c. The Coastal Management Division will inform interested parties of the exact date of publication on request.

\* Habitat impacts are based on available in-house data and may not represent actual conditions. Field reconnaissance may be required to verify extent of impacts.

43

THE APPLICANT MUST SECURE A STATE COASTAL USE PERMIT. LOUISIANA DEPARTMENT OF ENVIRONMENTAL QUALITY WATER QUALITY CERTIFICATION IS ALSO REQUIRED. INDEPENDENT EVALUATIONS AND DECISIONS WILL BE MADE BY THE COASTAL MANAGEMENT DIVISION AND THE DEPARTMENT OF ENVIRONMENTAL QUALITY.

Plans for the proposed work are now on file and may be inspected at the office of the Coastal Management Division, Department of Natural Resources, State Land and Natural Resources Building, 625 North 4th Street, Room 1011, Baton Rouge, Louisiana 504/342-7591. Written comments, including suggestions for modifications or objections to the proposed work and stating the reasons thereof, are being solicited from anyone having an interest in this permit request. Comments to the State of Louisiana, Coastal Management Division must be mailed within 25 days of the date of official journal publication of this notice to Coastal Management Division, Louisiana Department of Natural Resources, P.O. box 44487, Capitol Station, Baton Rouge, Louisiana 70804-4487. Comments concerning this application can be filed with the Office of Environmental Services within ten days of this notice to the following address: Louisiana Department of Environmental Quality, Office of Environmental Services, P.O. Box 82135, Baton Rouge, Louisiana 70884. All comment letters should contain both the applicant's name and the appropriate application number.

#### State of Louisiana Coastal Use Permit Criteria

The decision on whether or not to issue a Coastal Use Permit will be based on an evaluation of the probable impacts of the proposed activity in accordance with the state policies outlined in R.S. 49:214.22. The decision will reflect the national concern for both protection and utilization of important resources. The decision must be consistent with the state program and approved local programs for affected parishes and must represent an appropriate balancing of social, environmental and economic factors. All factors which may be relevant to the proposal will be considered; among these are flood and storm hazards, water quality, water supply, feasible alternative sites, drainage patterns, historical sites, economics, public and private benefits, coastal water dependency, impacts on natural features, compatibility with the natural and cultural setting and the extent of long term benefits or adverse impacts.

#### State of Louisiana Water Quality Certification Criteria

In accordance with the Joint Public Notice Agreement between Coastal Management Division and the Office of Water Resources, notice is hereby given that the applicant has applied to the Louisiana Department of Environmental Quality, Office of Environmental Services for a Water Quality Certification in accordance with statutory authority contained in the Louisiana Revised Statutes of 1950, Title 30, Chapter 11, Part IV, Section 2074 A(3) and provision of Section 401 of the Clean Water Act (P.L. 95-217).

Comments concerning this application can be filed with the Office of Environmental Services within ten days of this notice to the following address: Louisiana Department of Environmental Quality, Office of Environmental Services, P.O. Box 82135, Baton Rouge, Louisiana 70884.

Additional information is on file with the above office, and may be inspected at any time between 8:00 a.m. and 4:30 p.m. weekdays. Copies may be obtained upon payment of cost of printing. A final decision on this application will be made within 60 days after publication of this notice.

#### Public Hearings

Any person may request, in writing, within the comment period specified in this notice, that a public hearing be held to consider this application. Request for public hearings shall state, with particularity, the reasons for holding a public hearing.

46

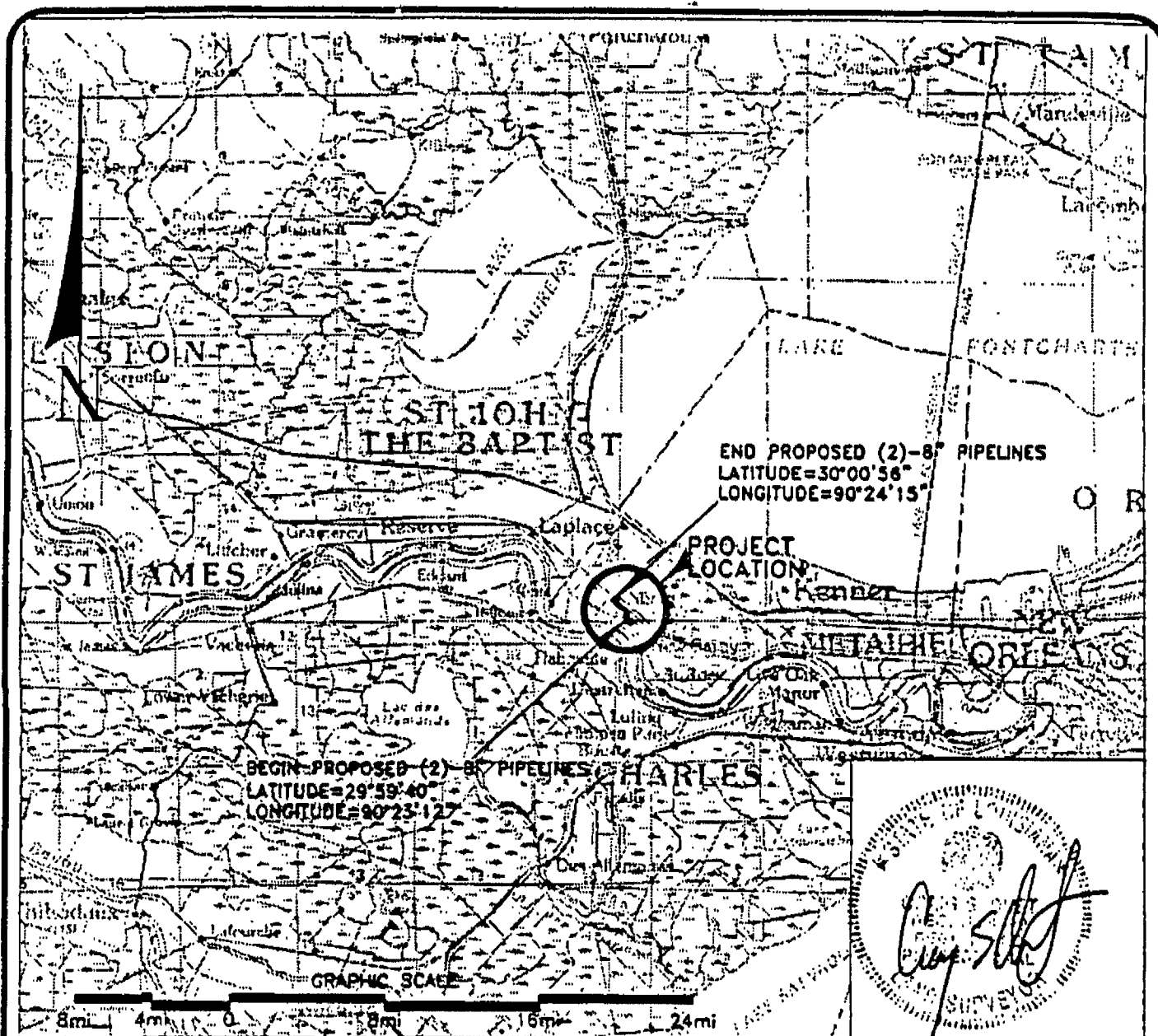

| NO. | DATE | REVISION |
|-----|------|----------|
|-----|------|----------|

## SORRENTO PIPELINE COMPANY, LLC

PROPOSED (2)-8" PIPELINES  
 FROM ORION REFINERY TO THE ENTERPRISE  
 NORCO REFRACATIONATOR LOCATED IN  
 SECTIONS 6 & 7, T12S-R8E,  
 ST. CHARLES PARISH, LOUISIANA



**Morris P. Hebert, Inc.**  
 PROFESSIONAL LAND & HYDROGRAPHIC SURVEYORS  
 P.O. BOX 3108 • HOUMA, LOUISIANA 70361-3108 • (504) 879-2731

|                   |               |
|-------------------|---------------|
| DRAWN BY: GWN     | SHEET: 1      |
| CHECKED BY: JMH   | SCALE: SHOWN  |
| APPROVED BY: DE.  | DATE: 4-12-00 |
| MPH CAD FILE: 601 | DE0001A0      |

(45)

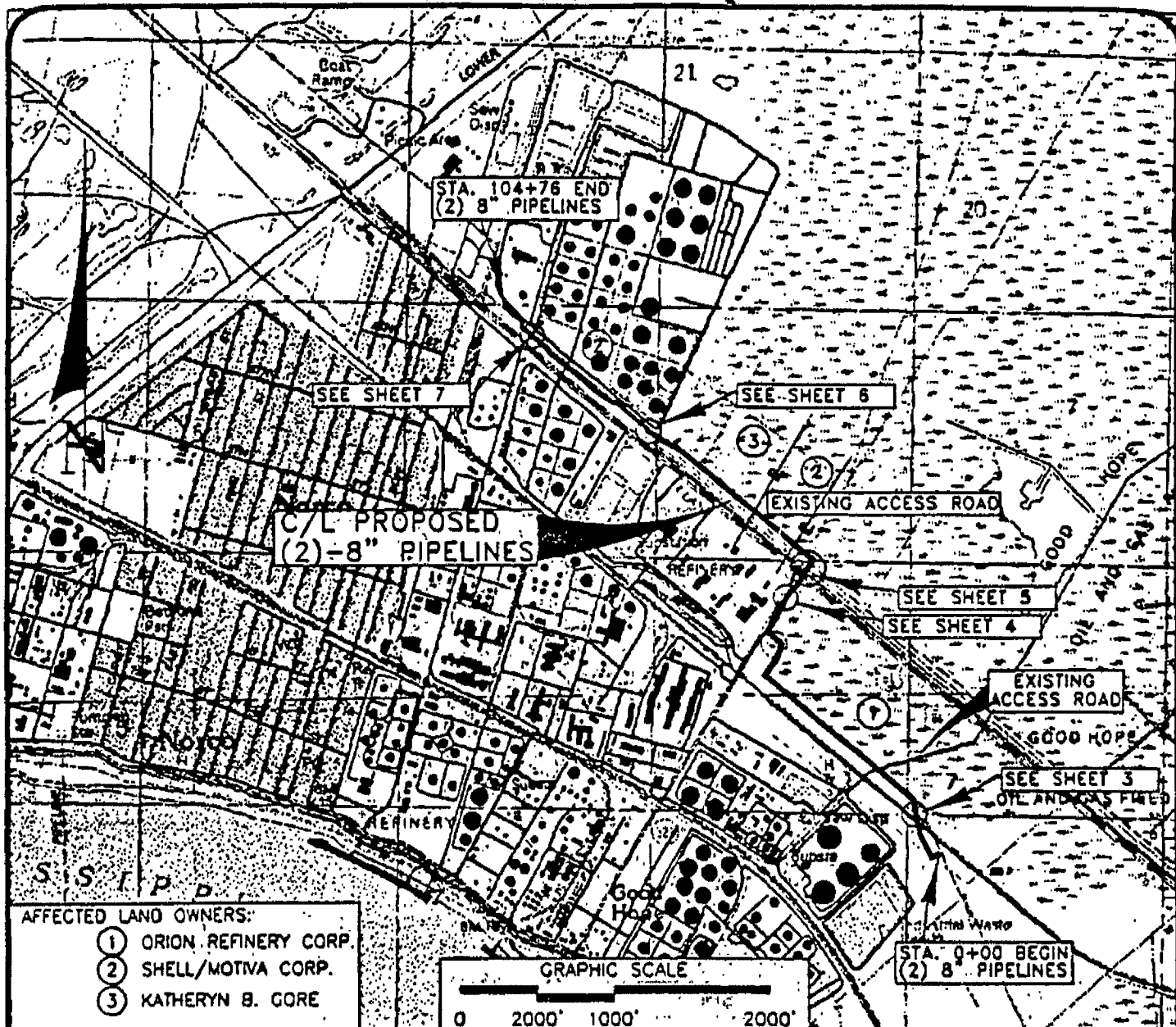

AFFECTED LAND OWNERS:

- ① ORION REFINERY CORP.
- ② SHELL/MOTVA CORP.
- ③ KATHERYN B. GORE

GRAPHIC SCALE

0 2000' 1000' 2000'

| NO. | DATE | REVISION |
|-----|------|----------|
|-----|------|----------|

## SORRENTO PIPELINE COMPANY, LLC

PROPOSED (2)-8" PIPELINES  
FROM ORION REFINERY TO THE ENTERPRISE  
NORCO REFRACATIONATOR LOCATED IN  
SECTIONS 6 & 7, T12S-R8E  
ST. CHARLES PARISH, LOUISIANA



**Morris P. Hebert, Inc.**  
PROFESSIONAL LAND & HYDROGRAPHIC SURVEYORS  
P.O. BOX 3108 • HOUMA, LOUISIANA 70361-3108 • (504) 879-2731

DRAWN BY: GWN

SHEET: 2

CHECKED BY: JMH

SCALE: SHOWN

APPROVED BY: DEC

DATE: 4-3-00

MPH CAD FILE: 6016COE0002A0

ST. CHARLES PARISH, LOUISIANA  
SECTION 7, T12S-R6E

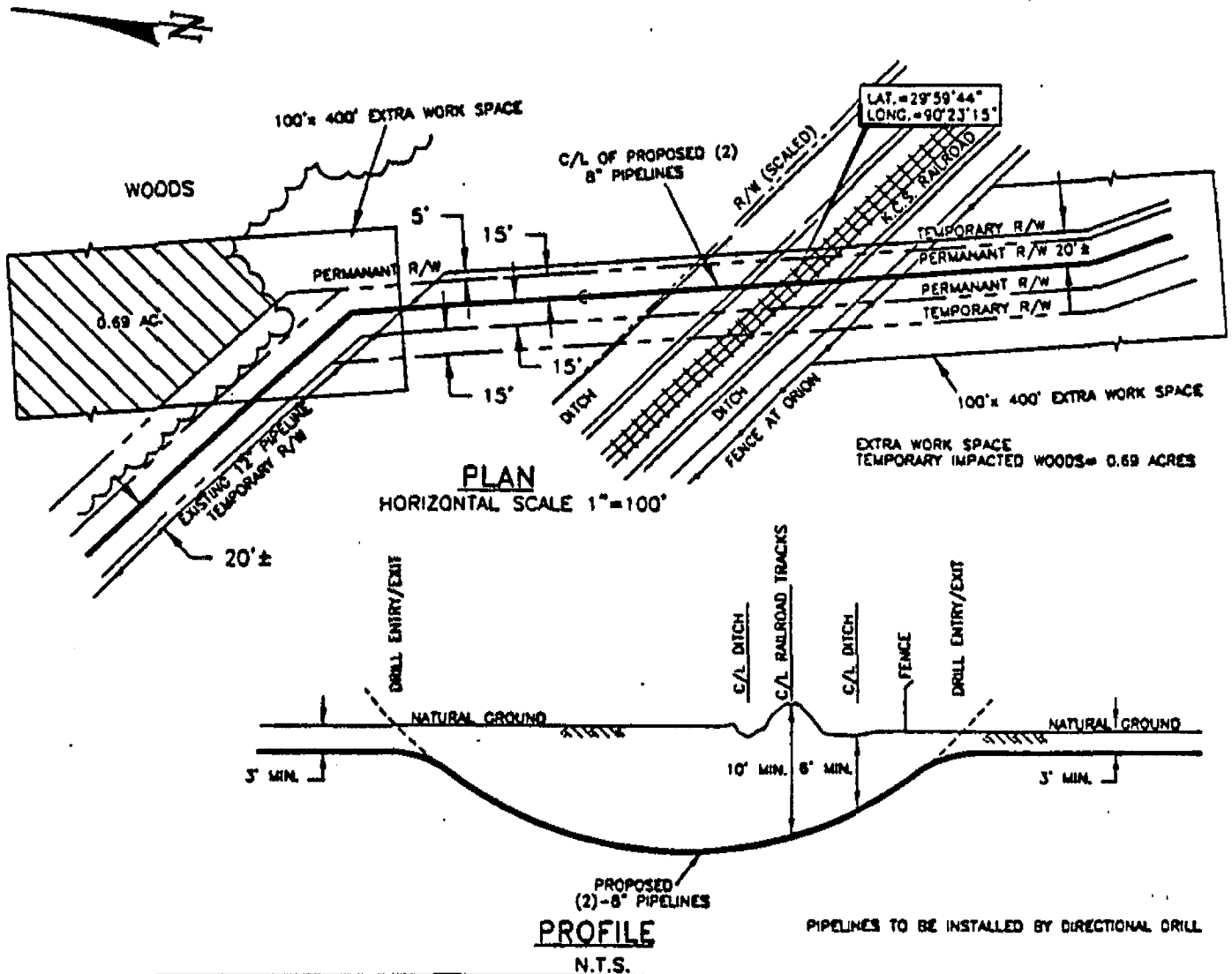

| NO. | DATE | REVISION |
|-----|------|----------|
|-----|------|----------|

**SORRENTO PIPELINE COMPANY, LLC**

PROPOSED (2)-8" PIPELINES  
FROM ORION REFINERY TO THE ENTERPRISE  
NORCO REFRACATIONATOR LOCATED IN  
SECTIONS 6 & 7, T12S-R8E,  
ST. CHARLES PARISH, LOUISIANA



**Morris P. Hebert, Inc.**  
PROFESSIONAL LAND & HYDROGRAPHIC SURVEYORS  
P.O. BOX 3108 • HOUMA, LOUISIANA 70361-3108 • (504) 879-2731

|                             |              |
|-----------------------------|--------------|
| DRAWN BY: GWN               | SHEET: 3     |
| CHECKED BY: JMH             | SCALE: SHOWN |
| APPROVED BY: DEC            | DATE: 4-3-00 |
| MPH CAD FILE: 6016COE0004A0 |              |

47

# ST. CHARLES PARISH, LOUISIANA SECTION 6, T12S-R8E

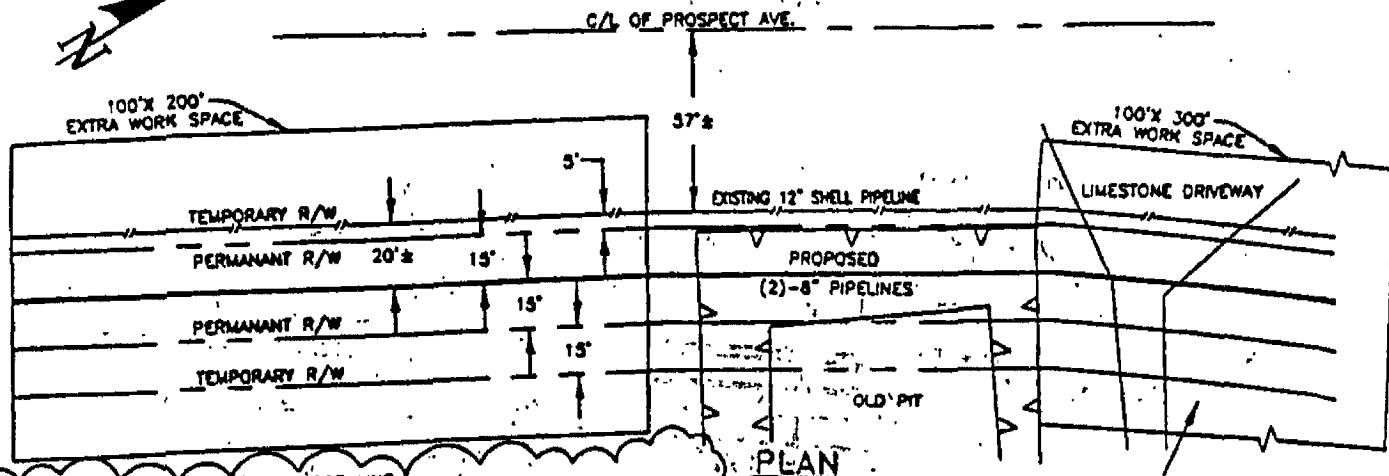

**PLAN**

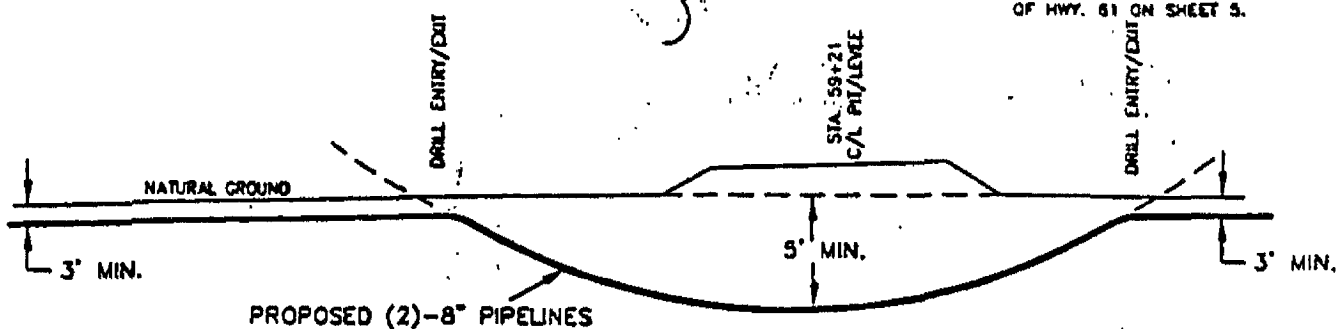

**PROFILE**  
N.T.S.

PIPELINE TO BE INSTALLED BY DIRECTIONAL DRILL OR OPEN CUT METHOD.

| NO. | DATE | REVISION |
|-----|------|----------|
|-----|------|----------|

## SORRENTO PIPELINE COMPANY, LLC

PROPOSED (2)-8" PIPELINES  
FROM ORION REFINERY TO THE ENTERPRISE  
NORCO REFRACATIONATOR LOCATED IN  
SECTIONS 6 & 7, T12S-R8E,  
ST. CHARLES PARISH, LOUISIANA



**Morris P. Hebert, Inc.**  
PROFESSIONAL LAND & HYDROGRAPHIC SURVEYORS  
P.O. BOX 3106 • HOUMA, LOUISIANA 70361-3106 • (504) 879-2731

|                             |              |
|-----------------------------|--------------|
| DRAWN BY: GWN               | SHEET: 4     |
| CHECKED BY: JMH             | SCALE: SHOWN |
| APPROVED BY: DEC            | DATE: 4-3-00 |
| MPH CAD FILE: 6016COE0010AD |              |

# ST. CHARLES PARISH, LOUISIANA SECTION 7, T12S-R8E

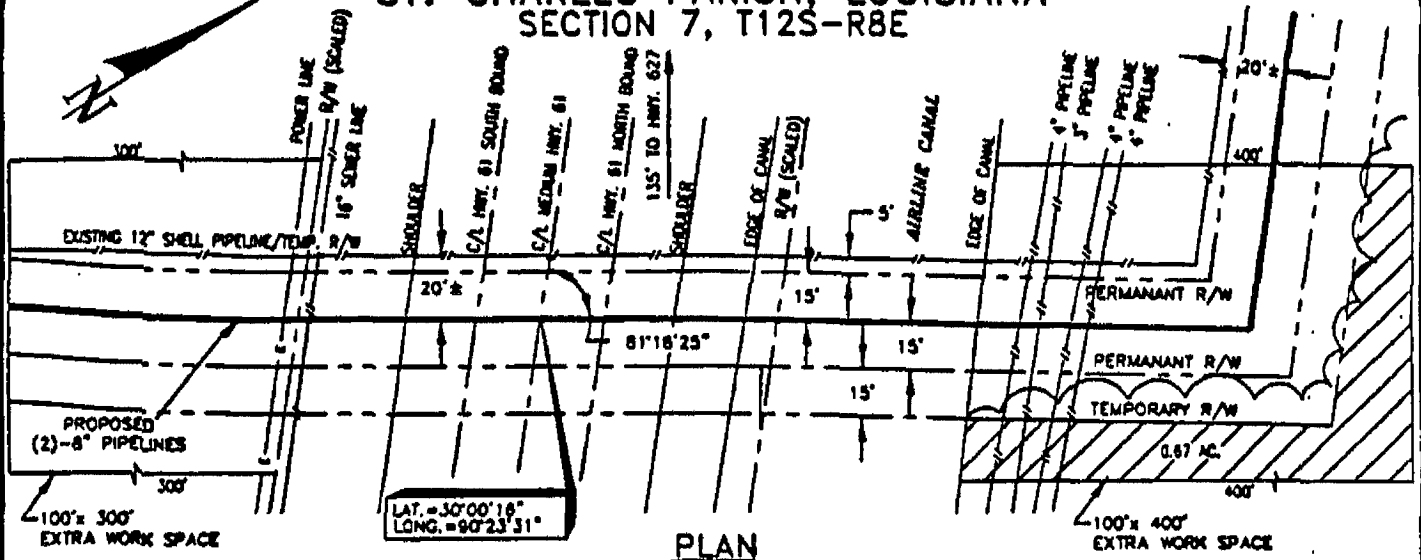

PLAN

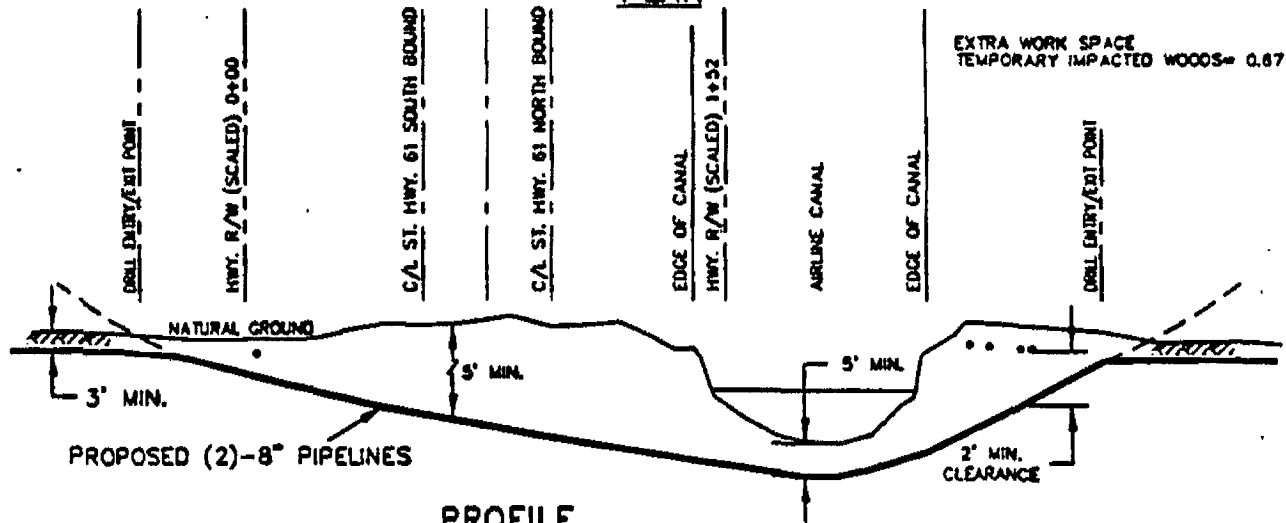

PROFILE  
HORIZONTAL SCALE  
0 30' 60'  
0 15' 30'  
VERTICAL SCALE

PIPELINE TO BE INSTALLED BY DIRECTIONAL DRILL

EXTRA WORK SPACE  
TEMPORARY IMPACTED WOODS= 0.67 ACRES

| NO. | DATE | REVISION |
|-----|------|----------|
|     |      |          |

## SORRENTO PIPELINE COMPANY, LLC

PROPOSED (2)-8" PIPELINES  
FROM ORION REFINERY TO THE ENTERPRISE  
NORCO REFRACATIONATOR LOCATED IN  
SECTIONS 6 & 7, T12S-R8E,  
ST. CHARLES PARISH, LOUISIANA

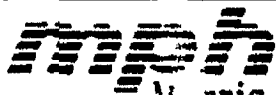

**Morris P. Hebert, Inc.**  
PROFESSIONAL LAND & HYDROGRAPHIC SURVEYORS  
P.O. BOX 3106 • HOUMA, LOUISIANA 70361-3106 • (504) 879-2731

|                             |              |
|-----------------------------|--------------|
| DRAWN BY: GWN               | SHEET: 5     |
| CHECKED BY: JMH             | SCALE: SHOWN |
| APPROVED BY: DEC            | DATE: 4-3-00 |
| MPH CAD FILE: 6016COE0003AO |              |

ST. CHARLES PARISH, LOUISIANA  
SECTION 6, T12S-R8E

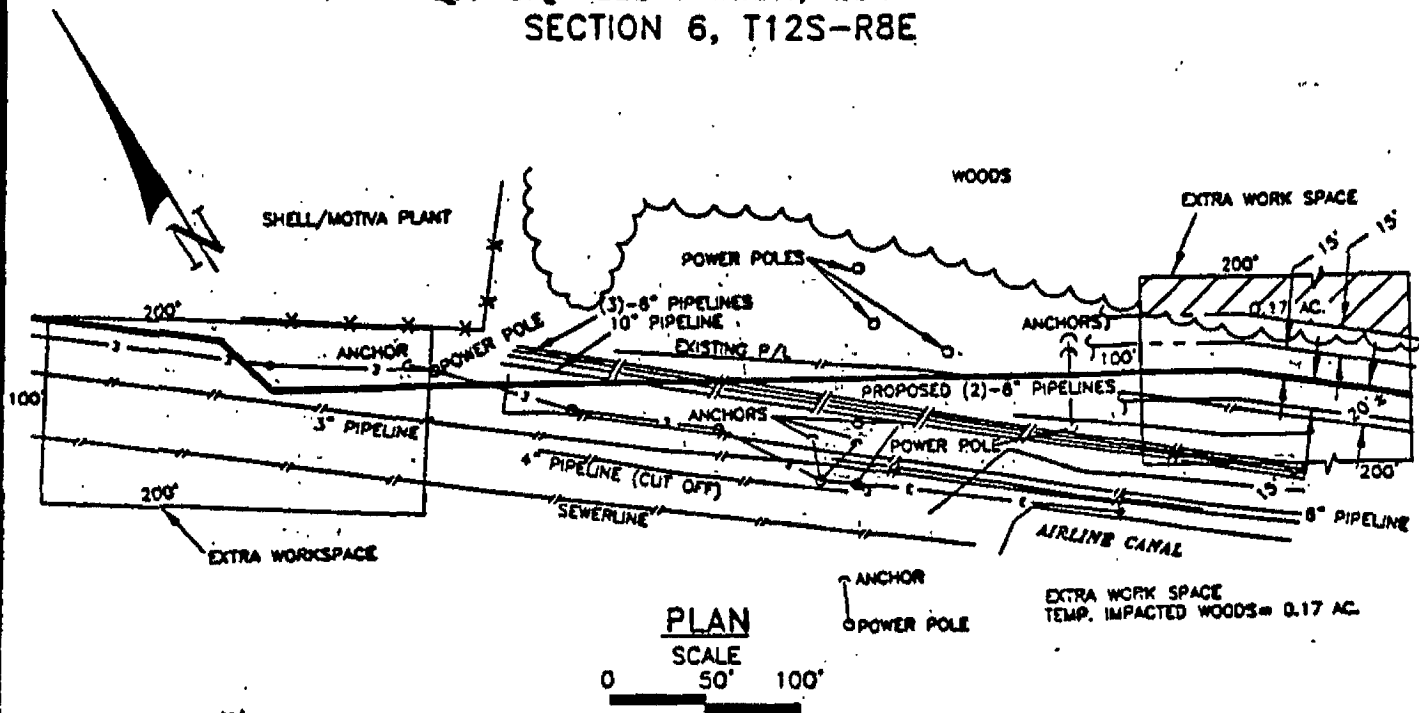

PLAN  
SCALE

0 50' 100'

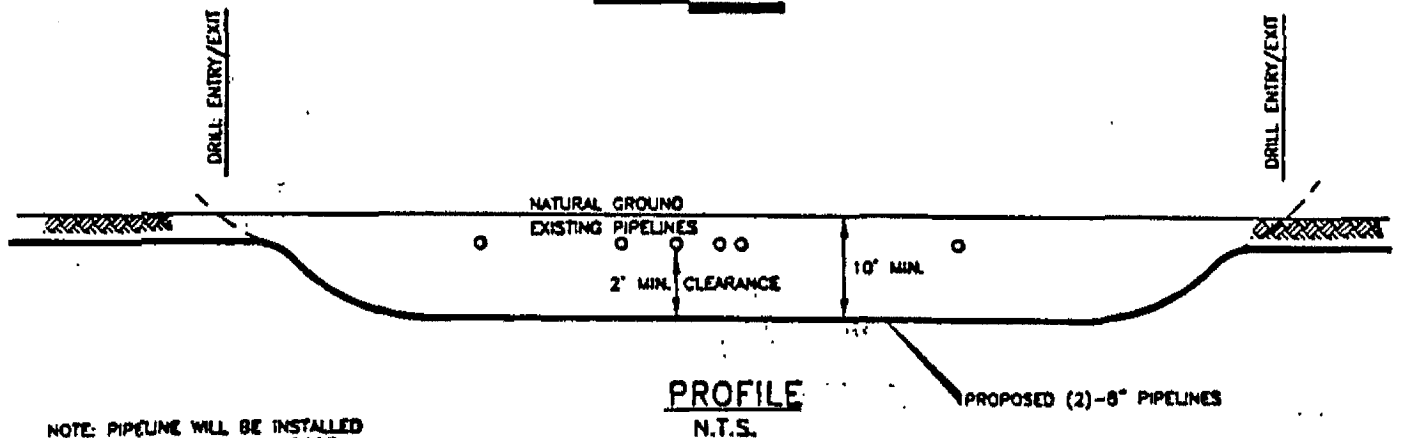

NOTE: PIPELINE WILL BE INSTALLED  
BY DIRECTIONAL DRILL OR BORE  
METHOD.

NO.

DATE

REVISION

**SORRENTO PIPELINE COMPANY, LLC**

PROPOSED (2)-8" PIPELINES  
FROM ORION REFINERY TO ENTERPRISE  
NORCO REFRACATIONATOR LOCATED IN  
SECTIONS 6 & 7, T12S-R8E,  
ST. CHARLES PARISH, LOUISIANA

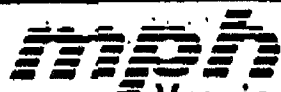

**Morris P. Hebert, Inc.**  
PROFESSIONAL LAND & HYDROGRAPHIC SURVEYORS

P.O. BOX 3108 • HOUMA, LOUISIANA 70381-3108 • (504) 879-2731

DRAWN BY: GWN

SHEET: 6

CHECKED BY: JMH

SCALE: SHOWN

APPROVED BY: DEC

DATE: 4-10-00

MPH CAD FILE: 6016COE0006AD

ST. CHARLES PARISH, LOUISIANA  
SECTION 6, T12S-R8E

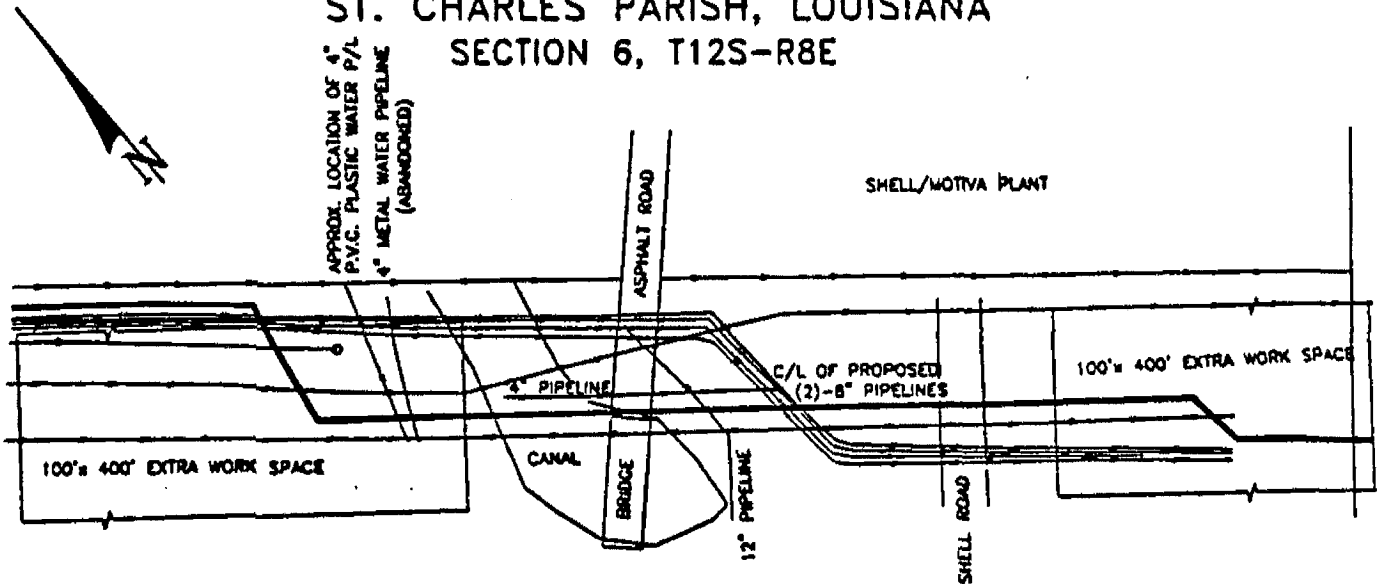

**PLAN**  
HORIZONTAL SCALE 1"=100'

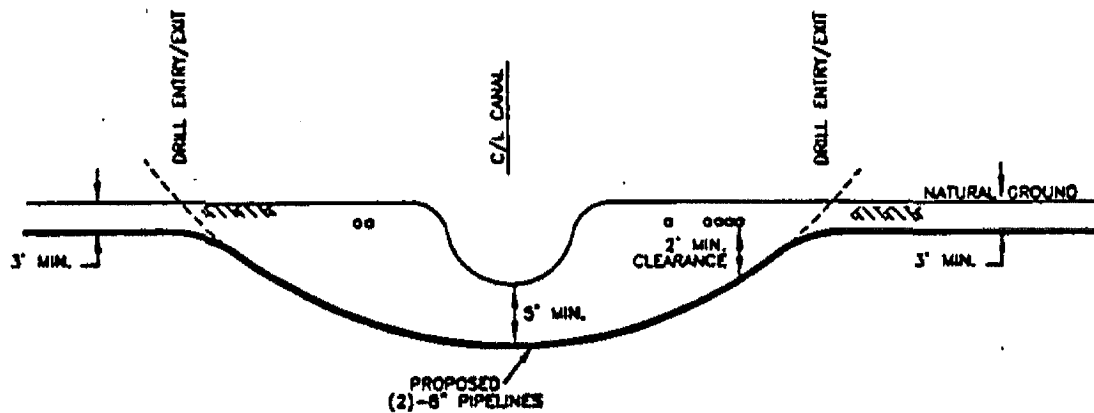

**PROFILE**  
N.T.S.

PIPELINES TO BE INSTALLED BY DIRECTIONAL DRILL  
OR BORE METHOD

| NO. | DATE | REVISION |
|-----|------|----------|
|     |      |          |

**SORRENTO PIPELINE COMPANY, LLC**

PROPOSED (2)-8" PIPELINES  
FROM ORION REFINERY TO ENTERPRISE  
NORCO REFRACATIONATOR LOCATED IN  
SECTIONS 6 & 7, T12S-R8E,  
ST. CHARLES PARISH, LOUISIANA

**mph**

DRAWN BY: GWN

SHEET: 7

CHECKED BY: JMH

SCALE: SHOWN

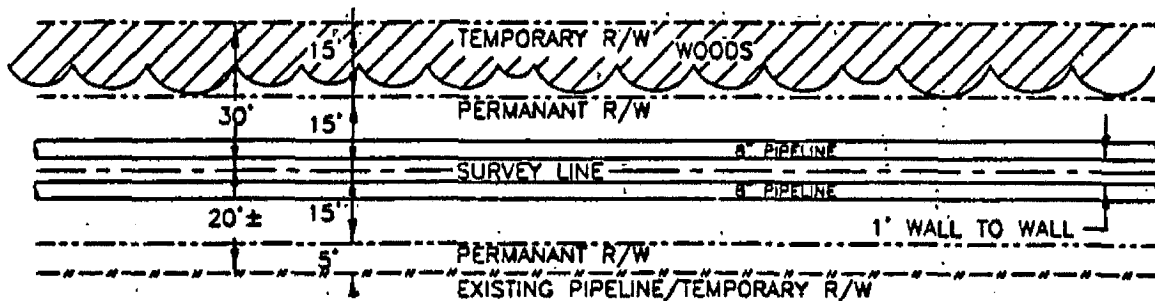

WET LAND DETAIL  
N.T.S.

TEMPORARY IMPACTED WOODS  
 $9+21-13+91=0.16$  AC.  
 $15+30-40+53=0.97$  AC.  
 $51+07-74+16=0.60$  AC.  
**TOTAL=1.73 ACRES**

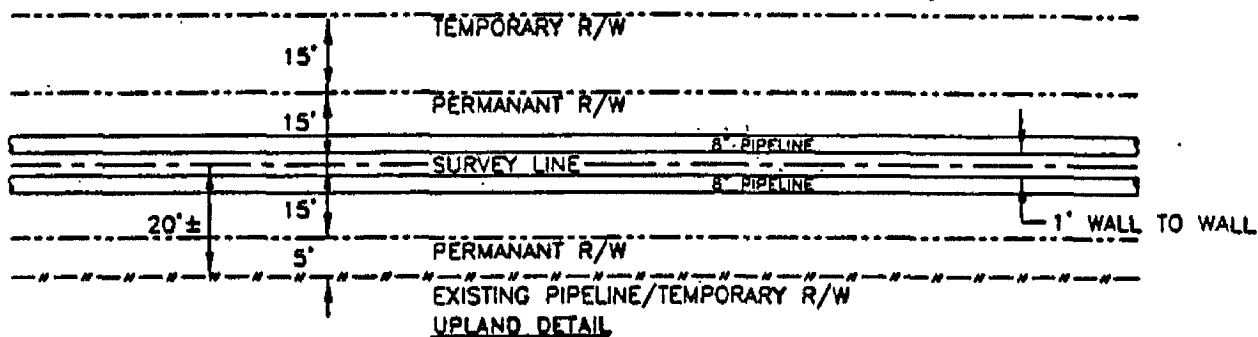

NO TREES IMPACTED  
 $0+00-9+21$   
 $13+91-15+30$   
 $40+53-51+07$   
 $74+16-104+76$

| NO. | DATE | REVISION |
|-----|------|----------|
|     |      |          |

## SORRENTO PIPELINE COMPANY, LLC

PROPOSED (2)-8" PIPELINES  
 FROM ORION REFINERY TO THE ENTERPRISE  
 NORCO REFRACATIONATOR LOCATED IN  
 SECTIONS 6 & 7, T.12S-R8E,  
 ST. CHARLES PARISH, LOUISIANA

(52)



**Morris P. Hebert, Inc.**  
 PROFESSIONAL LAND & HYDROGRAPHIC SURVEYORS  
 P.O. BOX 3106 • HOUMA, LOUISIANA 70361-3106 • (504) 879-2731

|                             |               |
|-----------------------------|---------------|
| DRAWN BY: GWN               | SHEET: 8      |
| CHECKED BY: JMM             | SCALE: SHOWN  |
| APPROVED BY: DEC            | DATE: 4-10-00 |
| MPH CAD FILE: 6016COE0011A0 |               |

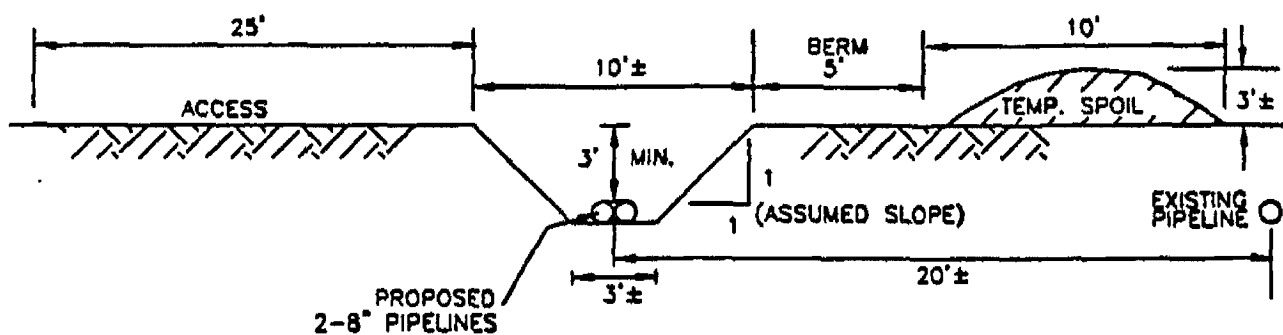

**DITCH DETAIL**  
NOT TO SCALE

| NO. | DATE | REVISION |
|-----|------|----------|
|-----|------|----------|

## SORRENTO PIPELINE COMPANY, LLC

PROPOSED (2)-8" PIPELINES  
FROM ORION REFINERY TO THE ENTERPRISE  
NORCO REFRACATIONATOR LOCATED IN  
SECTIONS 6 & 7, T12S-R8E,  
ST. CHARLES PARISH, LOUISIANA

53



**Morris P. Hebert, Inc.**  
PROFESSIONAL LAND & HYDROGRAPHIC SURVEYORS  
P.O. BOX 3108 • HOUMA, LOUISIANA 70361-3108 • (504) 879-2731

|                             |               |
|-----------------------------|---------------|
| DRAWN BY: GWN               | SHEET: 9      |
| CHECKED BY: JMH             | SCALE: SHOWN  |
| APPROVED BY: DEC            | DATE: 4-10-00 |
| MPH CAD FILE: 6016COE0012A0 |               |

NOTES:

1. APPROXIMATELY 7,420± CUBIC YARDS OF SPOIL MATERIAL WILL BE EXCAVATED BY BACK HOE. SPOIL WILL BE PLACED ADJACENT TO PIPE DITCH DURING CONSTRUCTION. FOLLOWING CONSTRUCTION, SPOIL WILL BE RETURNED TO DITCH.
2. A TOTAL OF APPROXIMATELY 3.26± ACRES OF WOODLAND TO BE AFFECTED BY CONSTRUCTION OF THE PROPOSED PIPELINES. NO WOODS WILL BE PERMANENTLY IMPACTED. APPROXIMATELY 1.73± ACRES WILL BE TEMPORARILY IMPACTED AND 1.53± ACRES WILL BE TEMPORARILY IMPACTED BY EXTRA WORKSPACE.
3. TIMBER SHALL BE CHIPPED, BURNED OR REMOVED FROM RIGHT-OF-WAY.

| NO.  | DATE         | REVISION  |               |           |                 |              |                  |              |                             |  |
|--|--------------|---|---------------|-----------|-----------------|--------------|------------------|--------------|-----------------------------|--|
| <b>SORRENTO PIPELINE COMPANY, LLC</b>  |              |   |               |           |                 |              |                  |              |                             |  |
| PROPOSED (2)-8" PIPELINES<br>FROM ORION REFINERY TO THE ENTERPRISE<br>NORCO REFRACATIONATOR LOCATED IN<br>SECTIONS 6 & 7, T12S-R8E,<br>ST. CHARLES PARISH, LOUISIANA   |              |   |               |           |                 |              |                  |              |                             |  |
| <br><b>Morris P. Hebert, Inc.</b><br>PROFESSIONAL LAND & HYDROGRAPHIC SURVEYORS<br>P.O. BOX 3108 • HOUMA, LOUISIANA 70381-3108 • (504) 879-2731 |              | <table border="1"><tr><td>DRAWN BY: GWN</td><td>SHEET: 10</td></tr><tr><td>CHECKED BY: JMH</td><td>SCALE: SHOWN</td></tr><tr><td>APPROVED BY: DEC</td><td>DATE: 4-3-00</td></tr><tr><td colspan="2">MPH CAD FILE: 6016COE0007A0</td></tr></table> | DRAWN BY: GWN | SHEET: 10 | CHECKED BY: JMH | SCALE: SHOWN | APPROVED BY: DEC | DATE: 4-3-00 | MPH CAD FILE: 6016COE0007A0 |  |
| DRAWN BY: GWN  | SHEET: 10    |   |               |           |                 |              |                  |              |                             |  |
| CHECKED BY: JMH  | SCALE: SHOWN |   |               |           |                 |              |                  |              |                             |  |
| APPROVED BY: DEC   | DATE: 4-3-00 |   |               |           |                 |              |                  |              |                             |  |
| MPH CAD FILE: 6016COE0007A0  |              |   |               |           |                 |              |                  |              |                             |  |

cc:pc ✓  
earl ✓