



St. Charles Parish LIBRARY

Our mission is to empower our community
to explore, learn, create, and connect.

Annual report to the Parish Council
April 6, 2026

Leann Benedict, MLIS
Library Director

East Regional Library

160 W. Campus Drive

985-764-2366

Mon - Thu: 9am - 8pm

Fri - Sat: 9am - 5pm



St. Rose Branch

90 East Club Drive

504-465-0646

Mon: 10am - 8pm

Tue - Thu: 10am - 6pm

Fri: 9am - 5pm

Sat: 10am - 2pm



Norco Branch

590 Apple Street

985-764-6581

Mon: 10am - 8pm

Tue - Thu: 10am - 6pm

Fri: 9am - 5pm

Sat: 10am - 2pm



West Regional Library Bookmobile, & Planetarium

105 Lakewood Drive

985-785-8471

Mon - Thu: 9am - 8pm

Fri - Sat: 9am - 5pm



Paradis Branch

307 Audubon Street

985-758-1868

Mon: 10am - 8pm

Tue - Thu: 10am - 6pm

Fri: 9am - 5pm

Sat: 10am - 2pm



Hahnville Branch

14996 River Road

985-783-2341

Mon - Fri: 9am - 5pm



The St. Charles Parish Library Team

- ▶ 89 Team Members
 - ▶ 54 full-time
 - ▶ 35 part-time
- ▶ 10 Full-Time Professional Librarians who hold a Masters Degree in Library and Information Science
- ▶ Director holds Executive Certificate from the State Board of Library Examiners
- ▶ 2 staff currently hold an ALA Library Support Staff Certification, and 8 staff members are currently working towards their certification.

Library Cards

Library cards are free to anyone who lives, works, goes to school, or owns property in St. Charles Parish

- ▶ 41,624 registered borrowers
- ▶ 1,253 new library cards distributed in 2025
- ▶ Non-resident cards available for \$25/year

Services Available at All Branches

- ▶ 188,022 physical items available for checkout in our libraries including:
 - ▶ Fiction & Non-Fiction Books
 - ▶ Magazines
 - ▶ Audiobooks and DVDs
 - ▶ Launchpads (pre-loaded learning tablets)
 - ▶ Wi-Fi Hotspots
 - ▶ Coming Soon - Check Out Louisiana: State Parks and Geaux Explore Backpacks
- ▶ Wi-Fi (available in the parking lots 24/7)
- ▶ Access to public computers (Internet, Microsoft Office)
- ▶ Photocopies and Computer Prints
- ▶ Study Rooms (first come first serve - 2-hour limit if there is a waitlist)
- ▶ Meeting Rooms (by reservation)
- ▶ Programs for All Ages

Digital Resources

81,621 Digital Items Available for Checkout

- ▶ OverDrive (Libby app) - eBooks and Audiobooks
- ▶ Hoopla - eBooks, Audiobooks, Comic Books, Magazines, Music, Movies, & TV Shows
- ▶ Flipster - Magazines
- ▶ New York Times Online
- ▶ Databases covering a wide variety of topics including business, history, consumer guides, food and recipes, genealogy, health job resources, language learning, test preparation, and more
- ▶ HomeworkLA.org - free online tutoring and homework help
- ▶ Check Out Louisiana: Museums - Use your library card to unlock the great historical, cultural, and educational resources of Louisiana's museums
<https://library.la.gov/check-out-louisiana-museums/>

Planetarium

- ▶ Located at the West Regional Library in Luling
- ▶ Free Public Shows
 - ▶ Tuesdays & Thursdays: 6:30pm
 - ▶ Saturday Children's Matinee: 10am
 - ▶ Saturday Afternoon Matinee: 2pm
- ▶ Groups Showings Available
 - ▶ School field trips, Girl Scout and Boy Scout troops, senior citizen groups, and other community organizations
 - ▶ No charge for St. Charles Parish organizations and residents
 - ▶ \$2.00 per person for groups from outside St. Charles Parish
 - ▶ Can seat groups with up to 42 attendees (larger groups can be split across multiple show times)
 - ▶ Contact Jason Talley, Planetarium Supervisor, at 985-785-8471 to schedule group shows or visit <https://www.myscpl.org/visit/planetarium>



**2,183 patrons visited
the Planetarium in
2025**

Bookmobile

- ▶ Mobile library delivering library materials to senior centers, daycares, and individual homes
- ▶ Service hours are between 9:00am and 5:00pm, Monday through Friday.
- ▶ Criteria used to select stops:
 - ▶ Within St. Charles Parish and eligible for a library card
 - ▶ Homebound patrons with physical or medical limitations that prevent them from visiting a local branch, daycares, and senior centers (highest priority)
 - ▶ More than 3 miles from an existing branch
 - ▶ Easily integrated into existing schedule
 - ▶ Enough room to maneuver and park on a level, solid parking area
 - ▶ Safe access for patrons
- ▶ Patrons can request bookmobile service by contacting Destani Clement, Circulation Librarian at the West Regional Library, at 985-785-8471



Bookmobile Circulation Statistics

► 47,452 items delivered to 3,098 patrons in 2025

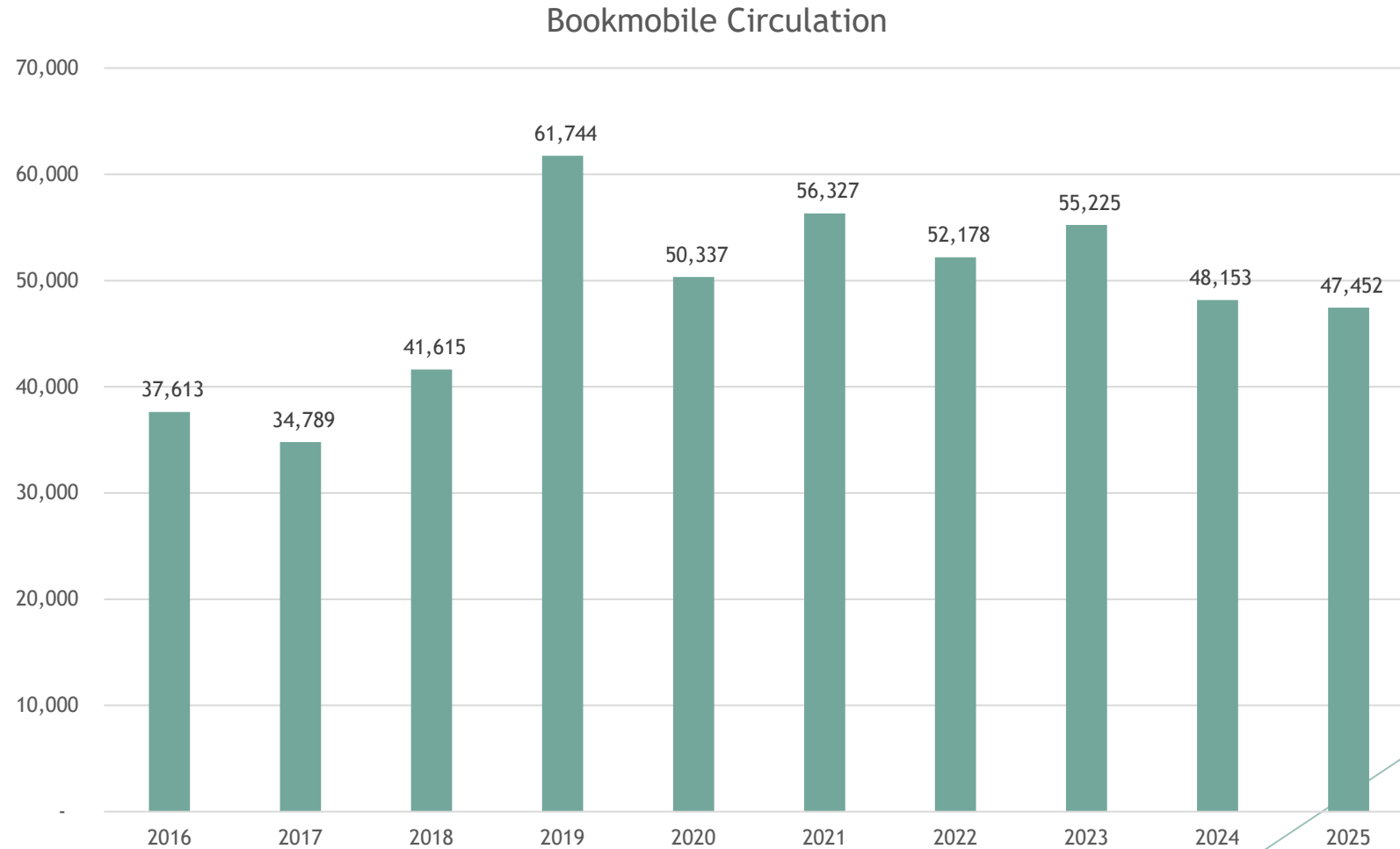

Circulation Statistics - All Branches

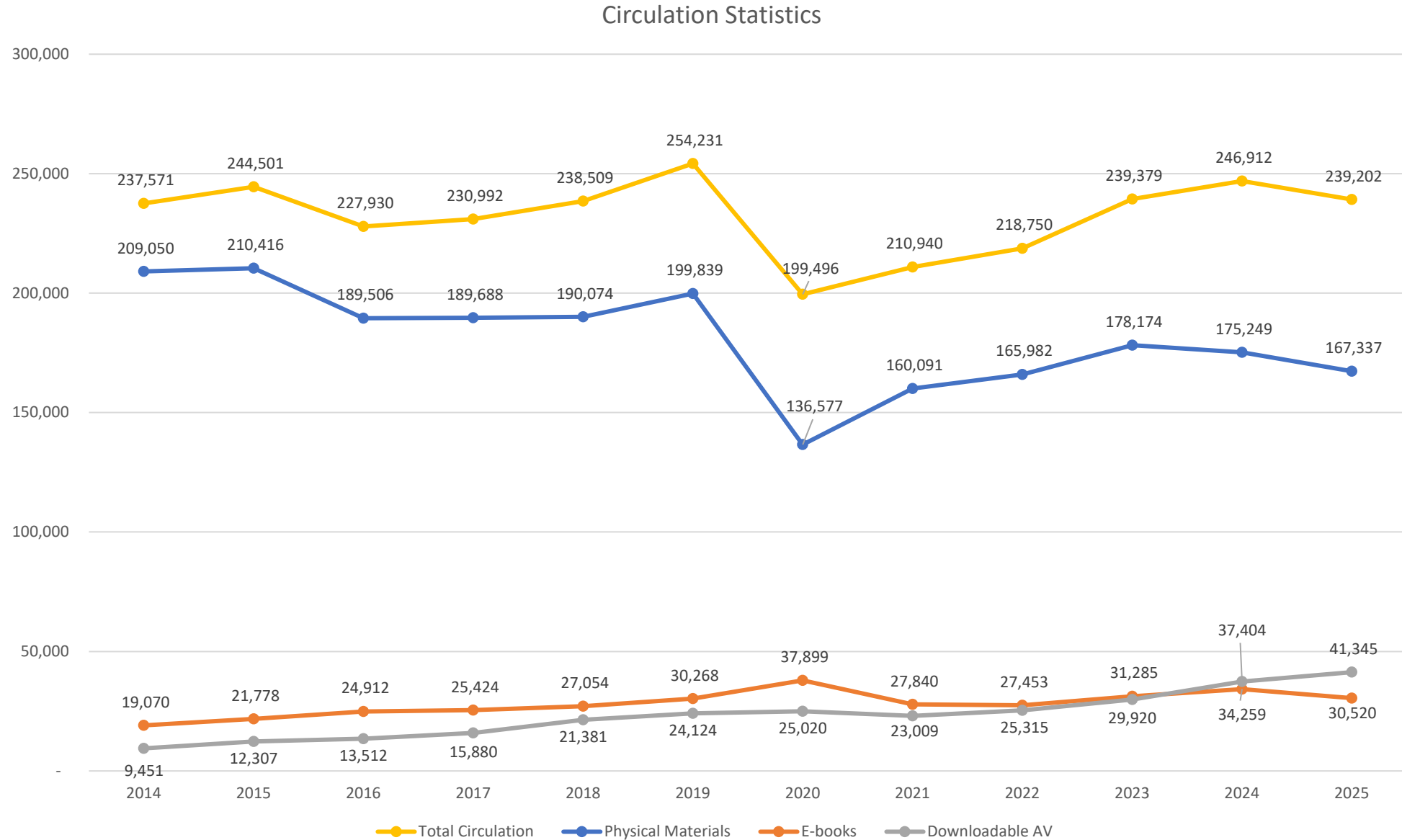

Patron Visits

Number of Patron Visits to Branch Libraries, Planetarium, and Bookmobile

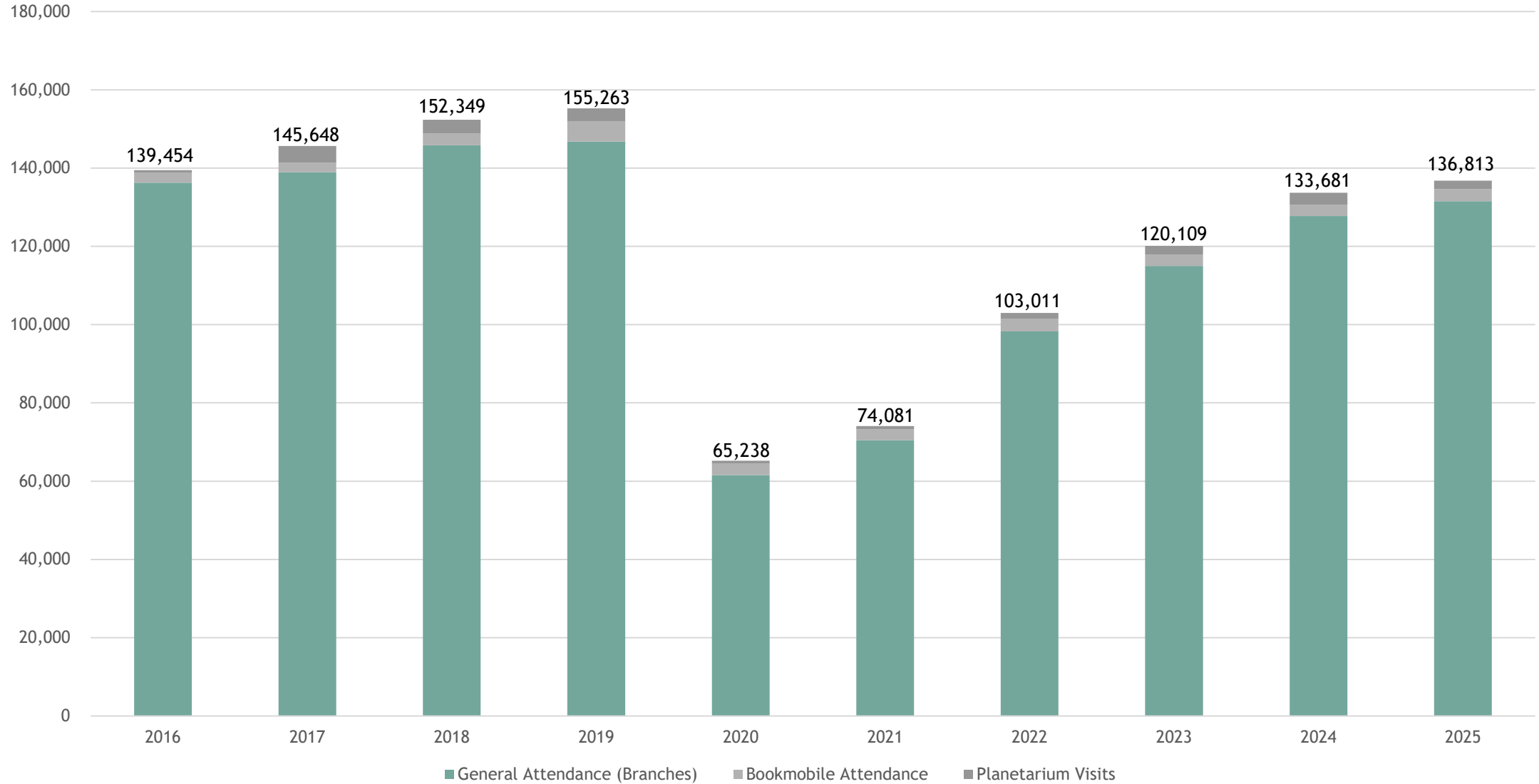

Programming and Outreach

- ▶ 1,393 Onsite Programs with 19,813 attendees (4% increase in attendance)
- ▶ 235 Outreach Programs with 16,397 patrons reached in partnership with schools and daycares, Senior Centers, the Farmer's Market, Community Centers, & at Local Community Events

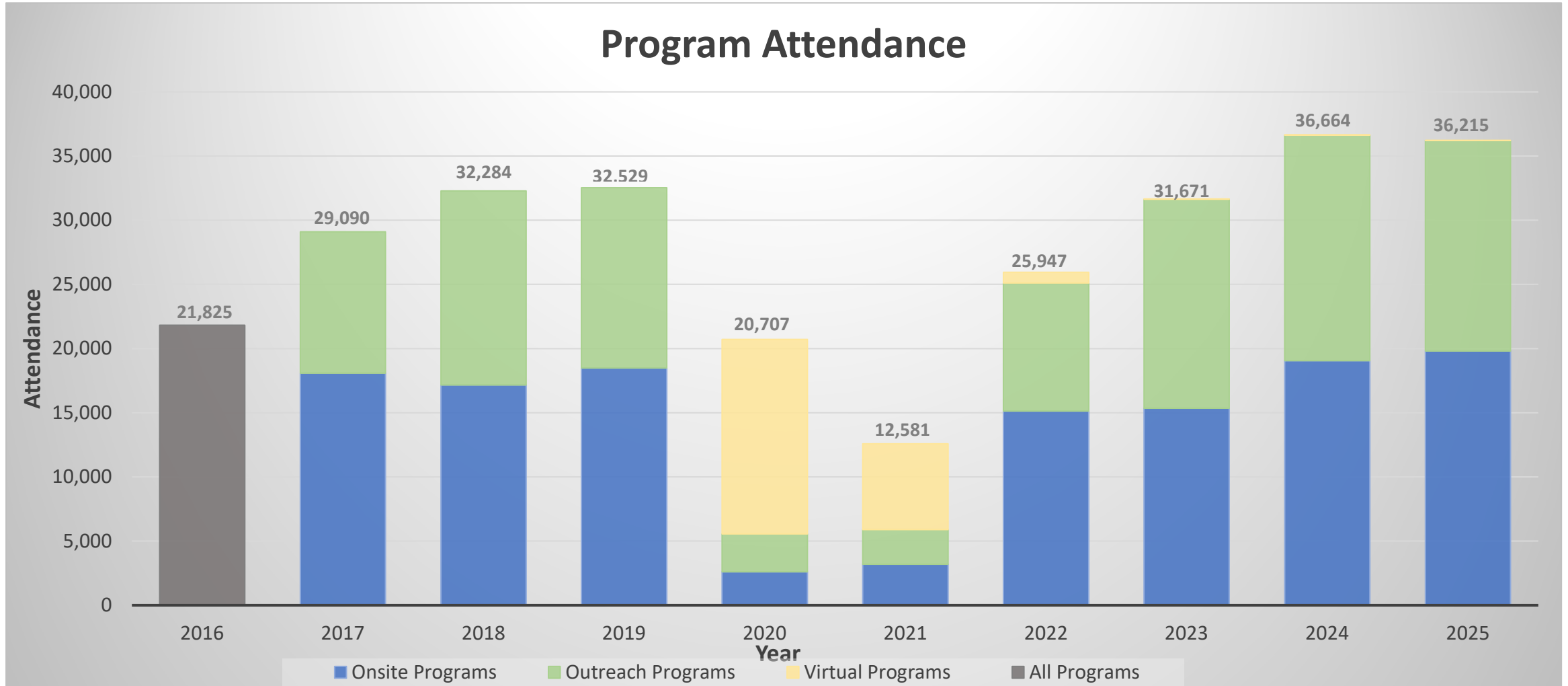

Makerspace Opened in June 2025

a place for community members to explore, learn, create, and connect with specialized tools in a relaxed environment.

- ▶ Located at the West Regional Library
- ▶ Designed for adults and teens age 15 and older
- ▶ Tools available include
 - ▶ 3-D Pens and Printers
 - ▶ Laser Engraver
 - ▶ Cricut
 - ▶ Sublimation Printer
 - ▶ Heat Presses for applying sublimation prints and vinyl
 - ▶ Sewing Machine
 - ▶ Serger
 - ▶ Button Makers
 - ▶ Book Binders
 - ▶ Sticker Maker
 - ▶ Vinyl Cutter
- ▶ Visit www.myscpl.org/makerspace for open hours, programs, or to schedule a one-on-one appointment





Coming Soon... Litter Cleanup Kits

- ▶ In partnership with Keep Louisiana Beautiful and the State Library, the Library will soon be circulating litter cleanup kits that can be used by residents and students to help keep our parish clean.
- ▶ Perfect opportunity for students to get service hours for school and for families or groups such as scouts, homeschoolers, or other youth groups to care for their neighborhoods.
- ▶ We anticipate having these ready for checkout the week of April 13th, just in time for Trash Bash and Love the Boot Week
- ▶ Each kit includes a litter grabber, safety vest, trash bags, and instructions on how to conduct a cleanup. 24 kits available



Safety Vest



Litter Grabbers



Trash Bag



A Look Forward - New Hahnville Branch

EXTERIOR



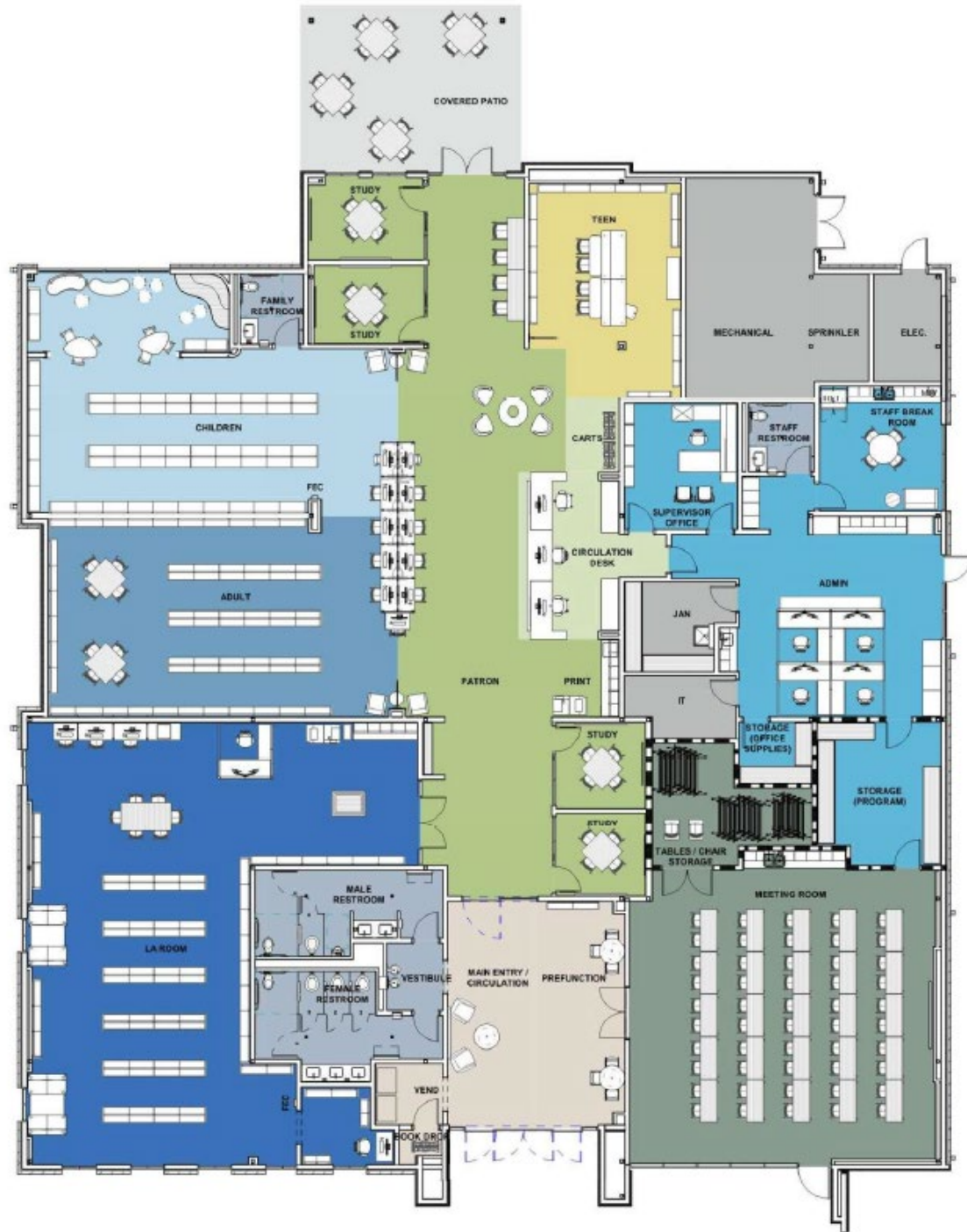

LEGEND

- LOBBY
- PATRON AREA
- CIRCULATION DESK
- CHILDREN
- ADULT
- LOUISIANA ROOM
- ADMIN
- TEEN
- MEETING ROOMS
- RESTROOM
- SUPPORT
- PATIOS

LOBBY



MEETING ROOM



PATRON AREA



LOUISIANA ROOM



ADULT AREA



CHILDREN'S AREA



TEEN AREA



STAFF AREA



STAFF BREAK ROOM



2026 Summer Reading Program

Sign up starting May 15th at www.myscpl.org/summer



Read for 360 minutes to be eligible to win a grand prize, provided by the *Friends of the St. Charles Library!*

Sign up prizes and completion prizes for everyone!

Programs and fun for all ages, all summer long!!

Find Out What's Happening at Your Library



Website - www.myscpl.org



Download our app



<https://www.facebook.com/StCharlesLib/>

<https://www.facebook.com/SCPL.Planetarium/>



Instagram

<https://www.instagram.com/stcharleslib/>



twitter

<https://www.twitter.com/StCharlesLib>



<https://www.tiktok.com/@stcharleslib>

Monthly Newsletter



Thank you to the parish council for your support this past year! We invite you to stop in and visit us at any of our 6 locations or visit our website to access our many digital resources.

Questions?

Leann Benedict, MLIS
Library Director
985-764-9643, x103
leann.benedict@muscpl.org

