

Gulf South Pipeline Company, LP

**St Charles Parish Meeting
November 13, 2017**

Application for Rezoning & Special Permit Use

Case Numbers: PZR-2017-14 & PZSPU 2017-08



Operations in St. Charles Parish

- Safely operating pipelines and facilities in St. Charles for over 50 years
- Customers: Atmos, Shell, Monsanto, Hexion Chemical, Union Carbide, Oxychem, Entergy, Air Products, Praxair & Valero
- New compressor station
 - Generate ~\$800,000 in new annual property tax revenue*
 - No tax relief/incentives requested or received
- New power station
 - \$1.3 billion in net savings for customers.
 - 2,000 direct and indirect jobs a year across the state.

Community Outreach

- Community Information Sessions
 - June 14, 2017
 - Sept, 7 2017
- Door-to-door visits August 25-26, 2017 (12 homeowners)
- Individual meetings with adjacent landowners
- Comprehensive website with project information
- Direct mailings to adjacent landowners
- If our application is approved, we will continue providing updates to the community.

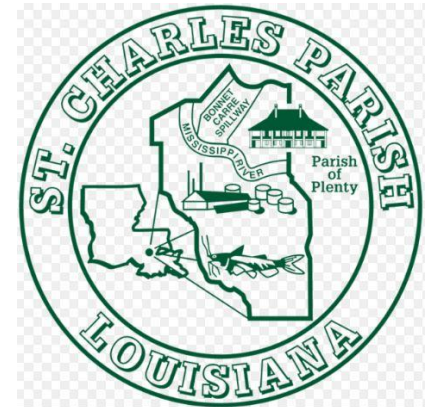

2.7 Acres Site Layout Will Not Change Land Use

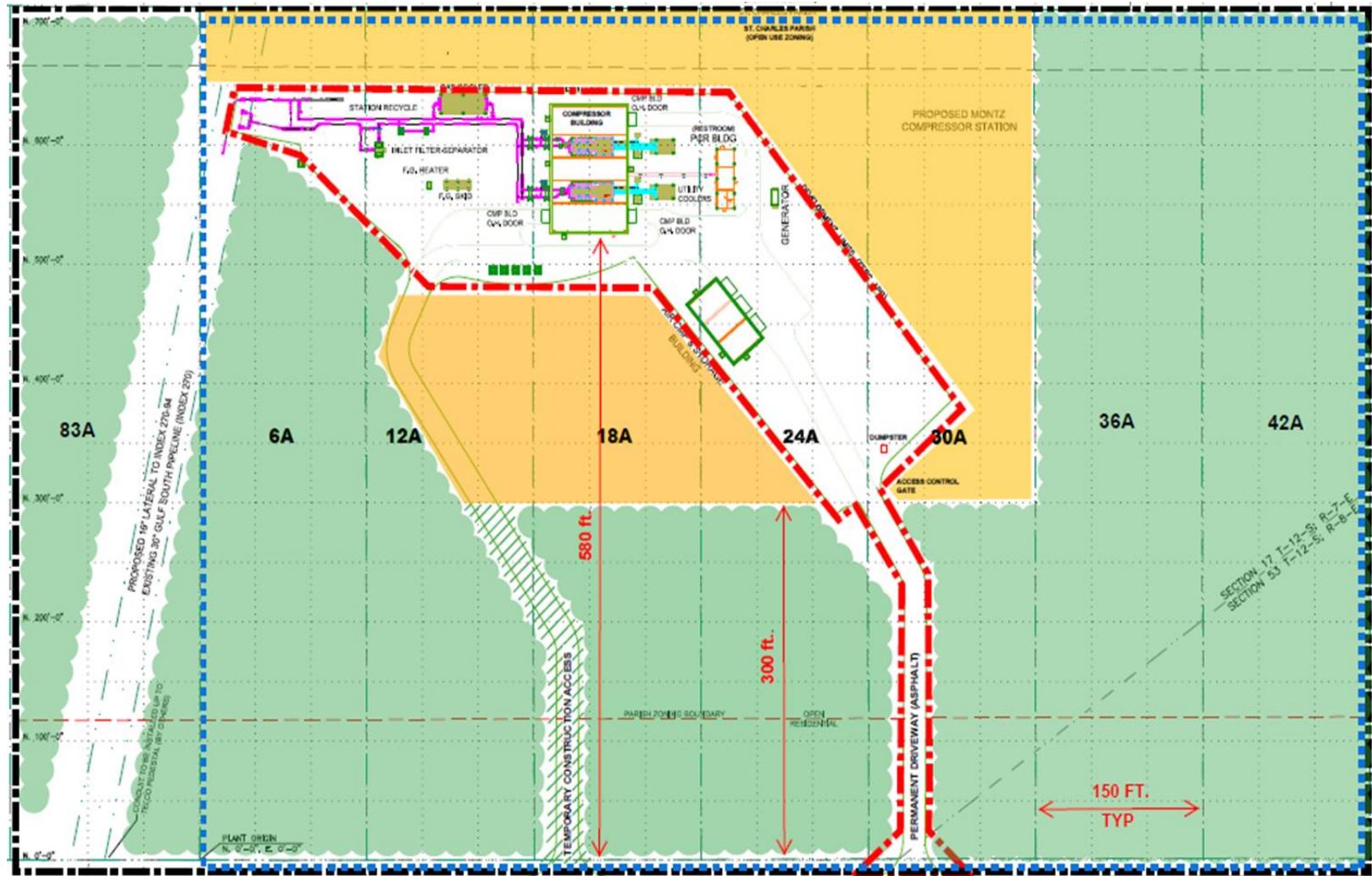

Rezoning & Special Permit Use Features

- Conditions Address All Concerns That Have Been Raised

Original application	
Prohibit new industrial & commercial facilities on remainder of site (Restrictive Covenant)	Post construction noise validation / noise study
Traffic Control Plan & other Access Requirements	Natural vegetation & trees remain and/or replanted around site
Construction hours limited	Drainage restrictions
Evangeline Road conditions	

Revised application
All items included in Special Permit under Original Application plus Gulf South has agreed to include the following:
Additional Noise Insulation
Sound wall – Noise Barrier
Inspect existing pipeline with a “smart pig”

We have Explained Compressor Station Design & Safety

Compressor building, piping and associated facilities

- **Compressor bldg:** 110' long x 70' wide, 42' tall
- **Auxiliary bldg:** 66' long x 35' wide, 24' tall
- **Power control room**



Actual Size of Compressor (18' x 45')



Noise Concerns Have Been Addressed

- ▶ Post construction test will verify sound below 55 Dba at all sites
- ▶ Tree and vegetation buffer further reduces noise
- ▶ Insulation increased
- ▶ Noise Absorbing Wall



Pipeline Inspection Will Verify Continued Good Condition

- ▶ Gulf South will use internal inspection tool (“ILI” or “Smart Pig”) to verify the continued good condition of the pipeline prior to operation of Montz Compressor.
- ▶ ILI tool provides detailed data on the pipe, including any signs of dents or third-party damage.
- ▶ Adjacent landowners have already been notified.

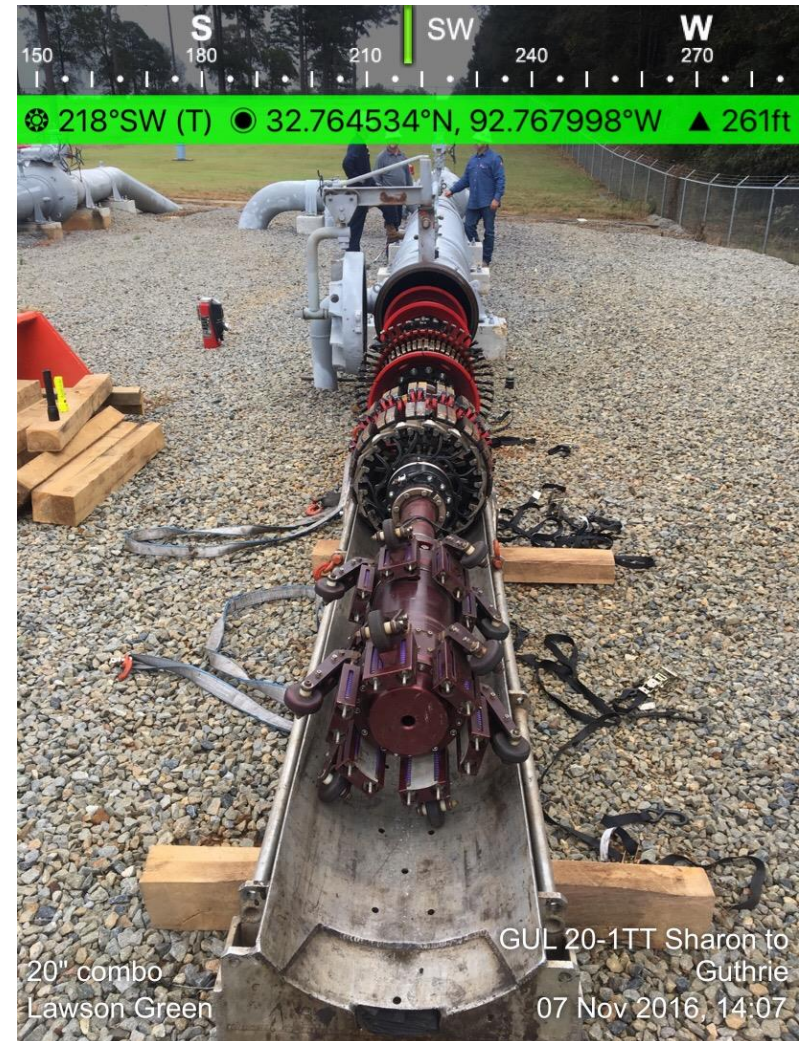

Drainage Improvement Grant

- Drainage has been identified as a significant issue affecting the community and the compressor station site
- Entergy has commissioned a drainage study of the Evangeline Road area
- Gulf South would provide \$2 million grant to the Parish to assist with drainage projects

Tree Canopy and Vegetation Will Remain

