

JOINT PUBLIC NOTICE

August 1, 2000

DEPARTMENT OF THE ARMY
NEW ORLEANS DISTRICT
CORPS OF ENGINEERS
REGULATORY FUNCTIONS
BRANCH
P.O. BOX 60267
NEW ORLEANS, LA 70160
(504) 862-2292

COE REVIEWER:
Brian Breaux

COE NUMBER:
EC-20-000-3421

STATE OF LOUISIANA
DEPARTMENT OF ENVIRONMENTAL QUALITY
OFFICE OF ENVIRONMENTAL SERVICES
P.O. BOX 82135
BATON ROUGE, LA 70884-2135
(225) 765-0664

DEQ REVIEWER:
James Little

WQC NUMBER:
WQC000713-11

STATE OF LOUISIANA
DEPARTMENT OF NATURAL
RESOURCES
COASTAL MANAGEMENT DIVISION
P.O. BOX 44487
BATON ROUGE, LA
70804-4487
(225) 342-8917

CMD REVIEWER:
Jeff Thibodeaux

CUP NUMBER:
P000914

Interested parties are hereby notified that the Coastal Management Division of the Department of Natural Resources has received the following application for a Coastal Use Permit in accordance with the State and Local Coastal Resources Management Act of 1978, as amended, (Louisiana R.S. 49, Sections 214.21-214.41), and the rules and regulations of the Coastal Resources Program.

Additionally, interested parties are hereby notified that an application has been received by the District Engineer for a Department of the Army permit to authorize the following pursuant to: [X]Section 404 of the Clean Water Act (86 Stat. 816; 33 USC 1344), [X]Section 10 of the Rivers and Harbors Act of 1899 (33 USC 403).

Application has also been made to the Louisiana Department of Environmental Quality, Office of Environmental Services for a Water Quality Certification in accordance with statutory authority contained in the Louisiana Revised Statutes of 1950, Title 30, Chapter 11, Part IV, Section 2074 A(3) and Provisions of Section 401 of the Clean Water Act (P.L.D. 95-217).

NAME: Sorrento Pipeline Company, LLC
% Morris P. Hebert, Inc.
P.O. Box 3106
Houma, LA 70361
Attn: Michael Capello

LOCATION: St. John and St. Charles Parish, LA; Sections 43, 44, 29, 20, 19, 18; T11S-R8E; Sections 13, 97, 12, 66, 96, 10, 14, 69, 70, 9, 16, 8, 7; T11S-R7E; Sections 93, 94, 51, 52, 53, 55, 56, 57, 32, 31, 30, 29, 28, 27, 26, 23; T11S-R6E; Lat. 29° 27' 21.87", Long. 91° 05' 49.20"; Lat. 29° 27' 22.50", Long. 91° 05' 51.35".

DESCRIPTION: Proposed installation of approximately 87,870' of two 8" pipelines from the Tri-States valve site west of the Bonnet Carre Spillway to an Enterprise valve site which is located west of the Marathon Refinery in Garyville, LA. The proposed pipelines will parallel the recently constructed Wilprise and Bridgeline pipelines. A 50' x 300' workspace will be required at the Tri-States valve site. Two 50' x 400' workspaces will be required at the Woodlawn Canal crossing. Two 100' x 400' workspaces will be required for the directional drill of the first I-10 crossing. Two 100' x 400' workspaces will be required for the directional drill of the second I-10 crossing. Two 50' x 400' workspaces will be required at the Reserve Relief Canal crossing. The crossing of the Godchaux Canal will require four additional workspaces: a 100' x 400', a 100' x 200', a 25' x 294', and a 25' x 400'. A 100' x 200' workspace will be required on the wetland side of the east/west levee and a 100' x 400' workspace will be required in the upland side of the levee. Three 30' x 30' valve sites will be constructed at the Tri-States valve site, the Godchaux Canal, and the Reserve Relief

Canal. A 50' construction right-of-way will be required in the wetland areas and a 70' construction right-of-way will be required in the upland areas. Approximately 73,500 cu. yds. of native material will be temporarily displaced during pipeline installation. Approximately 900 cu. yds. of water bottom material will be temporarily displaced if the contractor elects to open cut the canal crossings. Approximately 100 cu. yds. of limestone fill will be required for valve sites and approximately 75 cu. yds. of limestone will be required for bank stabilization if the contractor elects to open cut the canal crossings. Approximately 14.92 acres of forested wetlands may be impacted by the proposed project.**

The official date of the beginning of the public comment period for Coastal Use Permits and Water Quality Certification applications begins on the date of publication of the notice in the official state journal (The Advocate), in accordance with the Rules and Procedures for Coastal Use Permits, §723.C.5.c. The Coastal Management Division will inform interested parties of the exact date of publication on request.

**This date represents the beginning date of the Corps of Engineers public notice period. The official date of the beginning of the public comment period for Coastal Use Permit and Water Quality Certification applications begins on the date of publication of the notice in the official state journal (The Advocate), in accordance with the Rules and Procedures for Coastal Use Permits, §723.C.5.c. The Coastal Management Division will inform interested parties of the exact date of publication on request.

***Habitat impacts are based on available in-house data and may not represent actual conditions. Field reconnaissance may be required to verify extent of impacts.

THE APPLICANT MUST SECURE A STATE COASTAL USE PERMIT PLUS A DEPARTMENT OF THE ARMY PERMIT OR A GENERAL PERMIT AUTHORIZATION FROM THE CORPS OF ENGINEERS. INDEPENDENT EVALUATIONS AND DECISIONS WILL BE MADE BY THE COASTAL MANAGEMENT DIVISION AND THE CORPS OF ENGINEERS.

Plans for the proposed work are now on file and may be inspected at the Office of the Coastal Management Division, Department of Natural Resources, State Land and Natural Resources Building, 625 North 4th Street, Room 1011, Baton Rouge, LA 504/342-7591. Written comments, including objections to the proposed work and reasons therefore, and suggestions for modifications thereof, are solicited from anyone having an interest in the matter. Comments to the state of Louisiana must be mailed within 25 days of the date of official journal publication of this notice and must be addressed to the Coastal Management Division at P.O. Box 44487, Baton Rouge, LA 70804-4487. All comment letters should contain both the applicant's name and the application number.

State of Louisiana Coastal Use Permit Criteria

The decision on whether or not to issue a Coastal Use Permit will be based on an evaluation of the probable impacts of the proposed activity in accordance with the state policies outlined in R.S. 49:214.22. The decision will reflect the national concern for both protection and utilization of important resources. The decision must be consistent with the state program and approved local programs for affected parishes and must represent an appropriate balancing of social, environmental and economic factors. All factors which may be relevant to the proposal will be considered; among these are flood and storm hazards, water quality, water supply, feasible alternative sites, drainage patterns, historical sites, economics, public and private benefits, coastal water dependency, impacts on natural features, compatibility with the natural and culture setting and the extent of long term benefits or adverse impacts.

Certification that the proposed activity will not violate applicable water and air quality laws, standards and regulations will be required before a permit is issued.

State of Louisiana Water Quality Certification Criteria

In accordance with the Joint Public Notice Agreement between Coastal Management Division and the Office of Water Resources, notice is hereby given that the applicant has applied to the Louisiana Department of Environmental Quality, Office of Environmental Services for a Water Quality Certification in accordance with statutory authority contained in the Louisiana Revised Statutes of 1950, Title 30, Chapter 11, Part IV, Section 2074 A(3) and provision of Section 401 of the Clean Water Act (P.L. 95-217).

Comments concerning this application can be filed with the Office of Environmental Services within ten days of this notice to the following address: Louisiana Department of Environmental Quality, Office, Office of Environmental Services, P.O. Box 821355, Baton Rouge, Louisiana 70884.

Additional information is on file with the above office, and may be inspected at any time between 8:00 a.m. and 4:30 p.m. weekdays. Copies may be obtained upon payment of cost of printing. A final decision on this application will be made within 60 days after publication of this notice.

Corps of Engineers Federal Permit Criteria

The decision whether to issue a permit will be based on an evaluation of the probable impacts including cumulative impacts of the proposed activity on the public interest. That decision will reflect the national concern for both protection and utilization of important resources. The benefits which reasonably may be expected to accrue from the proposal must be balanced against its reasonably foreseeable detriments. All factors which may be relevant to the proposal will be considered including the cumulative effects thereof; among those are conservation, economics, aesthetics, general environmental concerns, wetlands, historic properties, fish and wildlife values, flood hazards, floodplain values, land use, navigation, shoreline erosion and accretion, recreation, water supply and conservation, water quality, energy needs, safety,

food and fiber production, mineral needs, considerations of property ownership and, in general, the needs and welfare of the people.

The Corps of Engineers is soliciting comments from the public, Federal, state and local agencies and officials; Indian Tribes; and other interested parties in order to consider and evaluate the impacts of this proposed activity. Any comments received will be considered by the Corps of Engineers to determine whether to issue, modify, condition or deny a permit for this proposal. To make this decision, comments are used to assess impacts on endangered species, historic properties, water quality, general environmental effects and the other public interest factors listed above. Comments are used in preparation of an Environmental Assessment and/or an Environmental Impact Statement pursuant to the National Environmental Policy Act. Comments are also used to determine the need for a public hearing and to determine the overall public interest of the proposed activity.

No properties listed in the National Register of Historic Places are near the proposed work. The possibility exists that the proposed work may damage or destroy presently unknown archaeological, scientific, prehistorical, or historical sites or data. Copies of this notice are being sent to the State Archaeologist and the State Historic Preservation Officer.

Our initial finding is that the proposed work would neither affect any species listed as endangered by the U.S. Department of Interior nor affect any habitat designated as critical to the survival and recovery of any endangered species.

The applicant has certified that the proposed activity described in the application complies with and will be conducted in a manner that is consistent with the Louisiana Coastal Resources Program. The Department of the Army permit will not be issued unless the applicant receives approval or waiver of the Coastal Use Permit by the Department of Natural Resources.

If the proposed work involves deposits of dredged or fill material into waters of the United States, the evaluation of the probable impacts will include the application guidelines established by the Administrator of the Environmental Protection Agency. Certification that the proposed activity will not violate applicable water quality standards will be required from the Department of Environmental Quality, Office of Water Resources before a permit is issued.

You are requested to communicate the information contained in this letter to any other parties whom you deem likely to have interest in this matter.

Public Hearings

Any person may request, in writing, within the comment period specified in this notice, that a State or Federal public hearing be held to consider this application. Request for public hearings shall state, with particularity, the reasons for holding a public hearing.

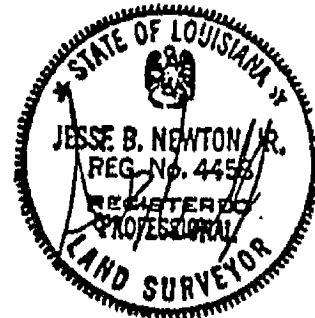
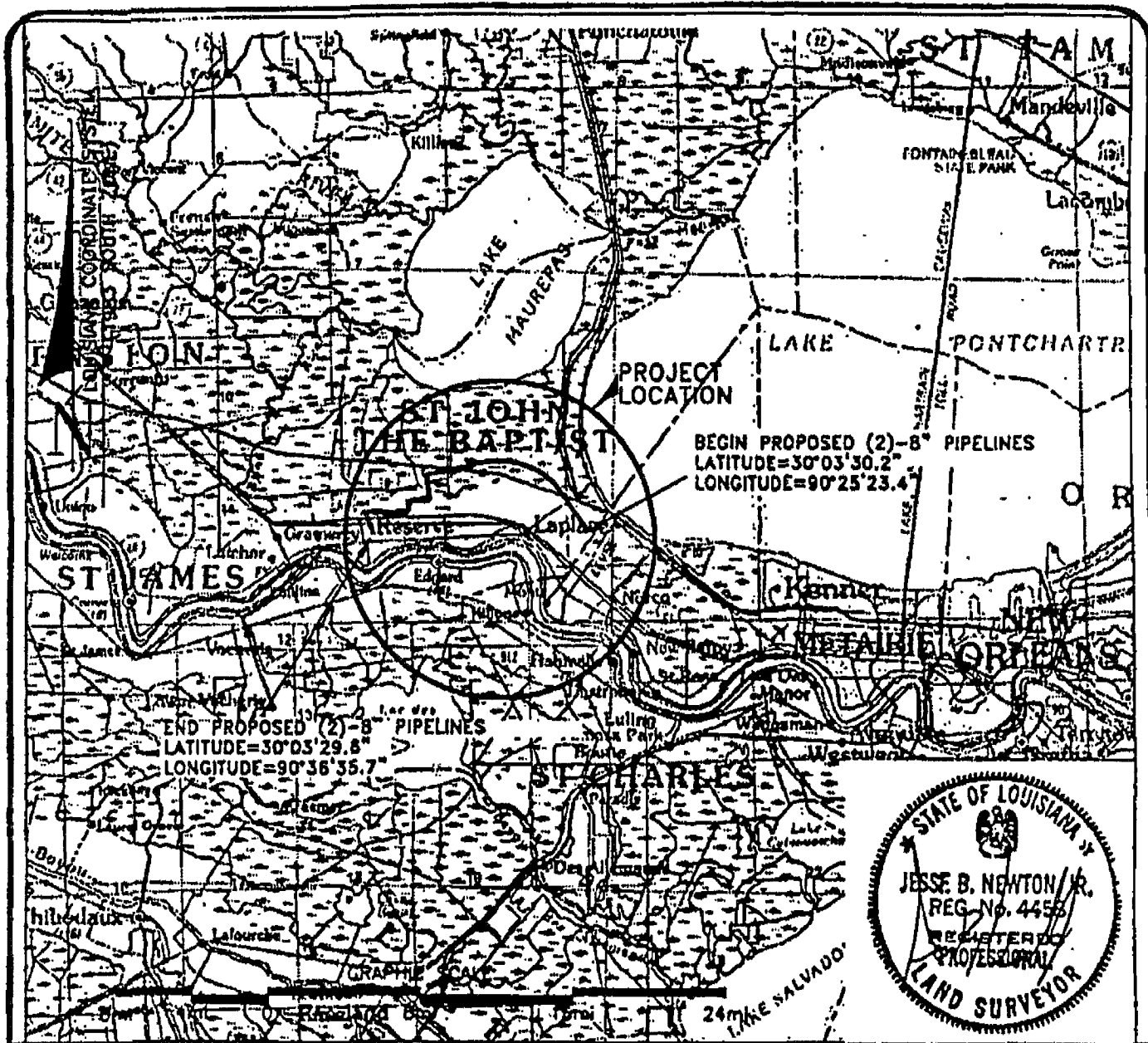

2	6-23-00	REMOVED 10" PIPELINE, REVISED ROUTE & ADDED R/W DETAIL
NO.	DATE	REVISION

SORRENTO PIPELINE COMPANY, LLC

PROPOSED (2)-8" PIPELINES FROM TRI-STATES VALVE
TO GARYVILLE LOCATED IN SECTIONS, 43 & 44, T11S-R8E, ST. CHARLES PARISH
AND SECTIONS, 44, 29, 20, 19, 18, T11S-R8E & 13, 97, 12, 66, 96, 10, 14,
69, 70, 9, 16, 8, 7, T11S-R7E & SECTIONS, 93, 94, 51, 52, 53, 55, 56, 57, 32
31, 30, 29, 28, 27, 26 & 23, T11S-R6E, ST. JOHN THE BAPTIST PARISH, LOUISIANA



Morris P. Hebert, Inc.
PROFESSIONAL LAND & HYDROGRAPHIC SURVEYORS
P.O. BOX 3106 • MOINA, LOUISIANA 70381-3106 • (504) 879-2731

DRAWN BY: GWN	SHEET: 1
CHECKED BY: JMH	SCALE: SHOWN
APPROVED BY: DEC	DATE: 4-5-00
MPH CAD FILE: 6014COE0022AO	

35

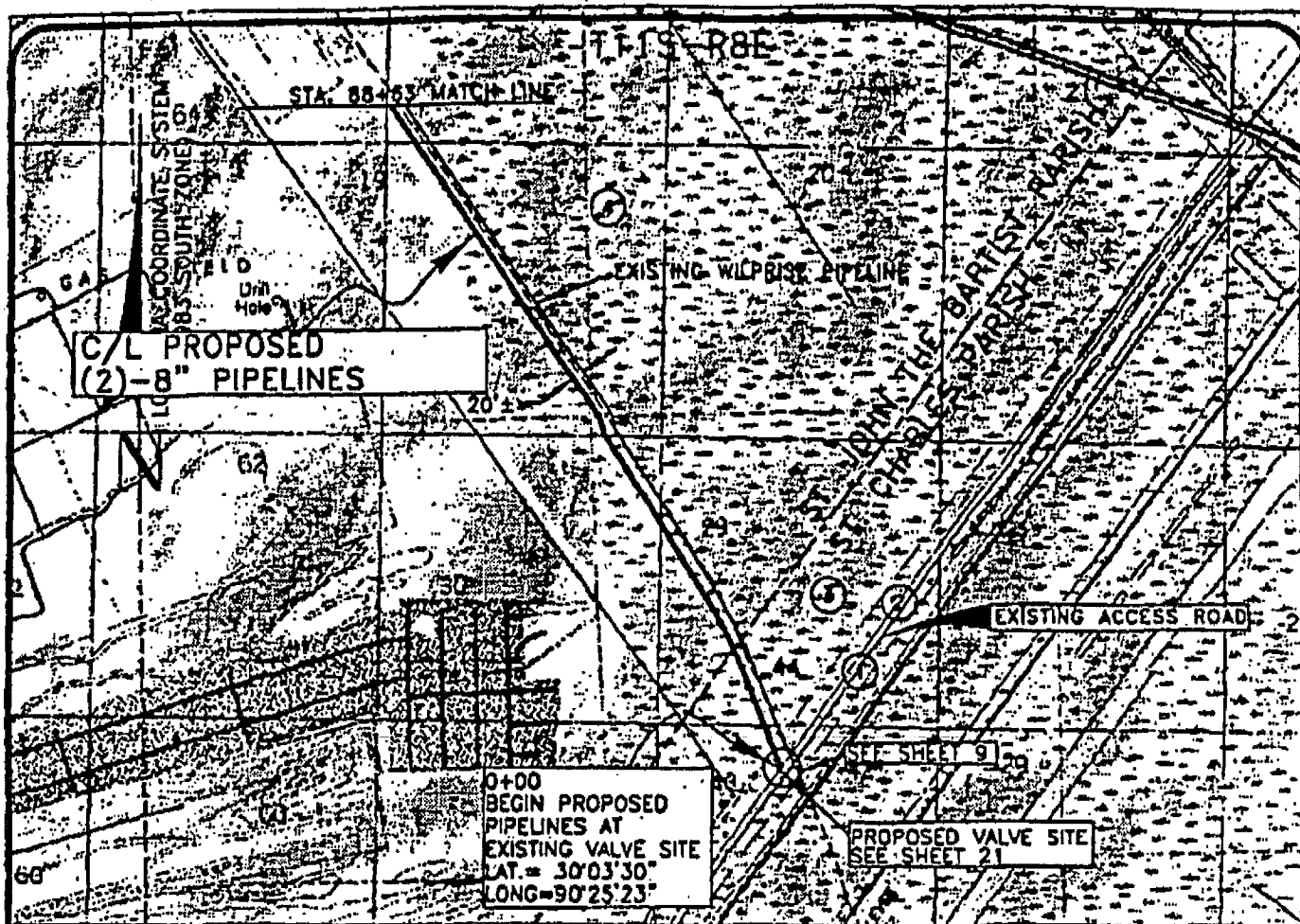

PLAN

GRAPHIC SCALE

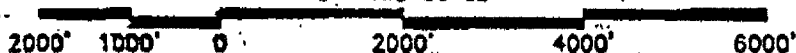

AFFECTED LAND OWNERS:

- | | |
|-------------------------------|----------------------------|
| ① ENTERGY, LA., INC. | ③ THELMA L. BOUGERE, et al |
| ② CRISTINA & LAURICELLA, INC. | ④ ROGERS LAND CO., INC. |

2	6-22-00	REMOVED 10" PIPELINE, REVISED ROUTE & ADDED R/W DETAIL
NO.	DATE	REVISION

SORRENTO PIPELINE COMPANY, LLC

PROPOSED (2)-8" PIPELINES FROM TRI-STATES VALVE
TO GARYVILLE LOCATED IN SECTIONS, 43 & 44, T11S-R8E, ST. CHARLES PARISH
AND SECTIONS, 44, 29, 20, 19, 18, T11S-R8E & 13, 97, 12, 66, 96, 10, 14,
69, 70, 9, 16, 8, 7, T11S-R7E & SECTIONS, 93, 94, 51, 52, 53, 55, 56, 57, 32
31, 30, 29, 28, 27, 26 & 23, T11S-R6E, ST. JOHN THE BAPTIST PARISH, LOUISIANA



Morris P. Hebert, Inc.
PROFESSIONAL LAND & HYDROGRAPHIC SURVEYORS
P.O. BOX 3108 • HOUMA, LOUISIANA 70361-3108 • (504) 878-2731

DRAWN BY: GWN	SHEET: 2
CHECKED BY: JMH	SCALE: SHOWN
APPROVED BY: DEC	DATE: 4-2000
MPH CAD FILE: 6014COE002JAD	

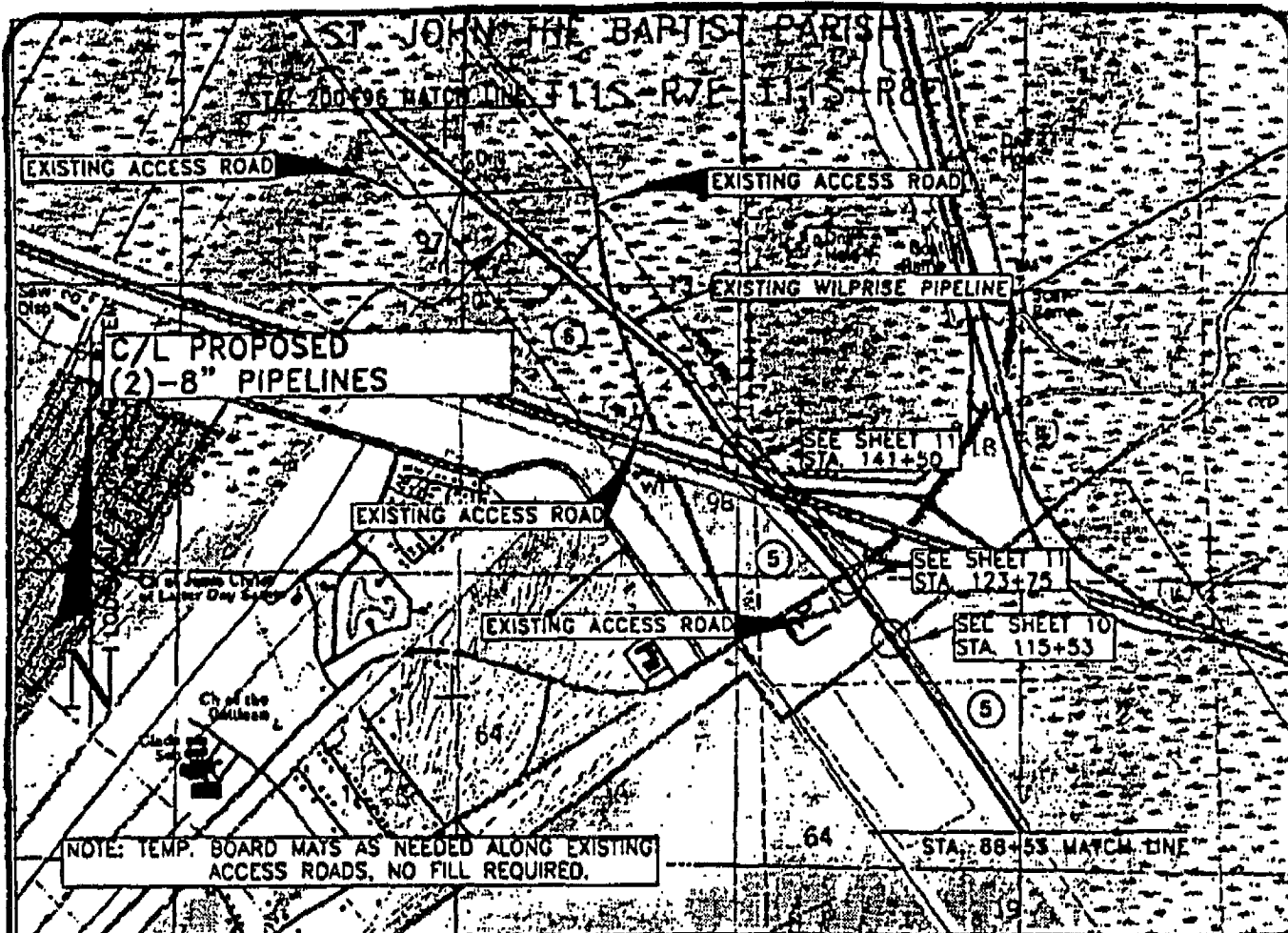

PLAN
GRAPHIC SCALE

2000' 1000' 0 2000' 4000' 6000'

AFFECTED LAND OWNERS:

- ⑤ EDMUND McILHENNY, JR. et al
- ⑥ GORDON L. GUIDRY, et ux

2	6-23-00	REMOVED 10" PIPELINE, REVISED ROUTE & ADDED R/W DETAIL
NO.	DATE	REVISION

SORRENTO PIPELINE COMPANY, LLC

**PROPOSED (2)-8" PIPELINES FROM TRI-STATES VALVE
TO GARYVILLE LOCATED IN SECTIONS, 43 & 44, T11S-R8E, ST. CHARLES PARISH
AND SECTIONS, 44, 29, 20, 19, 18, T11S-R8E & 13, 97, 12, 66, 96, 10, 14,
69, 70, 9, 16, 8, 7, T11S-R7E & SECTIONS, 93, 94, 51, 52, 53, 55, 56, 57, 32
31, 30, 29, 28, 27, 26 & 23, T11S-R6E, ST. JOHN THE BAPTIST PARISH, LOUISIANA**

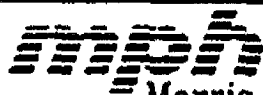

Morris P. Hebert, Inc.
PROFESSIONAL LAND & HYDROGRAPHIC SURVEYORS
P.O. BOX 3106 • NOUA, LOUISIANA 70361-3106 • (504) 878-2731

DRAWN BY: GWN	SHEET: 3
CHECKED BY: JMH	SCALE: SHOWN
APPROVED BY: DEC	DATE: 4-2000
MPH CAD FILE: 6014COED024AO	

(37)

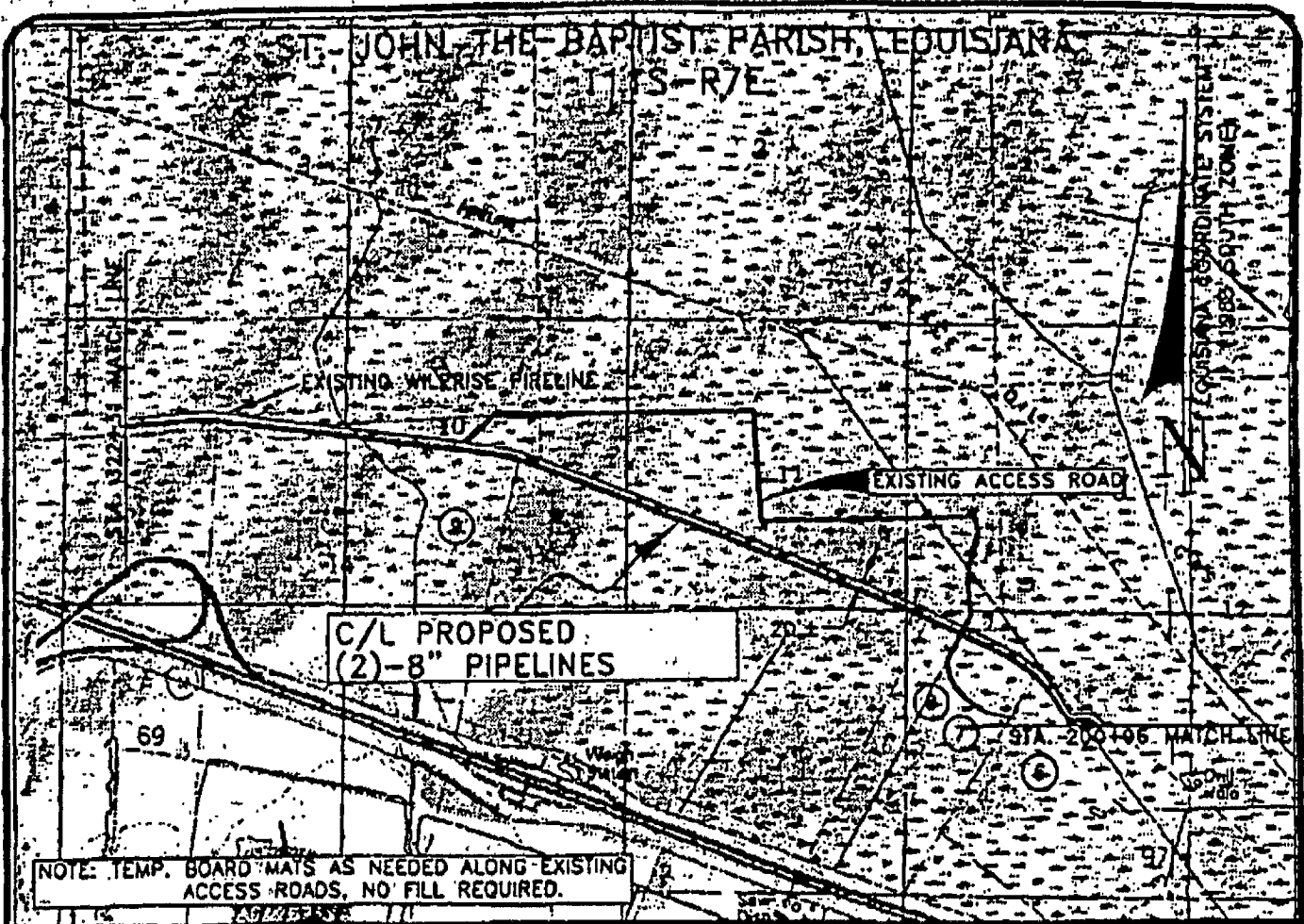

NOTE: TEMP. BOARD MATS AS NEEDED ALONG EXISTING ACCESS ROADS, NO FILL REQUIRED.

PLAN

GRAPHIC SCALE

2000' 1000' 0 2000' 4000' 6000'

AFFECTED LAND OWNERS:

- | | |
|---------------------------|--------------------------------|
| ⑥ GORDON L. GUIDRY, et ux | ⑧ NORMA G. DOYLE, et al. |
| ⑦ DOWIE GENORON, et al | ⑨ BELLE TERRE HOLDINGS, L.L.C. |

2	6-23-00	REMOVED 10" PIPELINE, REVISED ROUTE & ADDED R/W DETAIL
NO.	DATE	REVISION

SORRENTO PIPELINE COMPANY, LLC

PROPOSED (2)-8" PIPELINES FROM TRI-STATES VALVE
TO GARYVILLE LOCATED IN SECTIONS, 43 & 44, T11S-R8E, ST. CHARLES PARISH
AND SECTIONS, 44, 29, 20, 19, 18, T11S-R8E & 13, 97, 12, 66, 96, 10, 14,
69, 70, 9, 16, 8, 7, T11S-R7E & SECTIONS, 93, 94, 51, 52, 53, 55, 56, 57, 32
31, 30, 29, 28, 27, 26 & 23, T11S-R6E, ST. JOHN THE BAPTIST PARISH, LOUISIANA



Morris P. Hebert, Inc.
PROFESSIONAL LAND & HYDROGRAPHIC SURVEYORS
P.O. BOX 3108 • MOUNA, LOUISIANA 70361-3108 • (504) 878-2731

DRAWN BY: GWN	SHEET: 4
CHECKED BY: JMH	SCALE: SHOWN
APPROVED BY: DEC	DATE: 4-2000
MPH CAD FILE: 6014CDE0025AD	

29

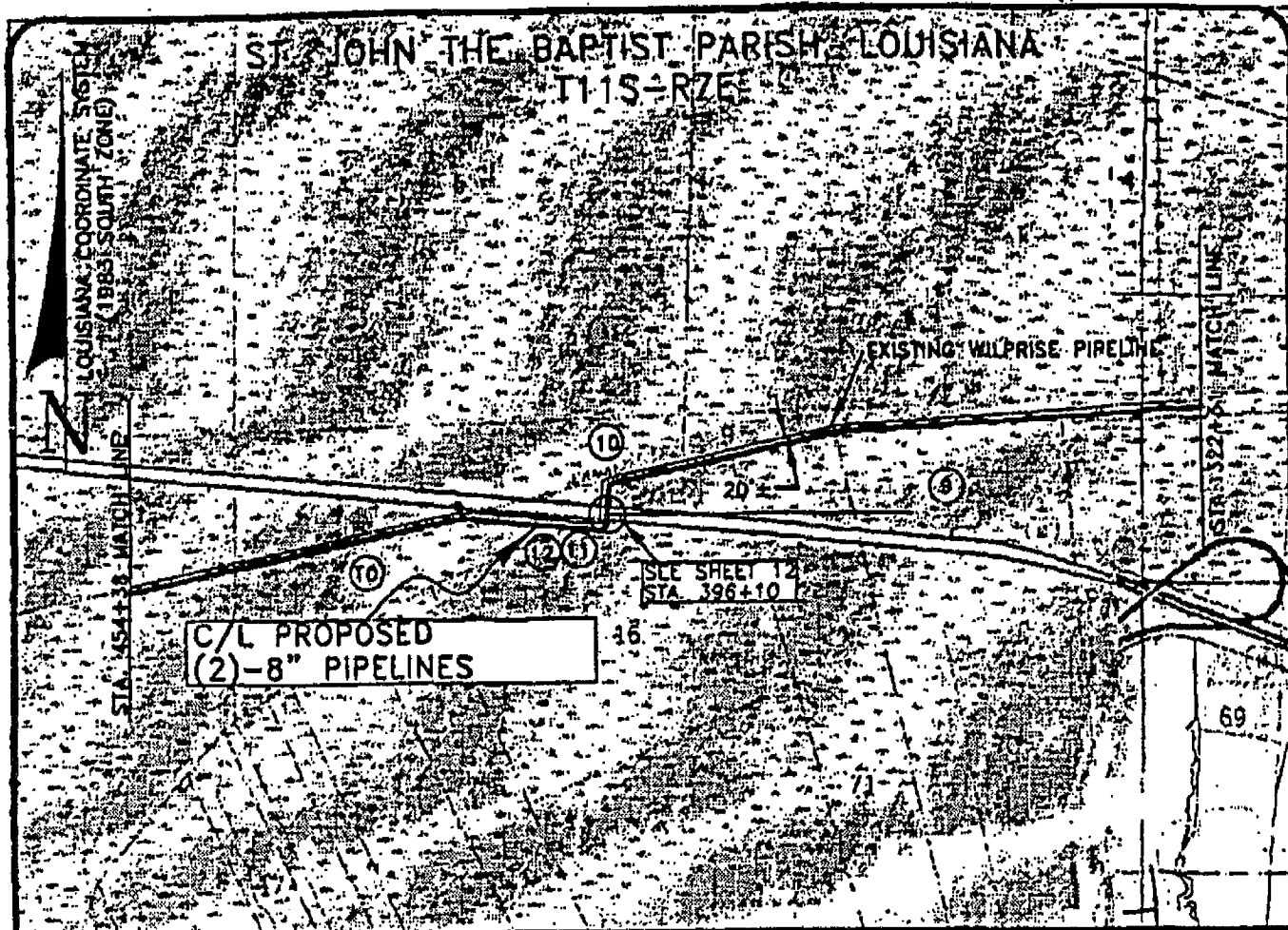

PLAN

GRAPHIC SCALE

2000' 1000' 0 2000' 4000' 6000'

AFFECTED LAND OWNERS:

- ⑨ BELLE TERRE HOLDINGS, L.L.C. ⑩ NATURE LAND COMPANY, L.L.C. ⑪ E. RALPH LUPIN, et ux
⑫ FRANK MANUEL CHALAIRE

2	6-23-00	REMOVED 10" PIPELINE, REVISED ROUTE & ADDED R/W DETAIL
NO.	DATE	REVISION

SORRENTO PIPELINE COMPANY, LLC

PROPOSED (2)-8" PIPELINES FROM TRI-STATES VALVE
TO GARYVILLE LOCATED IN SECTIONS, 43 & 44, T11S-R8E, ST. CHARLES PARISH
AND SECTIONS, 44, 29, 20, 19, 18, T11S-R8E & 13, 97, 12, 66, 96, 10, 14,
69, 70, 9, 16, 8, 7, T11S-R7E & SECTIONS, 93, 94, 51, 52, 53, 55, 56, 57, 32
31, 30, 29, 28, 27, 26 & 23, T11S-R6E, ST. JOHN THE BAPTIST PARISH, LOUISIANA

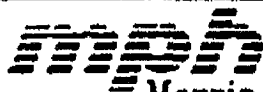

Morris P. Hebert, Inc.
PROFESSIONAL LAND & HYDROGRAPHIC SURVEYORS
P.O. BOX 3108 • MOUMA, LOUISIANA 70361-3108 • (504) 878-2731

DRAWN BY: GWN	SHEET: 5
CHECKED BY: JMH	SCALE: SHOWN
APPROVED BY: DEC	DATE: 4-2000
MPH CAD FILE: 6014COE0026AD	

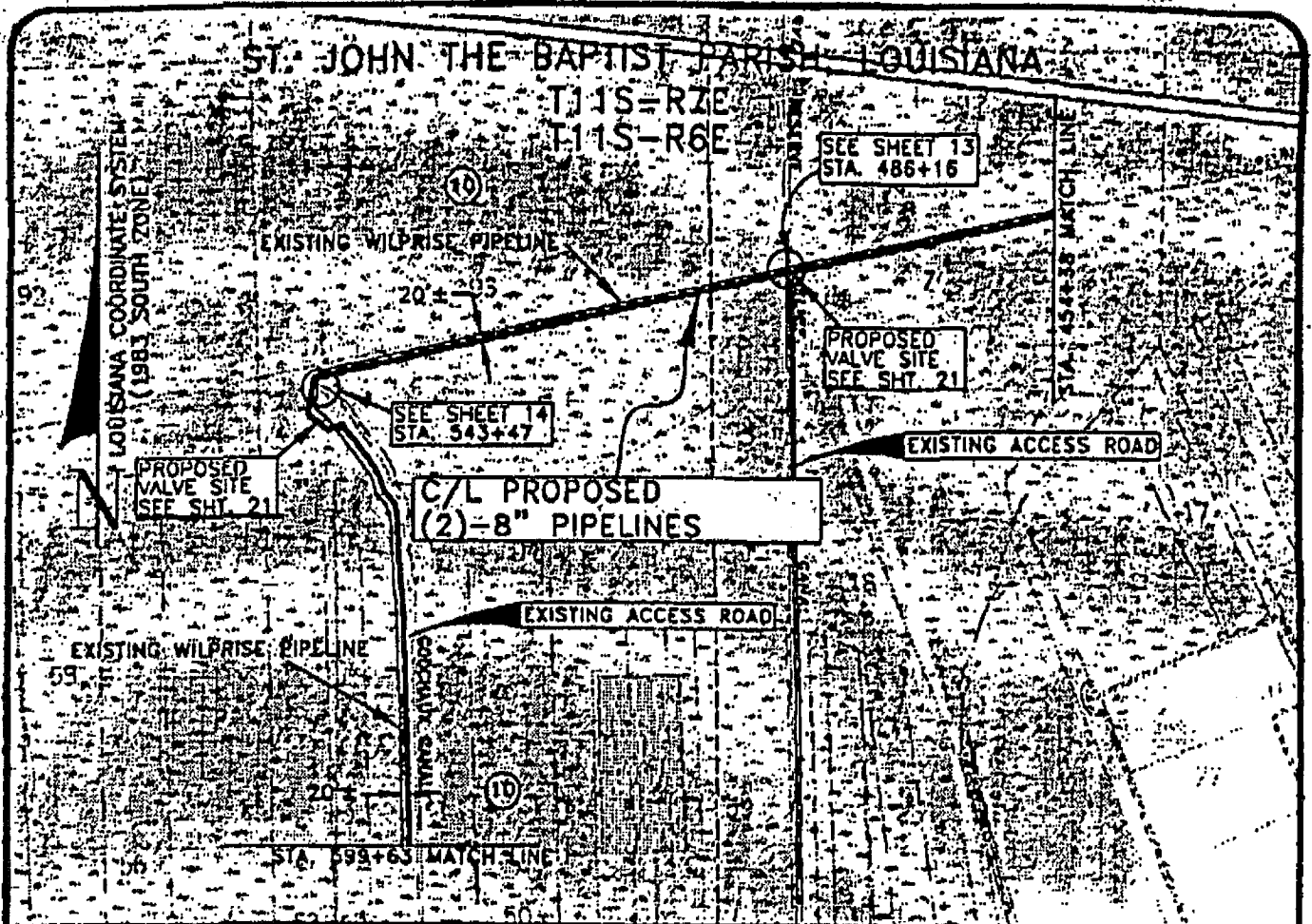

PLAN
GRAPHIC SCALE

2000' 1000' 0 2000' 4000' 6000'

AFFECTED LAND OWNERS:

(10) NATURE LAND COMPANY, L.L.C.

2	6-23-00	REMOVED 10" PIPELINE, REVISED ROUTE & ADDED R/W DETAIL
NO.	DATE	REVISION

SORRENTO PIPELINE COMPANY, LLC

PROPOSED (2)-8" PIPELINES FROM TRI-STATES VALVE
TO GARYVILLE LOCATED IN SECTIONS, 43 & 44, T11S-R8E, ST. CHARLES PARISH.
AND SECTIONS, 44, 29, 20, 19, 18, T11S-R8E & 13, 97, 12, 66, 96, 10, 14,
69, 70, 9, 16, 8, 7, T11S-R7E & SECTIONS, 93, 94, 51, 52, 53, 55, 56, 57, 32
31, 30, 29, 28, 27, 26 & 23, T11S-R6E, ST. JOHN THE BAPTIST PARISH, LOUISIANA

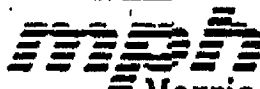

Morris P. Hebert, Inc.

PROFESSIONAL LAND & HYDROGRAPHIC SURVEYORS

P.O. BOX 2104 • LEBLANC, LOUISIANA 70361-3104 • (504) 878-2711

DRAWN BY: CWN

SHEET: 6

CHECKED BY: JMH

SCALE: SHOWN

APPROVED BY: DEC

DATE: 4-2000

MPH CAD FILE: 6014COE0027A0

(10)

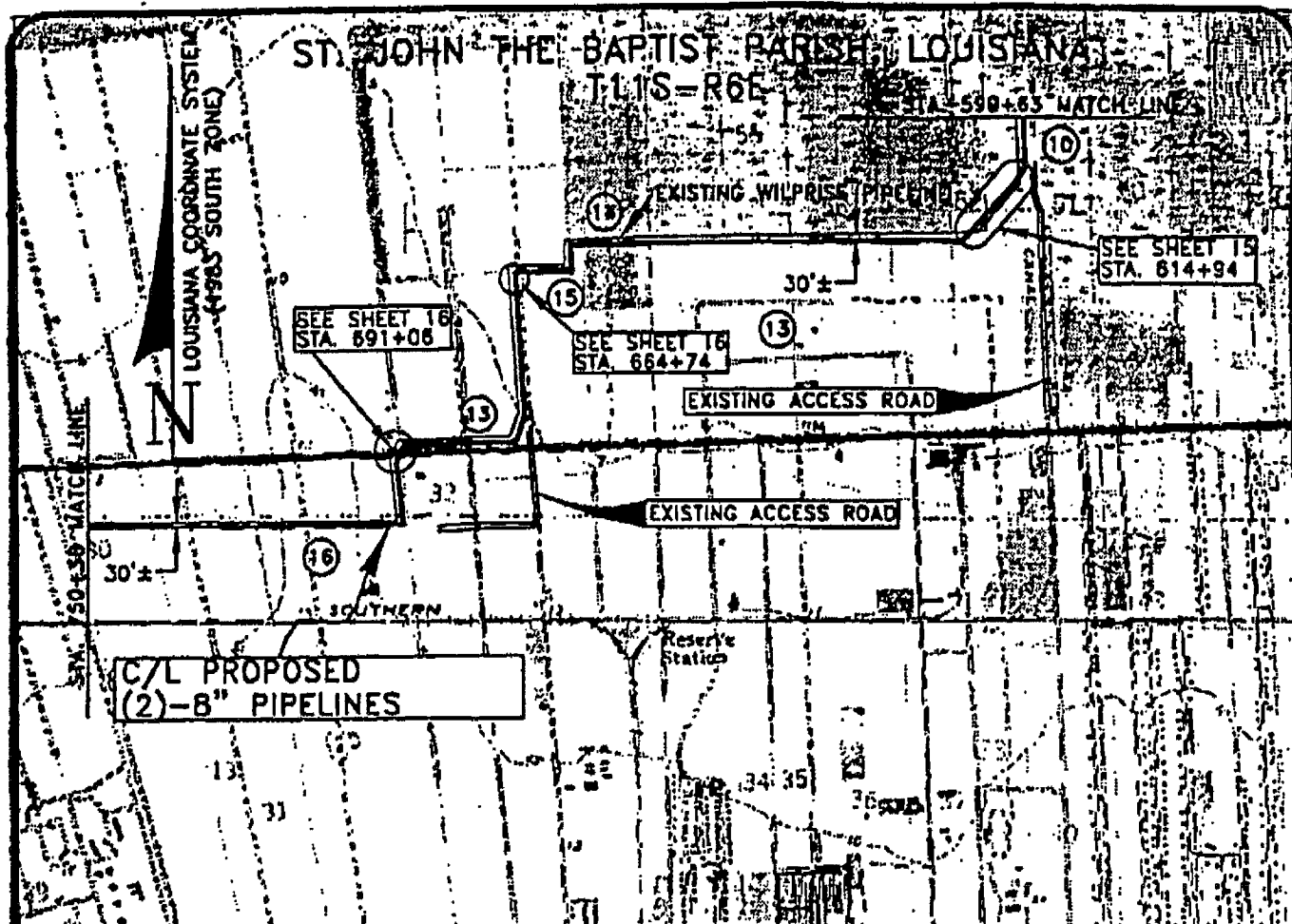

PLAN

GRAPHIC SCALE

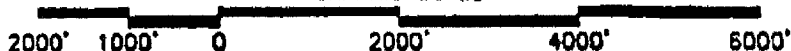

AFFECTED LAND OWNERS:

- (10) NATURE LAND COMPANY
- (14) DUTCH DEVELOPMENT CO., INC.
- (13) ST. JOHN THE BAPTIST PARISH
- (15) WILPRISE PIPELINE CO., L.L.C.
- (16) CARGILL, INCORPORATED

2	6-23-00	REMOVED 10" PIPELINE, REVISED ROUTE & ADDED R/W DETAIL
NO.	DATE	REVISION

SORRENTO PIPELINE COMPANY, LLC

PROPOSED (2)-8" PIPELINES FROM TRI-STATES VALVE
TO GARYVILLE LOCATED IN SECTIONS, 43 & 44, T11S-R8E, ST. CHARLES PARISH
AND SECTIONS, 44, 29, 20, 19, 18, T11S-R8E & 13, 97, 12, 66, 96, 10, 14,
69, 70, 9, 16, 8, 7, T11S-R7E & SECTIONS, 93, 94, 51, 52, 53, 55, 56, 57, 32
31, 30, 29, 28, 27, 26 & 23, T11S-R6E, ST. JOHN THE BAPTIST PARISH, LOUISIANA



Morris P. Hebert, Inc.
PROFESSIONAL LAND & HYDROGRAPHIC SURVEYORS
P.O. BOX 3106 • HOUMA, LOUISIANA 70381-3106 • (504) 879-2731

DRAWN BY: GWN	SHEET: 7
CHECKED BY: JMH	SCALE: SHOWN
APPROVED BY: DEC	DATE: 4-2000
MPH CAD FILE: 6014COE002BA0	

46

ST. JOHN THE BAPTIST PARISH, LOUISIANA SECTIONS 43 & 44, T11S-R8E

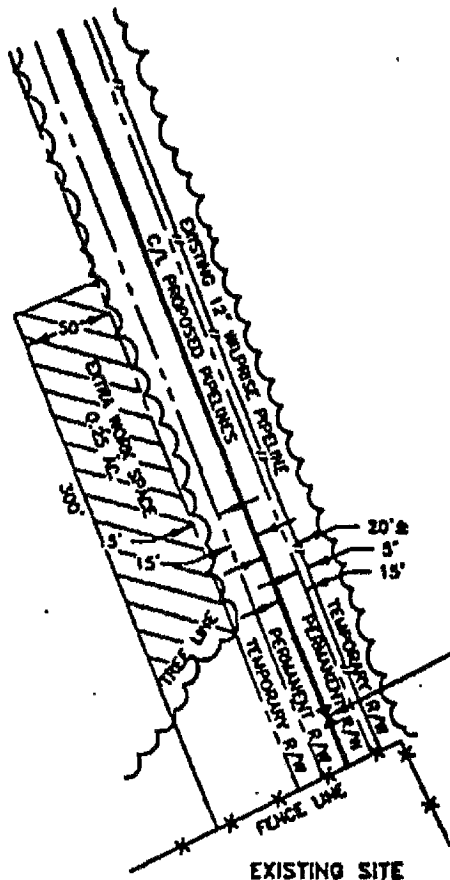

PROPOSED VALVE SITE
SEE SHEET 21

EXTRA WORK SPACE
TEMP. IMPACTED WOODS = 0.25 ACRES

PLAN

HORIZONTAL SCALE
0 50' 100'

2	6-23-00	REMOVED 10" PIPELINE, REVISED ROUTE & ADDED R/W DETAIL
NO.	DATE	REVISION

SORRENTO PIPELINE COMPANY, LLC

PROPOSED (2)-8" PIPELINES FROM TRI-STATES VALVE
TO GARYVILLE LOCATED IN SECTIONS, 43 & 44, T11S-R8E, ST. CHARLES PARISH
AND SECTIONS, 44, 29, 20, 19, 18, T11S-R8E & 13, 97, 12, 66, 96, 10, 14,
69, 70, 9, 16, 8, 7, T11S-R7E & SECTIONS, 93, 94, 51, 52, 53, 55, 56, 57, 32
31, 30, 29, 28, 27, 26 & 25, T11S-R6E, ST. JOHN THE BAPTIST PARISH, LOUISIANA



Morris P. Hebert, Inc.
PROFESSIONAL LAND & HYDROGRAPHIC SURVEYORS
P.O. BOX 3106 • HOLMA, LOUISIANA 70361-3106 • (504) 678-2731

DRAWN BY: GWN	SHEET: 9
CHECKED BY: JMH	SCALE: SHOWN
APPROVED BY: DEC	DATE: 4-2000
MPH CAD FILE: 6014COE0049AD	

43

ST. JOHN THE BAPTIST PARISH, LOUISIANA SECTION 18, T11S-R8E

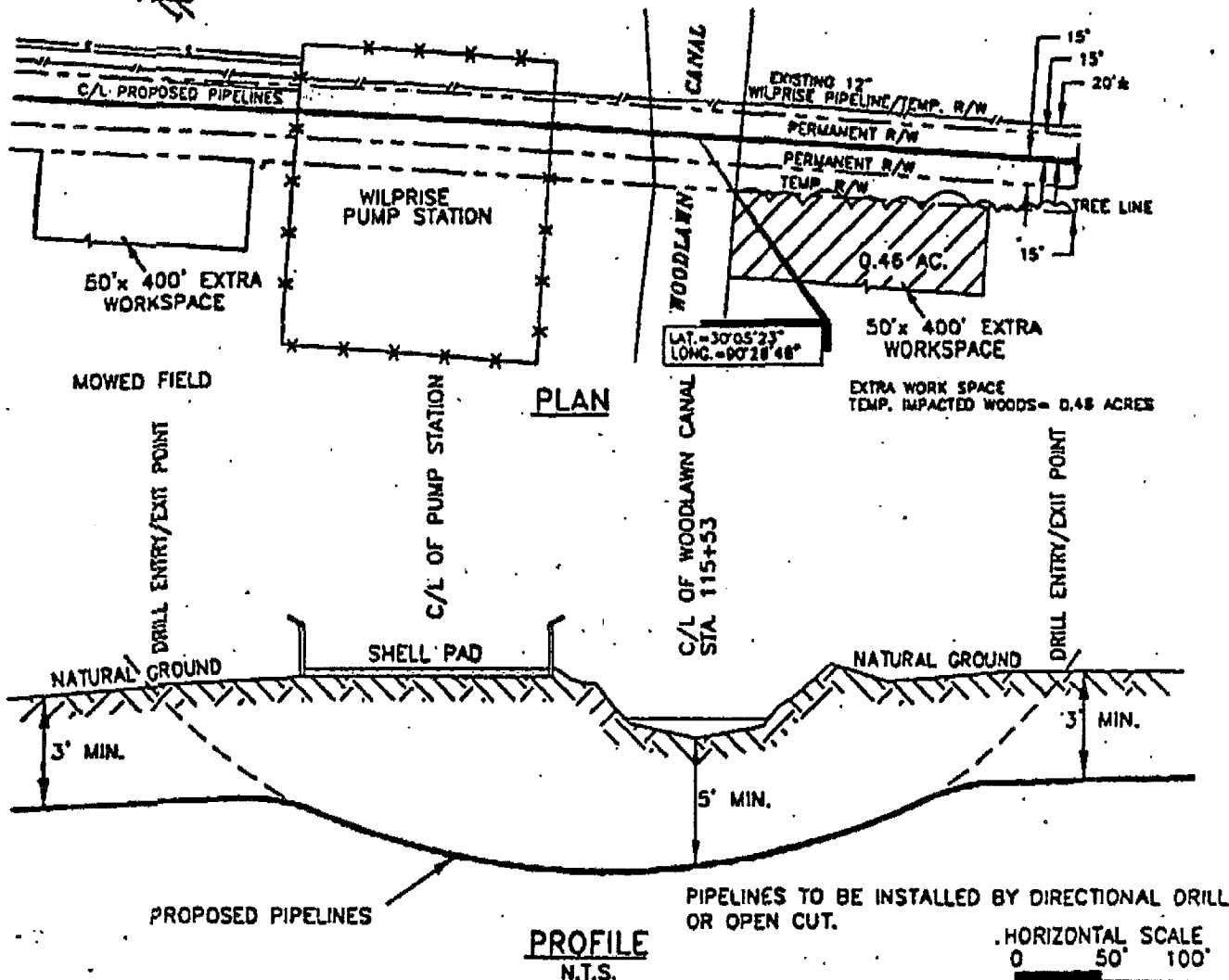

2	6-23-00	REMOVED 10" PIPELINE, REVISED ROUTE & ADDED R/W DETAIL
NO.	DATE	REVISION

SORRENTO PIPELINE COMPANY, LLC

PROPOSED (2) 8" PIPELINES FROM TRI-STATES VALVE
TO GARYVILLE LOCATED IN SECTIONS, 43 & 44, T11S-R8E, ST. CHARLES PARISH
AND SECTIONS, 44, 29, 20, 19, 18, T11S-R8E & 13, 97, 12, 66, 96, 10, 14,
69, 70, 9, 16, 8, 7, T11S-R7E & SECTIONS, 93, 94, 51, 52, 53, 55, 56, 57, 32
31, 30, 29, 28, 27, 26 & 23, T11S-R6E, ST. JOHN THE BAPTIST PARISH, LOUISIANA

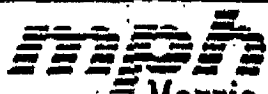

Morris P. Hebert, Inc.
PROFESSIONAL LAND & HYDROGRAPHIC SURVEYORS
P.O. BOX 3108 • HOUMA, LOUISIANA 70361-3108 • (504) 878-2731

DRAWN BY: GWN	SHEET: 10
CHECKED BY: JMH	SCALE: SHOWN
APPROVED BY: DEC	DATE: 4-2000
MPH CAD FILE: 6014COE0043A0	

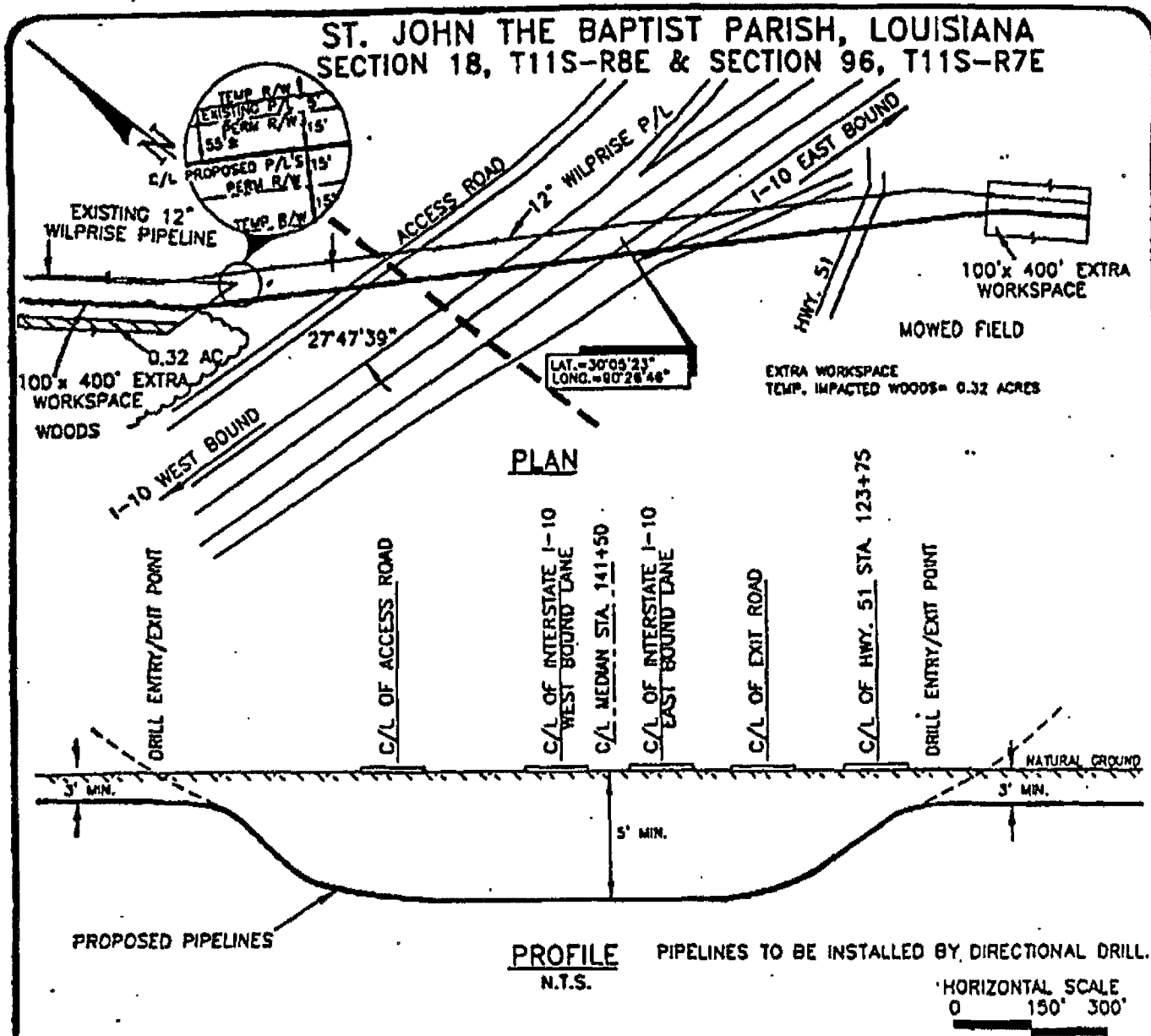

2	6-23-00	REMOVED 10" PIPELINE, REVISED ROUTE & ADDED R/W DETAIL
NO.	DATE	REVISION

SORRENTO PIPELINE COMPANY, LLC

**PROPOSED (2)-8" PIPELINES FROM TRI-STATES VALVE
 TO GARYVILLE LOCATED IN SECTIONS, 43 & 44, T11S-R8E, ST. CHARLES PARISH
 AND SECTIONS, 44, 29, 20, 19, 18, T11S-R8E & 13, 97, 12, 66, 96, 10, 14,
 69, 70, 9, 16, 8, 7, T11S-R7E & SECTIONS, 93, 94, 51, 52, 53, 55, 56, 57, 32
 31, 30, 29, 28, 27, 26 & 23, T11S-R6E, ST. JOHN THE BAPTIST PARISH, LOUISIANA**



Morris P. Hebert, Inc.
PROFESSIONAL LAND & HYDROGRAPHIC SURVEYORS
 P.O. BOX 3106 • HOUMA, LOUISIANA 70361-3106 • (504) 878-2731

DRAWN BY: GWN	SHEET: 11
CHECKED BY: JMH	SCALE: SHOWN
APPROVED BY: DEC	DATE: 4-2000
MPH CAD FILE: 6014COE0035A0	

(15)

ST. JOHN THE BAPTIST PARISH, LOUISIANA SECTIONS 8 & 16, T11S-R7E

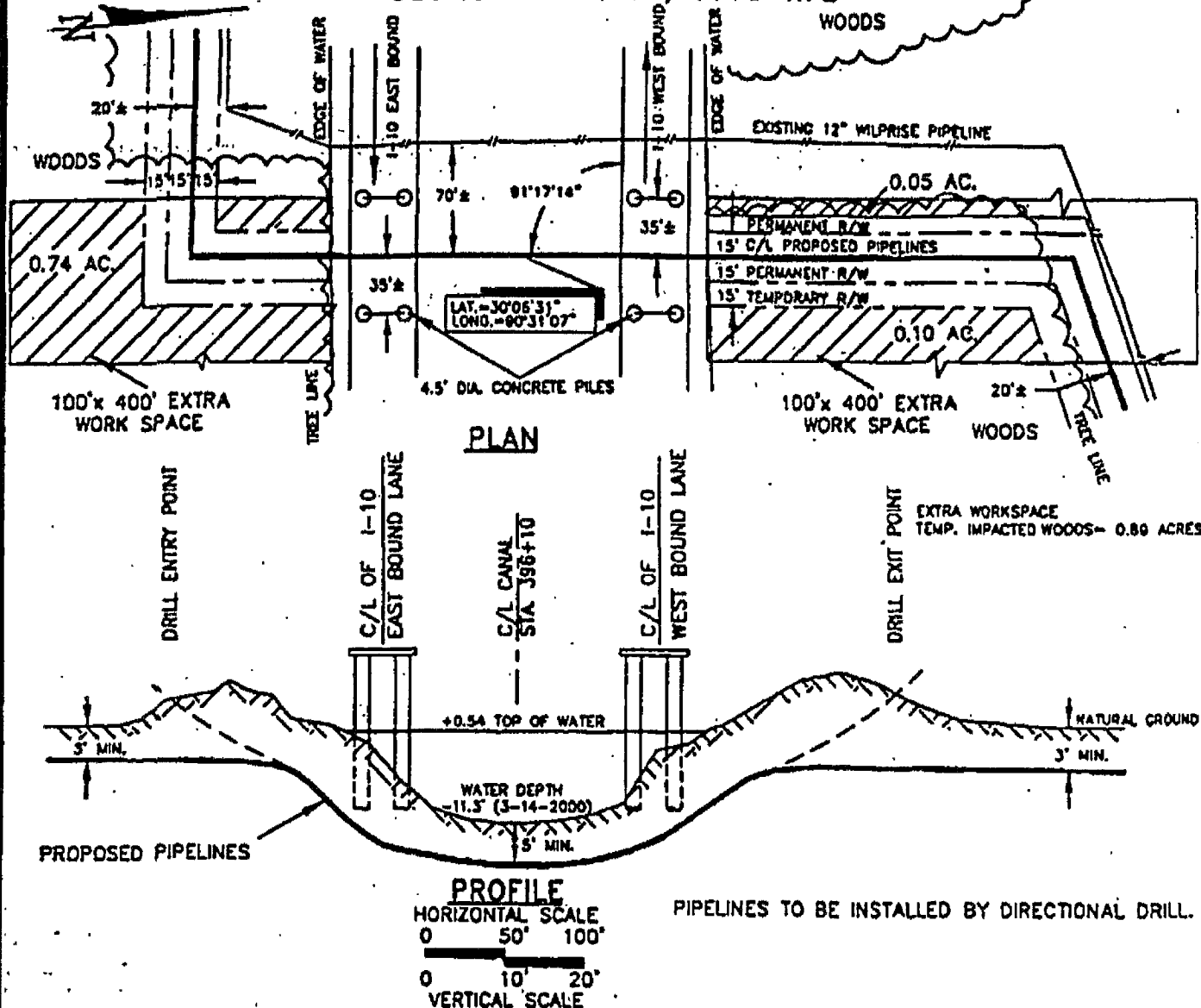

2	6-23-00	REMOVED 10\" PIPELINE, REVISED ROUTE & ADDED R/W DETAIL
NO.	DATE	REVISION

SORRENTO PIPELINE COMPANY, LLC

PROPOSED (2)-8\" PIPELINES FROM TRI-STATES VALVE TO GARYVILLE LOCATED IN SECTIONS, 43 & 44, T11S-R8E, ST. CHARLES PARISH AND SECTIONS, 44, 29, 20, 19, 18, T11S-R8E & 13, 97, 12, 66, 96, 10, 14, 69, 70, 9, 16, 8, 7, T11S-R7E & SECTIONS, 93, 94, 51, 52, 53, 55, 56, 57, 32, 31, 30, 29, 28, 27, 26 & 23, T11S-R6E, ST. JOHN THE BAPTIST PARISH, LOUISIANA

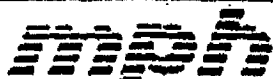

Morris P. Hebert, Inc.
PROFESSIONAL LAND & HYDROGRAPHIC SURVEYORS
P.O. BOX 3106 • HOLMA, LOUISIANA 70361-3106 • (504) 878-2731

DRAWN BY: GWN	SHEET: 12
CHECKED BY: JMH	SCALE: SHOWN
APPROVED BY: DEC	DATE: 4-2000
MPH CAD FILE: 6014COE0044AD	

ST. JOHN THE BAPTIST PARISH, LOUISIANA
SECTION 7, T11S-R7E

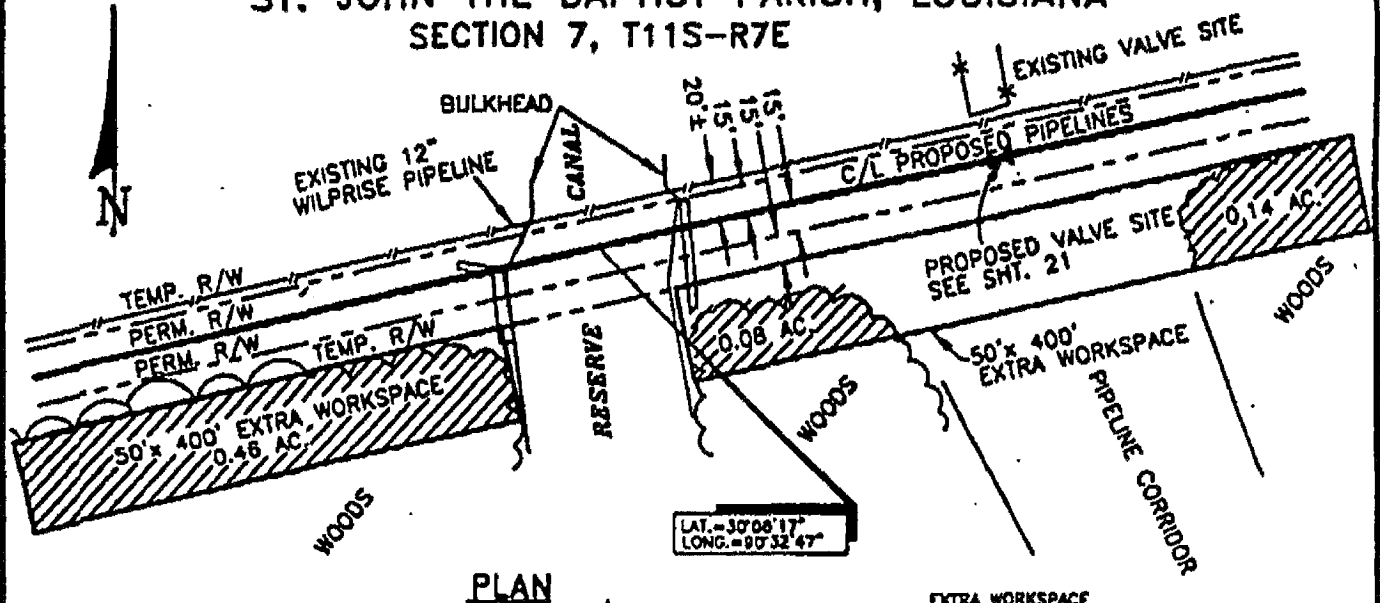

PLAN

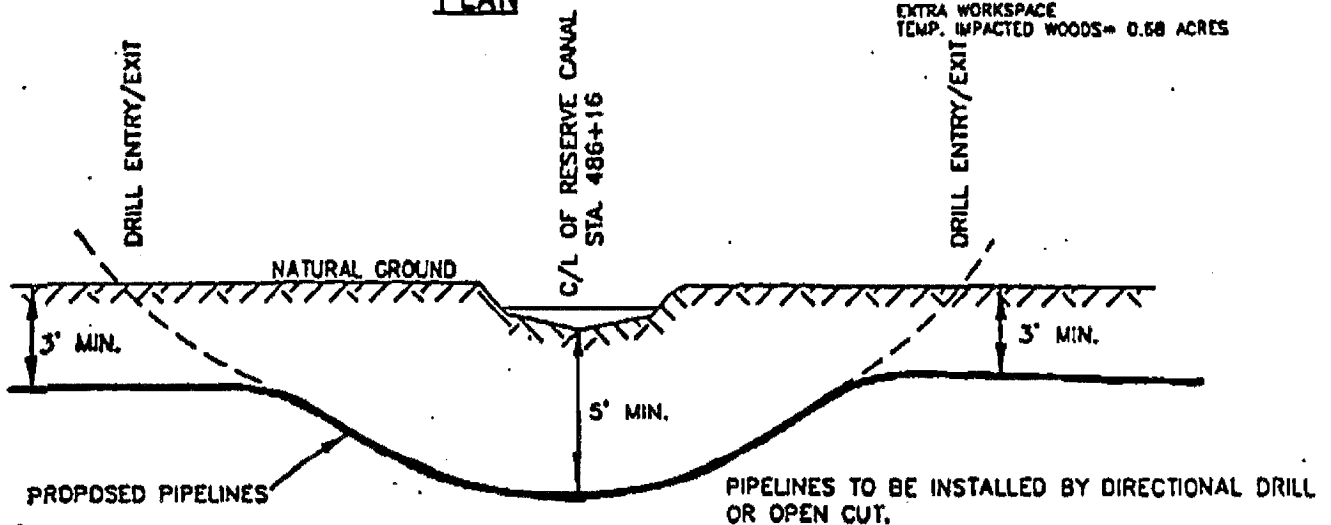

PROFILE
N.T.S.

HORIZONTAL SCALE
0 50' 100'

2	6-23-00	REMOVED 10" PIPELINE, REVISED ROUTE & ADDED R/W DETAIL
NO.	DATE	REVISION

SORRENTO PIPELINE COMPANY, LLC

PROPOSED (2)-8" PIPELINES FROM TRI-STATES VALVE
TO GARYVILLE LOCATED IN SECTIONS, 43 & 44, T11S-R8E, ST. CHARLES PARISH
AND SECTIONS, 44, 29, 20, 19, 18, T11S-R8E & 13, 97, 12, 66, 96, 10, 14,
69, 70, 9, 16, 8, 7, T11S-R7E & SECTIONS, 93, 94, 51, 52, 53, 55, 56, 57, 32
31, 30, 29, 28, 27, 26 & 23, T11S-R6E, ST. JOHN THE BAPTIST PARISH, LOUISIANA

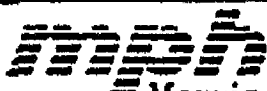

Morris P. Hebert, Inc.
PROFESSIONAL LAND & HYDROGRAPHIC SURVEYORS
P.O. BOX 3106 • MOBILE, LOUISIANA 70351-3106 • (504) 878-2731

DRAWN BY: GWN	SHEET: 13
CHECKED BY: JMM	SCALE: SHOWN
APPROVED BY: DEC	DATE: 4-2000
MPH CAD FILE: 6014COE0047A0	

**ST. JOHN THE BAPTIST PARISH, LOUISIANA
SECTION 93, T11S-R6E**

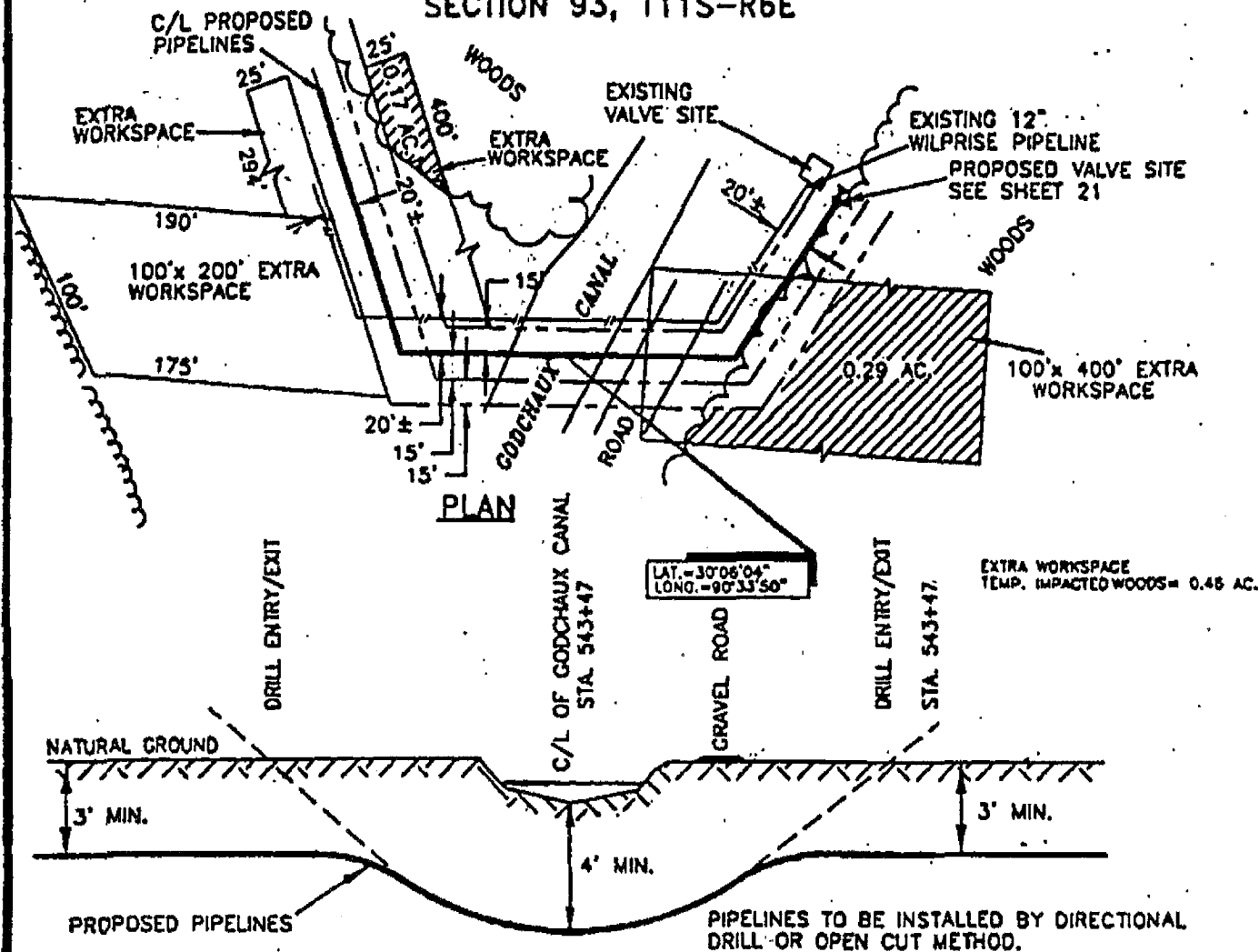

PROFILE
N.T.S.

HORIZONTAL SCALE
0 50' 100'

2	6-23-00	REMOVED 10" PIPELINE, REVISED ROUTE & ADDED R/W DETAIL
NO.	DATE	REVISION

SORRENTO PIPELINE COMPANY, LLC

**PROPOSED (2)-8" PIPELINES FROM TRI-STATES VALVE
TO GARYVILLE LOCATED IN SECTIONS, 43 & 44, T11S-R8E, ST. CHARLES PARISH
AND SECTIONS, 44, 29, 20, 19, 18, T11S-R8E & 13, 97, 12, 66, 96, 10, 14,
69, 70, 9, 16, 8, 7, T11S-R7E & SECTIONS, 93, 94, 51, 52, 53, 55, 56, 57, 32
31, 30, 29, 28, 27, 26 & 23, T11S-R6E, ST. JOHN THE BAPTIST PARISH, LOUISIANA**

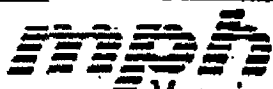

Morris P. Hebert, Inc.
PROFESSIONAL LAND & HYDROGRAPHIC SURVEYORS
P.O. BOX 3108 • HOUMA, LOUISIANA 70361-3108 • (504) 878-2731

DRAWN BY: GWN	SHEET: 14
CHECKED BY: JMH	SCALE: SHOWN
APPROVED BY: DEC	DATE: 4-2000
MPH CAD FILE: 6014COE0046A0	



ST. JOHN THE BAPTIST PARISH, LOUISIANA
SECTIONS 51 & 52, T11S-R6E

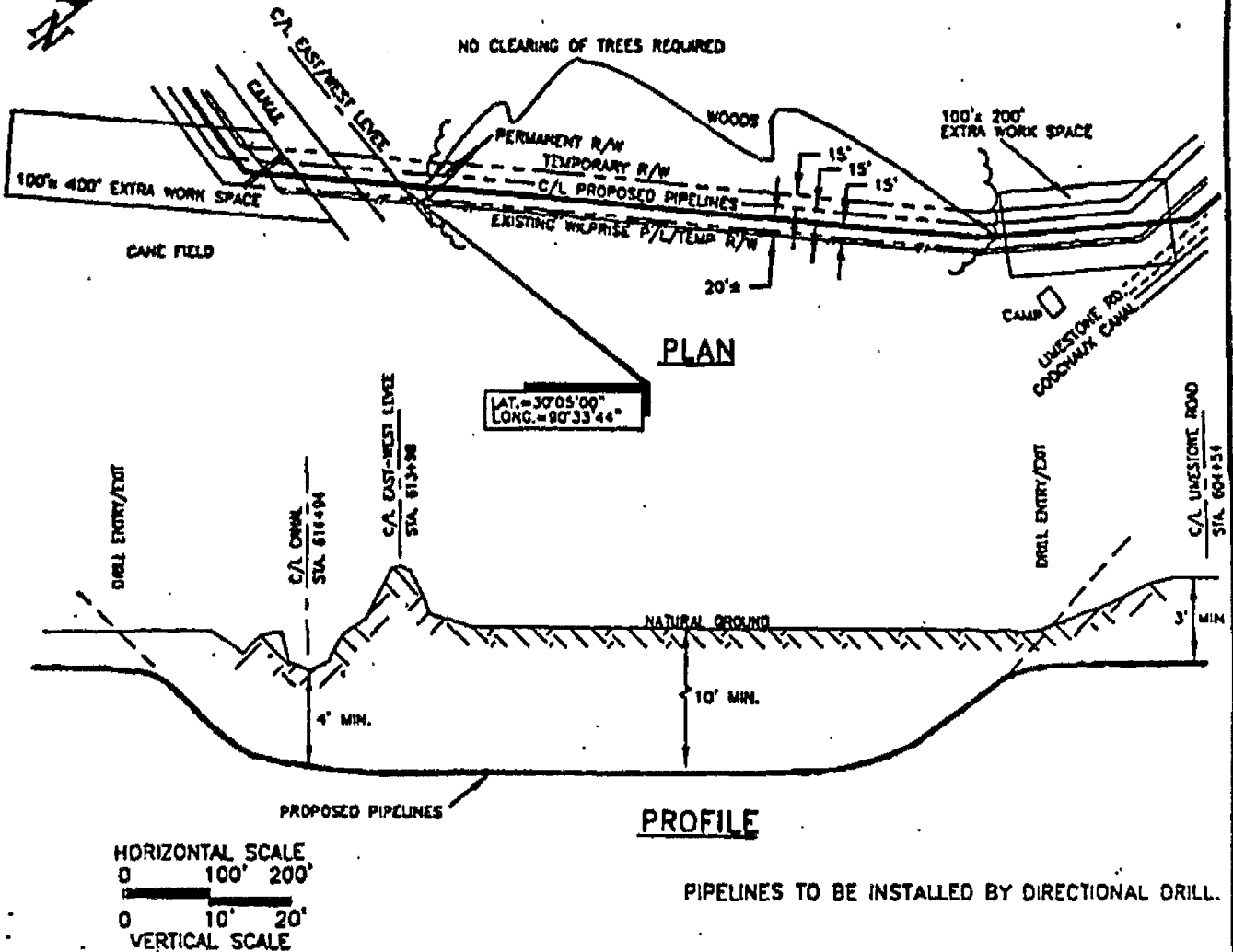

PIPELINES TO BE INSTALLED BY DIRECTIONAL DRILL.

2	6-23-00	REMOVED 10" PIPELINE, REVISED ROUTE & ADDED R/W DETAIL
NO.	DATE	REVISION

SORRENTO PIPELINE COMPANY, LLC

PROPOSED (2)-8" PIPELINES FROM TRI-STATES VALVE
TO GARYVILLE LOCATED IN SECTIONS, 43 & 44, T11S-R8E, ST. CHARLES PARISH
AND SECTIONS, 44, 29, 20, 19, 18, T11S-R8E & 13, 97, 12, 66, 96, 10, 14,
69, 70, 9, 16, 8, 7, T11S-R7E & SECTIONS, 93, 94, 51, 52, 53, 55, 56, 57, 32
31, 30, 29, 28, 27, 26 & 23, T11S-R6E, ST. JOHN THE BAPTIST PARISH, LOUISIANA



Morris P. Hebert, Inc.
PROFESSIONAL LAND & HYDROGRAPHIC SURVEYORS
P.O. BOX 3108 • MOBILE, LOUISIANA 70361-3108 • (504) 678-2731

DRAWN BY: GWN	SHEET: 15
CHECKED BY: JMH	SCALE: SHOWN
APPROVED BY: DEC	DATE: 4-2000
MPH CAD FILE: 6014COE0039A0	

49

TYPICAL ROAD CROSSING DETAIL

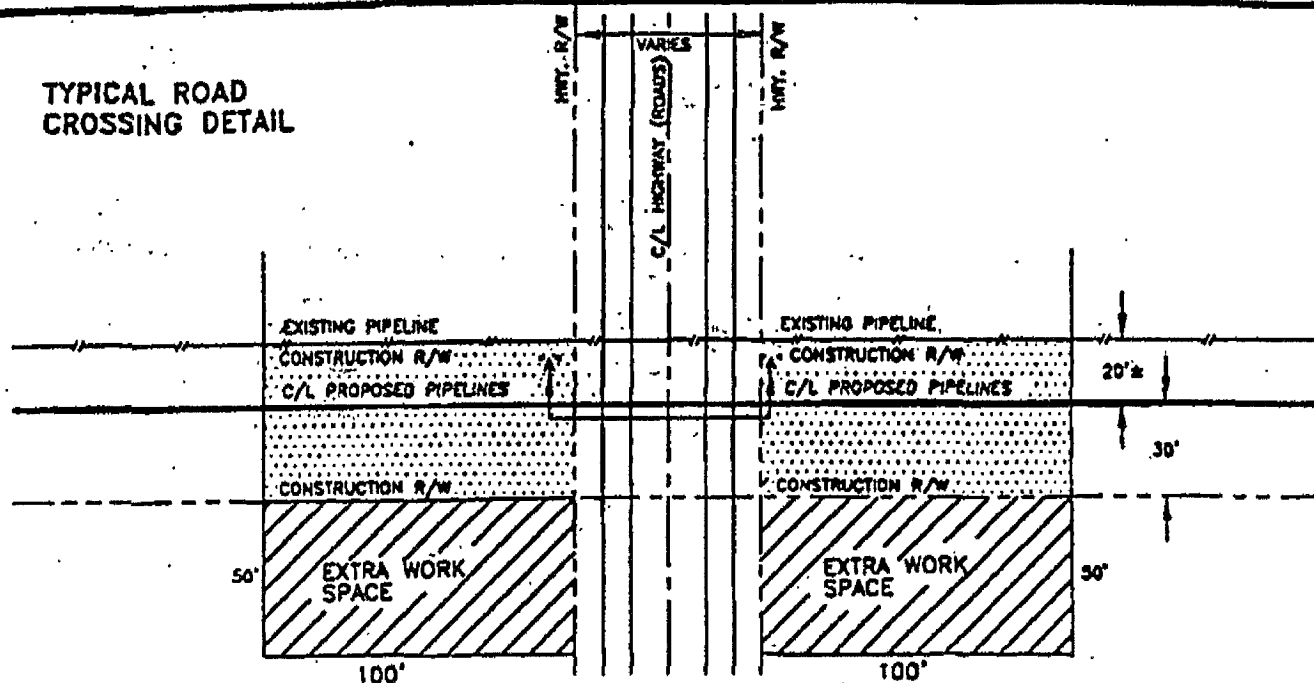

PLAN

N.T.S.

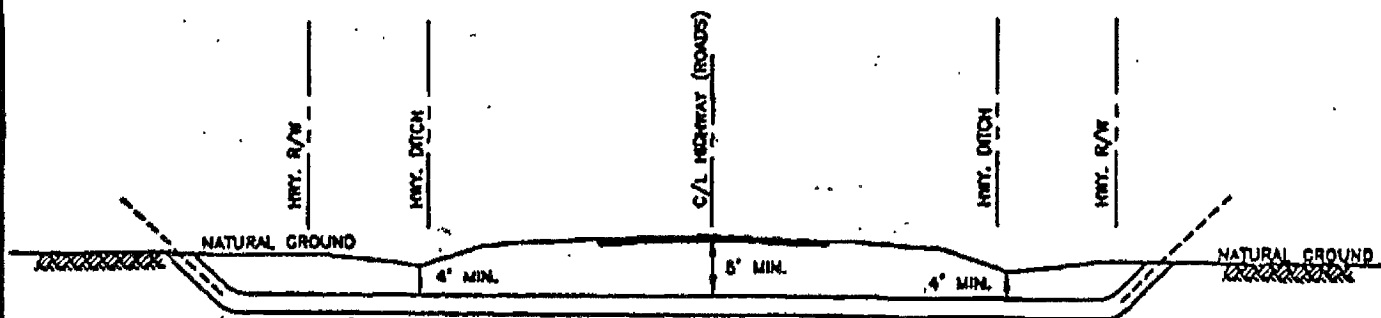

CROSS-SECTION "A"-A"

N.T.S.

NOTE: PIPELINES WILL BE
INSTALLED BY DIRECTIONAL DRILL
OR BORE METHOD.

PROPOSED PIPELINES

2	6-23-00	REMOVED 10" PIPELINE, REVISED ROUTE & ADDED R/W DETAIL
NO.	DATE	REVISION

SORRENTO PIPELINE COMPANY, LLC

PROPOSED (2)-8" PIPELINES FROM TRI-STATES VALVE
TO GARYVILLE LOCATED IN SECTIONS, 43 & 44, T11S-R8E, ST. CHARLES PARISH
AND SECTIONS, 44, 29, 20, 19, 18, T11S-R8E & 13, 97, 12, 86, 96, 10, 14,
69, 70, 9, 16, 8, 7, T11S-R7E & SECTIONS, 93, 94, 51, 52, 53, 55, 56, 57, 32
31, 30, 29, 28, 27, 26 & 23, T11S-R6E, ST. JOHN THE BAPTIST PARISH, LOUISIANA

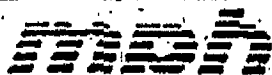

Morris P. Hebert, Inc.
PROFESSIONAL LAND & HYDROGRAPHIC SURVEYORS
P.O. BOX 3108 • HOUMA, LOUISIANA 70361-3108 • (504) 879-2731

DRAWN BY: GWN

SHEET: 16

CHECKED BY: JMH

SCALE: SHOWN

APPROVED BY: DEC

DATE: 4-2000

MPH CAD FILE: 6014COE0040AD

50

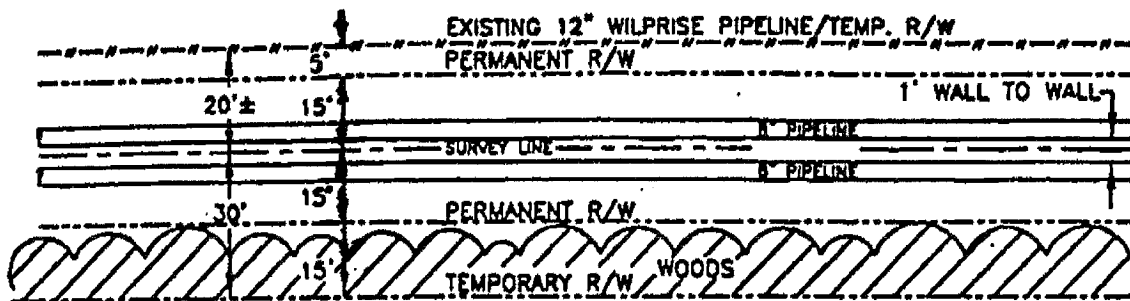

WET LAND R/W DETAIL (1)

N.T.S.

TEMPORARY IMPACTED WOODS

STATION:	STATION:
2+80 TO 114+92=1.67 AC.	397+19 TO 402+08=0.008 AC.
163+63 TO 185+87=0.27 AC.	412+60 TO 424+25=0.34 AC.
186+25 TO 200+14=0.20 AC.	453+95 TO 482+43=0.87 AC.
204+22 TO 220+03=0.40 AC.	487+28 TO 541+56=1.10 AC.
220+84 TO 281+94=1.30 AC.	TOTAL=6.78 ACRES
282+48 TO 293+47=0.24 AC.	
294+40 TO 311+87=0.38 AC.	

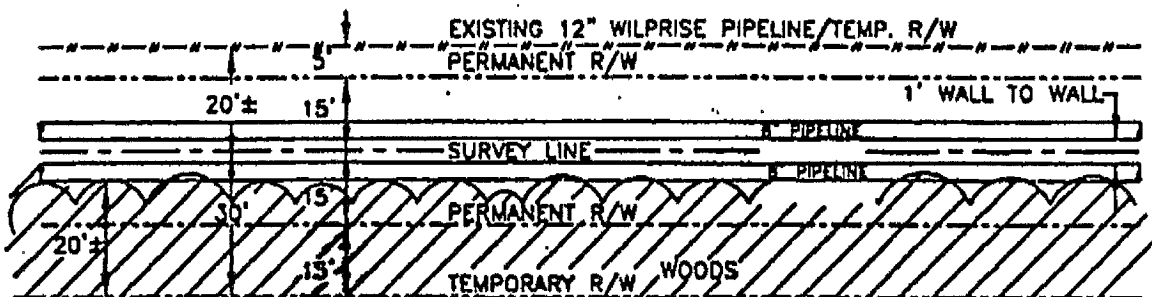

TEMPORARY & PERMANENT IMPACTED WOODS

WET LAND R/W DETAIL (2)

STATION: TEMPORARY R/W	STATION: PERMANENT R/W	N.T.S.
313+46 TO 394+86=2.25 AC.	313+46 TO 394+86=0.69 AC.	
397+19 TO 397+46=0.03 AC.	397+19 TO 397+46=0.02 AC.	
425+25 TO 453+95=1.01 AC.	425+25 TO 453+95=0.18 AC.	
543+85 TO 545+72=0.09 AC.	543+85 TO 545+72=0.12 AC.	
TOTAL 3.38 ACRES	TOTAL 1.01 ACRES	

2	6-23-00	REMOVED 10" PIPELINE, REVISED ROUTE & ADDED R/W DETAIL
NO.	DATE	REVISION

SORRENTO PIPELINE COMPANY, LLC

PROPOSED (2)-8" PIPELINES FROM TRI-STATES VALVE
TO GARYVILLE LOCATED IN SECTIONS, 43 & 44, T11S-RBE, ST. CHARLES PARISH
AND SECTIONS, 44, 29, 20, 19, 18, T11S-RBE & 13, 97, 12, 66, 96, 10, 14,
69, 70, 9, 16, 8, 7, T11S-R7E & SECTIONS, 93, 94, 51, 52, 53, 55, 56, 57, 32
31, 30, 29, 28, 27, 26 & 23, T11S-R6E, ST. JOHN THE BAPTIST PARISH, LOUISIANA

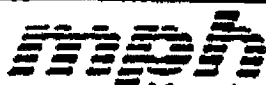

Morris P. Hebert, Inc.
PROFESSIONAL LAND & HYDROGRAPHIC SURVEYORS
P.O. BOX 3108 • NOUA, LOUISIANA 70361-3108 • (504) 879-2731

DRAWN BY: GWN	SHEET: 17
CHECKED BY: JMH	SCALE: SHOWN
APPROVED BY: DEC	DATE: 4-2000
MPH CAD FILE: 6014COE0048AD	

51

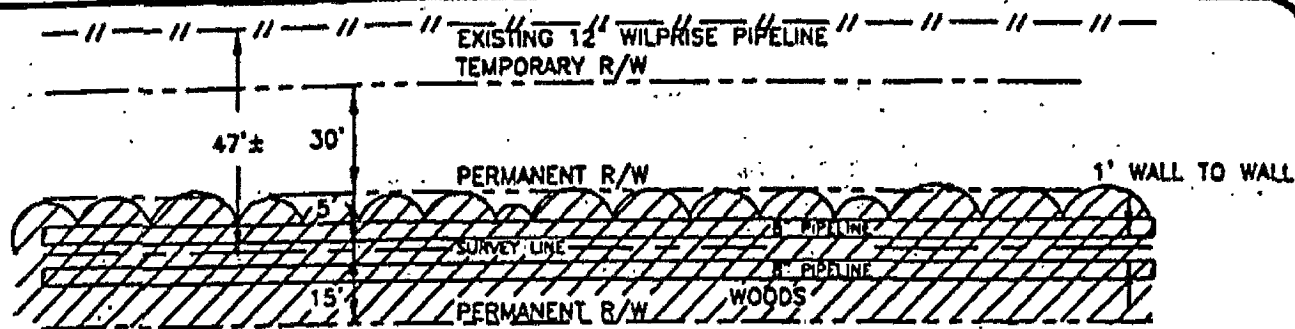
WET LAND R/W DETAIL (3)

N.T.S.

PERMANENT IMPACTED WOODS

STATION:

PERMANENT R/W

144+04 TO 183+09=0.69 AC.

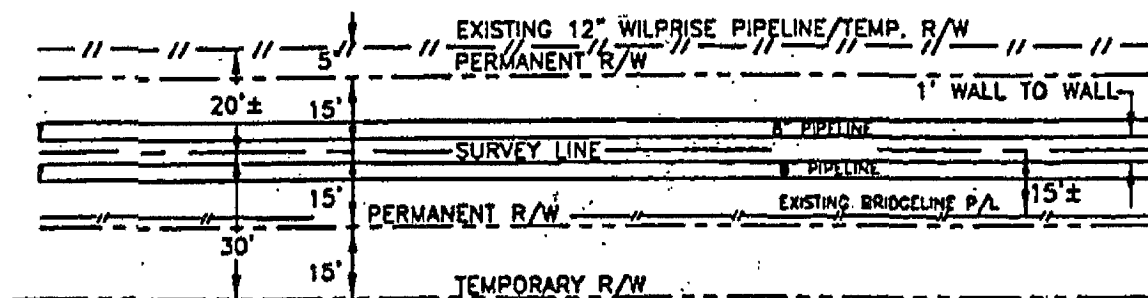
UPLAND R/W DETAIL (1)

N.T.S.

TEMPORARY & PERMANENT IMPACTED WOODS

STATION: 545+72 TO 603+85 (NO WOODS IMPACTED)

NO.	DATE	REVISION

SORRENTO PIPELINE COMPANY, LLC

PROPOSED (2)-8" PIPELINES FROM TRI-STATES VALVE
TO GARYVILLE LOCATED IN SECTIONS, 43 & 44, T11S-R8E, ST. CHARLES PARISH
AND SECTIONS, 44, 29, 20, 19, 18, T11S-R8E & 13, 97, 12, 66, 96, 10, 14,
69, 70, 9, 16, 8, 7, T11S-R7E & SECTIONS, 93, 94, 51, 52, 53, 55, 56, 57, 32
31, 30, 29, 28, 27, 26 & 23, T11S-R6E, ST. JOHN THE BAPTIST PARISH, LOUISIANA

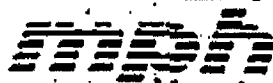
**Morris P. Hebert, Inc.**

PROFESSIONAL LAND & HYDROGRAPHIC SURVEYORS

P.O. BOX 3106 • MOBILE, LOUISIANA 70361-3106 • (504) 878-2731

DRAWN BY: GWN

SHEET: 17A

CHECKED BY: JMH

SCALE: SHOWN

APPROVED BY: DEC

DATE: 4-2000

MPH CAD FILE: 6014COE0053A0

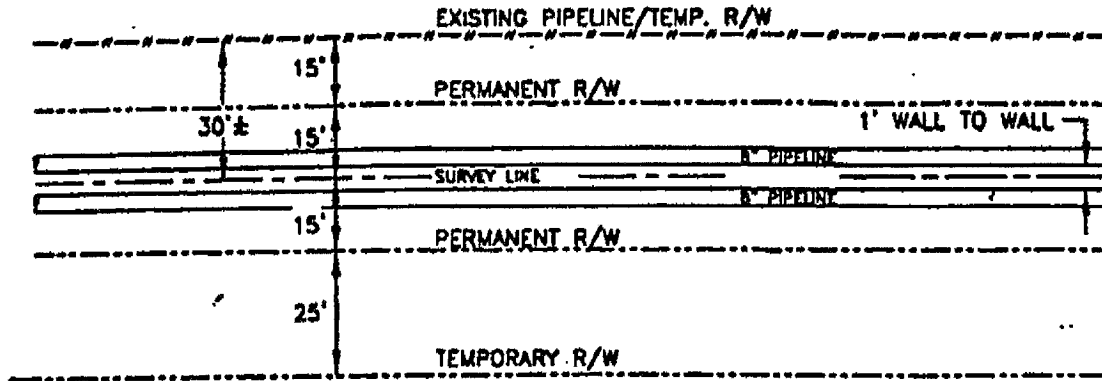

UPLAND R/W DETAIL (2) (CANE FIELD)

N.T.S.

STATION 615+19 TO 878+70 (NO WOODS IMPACTED)

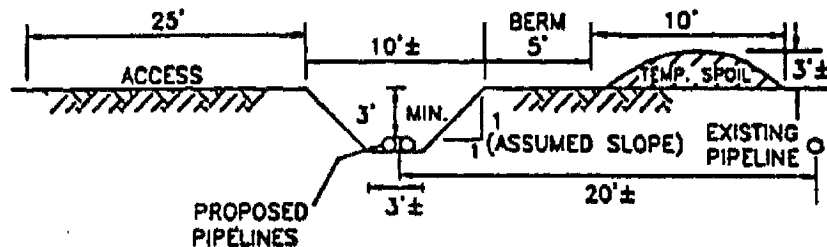

WETLAND DITCH DETAIL

N.T.S.

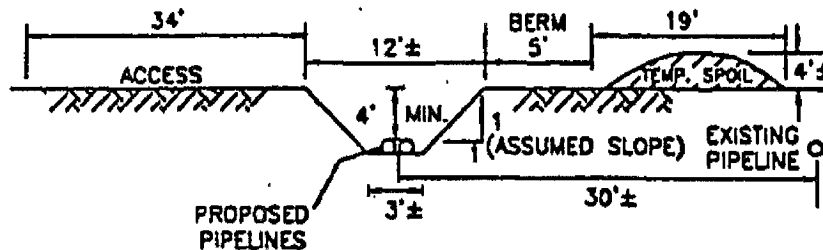

UPLAND DITCH DETAIL

N.T.S.

2	6-23-00	REMOVED 10" PIPELINE, REVISED ROUTE & ADDED R/W DETAIL
NO.	DATE	REVISION

SORRENTO PIPELINE COMPANY, LLC

PROPOSED (2)-8" PIPELINES FROM TRI-STATES VALVE TO GARYVILLE LOCATED IN SECTIONS, 43 & 44, T11S-R8E, ST. CHARLES PARISH AND SECTIONS, 44, 29, 20, 19, 18, T11S-R8E & 13, 97, 12, 66, 96, 10, 14, 69, 70, 9, 16, 8, 7, T11S-R7E & SECTIONS, 93, 94, 51, 52, 53, 55, 56, 57, 32, 31, 30, 29, 28, 27, 26 & 23, T11S-R6E, ST. JOHN THE BAPTIST PARISH, LOUISIANA



Morris P. Hebert, Inc.
PROFESSIONAL LAND & HYDROGRAPHIC SURVEYORS
P.O. BOX 3108 • MOUW, LOUISIANA 70381-3108 • (504) 878-2731

DRAWN BY: GWN	SHEET: 18
CHECKED BY: JMM	SCALE: SHOWN
APPROVED BY: DEC	DATE: 4-2000
MPH CAD FILE: 6014COE0048B0	

53

APPROXIMATELY 12 CUBIC YARDS (MAX.) OF MATERIAL TO BE PLACED OVER BACKFILLED PIPE DITCH TO PROVIDE STABILIZATION ALONG DISTURBED BANKLINE.

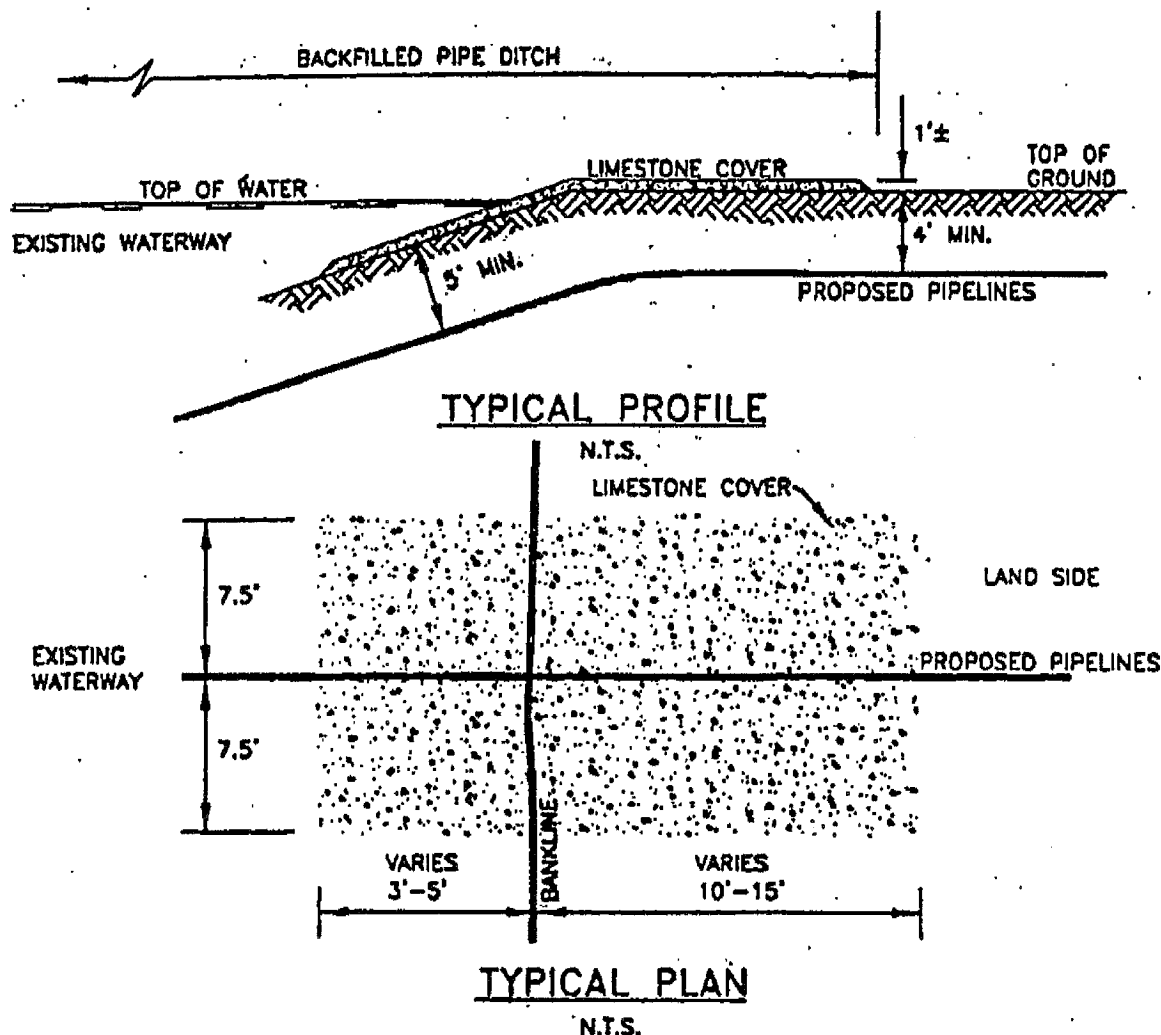

2	6-23-00	REMOVED 10" PIPELINE, REVISED ROUTE & ADDED R/W DETAIL
NO.	DATE	REVISION

SORRENTO PIPELINE COMPANY, LLC

PROPOSED (2)-8" PIPELINES FROM TRI-STATES VALVE TO GARYVILLE LOCATED IN SECTIONS, 43 & 44, T11S-R8E, ST. CHARLES PARISH AND SECTIONS, 44, 29, 20, 19, 18, T11S-R8E & 13, 97, 12, 66, 96, 10, 14, 69, 70, 9, 16, 8, 7, T11S-R7E & SECTIONS, 93, 94, 51, 52, 53, 55, 56, 57, 32 31, 30, 29, 28, 27, 26 & 23, T11S-R6E, ST. JOHN THE BAPTIST PARISH, LOUISIANA

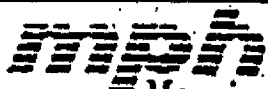

Morris P. Hebert, Inc.
 PROFESSIONAL LAND & HYDROGRAPHIC SURVEYORS
 P.O. BOX 3106 • HOUMA, LOUISIANA 70361-3106 • (504) 879-2731

DRAWN BY: GWN	SHEET: 19
CHECKED BY: JMH	SCALE: SHOWN
APPROVED BY: DEC	DATE: 4-2000
MPH CAD FILE: 6014C0E0036A0	

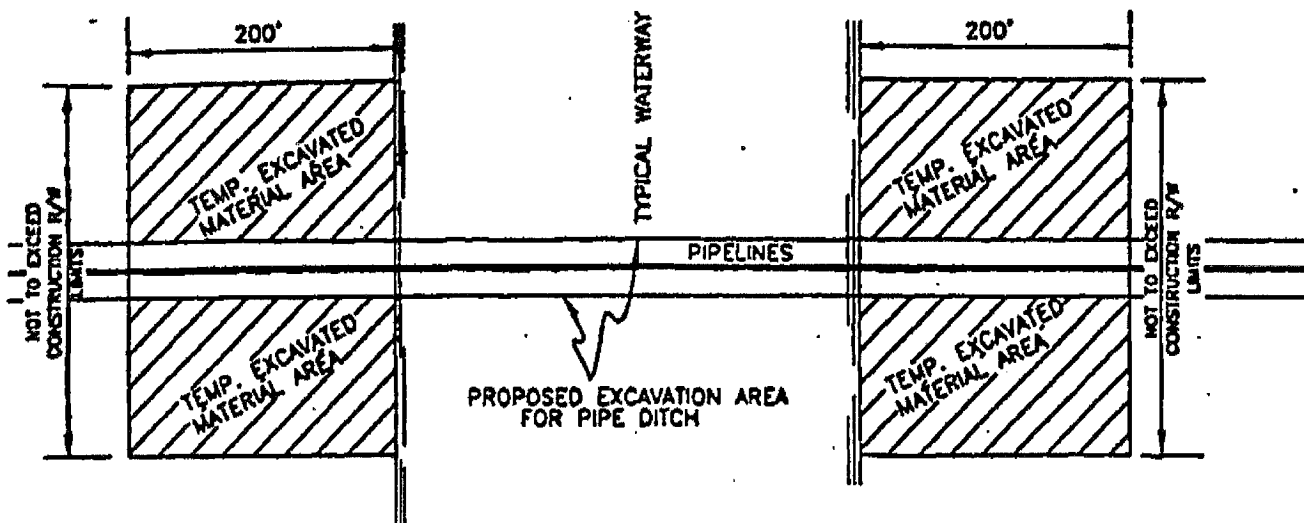

PLAN

N.T.S.

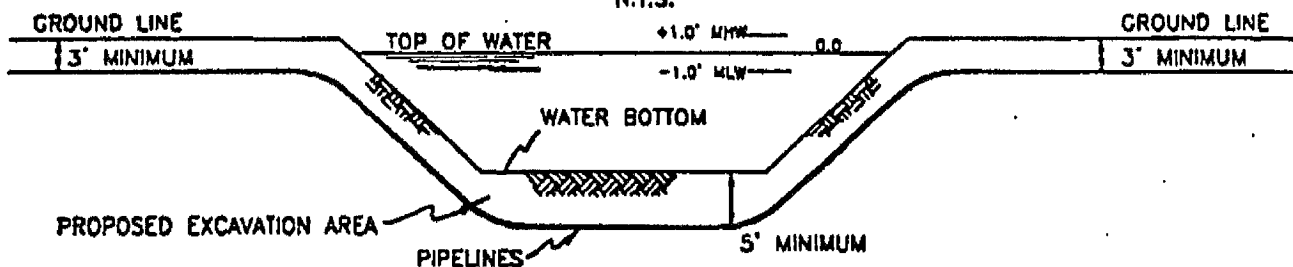

PROFILE

N.T.S.

EXCESS DREDGED OR EXCAVATED MATERIAL WILL
BE TEMPORARILY PLACED ON THE BANK.

TYPICAL OPEN CUT WATERWAY CROSSING

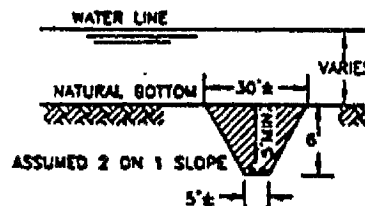

DITCH CROSS-SECTION

N.T.S.

2	6-23-00	REMOVED 10" PIPELINE, REVISED ROUTE & ADDED R/W DETAIL
NO.	DATE	REVISION

SORRENTO PIPELINE COMPANY, LLC

PROPOSED (2)-8" PIPELINES FROM TRI-STATES VALVE
TO GARYVILLE LOCATED IN SECTIONS, 43 & 44, T11S-RBE, ST. CHARLES PARISH
AND SECTIONS, 44, 29, 20, 19, 18, T11S-RBE & 13, 97, 12, 68, 96, 10, 14,
69, 70, 9, 16, 8, 7, T11S-R7E & SECTIONS, 93, 94, 51, 52, 53, 55, 56, 57, 32
31, 30, 29, 28, 27, 26 & 23, T11S-R6E, ST. JOHN THE BAPTIST PARISH, LOUISIANA

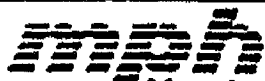

Morris P. Hebert, Inc.

PROFESSIONAL LAND & HYDROGRAPHIC SURVEYORS

P.O. BOX 3108 • HOUMA, LOUISIANA 70381-3108 • (504) 878-2731

DRAWN BY: GWN

SHEET: 20

CHECKED BY: JMH

SCALE: SHOWN

APPROVED BY: DEC

DATE: 4-2000

MPH CAD FILE: 6014COE0037A0

55

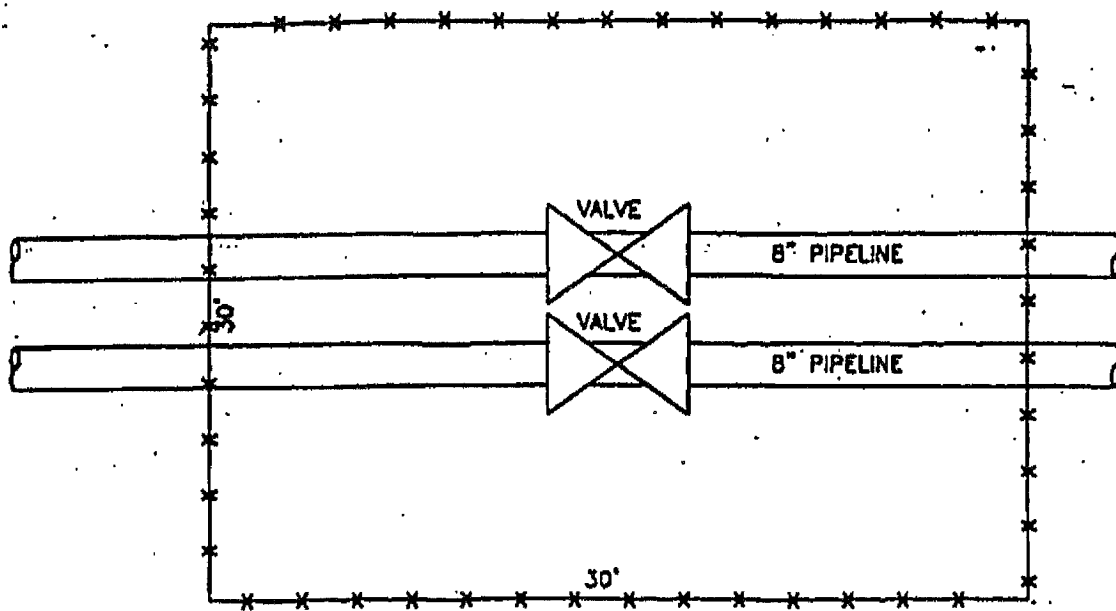

TYPICAL VALVE SITE
PLAN
N.T.S.

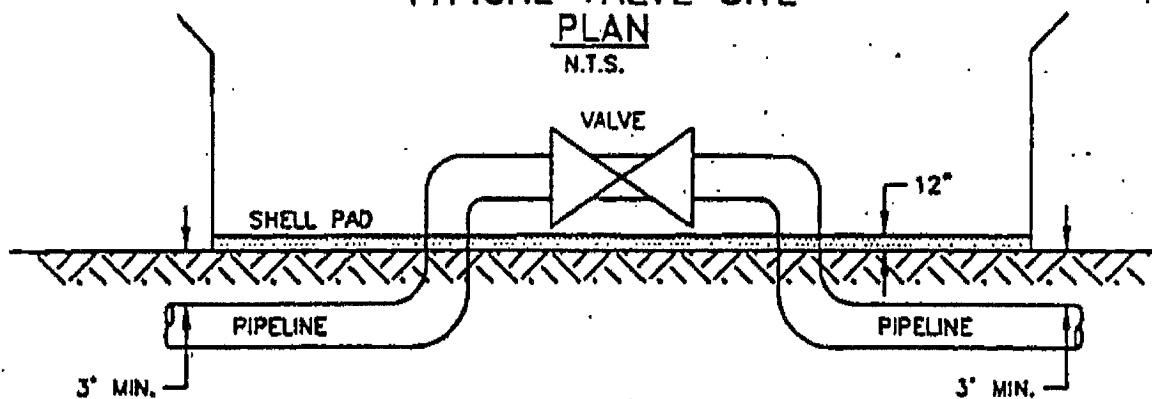

TYPICAL VALVE SITE
PROFILE
N.T.S.

2	6-23-00	REMOVED 10" PIPELINE, REVISED ROUTE & ADDED R/W DETAIL.
NO.	DATE	REVISION

SORRENTO PIPELINE COMPANY, LLC

PROPOSED (2)-8" PIPELINES FROM TRI-STATES VALVE
TO GARYVILLE LOCATED IN SECTIONS, 43 & 44, T11S-R8E, ST. CHARLES PARISH
AND SECTIONS, 44, 29, 20, 19, 18, T11S-R8E & 13, 97, 12, 66, 96, 10, 14,
69, 70, 9, 16, 8, 7, T11S-R7E & SECTIONS, 93, 94, 51, 52, 53, 55, 56, 57, 32
31, 30, 29, 28, 27, 26 & 23, T11S-R6E, ST. JOHN THE BAPTIST PARISH, LOUISIANA

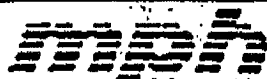

Morris P. Hebert, Inc.
PROFESSIONAL LAND & HYDROGRAPHIC SURVEYORS
P.O. BOX 3108 • HOUMA, LOUISIANA 70361-3108 • (504) 878-2731

DRAWN BY: GWN	SHEET: 21
CHECKED BY: JMH	SCALE: SHOWN
APPROVED BY: DEC	DATE: 4-2000
MPH CAD FILE: 6014COE0051A0	

NOTES:

1. APPROXIMATELY 73,500± CUBIC YARDS OF SPOIL MATERIAL WILL BE EXCAVATED BY BACK HOE. SPOIL WILL BE PLACED ADJACENT TO PIPE DITCH DURING CONSTRUCTION. FOLLOWING CONSTRUCTION, SPOIL WILL BE RETURNED TO DITCH.
2. IF THE CONTRACTOR ELECTS TO OPEN CUT WATER WAYS, APPROXIMATELY 900 CUBIC YARDS OF SPOIL MATERIAL WILL BE EXCAVATED FROM WATER BOTTOM. SPOIL WILL BE PLACED ADJACENT TO BANK LINE DURING CONSTRUCTION. FOLLOWING CONSTRUCTION, SPOIL WILL BE RETURNED TO DITCH.
3. IF CONTRACTOR ELECTS TO OPEN CUT WATER WAYS, APPROXIMATELY 75± CUBIC YARDS OF LIMESTONE WILL BE HAULED IN FOR CONSTRUCTION OF BANK STABILIZATION.
4. APPROXIMATELY 100 CUBIC YARDS. OF (LIMESTONE) FILL IS REQUIRED FOR THE VALVE SITES.
5. A TOTAL OF APPROXIMATELY 14.92± ACRES OF WOODLAND TO BE AFFECTED DURING CONSTRUCTION OF THE PROPOSED PIPELINES. APPROXIMATELY 1.70± ACRES WILL BE PERMANENTLY IMPACTED, 10.16± ACRES WILL BE TEMPORARILY IMPACTED AND 3.06± ACRES WILL BE TEMPORARILY IMPACTED BY EXTRA WORKSPACE.
6. TIMBER SHALL BE CHIPPED, BURNED OR REMOVED FROM RIGHT-OF-WAY.

2	6-23-00	REMOVED 10" PIPELINE, REVISED ROUTE & ADDED R/W DETAIL
NO.	DATE	REVISION

SORRENTO PIPELINE COMPANY, LLC

PROPOSED (2)-8" PIPELINES FROM TRI-STATES VALVE
TO GARYVILLE LOCATED IN SECTIONS, 43 & 44, T11S-R8E, ST. CHARLES PARISH
AND SECTIONS, 44, 29, 20, 19, 18, T11S-R8E & 13, 97, 12, 66, 96, 10, 14,
69, 70, 9, 16, 8, 7, T11S-R7E & SECTIONS, 93, 94, 51, 52, 53, 55, 56, 57, 32
31, 30, 29, 28, 27, 26 & 23, T11S-R6E, ST. JOHN THE BAPTIST PARISH, LOUISIANA

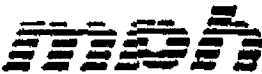

Morris P. Hebert, Inc.
PROFESSIONAL LAND & HYDROGRAPHIC SURVEYORS
P.O. BOX 3106 • MOBILE, LOUISIANA 70361-3106 • (504) 878-3731

DRAWN BY: GWN	SHEET: 22
CHECKED BY: JWH	SCALE: SHOWN
APPROVED BY: DEC	DATE: 4-2000
MPH CAD FILE: 6014COE0021A0	