

D.R.D.

2003-0334

INTRODUCED BY: ALBERT D. LAQUE, PARISH PRESIDENT
(DEPARTMENT OF PUBLIC WORKS)

ORDINANCE NO. 03-10-5

An ordinance approving and authorizing the execution of Change Order No. One (1) - Final for Parish Project No. P011003, Willowdale Canal Erosion Control, to balance contractual quantities with actual job quantities.

WHEREAS, Ordinance No. 03-4-14, adopted April 21, 2003 by the St. Charles Parish Council awarded construction of Parish Project No. P011003, Willowdale Canal Erosion Control, to Civil Construction Contractors, Inc. for the amount of \$131,212.94; and,

WHEREAS, the project was completed by Civil Construction Contractors, Inc. \$1114.46 under the original Contract Price of \$131,212.94; and,

WHEREAS, the project was completed by Civil Construction Contractors, Inc. eleven (11) days after the original completion date of September 13, 2003 due to inclimate weather and the addition of one yard to be graded and sodded; and,

WHEREAS, Change Order No. One (1) - Final is necessary to close out the construction contract with Civil Construction Contractors, Inc. for Parish Project No P011003, Willowdale Canal Erosion Control.

THE ST. CHARLES PARISH COUNCIL HEREBY ORDAINS:

SECTION I. That Change Order No. One (1) - Final to the contract for Parish Project No. 011003, Willowdale Canal Erosion Control, to offer a contract amount credit of \$1114.46 and an increase in contract time of eleven (11) days to St. Charles Parish is hereby approved.

SECTION II. That the Parish President is hereby authorized to execute said Change Order

The foregoing ordinance having been submitted to a vote, the vote thereon was as follows:

YEAS: RAMCHANDRAN, FAUCHEUX, HILAIRE, FABRE, ABADIE, AUTHEMENT, BLACK, MARINO, MINNICH

NAYS: NONE

ABSENT: NONE

And the ordinance was declared adopted this 6th day of October, 2003, to become effective five (5) days after publication in the Official Journal.

CHAIRMAN Lance J. Mann
SECRETARY Barbara J. Gout
DLVD/PARISH PRESIDENT October 7, 2003
APPROVED: [Signature] DISAPPROVED: _____
PARISH PRESIDENT: Albert D. Laque
RETD/SECRETARY. October 7 2003
AT 2:10 P.M. RECD BY: [Signature]

RECORDED IN THE ST. CHARLES PARISH
CLERK OF COURT OFFICE
ON 10/7/03
AS ENTRY NO. 286810
IN MORTGAGE/CONVFYANCE BOOK
NO. 972 FOLIO 360

CHANGE ORDER

No.

1 - Final

DATE OF ISSUANCE 17-Sep-03

EFFECTIVE DATE 17-Sep-03

OWNER St Charles Parish (SCP) Department of Public Works and Wastewater

CONTRACTOR Civil Construction Contractors, Inc

Contract Willowdale Canal Erosion Control

Project Willowdale Canal Erosion Control

OWNER's Contract No. P011003

ENGINEER's Contract No

N/A

ENGINEER Danny J Hebert, P E

You are directed to make the following changes in the Contract Documents

Description: See Attachment 1 - Description of Changes

Reason for Change Order: To adjust contractual quantities with actual quantities.

Attachments: (List documents supporting change) Attachment 1 - Description of Changes

CHANGE IN CONTRACT PRICE

CHANGE IN CONTRACT TIMES

Original Contract Price:

\$131,327.40

Net increase ~~decrease~~ from previous Change Orders

No 0 thru No 0

\$0.00

Contract Price prior to this Change Order

\$131,327.40

Net increase (decrease) of this Change Order:

(\$1,114.46)

Contract price with all approved Change Orders

\$130,212.94

Original Contract Times

Substantial Completion August 29, 2003

Ready for final payment, ~~October 14, 2003~~

(days or dates)

Net change from previous Change Orders No 0 to

No 0

Substantial Completion Zero

Ready for final payment Zero

(days)

Contract Times prior to this Change Order

Substantial Completion August 29, 2003

Ready for final payment October 14, 2003

(days or dates)

Net increase (~~decrease~~) this Change Order

Substantial Completion, Eleven

Ready for final payment, Eleven

(days)

Contract Times with all approved Change Orders

Substantial Completion: September 9, ~~2003~~

Ready for final payment: October 24, 2003

(days or dates)

RECOMMENDED:

By

ENGINEER (Authorized Signature)

Date:

9/17/03

APPROVED:

By

OWNER (Authorized Signature)

Date

10/2/2003

ACCEPTED:

By:

CONTRACTOR (Authorized Signature)

Date:

9-18-03

EJCDC 1910-8-B (1998 Edition)

Prepared by the Engineers Joint Contract Documents Committee and endorsed by The Associated General Contractors of America and the Construction Specifications Institute

4. SCHEDULE OF PRICES
ST. CHARLES PARISH PROJECT NO. P011003

NO.	ITEM	UNIT	ESTIMATED QUANTITY	UNIT PRICE	TOTAL ESTI-MATED PRICE
1	Mobilization	1	Lump Sum	Thirteen thousand + $\frac{40}{100}$ Dollars & Cents	\$ 13,000.00 ✓
2	Clearing, Grubbing, Demolition and Scarification	3,627	Sq. Yds.	Seven + $\frac{45}{100}$ Dollars & Cents	+ 2,415.00 ✓
	<i>Add</i> 345 Sq. Yds				\$ 25,389.00 ✓
3	Cohesive Clay Fill (topsoil)	50	Cubic Yds.	7.00 Eight + $\frac{30}{100}$ Dollars & Cents	\$ 415.00 ✓
4	Class "A" Centipede Sod (Includes Sod Pins)	3000	Sq. Yds.	8.30 Three + $\frac{32}{100}$ Dollars & Cents	+ 2,447.60 ✓
	<i>Add</i> 737.23 Sq. Yds				\$ 9,960.00 ✓
5	Reinforced Concrete Slope 870 Pavement	Sq. Yds.		3.32 Seventy-five + $\frac{82}{100}$ Dollars & Cents	+ 5,672.94 ✓
	<i>Add</i> 1482 Sq. Yds				\$ 65,963.40 ✓
6	Splash Blocks	20	Ea.	Three hundred thirty + $\frac{40}{100}$ Dollars & Cents	- 1,650.00 ✓
	<i>Delete</i> 5 ea.				\$ 6,600.00 ✓
7	Relocation of Infrastructure Items	Allow		Ten Thousand Dollars & No Cents	- 10,000 ✓
	<i>Delete</i> 1				(\$10,000.00) \$10,000.00 ✓

Total of all Estimated Prices: (\$ 131,327.40 *Revised* (\$ 130,217.94)
One hundred thirty-one thousand three hundred twenty-seven + $\frac{40}{100}$ Dollars.

Unit Prices have been computed in accordance with paragraph 11.9.2 of the General Conditions.

~~\$~~ - 1,114.46

TOTAL SLOPE PAVEMENT
 2325
 4375.25
 1576.75
 + 226.39
 8,503.4 S.F.=944.82 S.Y.

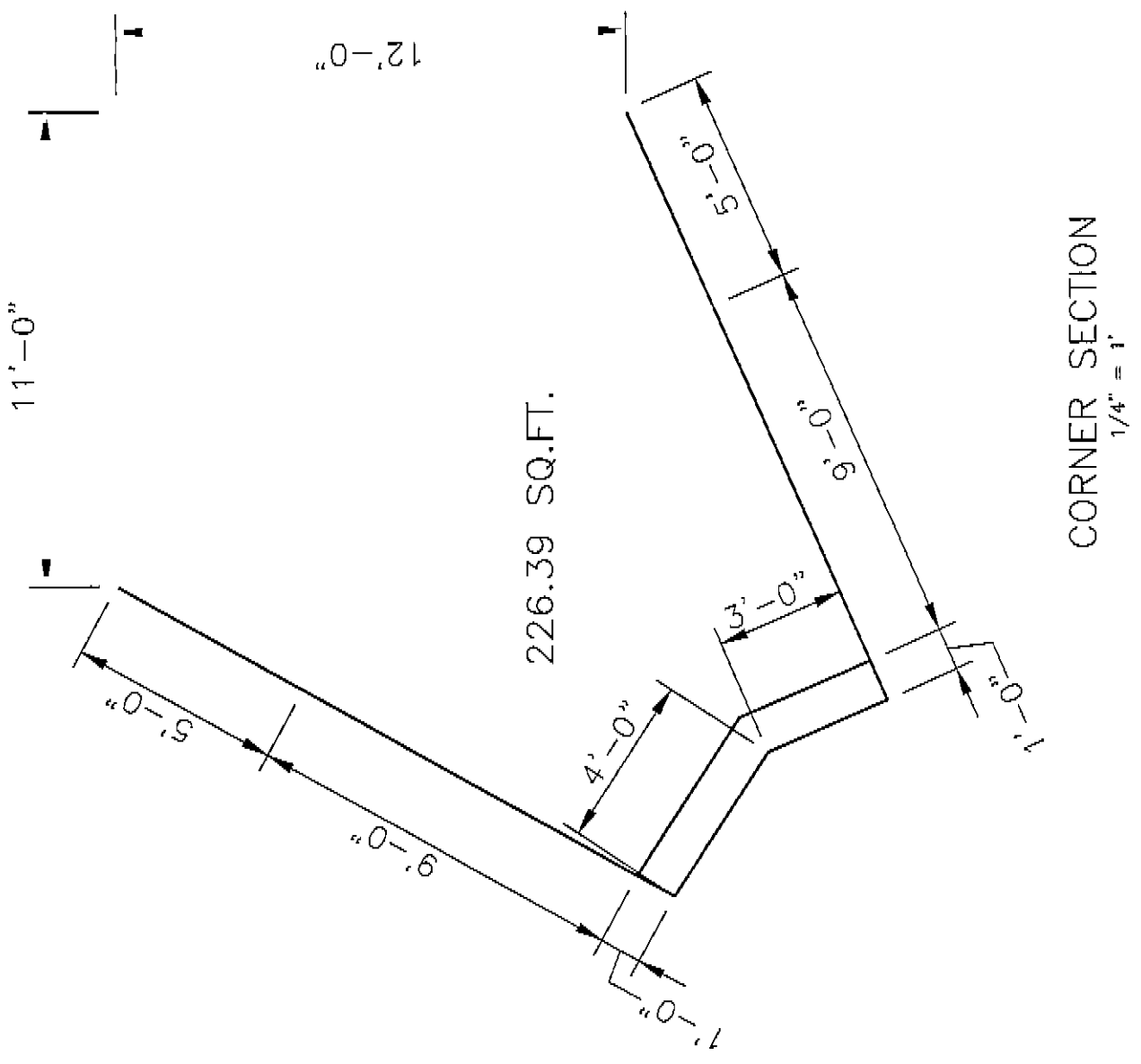

CORNER SECTION
 1/4" = 1'

TOTAL SLOPE PAVEMENT
 2325
 4375.25
 1576.75
 + 226.39
 8,503.4 S.F. = 944.82 S.Y.

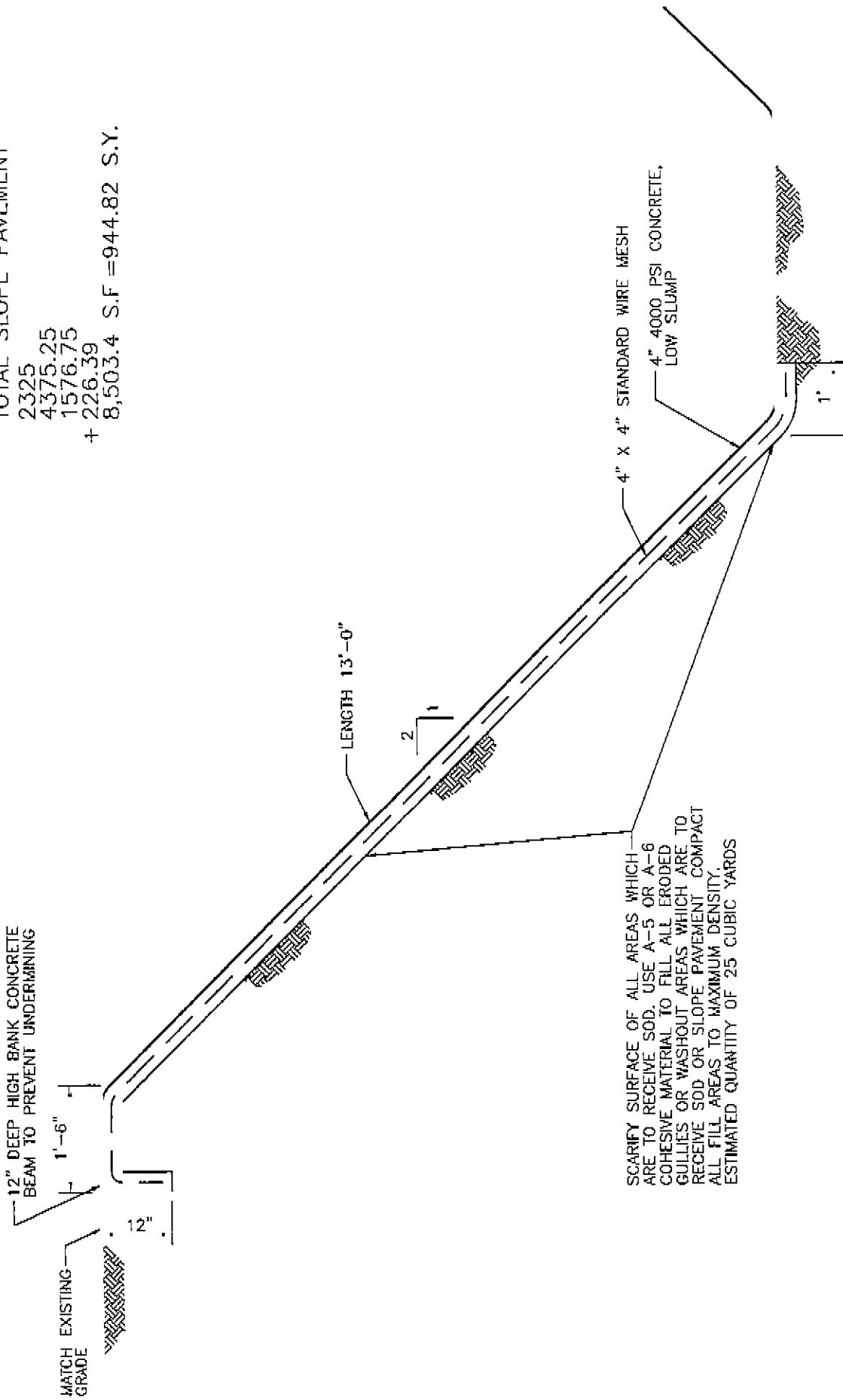

WILLOWRIDGE SLOPE PAVEMENT FIELD MEASUREMENTS

LOT 157 $\left[15.5' \times 150' = 2325 \text{ S.F.} \right]$
 $\frac{1}{2}'' = 1'$

TOTAL SLOPE PAVEMENT

2325
 4375.25
 1576.75
 + 226.39
 8,503.4 S.F.=944.82 S.Y.

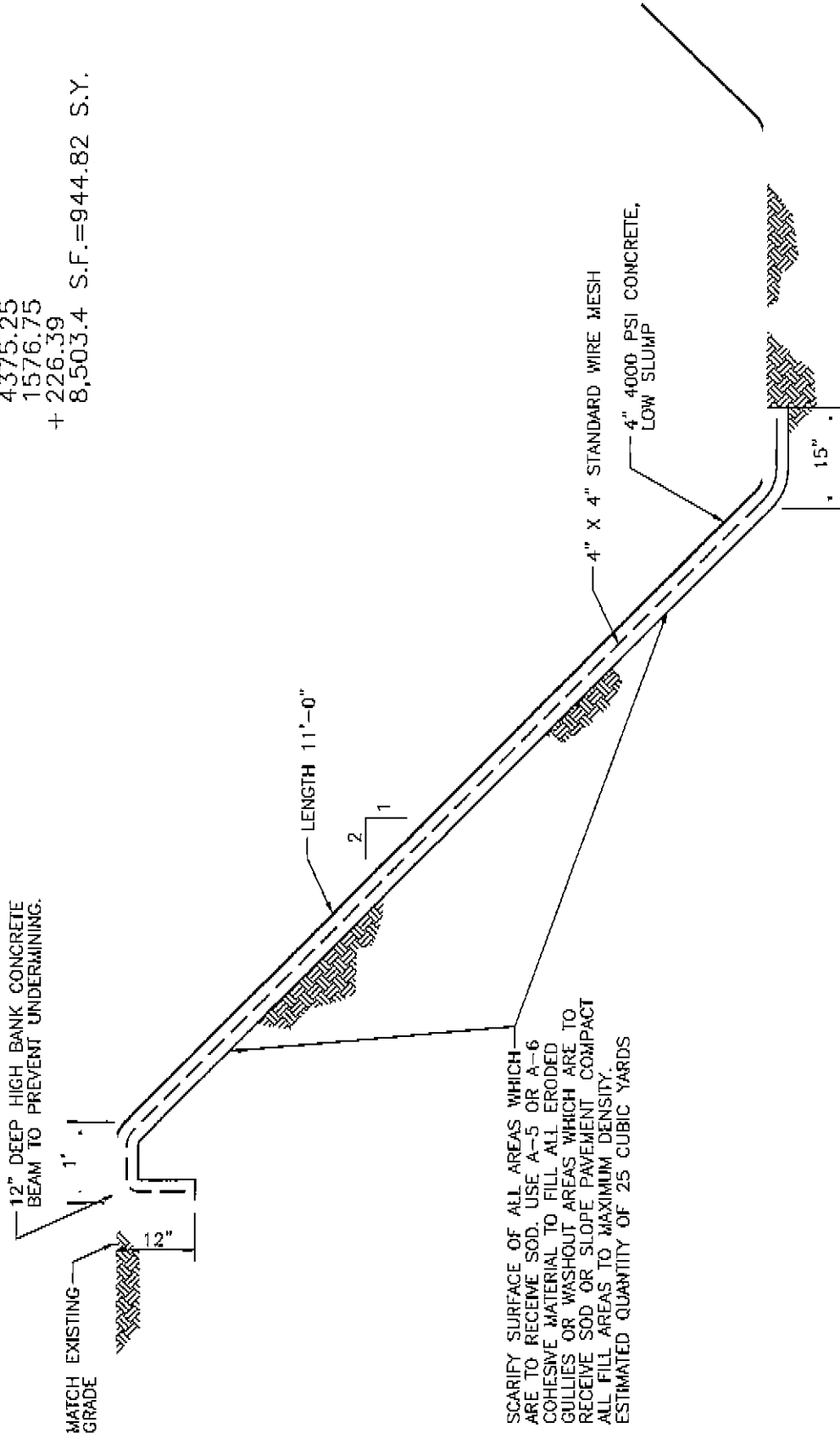

WILLOWRIDGE SLOPE PAVEMENT FIELD MEASUREMENTS

LOT 159 (SOUTH SIDE)
 $\frac{1}{2}'' = 1'$

$13.25' \times 119' = 1,576.75 \text{ S.F.}$

TOTAL SLOPE PAVEMENT
 2325
 4375.25
 1576.75
 + 226.39
 8,503.4 S.F.=944.82 S.Y.

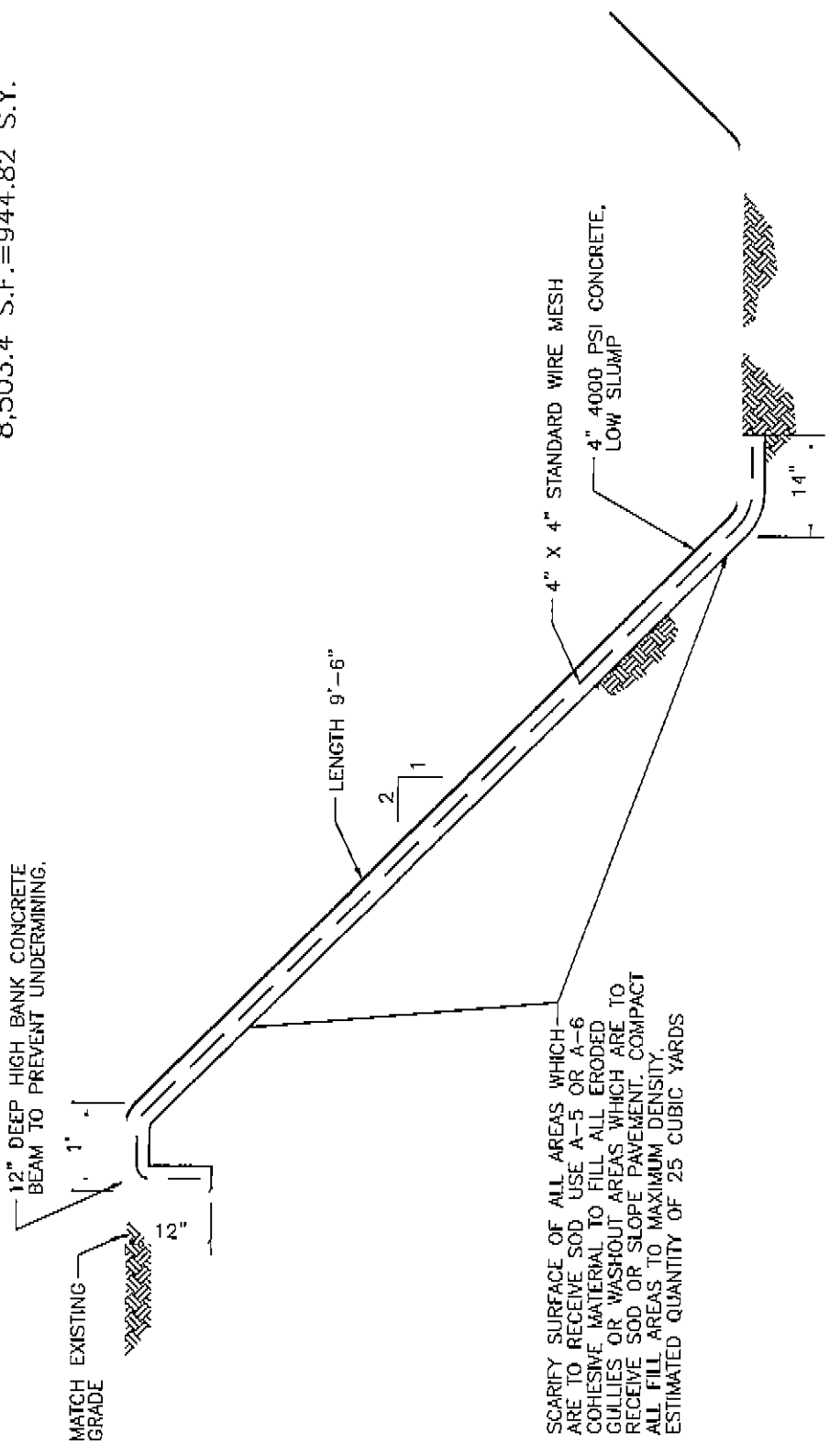

SCARIFY SURFACE OF ALL AREAS WHICH ARE TO RECEIVE SOD. USE A-5 OR A-6 COHESIVE MATERIAL TO FILL ALL ERODED GULLIES OR WASHOUT AREAS WHICH ARE TO RECEIVE SOD OR SLOPE PAVEMENT. COMPACT ALL FILL AREAS TO MAXIMUM DENSITY. ESTIMATED QUANTITY OF 25 CUBIC YARDS

WILLOWRIDGE SLOPE PAVEMENT FIELD MEASUREMENTS

LOT 159 (WEST SIDE)
 $\frac{1}{2}'' = 1'$

$11.67' \times 375' = 4,375.25 \text{ S.F.}$