

SECTION 00806

CHANGE ORDER

No. 1

DATE OF ISSUANCE May 14, 2004 EFFECTIVE DATE _____

OWNER St. Charles Parish Department of Public Works
CONTRACTOR All Star Electric, Inc.
Contract: Eastbank Historical Lighting
Project: Eastbank Historical Lighting
OWNER's Contract No. P030704 ENGINEER's Contract No. 20-0322
ENGINEER Meyer Engineers, Ltd.

You are directed to make the following changes in the Contract Documents:
Description:

See Attachment No. 1

Reason for Change Order:

See Attachment No. 1

Attachments* (List documents supporting change)

Attachment No. 1

CHANGE IN CONTRACT PRICE
Original Contract Price: \$ <u>148,912.91</u>
Net increase (decrease) from previous Change Orders No. <u> </u> to No. <u> </u> : \$ <u>-0-</u>
Contract Price prior to this Change Order: \$ <u>148,912.91</u>
Net increase (decrease) of this Change Order: \$ <u>25,481.44</u>
Contract price with all approved Change Orders: \$ <u>174,394.35</u>

CHANGE IN CONTRACT TIMES
Original Contract Times: Substantial Completion: <u>N/A</u> Ready for final payment: _____ (days or dates)
Net change from previous Change Orders No. <u> </u> to No. <u> </u> : Substantial Completion: <u>N/A</u> Ready for final payment: _____ (days)
Contract Times prior to this Change Order: Substantial Completion: <u>N/A</u> Ready for final payment: _____ (days or dates)
Net increase (decrease) this Change Order: Substantial Completion: <u>N/A</u> Ready for final payment: _____ (days)
Contract Times with all approved Change Orders: Substantial Completion: <u>N/A</u> Ready for final payment: _____ (days or dates)

RECOMMENDED:
By: [Signature]
ENGINEER (Authorized Signature)
Richard C. Meyer, Pres.
Date: 5-14-04

APPROVED:
By: [Signature]
OWNER (Authorized Signature)
Date: 6/8/2004

ACCEPTED:
By: [Signature]
CONTRACTOR (Authorized Signature)
Date: 5/17/04

EJCDC 1910-8-8 (1996 Edition)
Prepared by the Engineers Joint Contract Documents Committee and endorsed by The Associated General Contractors of America and The Construction Specifications Institute

20-0322C01

ATTACHMENT NO. 1
CHANGE ORDER NO. 1
EASTBANK HISTORICAL LIGHTING
PUBLIC WORKS # P030704
A/E PROJECT NO. 20-0322 MAY 14, 2004

ITEM NO.	DESCRIPTION	UNIT PRICE	REVISED QUANTITY	ORIGINAL QUANTITY	DIFFERENCE	JUSTIFICATION
1	LIGHT POLE (18' LONG)	\$2,276.37	28 EA	23 EA	\$11,381.85	1
2	LUMINAIRE (175 WATT METAL HALIDE)	\$706.94	56 EA	46 EA	\$7,069.40	1
3	ELECTRICAL SERVICE POINT	\$510.47	12 EA	10 EA	\$1,020.94	1
4	CONDUIT FOR ELECTRICAL SERVICE LINE	\$9.25	4,100 LF	3,500 LF	\$5,550.00	1
5	JACK AND BORE PIPE	\$8.35	370 LF	315 LF	\$459.25	1

TOTAL CHANGE ORDER NO. 1
ORIGINAL CONTRACT COST
PREVIOUS CHANGE ORDERS
TOTAL CONTRACT PRICE WITH CHANGE ORDER NO. 1

\$25,481.44
\$148,912.91
\$0.00
\$174,394.35

JUSTIFICATION:

1. ADDITIONAL FIVE (5) LIGHT POLES, FLXTURES, CONDUIT AND WIRING AS REQUESTED BY OWNER.

Richard C. Meyer, P.E.
President
Charles E. Meyer, P.E.
Executive Vice President
David H. Dupré, P.E.
Vice President
Jitendra C. Shah, P.E.
Vice President
Stephen R. Braquet, A.I.A.
Edye Conkerton, N.C.A.R.B.
Harold C. Lyons, Jr., P.E.
Mark A. Schutt, P.E.
Ann M. Theriot, P.E.

MEYER ENGINEERS, LTD.
ENGINEER & ARCHITECT

4937 Hearst Street, Suite B
Metairie, Louisiana 70001

P.O. Box 763
Metairie, Louisiana 70004

(504) 885-9892

Fax (504) 887-5056

E-mail: meyer@meyere-l.com

May 13, 2004

Mr. Frank Deffes
Allstar Electric
735 Little Farms
Metairie, LA 70003

Re: Eastbank Historical Lighting
PW# P030704
A/E Project No. 20-0322

Dear Mr. Deffes,

Enclosed are three (3) copies of revised sheet 19 and additional sheet 20 dated May 12, 2004.

Please review and advise us of the cost changes at your earliest convenience. Use existing pay items where possible.

Sincerely,

Meyer Engineers, Ltd.

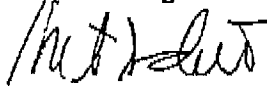

Mark A. Schutt

MAS/jmb

Enclosures

Cc: Mr. Gregory E. Bush, LTC, USA, Retired, Director of Public Works/Wastewater, St. Charles Parish Public Works, P. O. Box 705, Luling, LA 70070 (w/ attachments)

Mr. Matt Morelan, St. Charles Parish Public Works, P.O. Box 705, Luling, LA 70070 (w/ attachments)

55+00

30" OAK TREE

30" OAK TREE

CONC. DRIVE @ CHAISSON & CHASSION ATTORNEYS.

UNDERGROUND SERVICE

48" OAK TREE

SIGN SERVICE FROM ENTERGY UNDERGROUND SERVICE BY CHAISSON DRIVE

30" OAK TREE

48" OAK TREE

SERVICE FROM ENTERGY UNDERGROUND SERVICE BY CHAISSON DRIVE

50+00

RIVER ROAD

ASPHALT DRIVE

SERVICE FROM EXIST. POLE 31

CONC. DRIVE

JACK OR BORE ±15' UNDER CONCRETE DRIVE

REQ'D CONDUIT, TYP.

ASPHALT DRIVE

JACK OR BORE ±15' UNDER ASPHALT DRIVE

SERVICE FROM EXIST. POLE 31

JACK OR BORE ±15' UNDER ASPHALT DRIVE

ASPHALT DRIVE

SCALE: 1" = 100'

△ REVISED TO CLARIFY JACK OR BORE AREAS 02-09-04

△ ADDED ADDITIONAL LIGHTS 05-12-04

45+00

project no. 11-11-11
drawn by J. Meyer
checked by J. Meyer
date 11-11-11

EASTBANK HISTORICAL LIGHTING
ST. CHARLES PARISH, OWNER

MEYER ENGINEERS, LTD.
ENGINEER & ARCHITECT

sheet no. 19

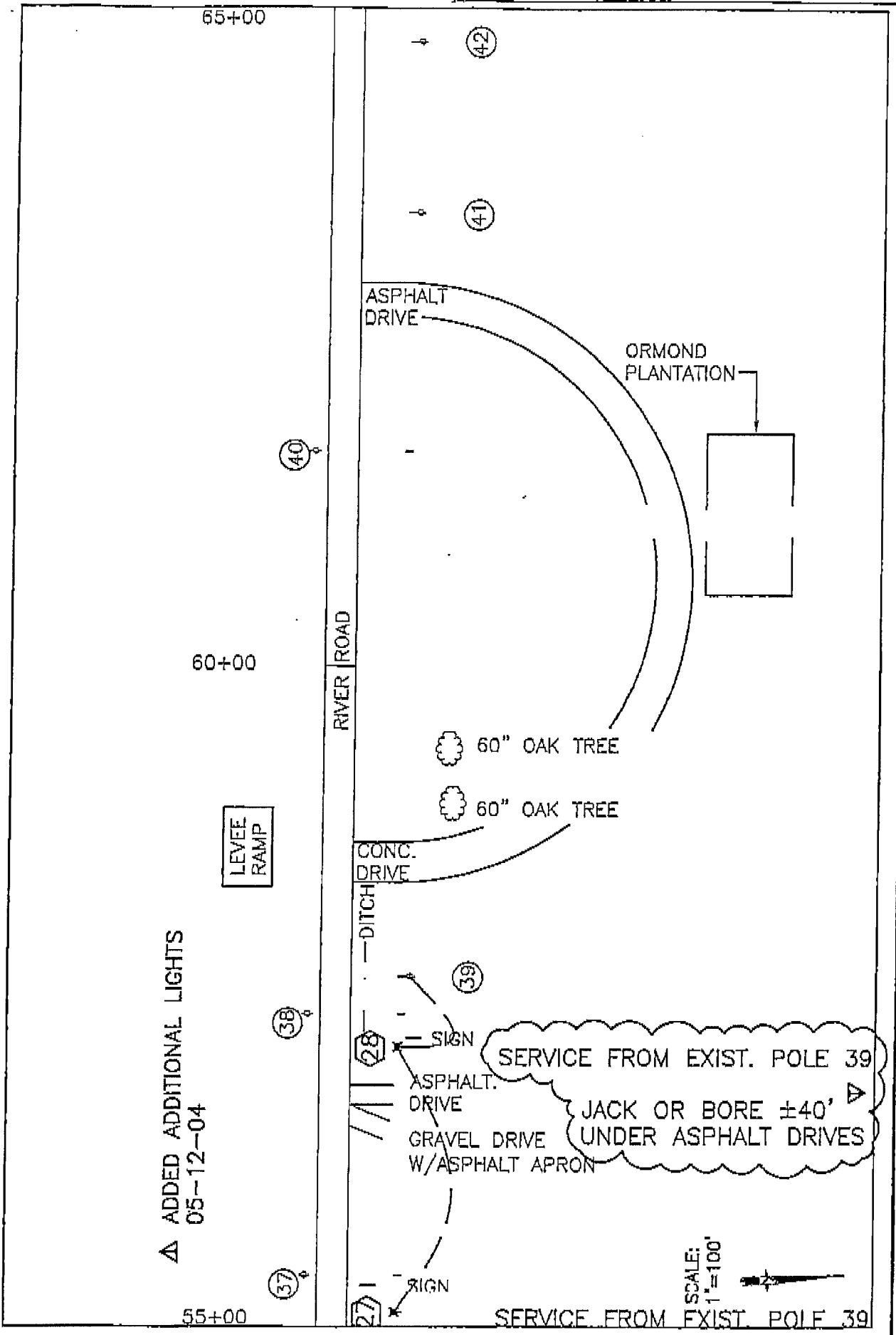

Project No. 20-011
 Date: 11/11/04
 Drawn: JKL
 Check: JKL

EASTBANK HISTORICAL LIGHTING
 ST. CHARLES PARISH OWNER

MEYER ENGINEERS, LTD.

Sheet No. 20