

SECTION 00650

CHANGE ORDER

PROJECT NAME: Edward A. Dufresne Community Center CHANGE ORDER NO: 001
 PPG OCD-DR PROJECT NUMBER: 45PARA3201
 CONTRACTOR: Lamar Contractors, Inc. CONTRACT DATE: 12-7-11

You are directed to make the following change(s) in this contract: Attach itemized breakdown in accordance with R.S. 38:2212A.(7). Also, please give brief description and justification of change(s) below.

RFC 2a rev 3-	Per contract documents, the Owner will receive Sales Tax credits on all material provided by subcontractors to perform the construction of the Edward A. Dufresne Community Center.	-\$320,950.32
RFC 3	- One (1) adverse weather day for the month of March.	\$ 0.00
RFC 4 rev 4	- Per Owner's request, add telephone/data power floor boxes in meeting rooms and provide power for future lighting of proposed statue.	\$ 4,496.97
RFC 5 rev 1	- Per Owner's request, a modification to the cook line in Kitchen 148.	\$ 2,177.51
RFC 6 rev 1	- Per response to RFI #37, add fitting to bring sewer cleanout to 90 degrees.	\$ 564.27
RFC 9 rev 1	- Four (4) adverse weather days for the month of June.	\$ 0.00
RFC 10 rev 4-	Per Owner's request, expand the existing parking lot layout. Add eleven (11) days to contract.	\$285,091.84
RFC 11 rev 5-	Per State Fire Marshal's review letter, modify the front entrance for additional egress width and add fire detection warning devices. Add three (3) days to contract.	\$ 8,113.43
RFC 12	- Five (5) adverse weather days for the month of July.	\$ 0.00
RFC 13	- Nine (9) adverse weather days for the month of August.	\$ 0.00
RFC 14rev 1	- Per professional engineer for metal wall panel company, 16 gage studs are required in lieu of 18 gage studs to withstand fastener pull-out of composite metal soffit panels.	\$ 2,166.01
RFC 15rev 1	- During shop drawing review of structural steel, the structural engineer added steel members. These members were not shown in the bid documents.	\$ 3,332.23
RFC 17	- During shop drawing review of acoustical metal roof deck, a curved steel member was added to support a transition from acoustical metal deck (interior) to non-acoustical metal deck (outside). This modification was necessary to maintain the aesthetics of the exterior metal soffits.	\$ 911.98
RFC 18rev 3	- Per Owner's request, provide backup power to existing lift station pumps along Edward Dufresne Parkway. Community Center will provide power to pumps during times of power outages. Add two (2) days to contract.	\$ 13,722.30

The Original Contract Sum	\$	10,565,980.00
Total Changes by Previous Change Order(s)	\$	0.00
Current Contract Sum	\$	10,565,980.00
Contract Sum, will be (increased) (decreased) (unchanged) by this Change Order	\$	-373.78
New Contract Sum	\$	10,565,606.22
The Original Contract Time and Completion Date	515	DAYS
Total Time extended by Previous Change Order(s)	0	DAYS
Contract Time will be (increased) (decreased) (unchanged) by this Change Order	35	DAYS
Revised Contract time and new Contract Completion Date	550	DAYS July 6, 2013

RECOMMENDED

Architect/Engineer Name
Address

SIZELER THOMPSON BROWN ARCHITECTS

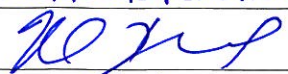
By MARK BRUPBACHER

Date: 12/6/12

ACCEPTED

Contractor's Name
Address

LAMAR CONTRACTORS, INC.

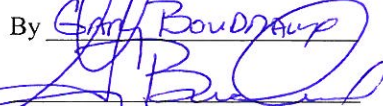
By SARA BOURGAIN

Date: 12/5/12

APPROVED

Owner

By: _____

Date: _____

(Note: Before any Change Order is routed to Owner for approval it must first be routed to the OCD-DR Project Manager for oversight review).



1515 Poydras St, Suite 1350
New Orleans, LA 70112
Tel: 504-799-1100
Fax: 504-812-8260

December 14, 2012

The Honorable V.J. St. Pierre, Jr.
St. Charles Parish President
P.O. Box 302
Hahnville, LA 70057

Subject: St. Charles Parish- Community Center
Gustav/Ike Project Number 45PARA3201
Review of Construction Change Order No. 1

Dear President St. Pierre:

On behalf of OCD/DRU, we have reviewed the attached proposed Change Order No. 1 and found that the change order appears to conform to the grant application. The Architect and the Parish have determined that the cost is reasonable. The change order incorporates several change requests for a net deduct of \$373.78 and adds 35 days to the completion calendar. The revised CDBG funded amount as a result of the change orders remains within the approved grant amount.

Once the change order is executed, please have the Architect furnish us with a copy for our files.

Please note that this review is only to verify general conformance with the project scope in the grant application/amended applications. Our review does not include a review against the Environmental Review Record (ERR), which shall be performed by the applicant or their representative to determine if changes or additional environmental clearances are needed. In addition, the review is non-technical in nature and does not include review of design, constructability, or compliance with codes, regulations, and public bid law.

If you have any questions or require additional information, please call me at 504-799-1100.

Sincerely,

A handwritten signature in black ink that reads 'Anil DeSa'.

Anil DeSa, P.E.
Project Manager

Cc: Rowdy Gaudet (OCD), Jeremy Meiske (OCD), Connie Hall (OCD), Holly Fonseca,
Mark Brupbacher

Attachment: Change Order No. 1



**REGIONAL
DESIGN
GROUP, LLC**

November 29, 2012

Mr. Steve Louque
Lamar Contractors, LLC
481 Judge Edward Dufresne Pkwy
Luling, LA 70070

**Re: Edward A Dufresne Community Center
Parish Project # 45PARA3201
SA# 21131.00**

PROJECT
design group, llc

REGIONAL
design group, llc

HEALTHCARE
design group, llc

Dear Steve,

Lamar Contractor's Request For Change #2a rev3 is approved. RFC #2a rev3 will be included in Change Order #1 and will deduct \$320,950.32 from the contract sum.

Following is a summary of the recommended Request For Change:

Per contract documents, the Owner will receive Sales Tax credits on all material provided by subcontractors to perform the construction of the Edward A. Dufresne Community Center. Additional tax credits will be issued by Lamar Contractors, at a later date, for all material purchased by Lamar.

Please call us should you have any questions regarding this information.

Sincerely,

**Sizeler Thompson Brown Architects
Regional Design Group, LLC**

A handwritten signature in blue ink, appearing to read "M Brupbacher", is written over the typed name of Mark Brupbacher.

Mark Brupbacher, AIA

mcb

cc: File
Holly Fonseca, SCP

Enclosure

*A Professional
Corporation*

300 Lafayette Street
Suite 200
New Orleans, LA
70130

office (504) 523-6472
fax (504) 529-1181

LAMAR CONTRACTORS, INC

Site Location: Edward Dufresne Community Center

Engineer: Sizler, Thompson, Brown Architects

Date: 11/26/2012

Request For Change No. 2a rev 3 - Partial Sales Tax Credit per the Owner's Request

DESCRIPTION	QUANT	MATERIAL		LABOR		SUB & OTHER		TOTAL
		UNIT	TOTAL	UNIT	TOTAL	UNIT	TOTAL	
Grass Rangers	1 ls		0		0		-\$228.07	-\$228.07
Boh Bros.	1 ls		0		0		-\$20,478.00	-\$20,478.00
Corgan Fence	1 ls		0		0		-\$295.29	-\$295.29
Barrett Interiors	1 ls		0		0		-\$19,719.28	-\$19,719.28
MorCore Roofing	1 ls		0		0		-\$19,935.00	-\$19,935.00
DeGeorge Glass	1 ls		0		0		-\$4,120.00	-\$4,120.00
Dynamic Door	1 ls		0		0		-\$594.59	-\$594.59
A&R Flooring	1 ls		0		0		-\$4,816.88	-\$4,816.88
Bauer Sports Floors	1 ls		0		0		-\$4,928.85	-\$4,928.85
D&T Terrazzo	1 ls		0		0		-\$1,000.26	-\$1,000.26
W.J. Enterprises	1 ls		0		0		-\$364.95	-\$364.95
M. Dalesandro Painting	1 ls		0		0		-\$1,245.00	-\$1,245.00
Associated Office Systems	1 ls		0		0		-\$7,672.15	-\$7,672.15
Glendale Enterprises	1 ls		0		0		-\$8,031.00	-\$8,031.00
Getbilt	1 ls		0		0		-\$7,268.67	-\$7,268.67
Hahn Enterprises	1 ls		0		0		-\$2,176.74	-\$2,176.74
Joffary Window Coverings	1 ls		0		0		-\$329.73	-\$329.73
Buckelew's Hardware	1 ls		0		0		-\$6,315.69	-\$6,315.69
Austin Fire Equipment	1 ls		0		0		-\$1,925.64	-\$1,925.64
Mayeux's A/C	1 ls		0		0		-\$36,437.06	-\$36,437.06
C&D Plumbing	1 ls		0		0		-\$7,775.50	-\$7,775.50
Advanced Electrical	1 ls		0		0		-\$47,875.00	-\$47,875.00
Lamar Contractors (3 suppliers)	1 ls		0		0		-\$112,145.13	-\$112,145.13
			0		0		0	0
SUB-TOTALS			0.00		0.00		-315,678.48	-315,678.48
SALES TAX @ Exempt	0 %							0.00
P/R BURDEN @ 41%	0.41 %							0.00
SMALL TOOLS @ 4%	0.04 %							0.00
SUBTOTAL								-315,678.48
Lamar OH&P on Subcontractor	0.10 %							0.00
SUBTOTAL								-315,678.48
Lamar OH&P on Self Performed	0.15 %							0.00
SUBTOTAL								-315,678.48
Bond & Insurance	0.017 %							-5,271.83
GRAND TOTAL								-320,950.32

This office is requesting an additional (0) Zero Day be added to the Contract.
 Please advise this office in (10) Ten Days whether this RFC has been approved.
 Delay in approval will require additional time be added to the contract.

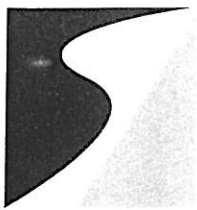

SIZELER
THOMPSON
BROWN
ARCHITECTS

**REGIONAL
DESIGN
GROUP, LLC**

November 27, 2012

Mr. Steve Louque
Lamar Contractors, LLC
481 Judge Edward Dufresne Pkwy
Luling, LA 70070

**Re: Edward A Dufresne Community Center
Parish Project # 45PARA3201
STBA# 21131.00**

PROJECT
design group, llc

REGIONAL
design group, llc

HEALTHCARE
design group, llc

Dear Steve,

Lamar Contractor's Request For Change #10 rev 4 is approved. RFC #10 rev 4 will be included in Change Order #1 and will modify the original contract sum by \$285,091.84 and contract time by eleven (11) calendar days.

Following is a summary of the recommended Request For Change:

Per Owner's request, additional parking spaces and lanes to the parking lot configuration was issued as part of WCPR #005. RFC #10 rev 4 was submitted as a response to this WCPR.

Therefore, Lamar Contractors' contract is approved to increase in time by eleven (11) calendar days. The new Substantial Completion date is July 1, 2013.

Please call us should you have any questions regarding this information.

Sincerely,

**Sizeler Thompson Brown Architects
Regional Design Group, LLC**

*A Professional
Corporation*

Mark Brupbacher, AIA

mcb

cc: File
Holly Fonseca

Enclosure

300 Lafayette Street
Suite 200
New Orleans, LA
70130

office (504) 523-6472
fax (504) 529-1181

LAMAR CONTRACTORS, INC

Site Location: Edward Dufresne Community Center

Engineer: Sizler, Thompson, Brown Architects

Date: 11/13/2012

Request For Change No. 10 rev 4 - WCPR No. 5 - Additional Parking

DESCRIPTION	QUANT	MATERIAL		LABOR		SUB & OTHER		TOTAL
		UNIT	TOTAL	UNIT	TOTAL	UNIT	TOTAL	
Arabie - Sand (2850yds)	1 ls		0.00		0.00		24,175.00	24,175.00
Arabie Profit	1 ls		0.00		0.00		3,626.25	3,626.25
Geocloth	6 roll	485.00	2,910.00	75.00	450.00		0.00	3,360.00
Form 8" Paving	764 sf	1.70	1,298.80		0.00		0.00	1,298.80
6" Paving	514 sf	1.70	873.80		0.00		0.00	873.80
Reinforcing Steel	1 ls		24,673.00		0.00		0.00	24,673.00
CJ Keyway 6"	1058 lf	1.13	1,195.54		0.00		0.00	1,195.54
Keyway 8"	1813 lf	1.39	2,520.07		0.00		0.00	2,520.07
Geocloth Strip	12 roll	54.00	648.00		0.00		0.00	648.00
Joint Sealant	2871 lf		0.00		0.00	1.00	2,871.00	2,871.00
LCJ Keyway 8"	547 lf	1.18	645.46		0.00		0.00	645.46
Sandplate	364 ea	0.35	127.40		0.00		0.00	127.40
Geocloth Strip	3 roll	54.00	162.00		0.00		0.00	162.00
Deformed Bars 30"	183 ea	1.47	269.01		0.00		0.00	269.01
Spade Chair	364 ea	0.35	127.40		0.00		0.00	127.40
EJ Redwood 6" w/basket	539 lf	5.49	2,959.11		0.00		0.00	2,959.11
Redwood 8" w/basket	333 lf	6.59	2,194.47		0.00		0.00	2,194.47
Geocloth Strip	4 roll	54.00	216.00		0.00		0.00	216.00
Joint Sealant	872 lf		0.00		0.00	1.50	1,308.00	1,308.00
Concrete	668 cy	94.00	62,792.00		0.00		0.00	62,792.00
Pump Concrete	668 cy		0.00		0.00	12.00	8,016.00	8,016.00
Pina Concrete (form & finish)	1 ls		0.00		0.00		30,360.00	30,360.00
Pina Conc. Profit	1 ls		0.00		0.00		4,554.00	4,554.00
C & D Plumbing (Storm Drng)	1 ls		0.00		0.00		8,870.40	8,870.40
C & D Profit	1 ls		0.00		0.00		1,330.56	1,330.56
Lamar Catch Basin Modification	40 mh		0.00	12.28	491.20		0.00	491.20
Electric Jack Hammer Rental	2 days		0.00	110.00	220.00		0.00	220.00
Advanced Electric	1 ls		0.00		0.00		32,820.25	32,820.25
Advanced Electric Profit	1 ls		0.00		0.00		4,563.04	4,563.04
Sonatube for Lightpole Bases	50 lf	9.20	460.00	10.00	500.00		0.00	960.00
Concrete @ Bases	7 cy	94.00	658.00		0.00		0.00	658.00
Finish & Pour Bases	5 ea		0.00	400.00	2,000.00		0.00	2,000.00
Grass Rangers	1 ls		0.00		0.00		2,252.38	2,252.38
Grass Rangers - Profit	1 ls		0.00		0.00		337.86	337.86
Parking Lot Striping & Arrows	1 ls		0.00		0.00		5,330.00	5,330.00
Do Not Enter Signage	2 ea		0.00		0.00	175.00	350.00	350.00
Bollards w/ Chain Guard	2 ea	500.00	1,000.00	100.00	200.00		0.00	1,200.00
Supervision	2 wk		0.00	1,610.00	3,220.00		0.00	3,220.00
Fuel	2 wk	175.00	350.00		0.00		0.00	350.00
Equipment Bobcat Loader	2 wk	495.00	990.00		0.00		0.00	990.00
Bobcat Excavator	2 wk	600.00	1,200.00		0.00		0.00	1,200.00
Dozer	2 wk	600.00	1,200.00		0.00		0.00	1,200.00
Temp Toilet	2 wk	30.00	60.00		0.00		0.00	60.00
Temp Office	2 wk	65.00	130.00		0.00		0.00	130.00
Temp Storage	2 wk	40.00	80.00		0.00		0.00	80.00
SUB-TOTALS			109,740.06		7,081.20		130,764.74	247,586.00

LAMAR CONTRACTORS, INC

SUB TOTAL CARRIED FWD			109,740.06		7,081.20		130,764.74	247,586.00
SALES TAX @ 9%	0 %							0.00
P/R BURDEN @ 41%	0.41 %							2,903.29
SMALL TOOLS @ 4%	0.04 %							283.25
SUBTOTAL								250,772.54
Lamar OH&P on Subcontractor	0.10 %							11,635.30
SUBTOTAL								262,407.84
Lamar OH&P on Self Performed	0.15 %							18,001.17
SUBTOTAL								280,409.01
Bond & Insurance	0.017 %							4,682.83
GRAND TOTAL								285,091.84

This office is requesting an additional (11) Eleven Days be added to the Contract.

Please advise this office in (10) Ten Days whether this RFC has been approved.

Delay in approval will require additional time be added to the contract.

QTY.	COMMON NAME	DESCRIPTION
8	SWEET BAY MAGNOLIA	#4.5, 10'-12" H., multi-trunk, full canopy spread, specimen quality
19,320 S.F.	CENTREPE SOD	Class 'A', see spec. (approx.)
	EREMOCLOA OVALIFOLIOS	

PLANT LIST

L101

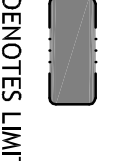
NOTE:

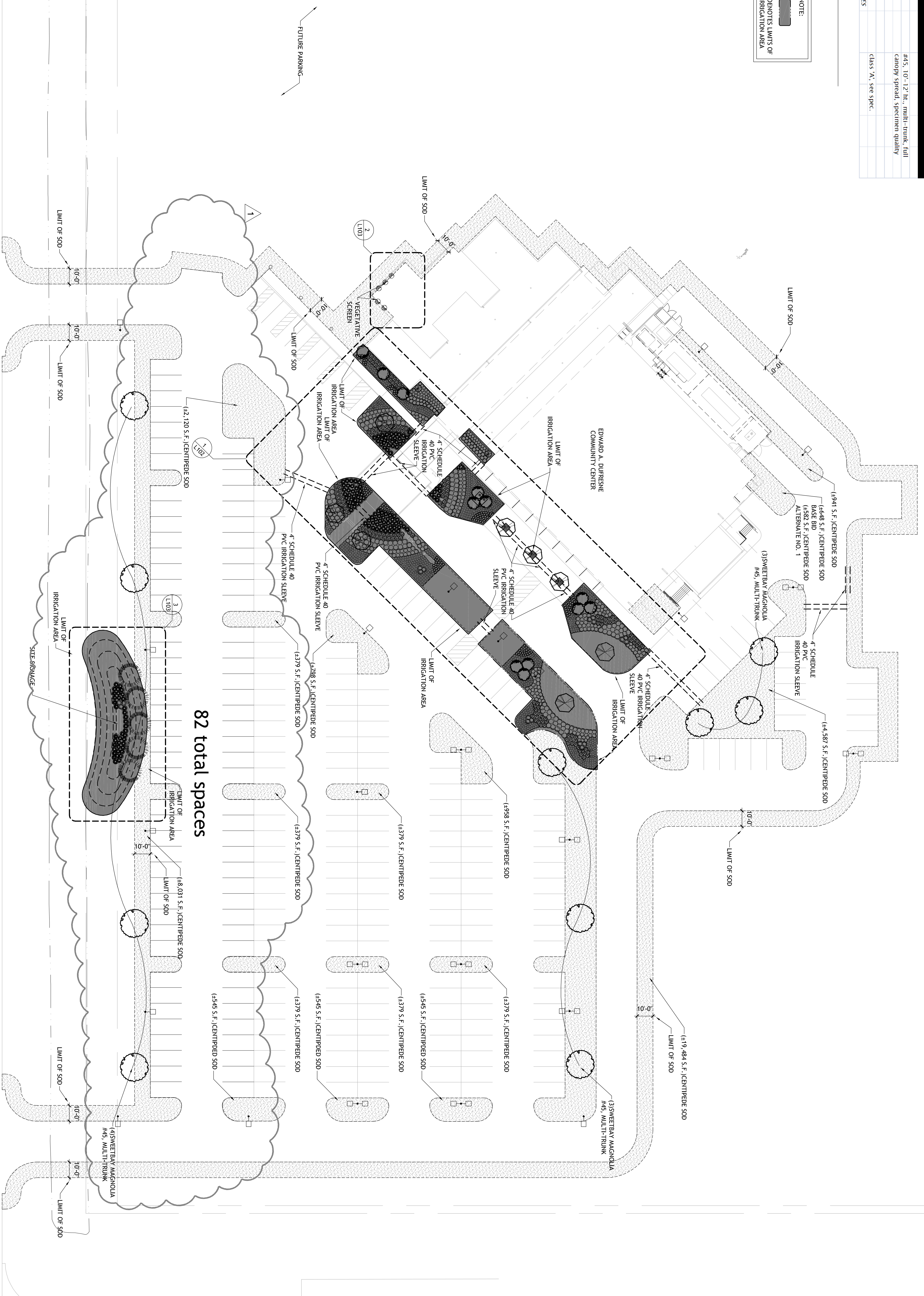
 DENOTES LIMITS OF IRRIGATION AREA



82 total spaces

1 LANDSCAPE SITE PLAN
 SCHEMATIC
 NORTH
 1" = 30'-0"

LANDSCAPE NOTES:
 AUTOMATED IRRIGATION SYSTEM WITH 100% COVERAGE TO LANDSCAPING WITHIN IRRIGATION AREA
 GET PLAN IS REQUIRED. PROVIDE SEPARATE WATER SERVICE LINE AND METER. COORDINATE
 WITH ELECTRICAL CONTRACTOR FOR METER LOCATION. PROVIDE SOD SHADING FOR NESTING BIRDS TO
 INSTALLATION.

CONSTRUCTION SET

REGIONAL DESIGN GROUP, LLC
 300 LAEYETTE STREET, SUITE 200
 NEW ORLEANS, LOUISIANA 70130
 (504) 523-6472 FAX (504) 529-1181
 THEODORE BROWN ARCHITECTS

NO.	REVISION	DATE
1	WORK SET	7-16-12
2		
3		
4		
5		

EDWARD A DUFRESNE COMMUNITY CENTER
 LULING, LOUISIANA

SCHEMATIC LANDSCAPE SITE PLAN

FILE NAME	L101.dwg	DRAWING NUMBER	L101
PROJECT NUMBER	21131.00		
DATE	November 29, 2011		
PHASE	CA		