

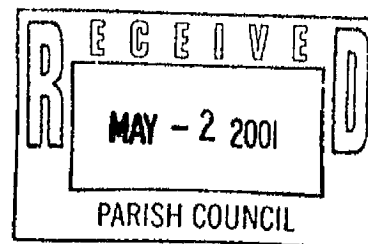

DEPARTMENT OF THE ARMY
NEW ORLEANS DISTRICT, CORPS OF ENGINEERS
P.O. BOX 60267
NEW ORLEANS, LOUISIANA 70160-0267

REPLY TO
ATTENTION OF:

May 1, 2001



Operations Division
Eastern Evaluation Section
Project Manager
Roger Swindler
(504) 862-2278

SUBJECT: EM-20-010-2413

PUBLIC NOTICE

Interested parties are hereby notified that an application has been received by the District Engineer for a Department of the Army permit to authorize the following pursuant to: Section 10 of the Rivers and Harbors Act of March 3, 1899 (30 Stat. 1151; 33 USC 403).

BARGE FLEET IN THE MISSISSIPPI RIVER
ST. CHARLES PARISH

NAME OF APPLICANT: Carline Management Company, Inc., c/o River Consulting, Inc.,
3500 N. Causeway Boulevard, Suite 210, Metairie, Louisiana 70002.

LOCATION OF WORK: In the Mississippi River, right descending bank, at a point about
122.4 miles above the Head of Passes, near Luling, Louisiana, in ST. CHARLES PARISH.

CHARACTER OF WORK: Install and maintain anchor piles, chains, buoys and spar barges for
a block moored barge fleet. The fleet will consist of three mooring blocks, eight
standard river barges (195'X35') wide, as shown on the attached drawings. The proposed
fleet will be located in an area about 3,400 feet long and 280 feet wide, extending
parallel to the mean low water shoreline, the outer edge to be about 500 feet channelward
there from. Barge fleet operations in a tier configuration were previously permitted
at the site under permit (Mississippi River)1009.

The comment period for the Department of the Army will close 20 days from the date
of this public notice. Written comments, including suggestions for modifications or
objections to the proposed work, stating reasons thereof, are being solicited from anyone
having interest in this permit and must be mailed so as to be received before or by the
last day of the comment period. Letters concerning the Corps of Engineers permit
application must reference the applicant's name and the Permit Application Number, and be
mailed to the Corps of Engineers at the address above, ATTENTION: REGULATORY BRANCH.

The decision whether to issue a permit will be based on an evaluation of the
probable impact including cumulative impacts of the proposed activity on the public
interest. That decision will reflect the national concern for both protection and
utilization of important resources. The benefit which reasonably may be expected to
accrue from the proposal must be balanced against its reasonably foreseeable detriments.
All factors which may be relevant to the proposal will be considered including the
cumulative effects thereof; among those are conservation, economics, aesthetics, general
environmental concerns, wetlands, historic properties, fish and wildlife values, flood
hazards, floodplain values, land use, navigation, shoreline erosion and accretion,
recreation, water supply and conservation, water quality, energy needs, safety, food and
fiber production, mineral needs, considerations of property ownership and, in general,
the needs and welfare of the people.

154

The Corps of Engineers is soliciting comments from the public; federal, state, and local agencies and officials; Indian Tribes; and other interested parties in order to consider and evaluate the impacts of this proposed activity. Any comments received will be considered by the Corps of Engineers to determine whether to issue, modify, condition or deny a permit for this proposal. To make this decision, comments are used to assess impacts on endangered species, historic properties, water quality, general environmental effects, and the other public interest factors listed above. Comments are used in the preparation of an Environmental Assessment and/or Environmental Impact Statement pursuant to the National Environmental Policy Act. Comments are also used to determine the need for a public hearing and to determine the overall public interest of the proposed activity.

No properties listed on the National Register of Historic Places are near the proposed work. The possibility exists that the proposed work may damage or destroy presently unknown archeological, scientific, prehistorical, historical sites, or data. Copies of this notice are being sent to the State Archeologist and the State Historic Preservation Officer.

Our initial finding is that the proposed work would neither affect any species listed as endangered by the U.S. Department of Interior nor affect any habitat designated as critical to the survival and recovery of any endangered species.

This notice initiates the Essential Fish Habitat (EFH) consultation requirements of the Magnuson-Stevens Fishery Conservation and Management Act. The applicant's proposal would result in the destruction or alteration of N/A acres of EFH utilized by various life stages of red drum and penaeid shrimp. Our initial determination is that the proposed action would not have a substantial adverse impact on EFH or federally managed fisheries in the Gulf of Mexico. Our final determination relative to project impacts and the need for mitigation measures is subject to review by and coordination with the National Marine Fisheries Service.

If the proposed work involves deposits of dredged or fill material into navigable waters, the evaluation of the probable impacts will include the application of guidelines established by the Administrator of the Environmental Protection Agency and certification that the proposed activity will not violate applicable water quality standards will be required from the Department of Environmental Quality, Office of Water Resources before a permit is issued.

Any person may request, in writing, within the comment period specified in this notice, that a public hearing be held to consider this application. Requests for public hearings shall state, with particularity, the reasons for holding a public hearing

You are requested to communicate the information contained in this notice to any other parties whom you deem likely to have interest in the matter. The applicant has certified that the proposed activity described in the application complies with and will be conducted in a manner that is consistent with the Louisiana Coastal Resources Program. The Corps of Engineers permit will not be issued unless the applicant has received approval or a waiver of the Coastal Use Permit by the Department of Natural Resources.

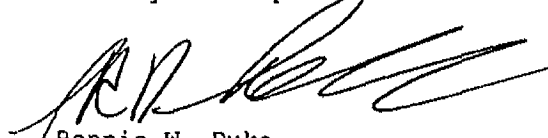

Ronnie W. Duke
Chief, Eastern Evaluation Section

Attachments

(155)

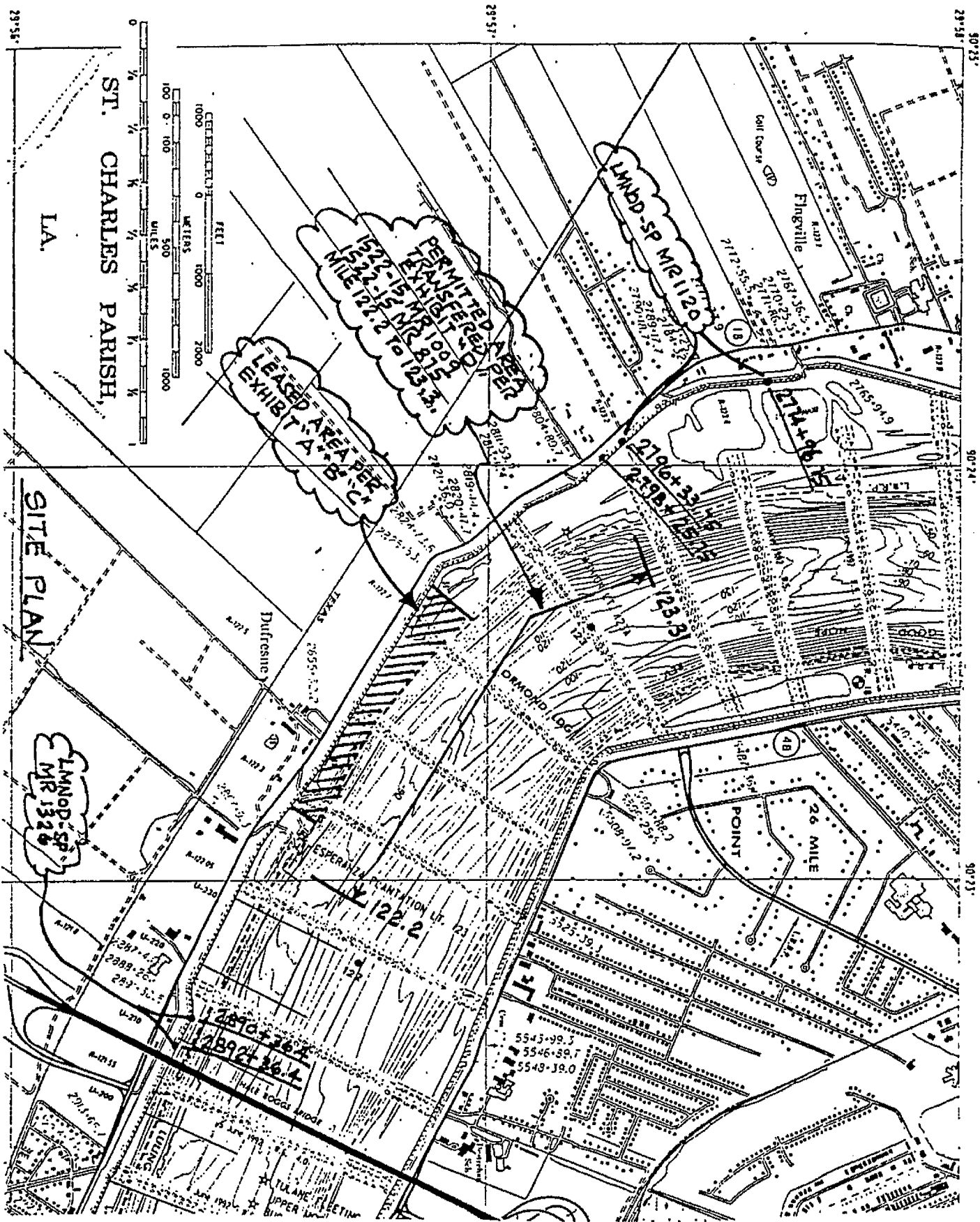

Designed By:
R.C.I.
Drawn By:
JH
Checked By:
Approved By:



Metairie, Louisiana
Columbus, Ohio

BARGE FLEETING PERMIT TRANSFERS
FOR
CARLINE MANAGEMENT CO. INC.
LOUISIANA

SITE PLAN

PROJ. NO.
DATE
APRIL, 2001
DRAWING NO.
D-2

156

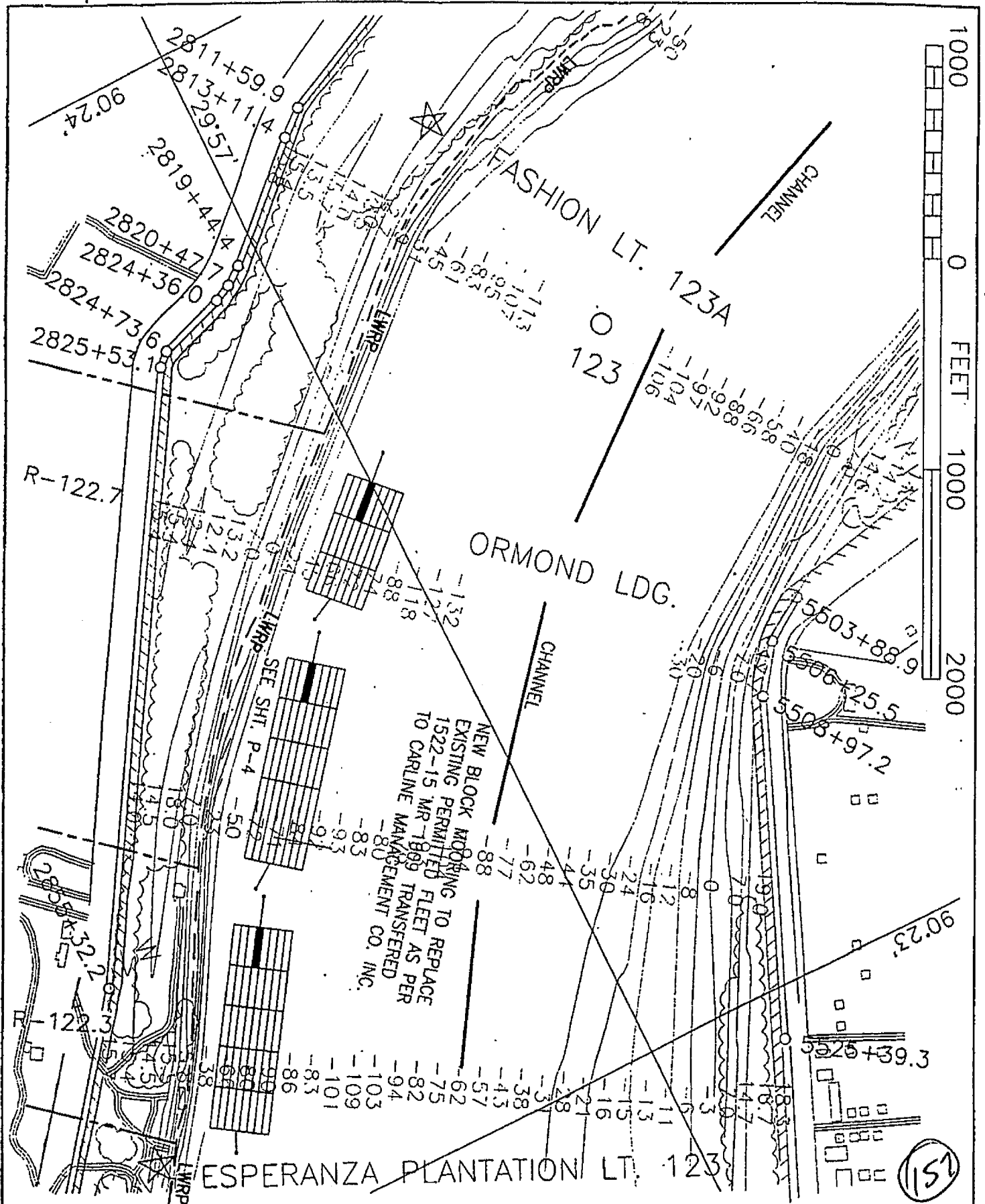

Designed by:
R.C.I.
Drawn by:
JH
Checked by:
Approved by:

RIVER
CONSULTING
INCORPORATED

Metairie, Louisiana
Columbus, Ohio

BARGE FLEETING PERMIT TRANSFERS
FOR
CARLINE MANAGEMENT CO. INC.
DUFRESNE LOUISIANA

BARGE FLEETING LAYOUT

PROJ. NO. 4751

DATE APRIL, 2001

DRAWING NO.

P-3

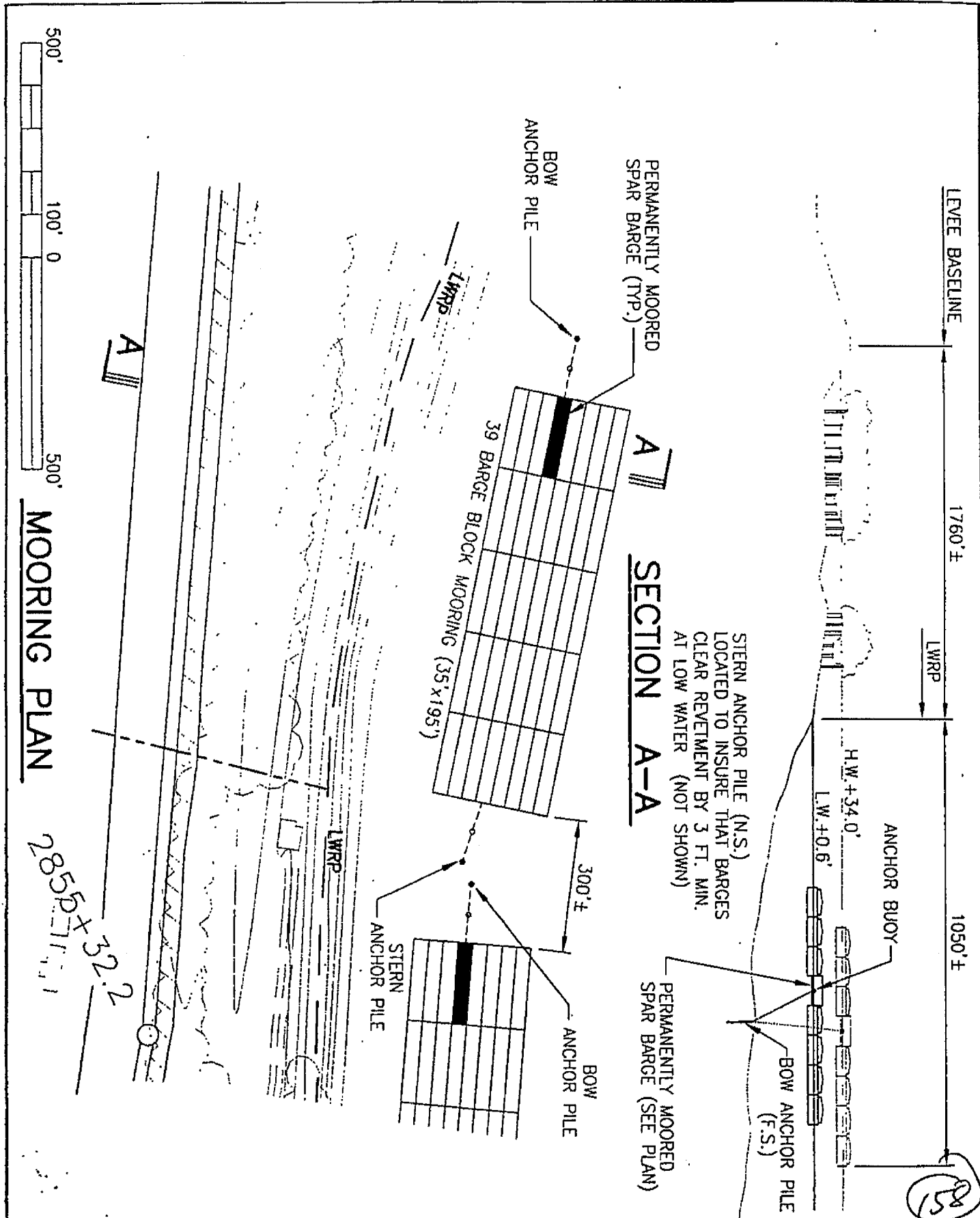

Designed by: R.C.I.	 <p>RIVER CONSULTING Metairie, Louisiana Columbus, Ohio</p>	BARGE FLEETING PERMIT TRANSFERS FOR CARLINE MANAGEMENT CO. INC. LOUISIANA	PROJ. NO. 4751
Drawn by: JH		DUFRESNE	DATE APRIL, 2001
Checked by:			DRAWING NO.
Approved by:			P-4

MOORING PLAN AND SECTION

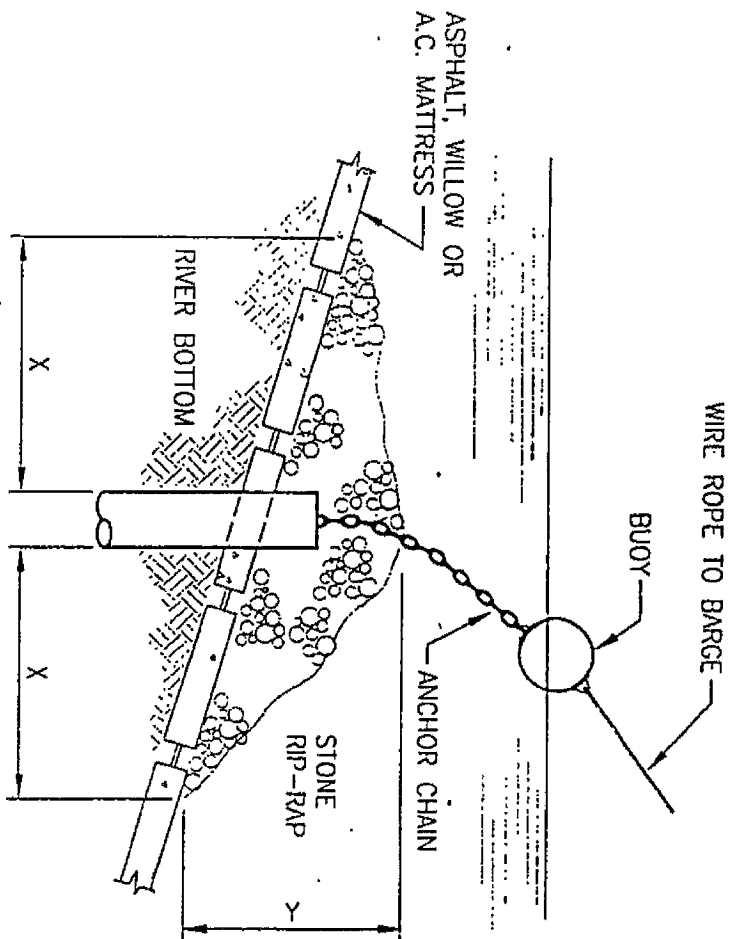

STANDARD REPAIR DETAIL (FOR PILING DRIVEN THROUGH REVETMENT)

N.T.S.

DEPTH OF WATER IN FEET AT POINT OF PILE PENETRATION	DISTANCE IN FEET		APPROXIMATE TONS OF STONE REQUIRED
	X	Y	
1 TO 10	3	1.5	1.5
11 TO 40	5	2	6.5
41 TO 60	8	3	22
61 TO 100	12	4	57

- NOTES**
1. SIZE OF RIP-RAP TO VARY BETWEEN 6 POUNDS AND 125 POUNDS WITH 40% TO 60% OF THE STONE WITHIN THE RANGE OF 25 POUNDS TO 75 POUNDS.
 2. WHEN USING ANCHOR CHAIN AND BUOY SYSTEM, ANCHOR CHAIN MUST BE AT TOP OF PILE TO MINIMIZE REVETMENT DAMAGE.

Designed by:
R.C.I.
Drawn by:
JH
Checked by:
Approved by:



Metalairie, Louisiana
Columbus, Ohio

BARGE FLEETING PERMIT TRANSFERS
FOR
CARLINE MANAGEMENT CO. INC.
LOUISIANA
DUFRESNE
REVETMENT REPAIR DETAIL

PROJ. NO. 4751
DATE APRIL, 2001
DRAWING NO. P-5

59